

WATERFORD NORTH THIRD ADDITION
 STORM WATER SEWER NO.
 PROJ. NO. 468-76-245 80001-000-000-071

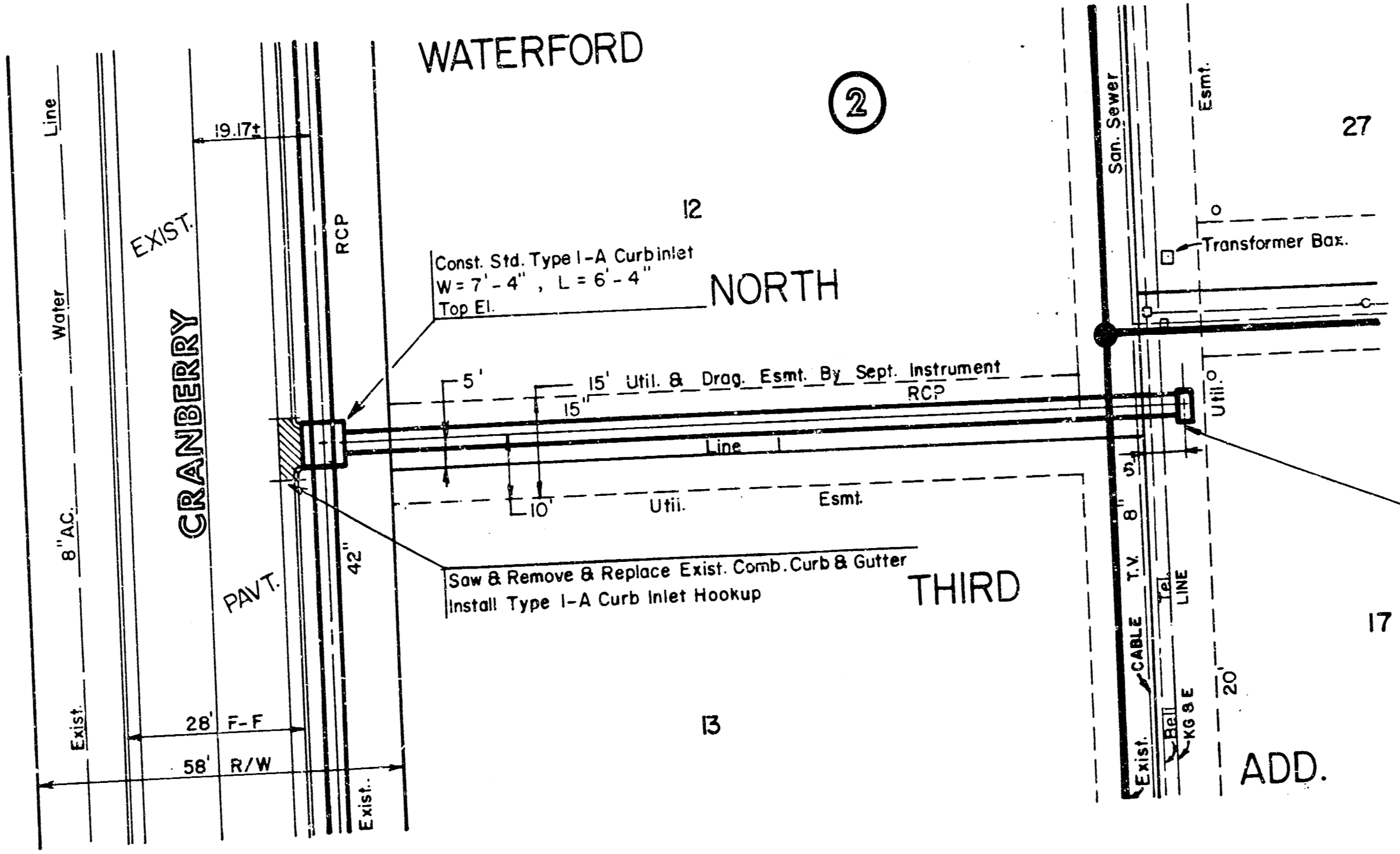

Const. Drop Inlet 4' x 2'
 W = 2'-0", L = 4'-0"
 Top Elevation = 185.0'
 Cost of Regroding & Seeding
 around Drop Inlet is Incidental
 to Project.

NOTE TO CONTRACTOR
 This project shall be constructed under the supervision of the CITY ENGINEER and conform to the SPECIFICATIONS of the CITY ENGINEER. The CONTRACTOR shall pay the cost of all materials of plant review, and shall be responsible for the construction.

Sanitary
 Date: 6-3-86



FINAL
 4-15-87
 GREENE

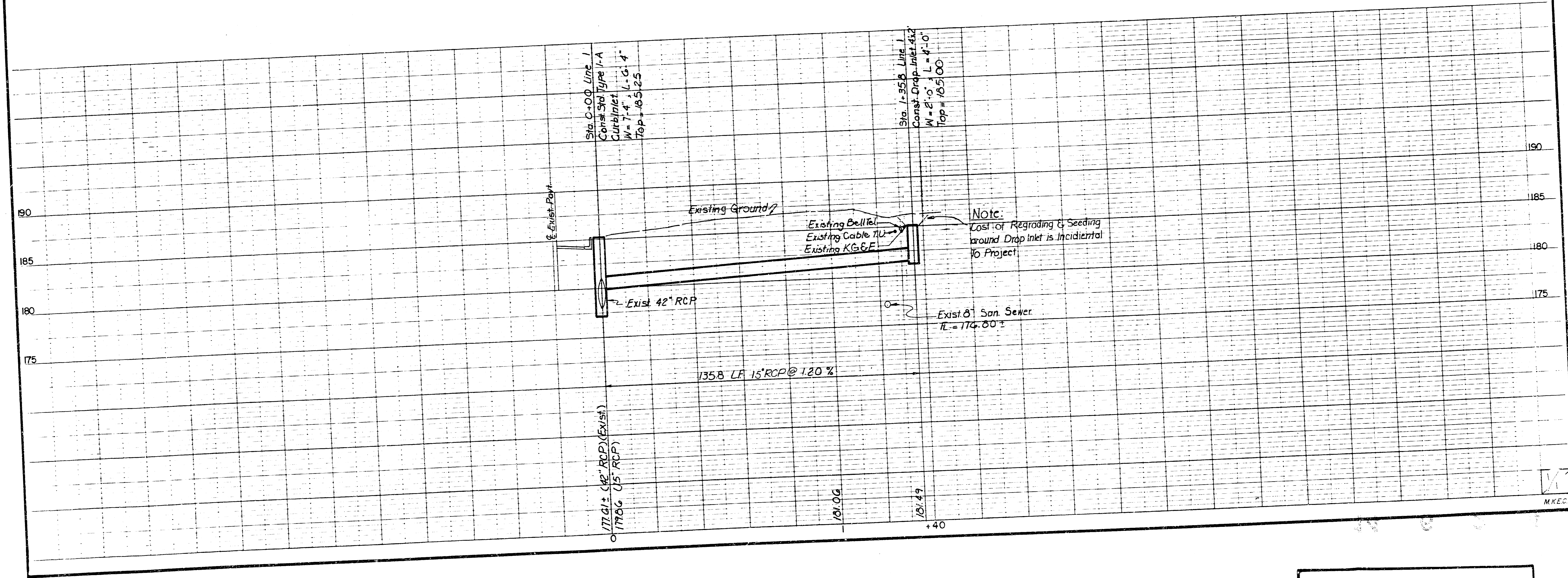

FILMED FROM THE BEST
 AVAILABLE COPY