

PAWNEE

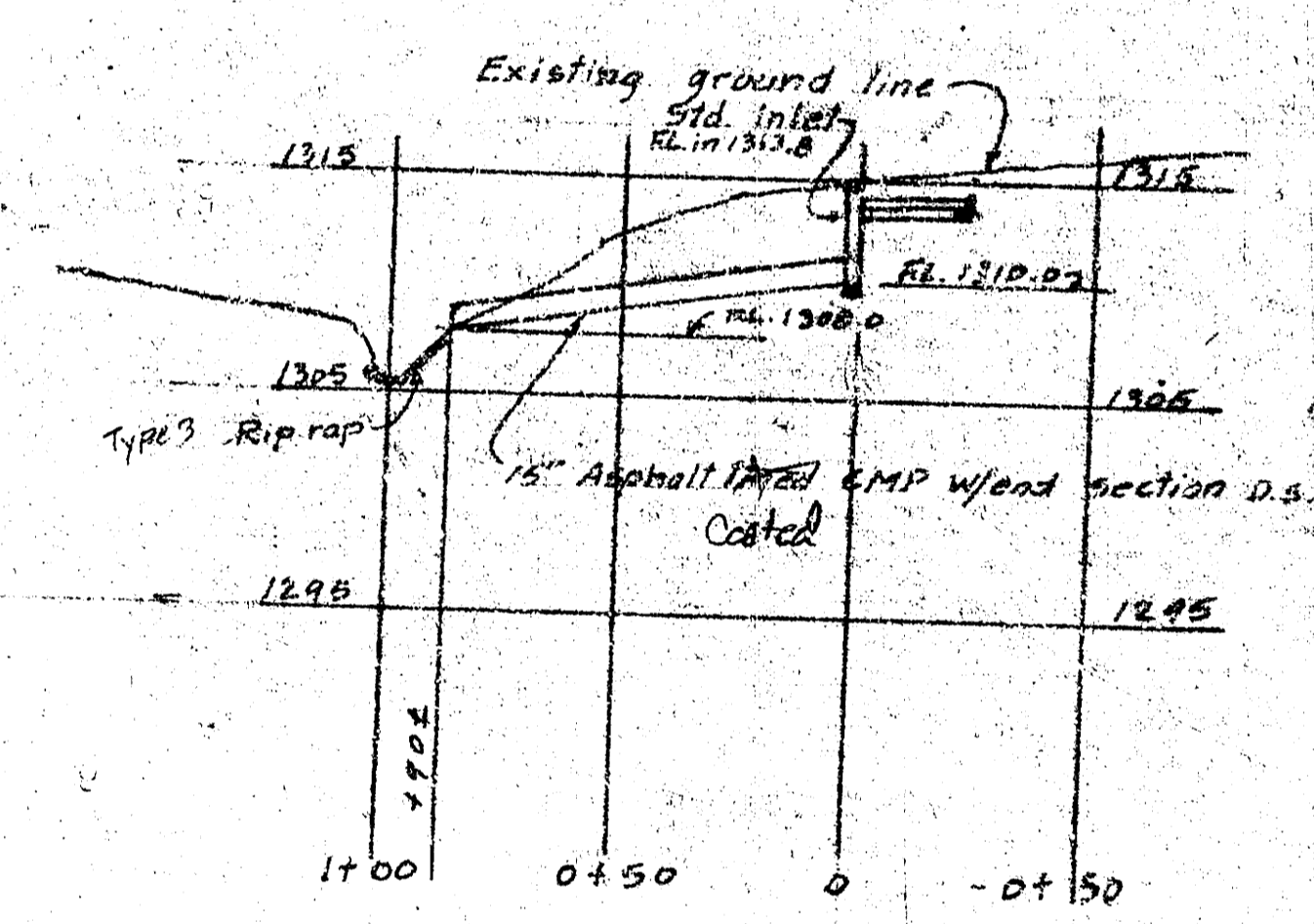
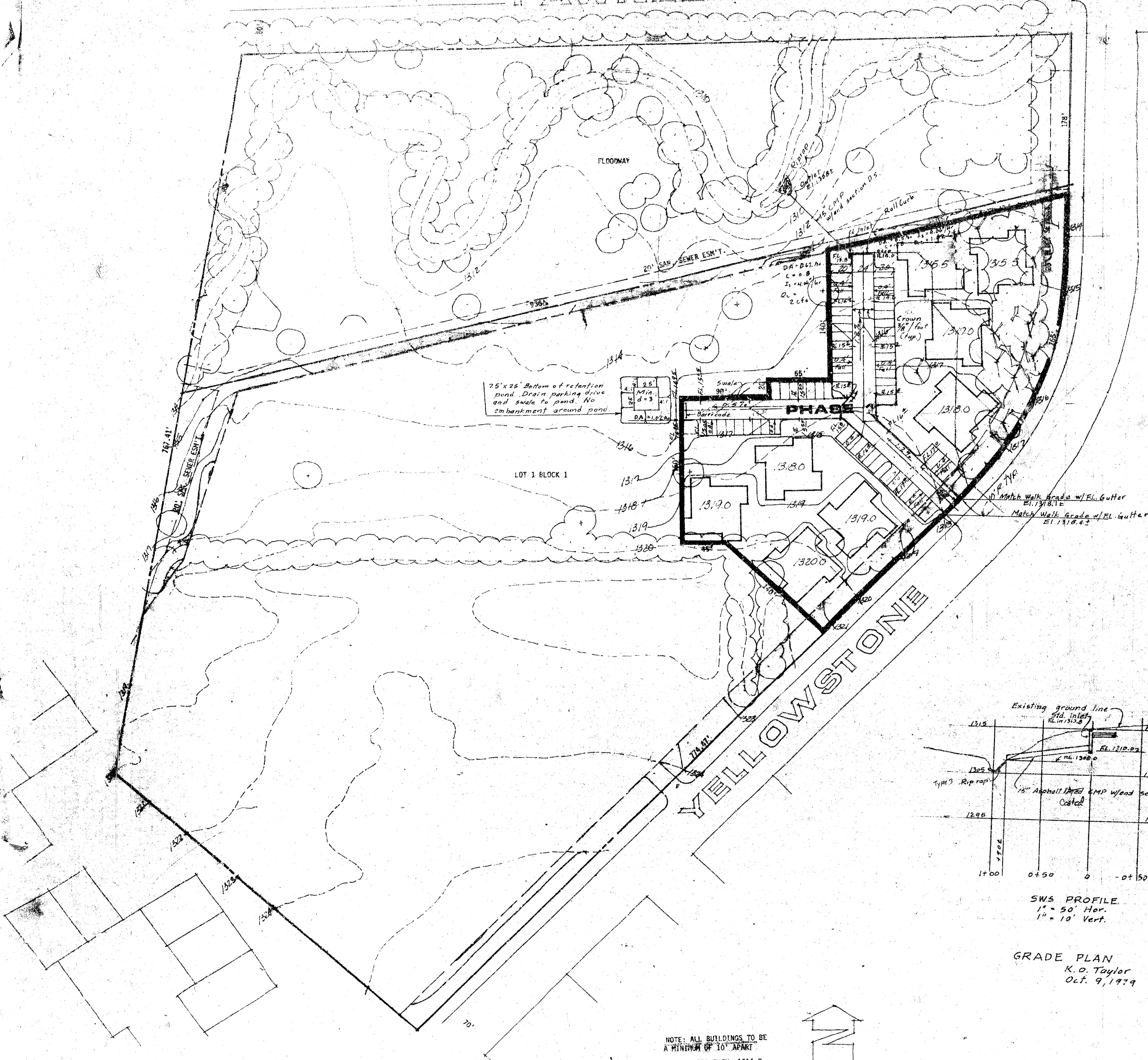

SWS PROFILE
 1" = 50' Hor.
 1" = 10' Vert.

GRADE PLAN
 K.O. Taylor
 Oct. 9, 1979

NOTE: ALL BUILDINGS TO BE
 A MINIMUM OF 10' APART
 MINIMUM PAD ELEV. 1314.0

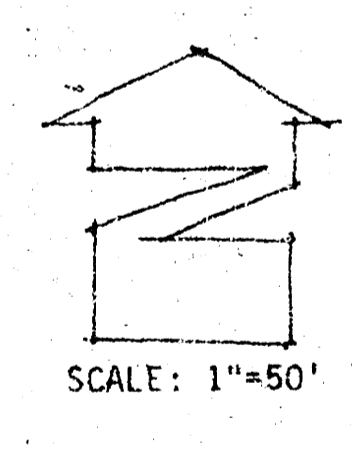

APPROVED AS NOTED
 By CITY ENGINEER OF WICHITA

Sanitary Sewers: _____
 Storm Sewers: *W. O. Taylor* 10/10/79
 Driveway Approaches: _____

NOTE TO CONTRACTOR
 This project will be constructed under the supervision of the CITY ENGINEERS and conforming to the SPECIFICATIONS of the CITY OF WICHITA. The CONTRACTOR will reimburse the City of Wichita for all cost of Engineering, Plans, and Inspection.

PRELIMINARY GRADING & SITE PLAN LOT ONE PARK ADDITION

TREEHOUSE VILLAGE

OWNER: TREEHOUSE INC., 786 N. BLOGE ROAD, WICHITA, KANSAS

DATE: SEPT. 13, 1979
 REVISED SEPT. 28, 1979

