

PLAN  
 SHEET NO. 14  
 NORTH ARKANSAS  
 PROJECT NO. 81-030-50  
 DATE: 10/1/81

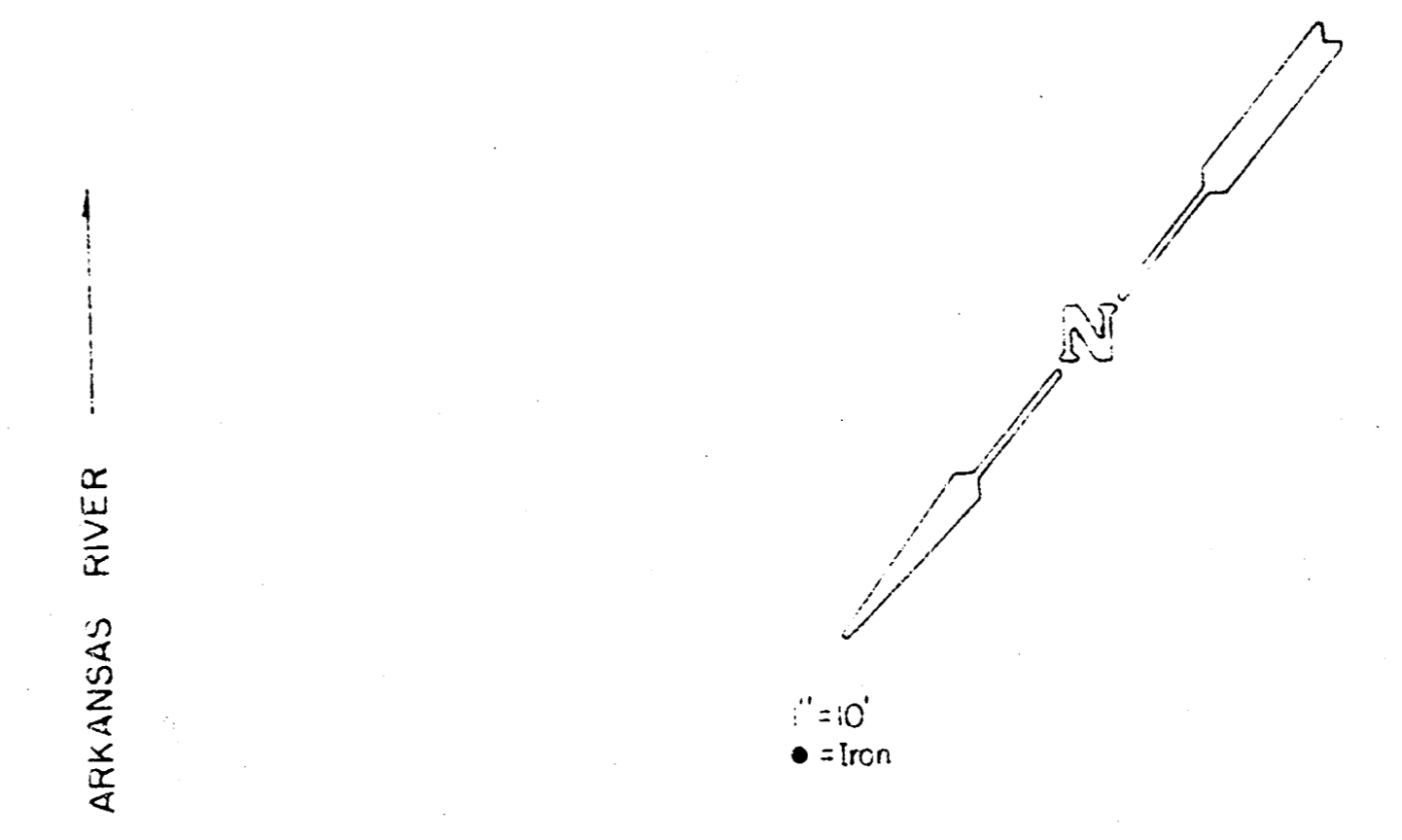

BENCH MARK: Top of Iron at S.W. Corner Lot 1,  
 Kinkaid Park 5th Addition.  
 Elev. 98.20 City Datum

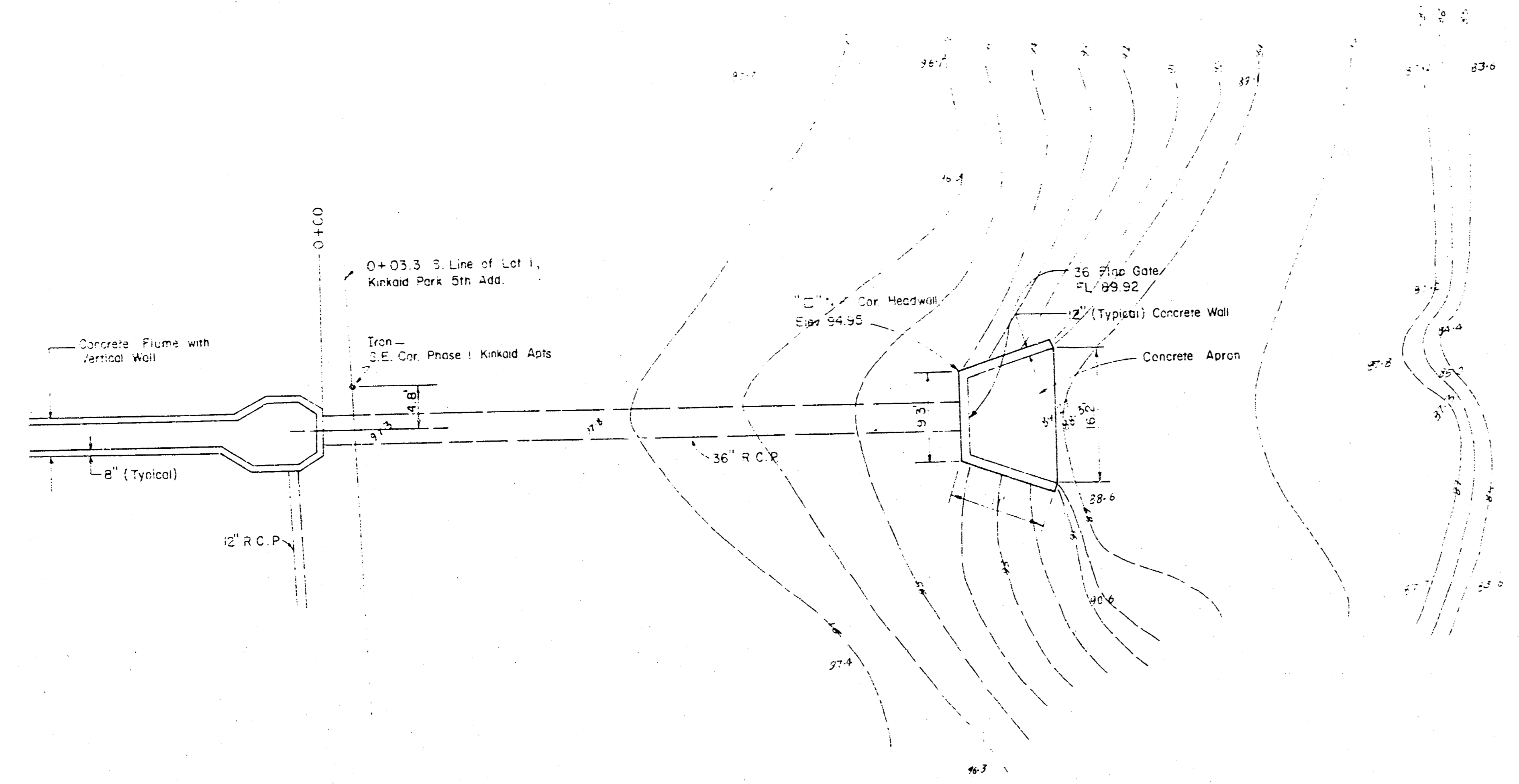
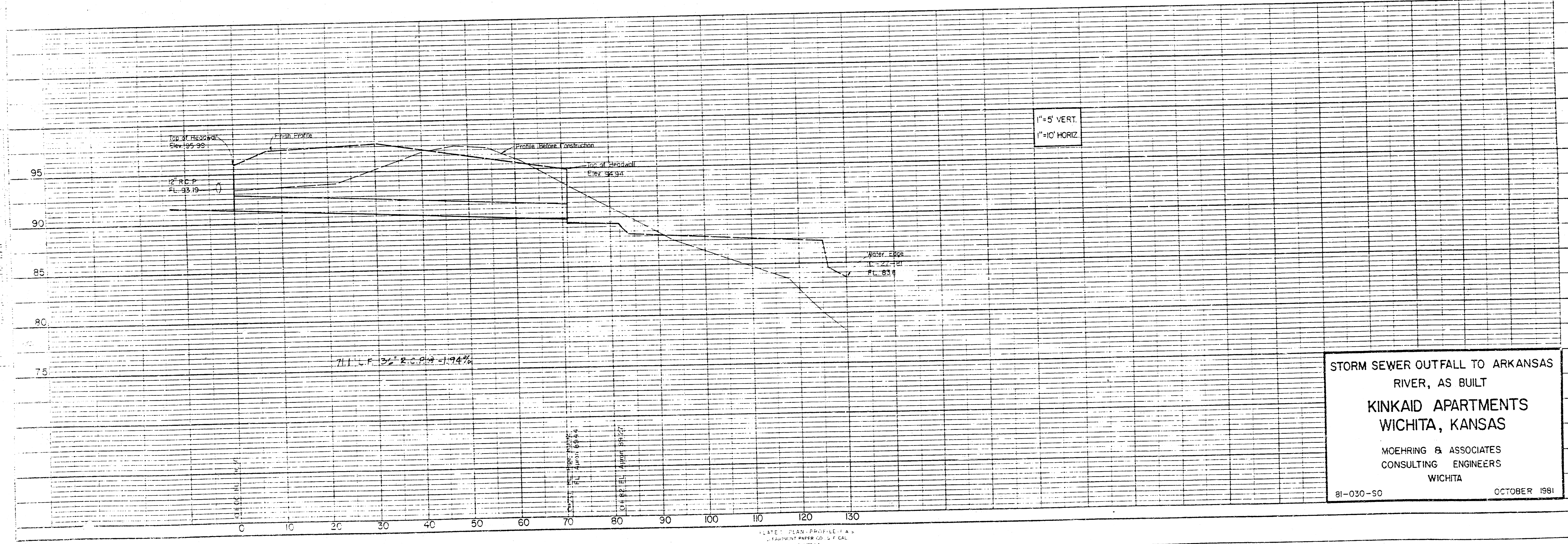

STORM SEWER OUTFALL TO ARKANSAS  
 RIVER, AS BUILT  
 KINKAID APARTMENTS  
 WICHITA, KANSAS  
 MOEHRING & ASSOCIATES  
 CONSULTING ENGINEERS  
 WICHITA  
 81-030-50      OCTOBER 1981