

PLAN
 SURVEYED
 PLANNED
 ALIGNED
 RIGHT OF WAY CHECKED
 NO.

PROFILE
 SURVEYED
 PLANNED
 ALIGNED
 RIGHT OF WAY CHECKED
 NO.

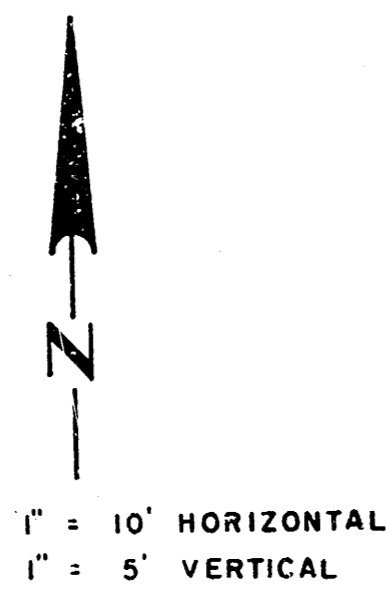

B.M. = ELEV. 137.46 - " " CUT ON TOP OF CURB BETWEEN
 DOUBLE INLET 15' NE OF THE
 P.C. IRON ON THE EAST SIDE OF PAR LANE.

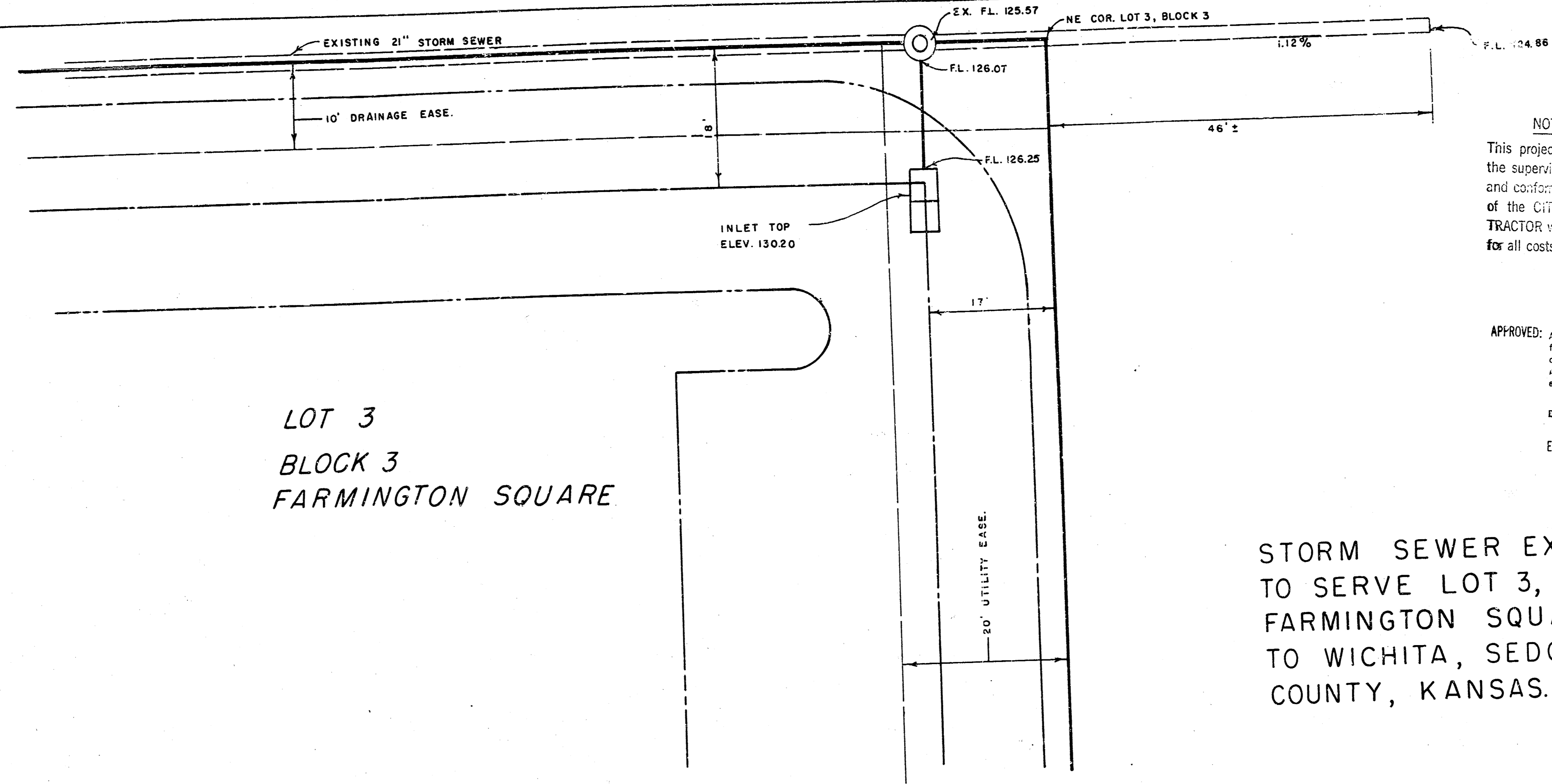

NOTE TO CONTRACTOR
 This project will be constructed under the supervision of the CITY ENGINEER and conforming to the SPECIFICATIONS of the CITY OF WICHITA. The CONTRACTOR will prepay the City of Wichita for all costs of inspection.

CITY OF WICHITA
 APPROVED: _____
 Approval does not relieve the contractor from any responsibility for the cost of deviations from the contract requirements or for any deficiencies of equipment, work, or materials.
 Date: 11/22/82
 Engineering Div. COB

**STORM SEWER EXTENTION
 TO SERVE LOT 3, BLOCK 3,
 FARMINGTON SQUARE ADDITION
 TO WICHITA, SEDGWICK
 COUNTY, KANSAS.**



NOV. 18, 1982

PRIVATE PROJECT NO.
 468-76-245-80000-000-000-008

