

APPROVED AS NOTED
 By CITY ENGINEER OF WICHITA
 Sanitary Sewers
 Storm Sewers: *Y. Wilson* 2/19/80
 Driveway Approaches

NOTE TO CONTRACTOR
 This project will be under the supervision of the City Engineer of Wichita and conforming to the City of Wichita Code. TRACTOR will need to be notified by the City Engineer of Wichita for all changes and improvements.

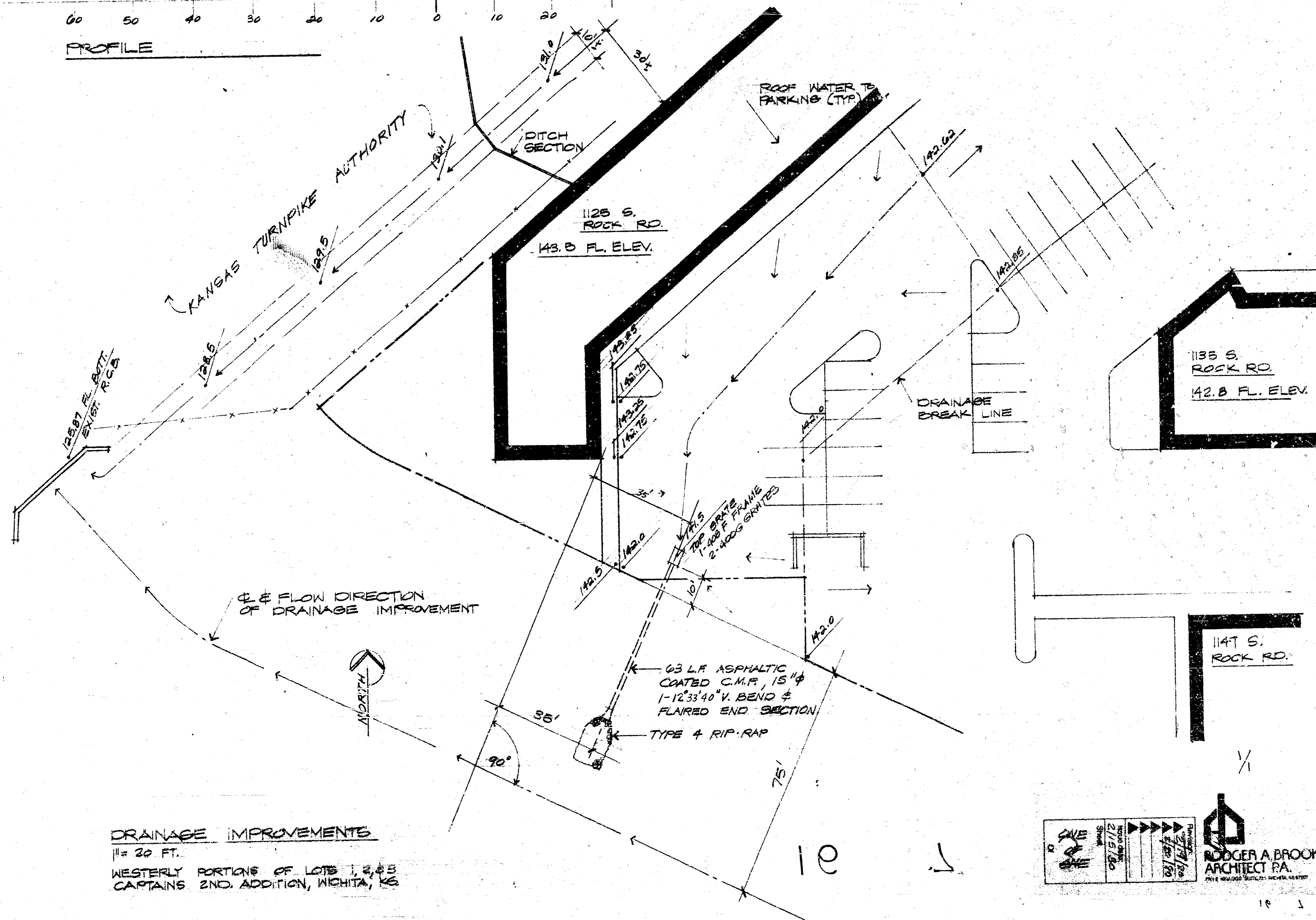

DRAINAGE IMPROVEMENTS
 1" = 20 FT.
 WESTERLY PORTIONS OF LOTS 1, 2, & 3
 CAPTAINS 2ND ADDITION, WICHITA, KS

RODGER A. BROOKS
 ARCHITECT P.A.
 2151 S. W. 10th St.
 Wichita, KS 67202
 (316) 261-1111