

BENCH MARK: Washington and 9th Street; Brass Rod in Concrete Post.
23 feet South and 37 feet East of Center Line of both. El. 112-898'

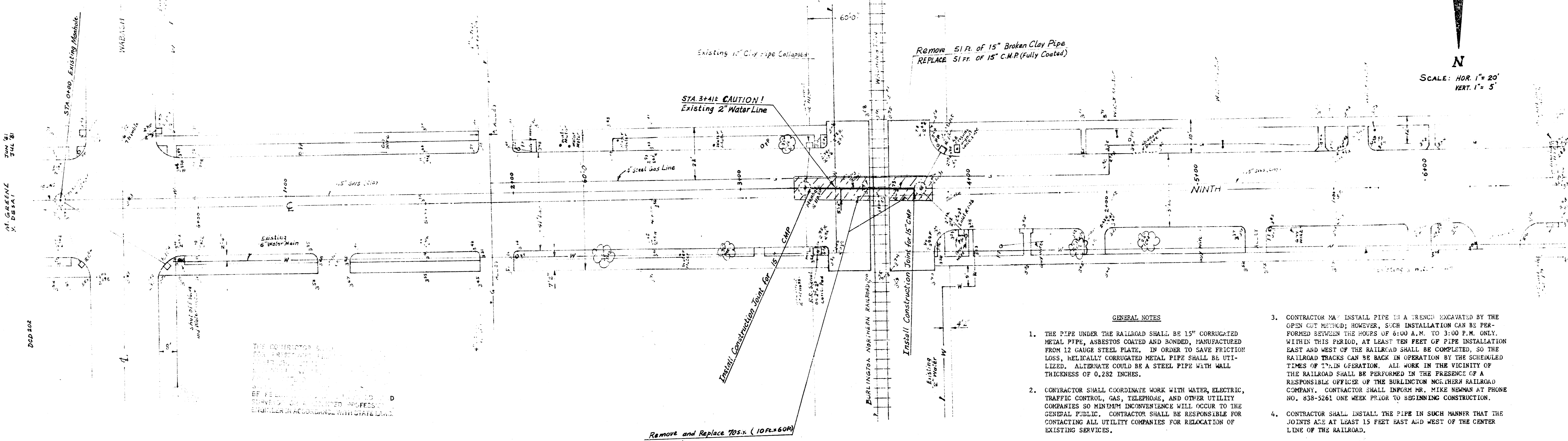
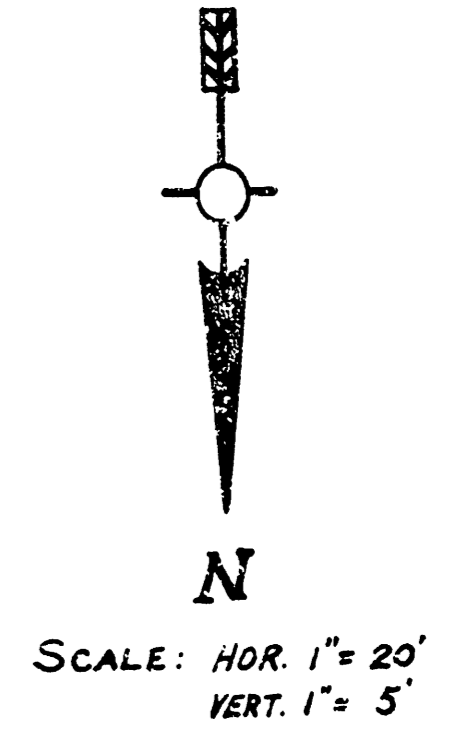

THE CONTRACTOR SHALL BE RESPONSIBLE FOR OBTAINING ALL NECESSARY PERMITS AND APPROVALS FROM THE CITY OF WICHITA AND THE BURLINGTON NORTHERN RAILROAD COMPANY. THE CONTRACTOR SHALL BE RESPONSIBLE FOR OBTAINING ALL NECESSARY PERMITS AND APPROVALS FROM THE CITY OF WICHITA AND THE BURLINGTON NORTHERN RAILROAD COMPANY.

GENERAL NOTES

1. THE PIPE UNDER THE RAILROAD SHALL BE 15" CORRUGATED METAL PIPE, ASBESTOS COATED AND BONDED, MANUFACTURED FROM 12 GAUGE STEEL PLATE. IN ORDER TO SAVE FRICTION LOSS, HELICALLY CORRUGATED METAL PIPE SHALL BE UTILIZED. ALTERNATE COULD BE A STEEL PIPE WITH WALL THICKNESS OF 0.282 INCHES.
2. CONTRACTOR SHALL COORDINATE WORK WITH WATER, ELECTRIC, GAS, TELEPHONE, AND OTHER UTILITY COMPANIES SO MINIMUM INCONVENIENCE WILL OCCUR TO THE GENERAL PUBLIC. CONTRACTOR SHALL BE RESPONSIBLE FOR CONTACTING ALL UTILITY COMPANIES FOR RELOCATION OF EXISTING SERVICES.
3. CONTRACTOR MAY INSTALL PIPE IN A TRENCH EXCAVATED BY THE OPEN CUT METHOD; HOWEVER, SUCH INSTALLATION CAN BE PERFORMED BETWEEN THE HOURS OF 6:00 A.M. TO 3:00 P.M. ONLY. WITHIN THIS PERIOD, AT LEAST TEN FEET OF PIPE INSTALLATION EAST AND WEST OF THE RAILROAD SHALL BE COMPLETED, SO THE RAILROAD TRACKS CAN BE BACK IN OPERATION BY THE SCHEDULED TIMES OF TRAIN OPERATION. ALL WORK IN THE VICINITY OF THE RAILROAD SHALL BE PERFORMED IN THE PRESENCE OF A RESPONSIBLE OFFICER OF THE BURLINGTON NORTHERN RAILROAD COMPANY. CONTRACTOR SHALL INFORM MR. MIKE NEWMAN AT PHONE NO. 838-5261 ONE WEEK PRIOR TO BEGINNING CONSTRUCTION.
4. CONTRACTOR SHALL INSTALL THE PIPE IN SUCH MANNER THAT THE JOINTS ARE AT LEAST 15 FEET EAST AND WEST OF THE CENTER LINE OF THE RAILROAD.

105.0
110.0
115.0
120.0

105.0
110.0
115.0
120.0

0+00 1+00 2+00 3+00 4+00 5+00

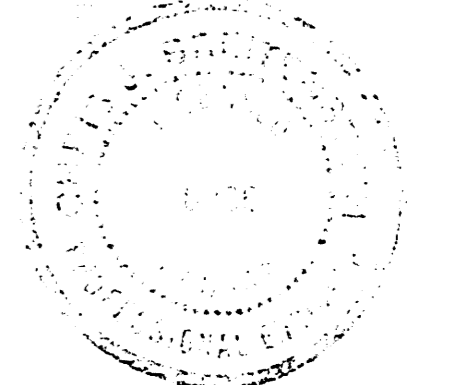

CITY OF WICHITA KANSAS
R.W. BRUGGEMAN, DIRECTOR OF ENGINEERING/CITY ENGINEER
STORM WATER SEWER RECONSTRUCTION
NINTH STREET AT WASHINGTON AVE.
(under Burlington Northern Railroad Track.)
PROJ. NO.: 468-76-245-81105-000-000-001
DATE: 6/00 SHEET NO. 1/1