

W.C. Blockley to E.C. Batten

26.2-30 Conc.

B.M. Elev 179.10 Iron N.W. cor Pinecrest & 1st

Walk grade is 1" above curb

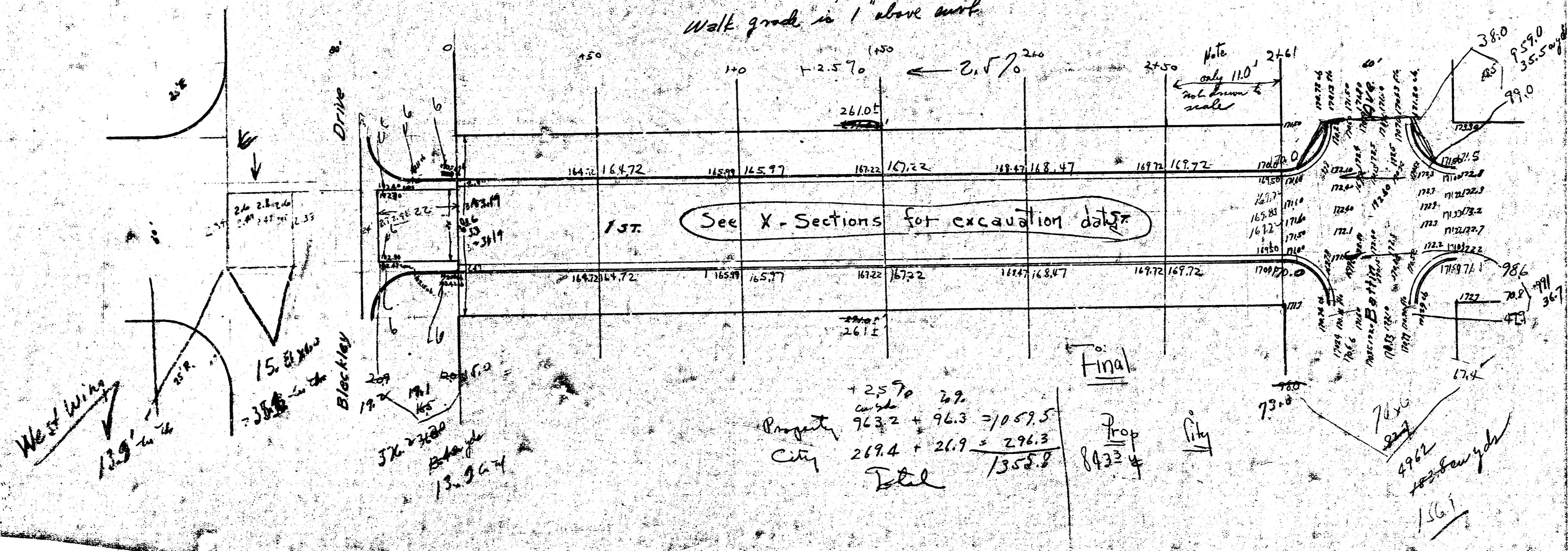

1st. See X-Sections for excavation data

Final  
 Prop City  

$$\begin{array}{r} +25.70 \quad 26.9 \\ \text{Property} \quad 763.2 + 96.3 = 1059.5 \\ \text{City} \quad 269.4 + 26.9 = 296.3 \\ \hline \text{Total} \quad 1355.8 \end{array}$$
 8432.4

156.1