



BASE LINE - 20.0' N. and S. of

NOTE: NO TREES ARE TO BE REMOVED unless specifically designated on plan.

3 M. 1190' N.E. Cor. 1/4' Cont. Sec. House S.W. Corner 2ND and GROVE  
B.M. 12195 A.E. N 25.09 East 2ND STREET.



NOTE: The exact limits of removal of side streets shall be determined by the engineer, consistent with existing joint locations. Any combined curb & gutter that is 3' in width is to be paid as bid price for 1/2" combined curb and gutter.

**\*\* THIMBLES \*\***  
Field Engineer to take ties to all thimbles destroyed by new construction. To place iron and install thimble in new pavement.

**\*\* SIDEWALKS \*\***  
sidewalks are to be constructed as necessary, both sides, entire length project. Existing walks are to remain in place during street construction. Any existing walks that are to be removed will be determined by the field engineer.

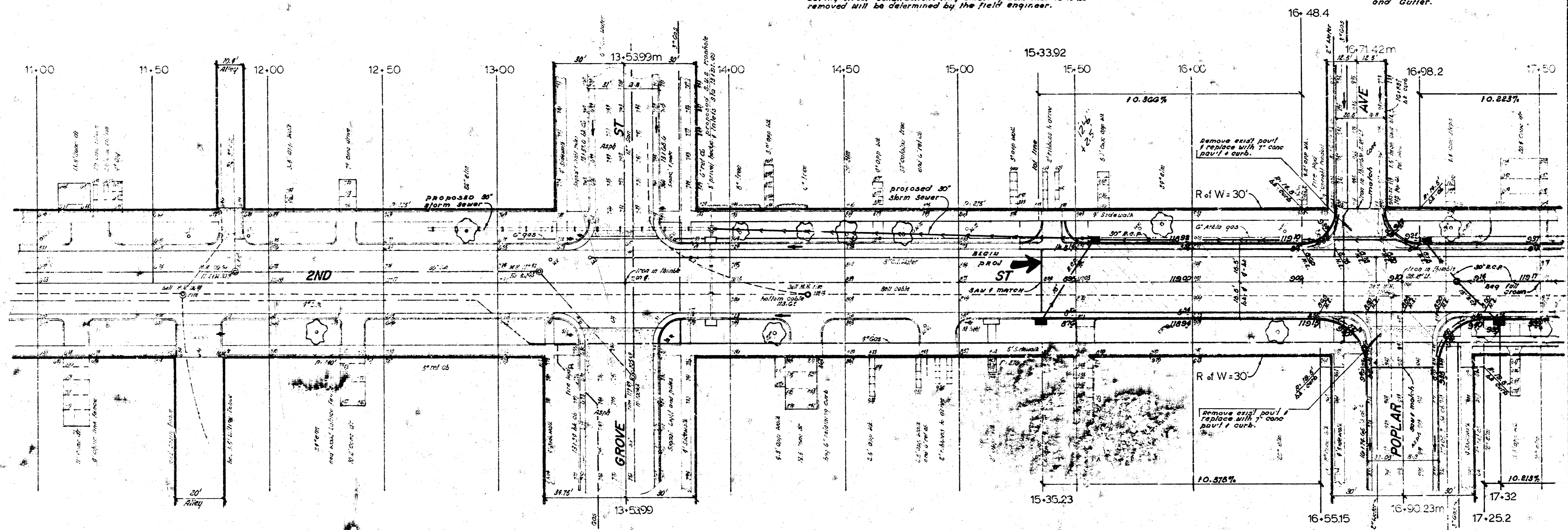

Survey Plots  
Plan sheet  
Exc. sheet  
City sheet

**GENERAL NOTES**  
All salvaged material shall be disposed of as directed by the engineer. Broken concrete and other non-combustible debris shall be disposed of at a time and dump site that is acceptable to the superintendent of public works maintenance, city of Wichita.  
Any new drive locations shown on plans are tentative and must be approved by property owners. All Alley entrances are to be paved with 7" concrete pavement.

**\*\* ACCESS \*\***  
This project is to be co-ordinated with the paving and drainage projects on FIRST STREET - 185 West W.L. POPLAR to W.L. HILLSIDE in such a manner that vehicular access will be provided at all times to the portions of streets from FIRST to Second St. between GROVE and HILLSIDE.

EARTH WORK	
--EXCAVATION--	
PROPERTY	CITY
410.3 cu yds	136.0 cu yds
110% \$12.00	110% \$8.00
491.3 cu yds	147.0 cu yds

NOTE: Type of SUBGRADE TREATMENT shall be determined by the field engineer. Subgrade treatment may consist of lime treatment, cement treatment, sub grade modification, or any combination of these.

**SECOND STREET**  
125' West W.L. POPLAR AVENUE to  
W.L. HILLSIDE AVENUE.  
**CITY OF WICHITA, KANSAS**  
(26'-2'-30" Asphaltic Concrete)  
R.W. LINN CITY ENGINEER  
DATE Proj. No. DAKM573002

2/12

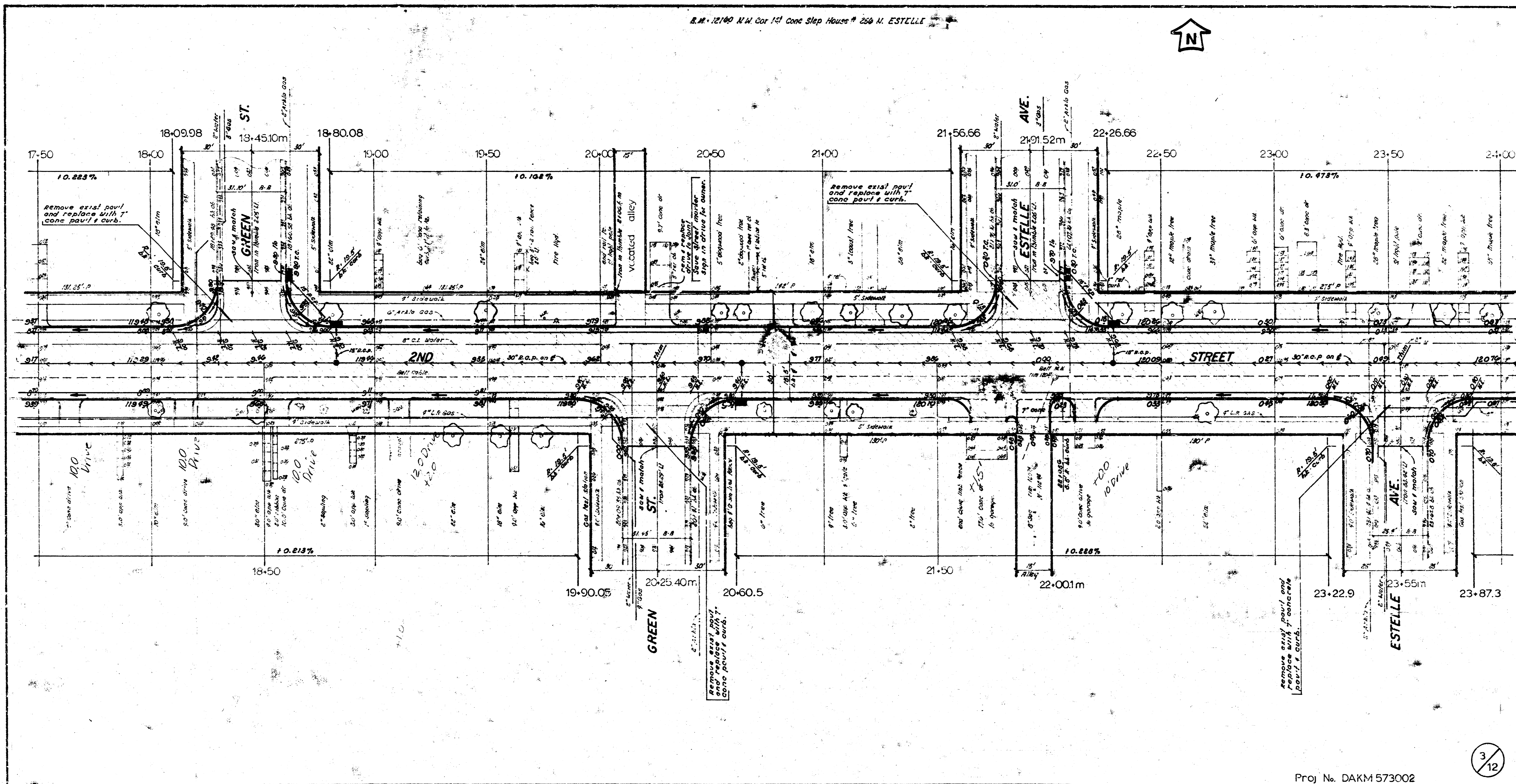

4-E  
1-11

R.M.: 126 1/2 N.W. Cor 1st Stop House # 2901 E. 2ND STREET.

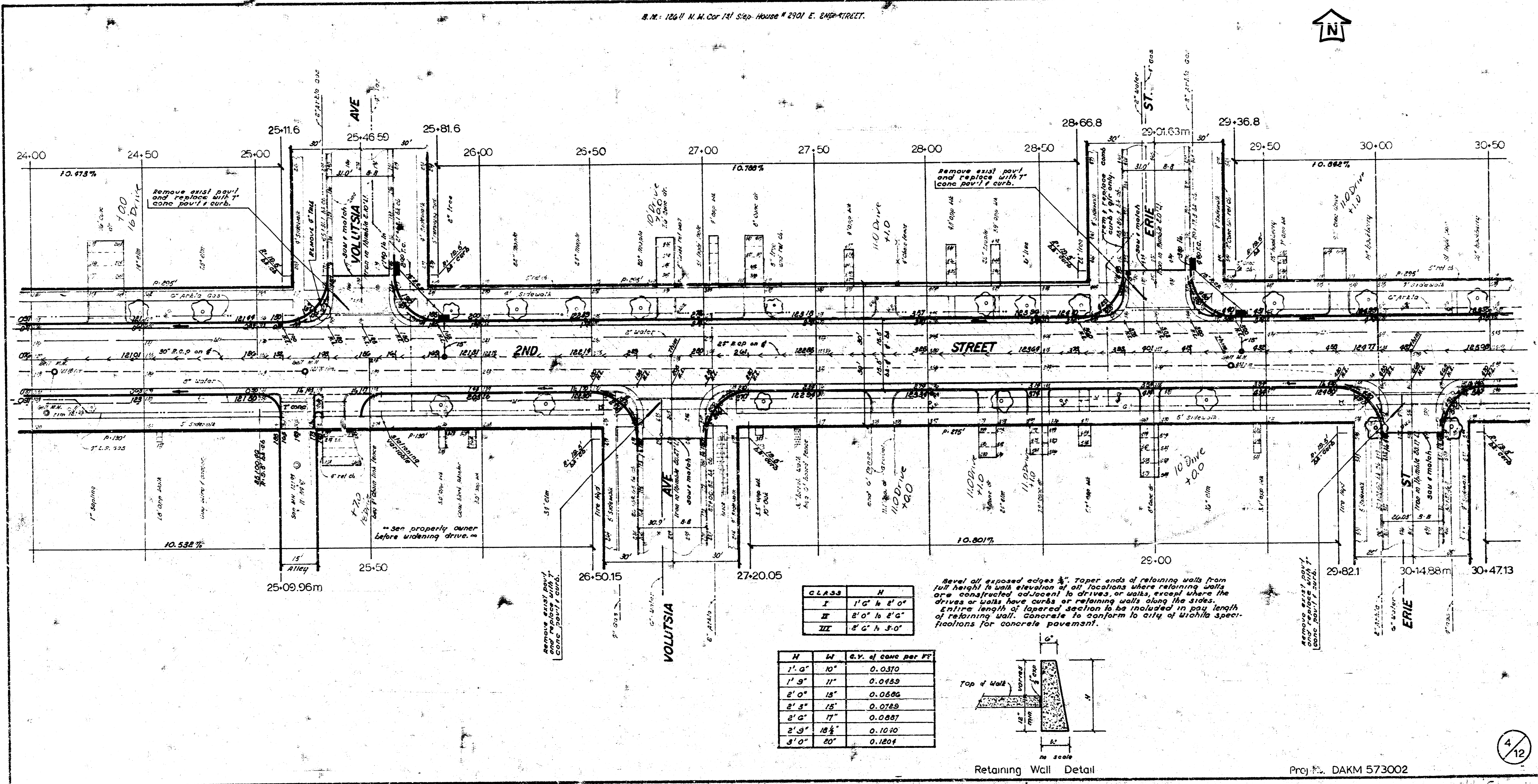

CLASS	H
I	1' 0" h 2' 0"
II	2' 0" h 4' 0"
III	4' 0" h 5' 0"

Bevel all exposed edges 1/4". Taper ends of retaining walls from full height to walk elevation at all locations where retaining walls are constructed adjacent to drives or walks except where the drives or walks have curbs or retaining walls along the sides. Entire length of tapered section to be included in pay length of retaining wall. Concrete to conform to city of Wichita specifications for concrete pavement.

H	Lt	C.Y. of conc per FT
1' 0"	10"	0.0370
1' 9"	11"	0.0433
2' 0"	12"	0.0500
2' 3"	15"	0.0725
2' 6"	17"	0.0837
2' 9"	18 1/2"	0.1020
3' 0"	20"	0.1204

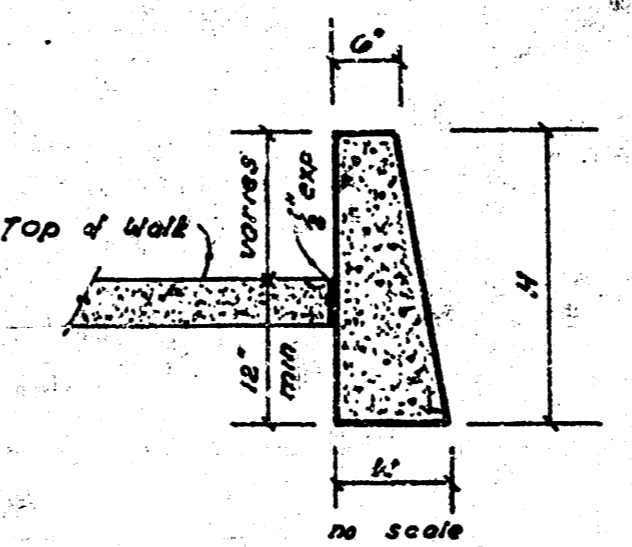

Retaining Wall Detail

Proj. No. DAKM 573002

R.M. 12959 N.E. Corner 1st conc. stop House # 3001 E. 2nd STREET.  
R.M. 12875 S.W. Corner 3110 E. 2nd STREET.

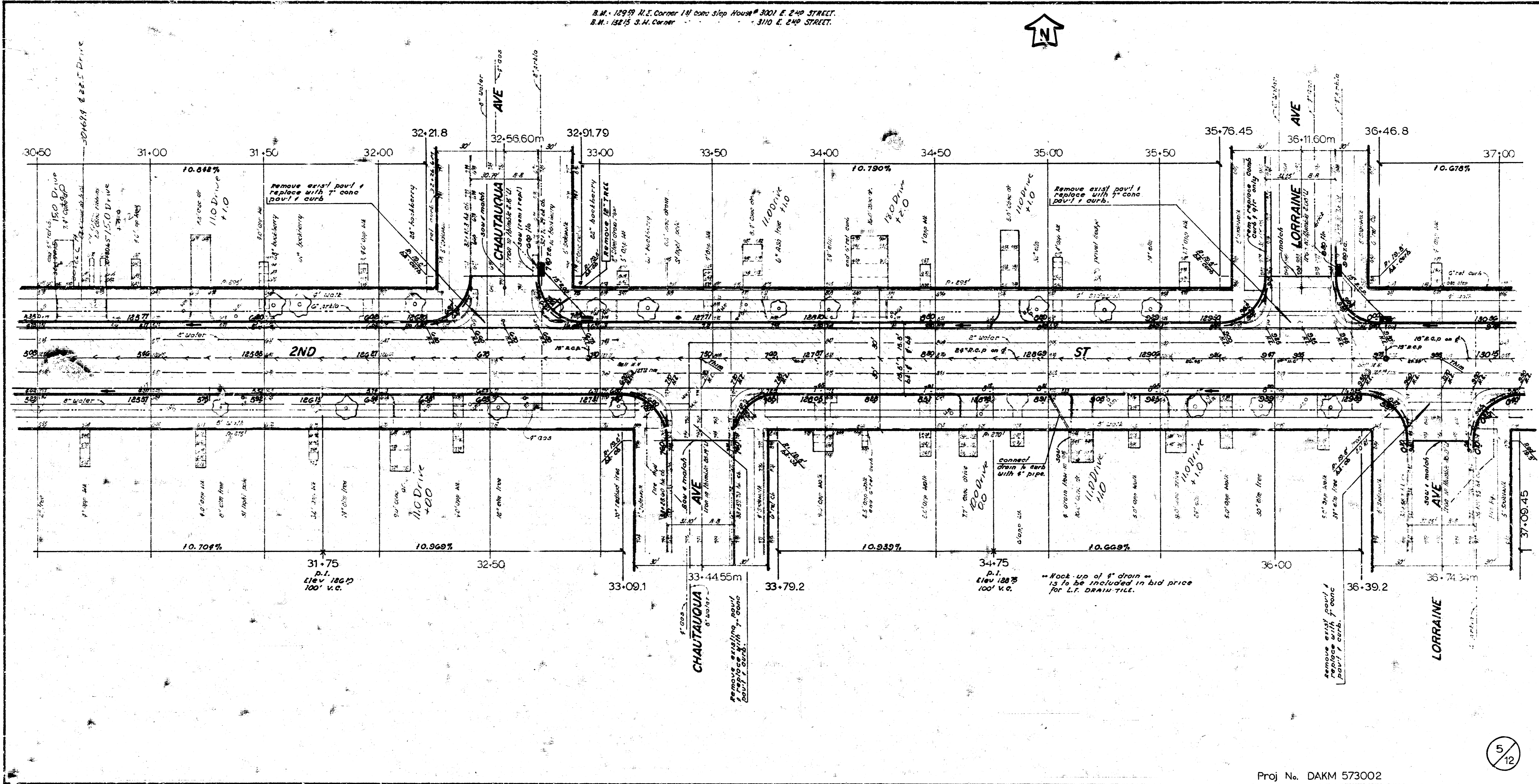

5/12

Proj. No. DAKM 573002

