

1942
 EIGHTH ST. - E.L. OLIVER to W.L. BATTIN
 C.B. & G.T.R.

Note: - Mills

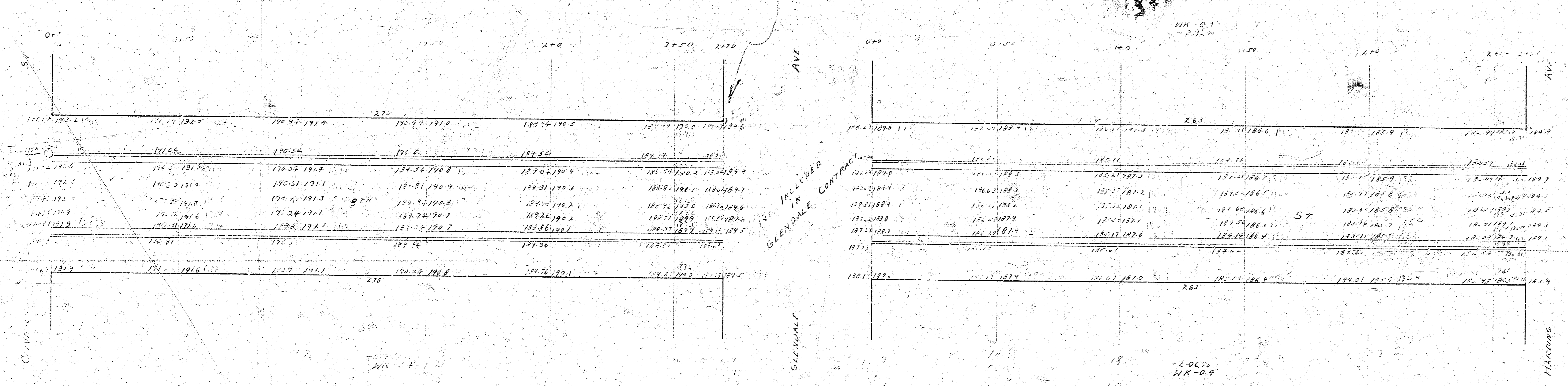

B.M. 1935 - 1800 N.W. COR. GLENDALE - 4' 0"
 Note: This is a copy of the original plan for 1942. The original plan was destroyed in the fire of 1942. The distances were measured from the original plan and the bearings were taken from the original plan. The original plan was destroyed in the fire of 1942. The distances were measured from the original plan and the bearings were taken from the original plan. The original plan was destroyed in the fire of 1942. The distances were measured from the original plan and the bearings were taken from the original plan.