

BM 20145 "X" on S. Ch. E.L. Crestway 51.92'
BM 20145 "N" on Top Ch. Ctr. of Radius N.E. Cor. 8th & Crestway

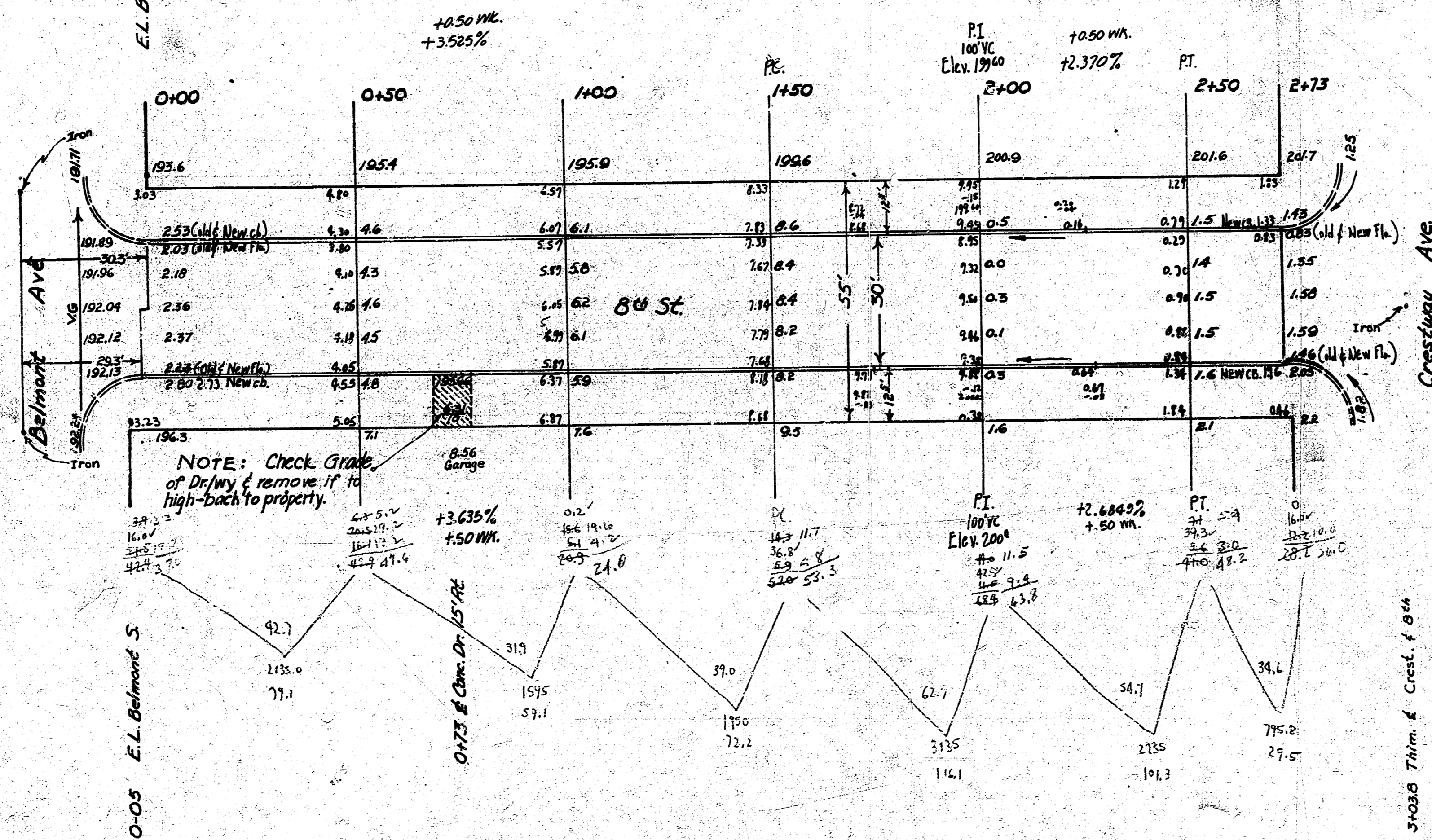

Property
79.1
59.1
72.2
114.1
181.0
29.5
457.5
45.7
503.0
+10%
Total Cu. Exemption

EIGHTH ST.
E.L. Belmont - W.L. Crestway
30' C & Cb
CITY OF WICHITA KANS.
L.K. White City Engineer
Jan. 1951 Proj. No. C-10-195

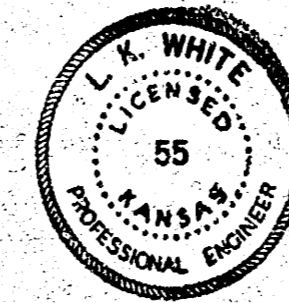

9 clws