

N 1/2 + S 1/2 10TH STREET
 L. L. WOODLAWN TO W. L. ARMOUR LN.
 PROJ. NOS. 318-121 & 318-21

CURVE DATA IS BASED ON S.P.L. R=248.42 A=28°13'30"				
STATIONING	CHORD FACE S.C.	CHORD RAD. IN FEET	DEF. 2'	TOTAL DEF.
14+00.00	0.00	248.42	0.00	0.00
14+25.00	25.00	248.42	3.45	3.45
14+50.00	50.00	248.42	13.81	17.26
14+75.00	75.00	248.42	28.59	45.85
15+00.00	100.00	248.42	47.84	93.69
15+25.00	125.00	248.42	71.59	165.28
15+50.00	150.00	248.42	99.84	265.12
15+75.00	175.00	248.42	132.59	397.71
16+00.00	200.00	248.42	169.84	567.55

Deflection Per 100' of Curve = 0.84%

NOTE TO FIELD ENGINEER:
SEE NOTES AND SPECIFICATIONS FOR FILL. ENGINEER
TO BE CROSSSECTION BEFORE CONSTRUCTION
GRADE REFERENCE WITH BLUE CLIPS

NOTE TO FIELD ENGINEER + CONTRACTOR:
DUE TO SUBSOIL CONDITIONS ENGINEER IS TO
DETERMINE PROPER DEPTH OF EXCAVATION TO INSURE
STABILITY. CONSTRUCTION TO BE OF STANDARD CONCRETE
ENGINEER TO BE CROSSSECTION BEFORE CONSTRUCTION.

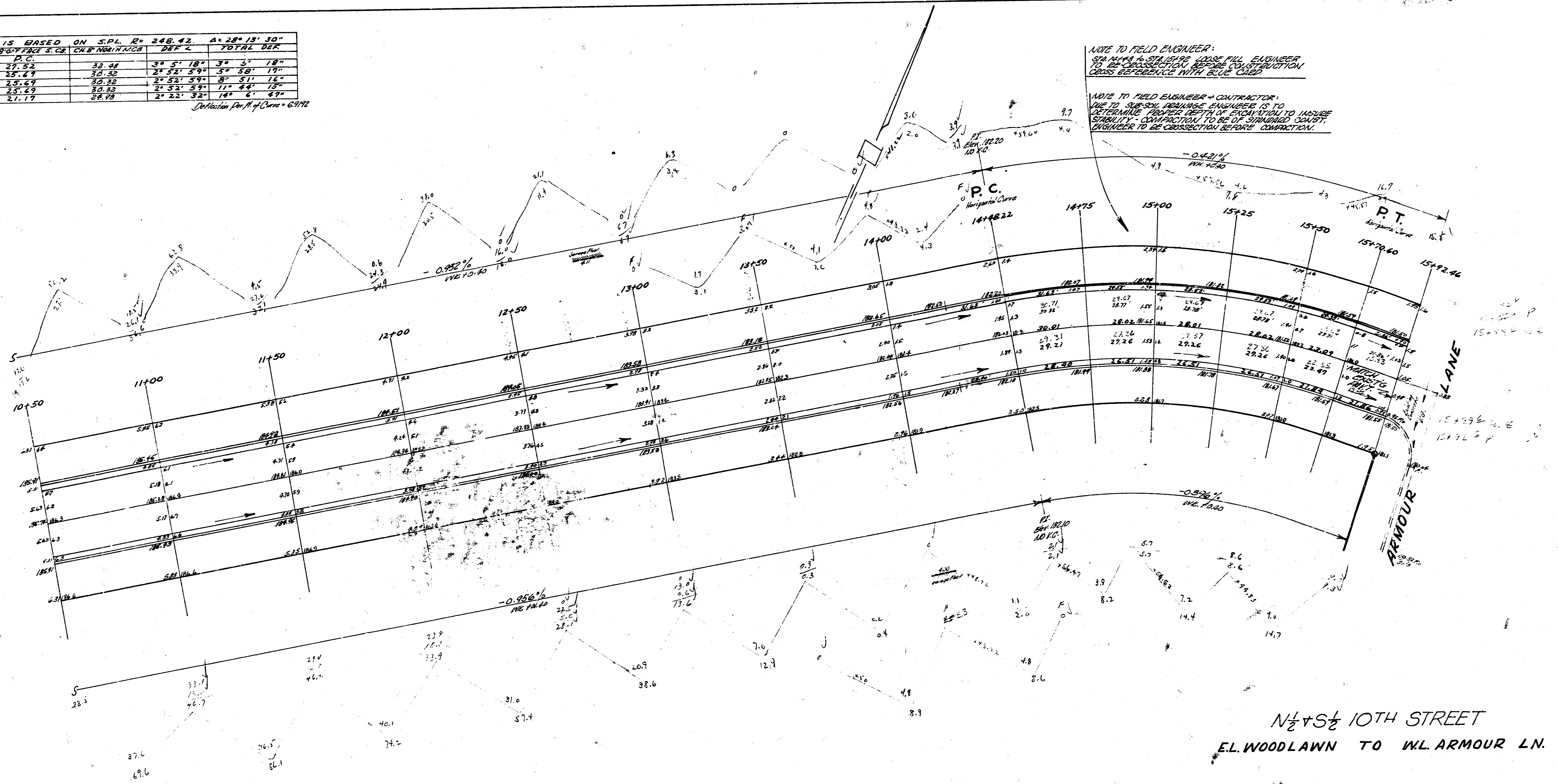

N 1/2 S 1/2 10TH STREET
E.L. WOODLAWN TO W.L. ARMOUR LN.