

B.M. 122.72 "G" in Globe W. cb Hood 5' S. 20th

B.M. 126.87 S.E. Cor. Conc. Porch Ho[#] 1124 20th

B.M. 122.53 "G" in Globe on W. end of cb. Rod. N.W. cor Salina 20th

Ties To Iron P.L. Hood E. 20th
1. 42.14' S.E. To S.W. cor. Porch Ho[#] 2102 Hood
2. 43.54' S.E. To N.W. cor. Ho[#] 2056 Hood
3. 54.63' S.W. To "G" in Globe W. cb Hood S.L. 20th

Ties To Iron S. of Payne E. of 20th
1. 75.66' S.E. To N.W. cor. Ho[#] 2056 Payne
2. 68.09' S.E. To S.W. cor. of same same Ho[#] 1124 20th
3. 76.04' N.W. To S.E. cor. of tower same Ho[#] 2101 Payne

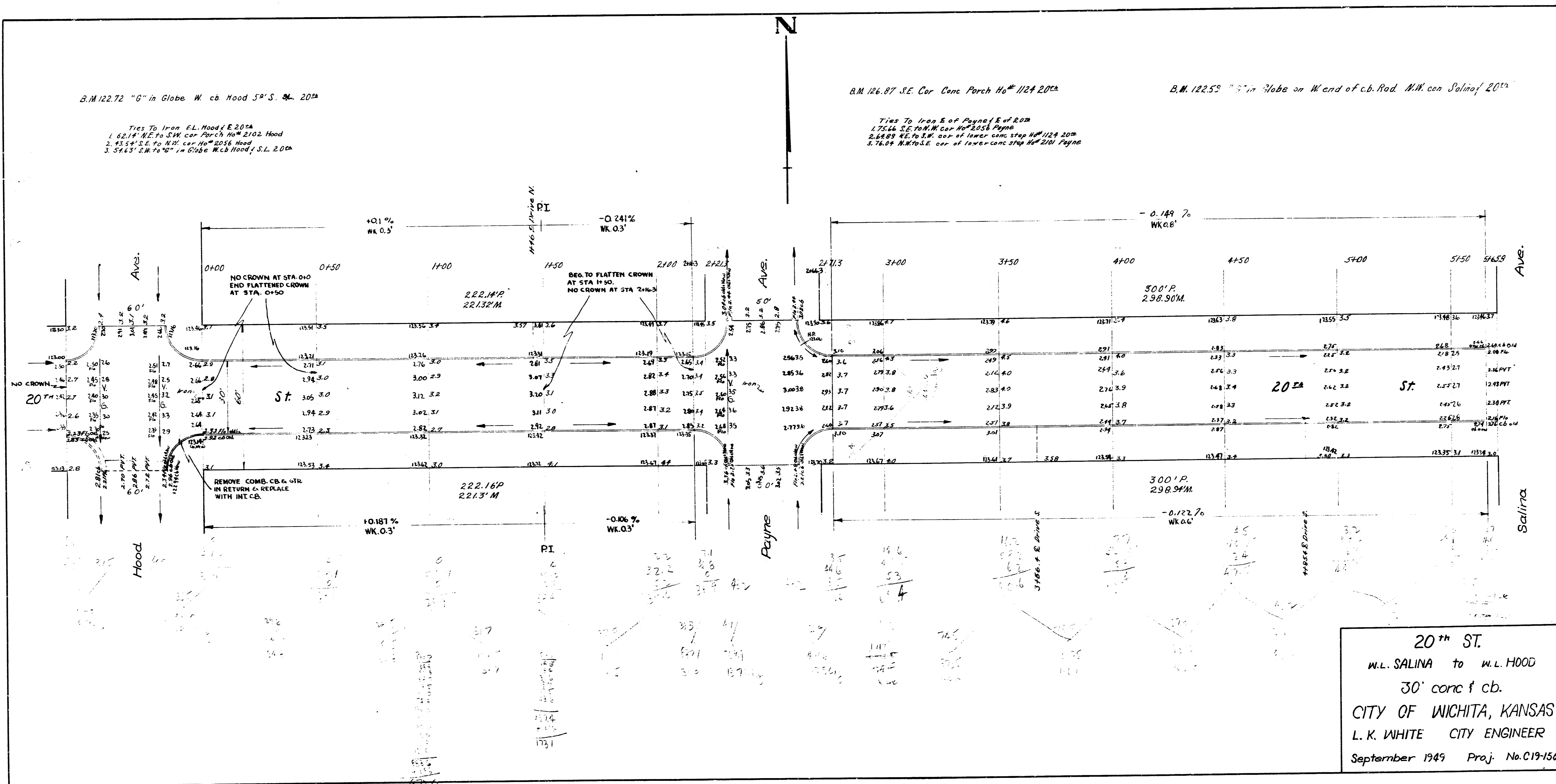

20th ST.
W.L. SALINA to W.L. HOOD
30' conc f cb.
CITY OF WICHITA, KANSAS
L. K. WHITE CITY ENGINEER
September 1945 Proj. No. C19-156