

B.M. 12127 60" SPIKE SW. SIDE LIGHT POLE NW. 17TH & WOODROW

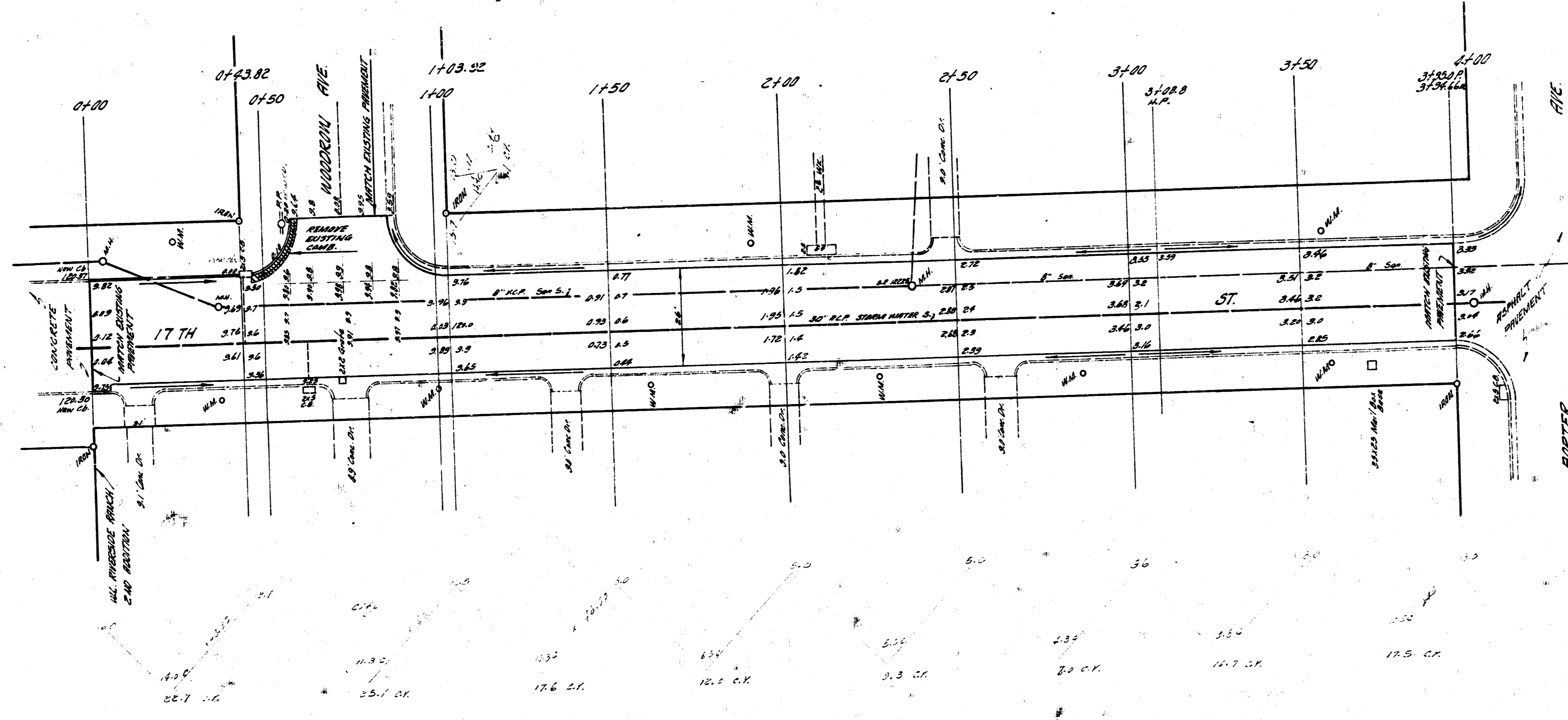

Survey Made by
 E.C. Culp
 Checked by
 L. H. ...

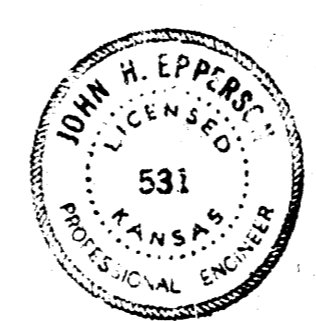

Excavation

Prop	0.4
47.8 CK	34.2 CF
17.6 CK	14.7 CF
	37.6 CF

17 TH ST.
 W.L. RIVERSIDE RANCH TO W.L. PARTER
 2ND ADDITION
 26' CONC.
 CITY OF WICHITA, KANSAS
 B. E. SMITH, CITY ENGINEER
 APRIL 1959 PROJ. NO. C-13-57