

BM 117.29 "x" cut in Top CB @ E. end of Road on SE Cor of 12<sup>th</sup> & Spruce.  
 BM 116.75 "G" in Globe on CB @ W. end of Road on SW Cor. of 12<sup>th</sup> & Madison  
 BM 121.06 "M" in Neulle: Top of Fire Hydrant on N.W. Cor of 12<sup>th</sup> & Grove  
 Base Line is E of 12<sup>th</sup> St.

SCALE 1"=20'

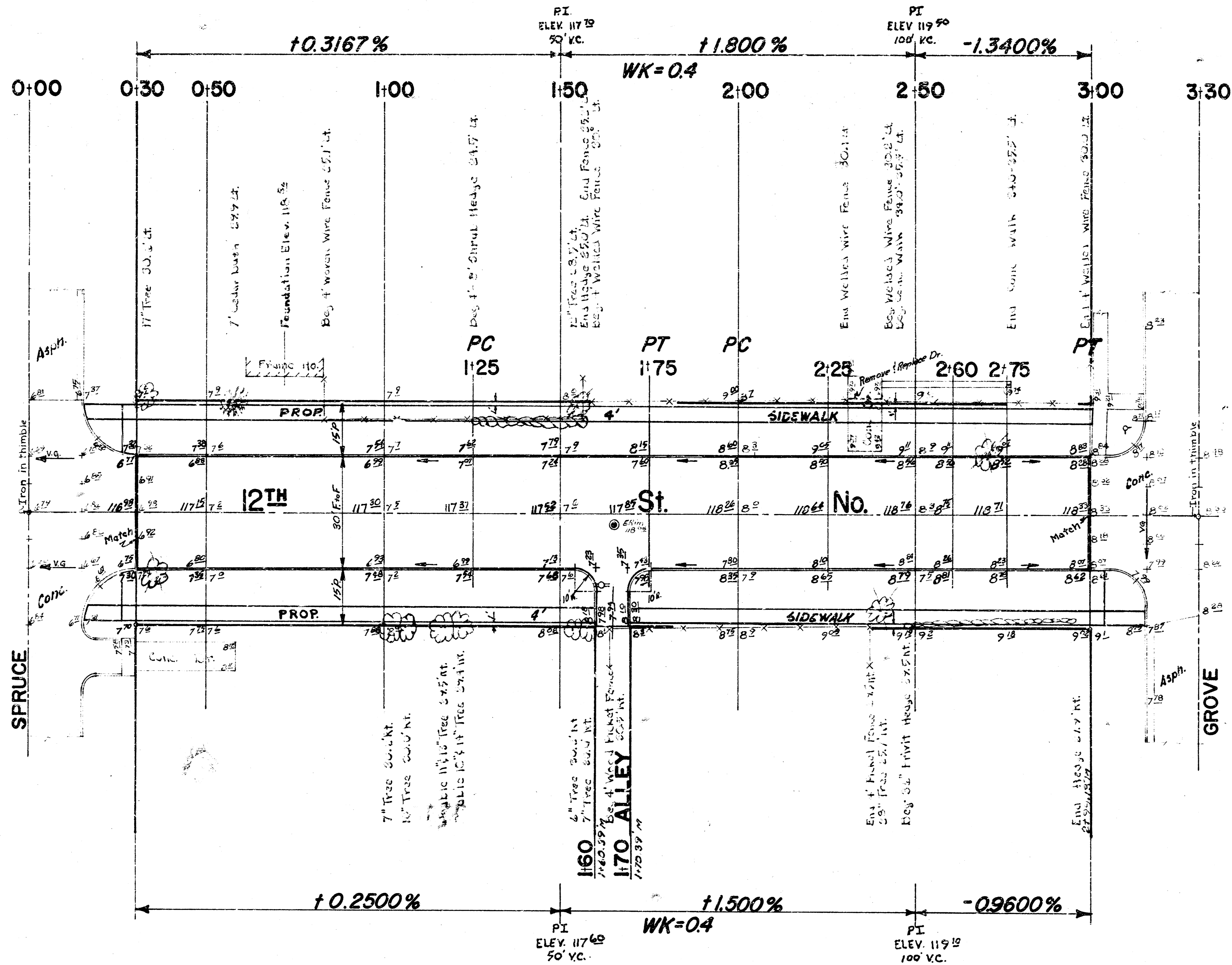

General Notes:

1. Excess excavated material to be used on Murdock Street Proj. C10-24.
2. This project is to be coordinated with projects C10-10, C10-11, C10-9 and C10-24.
3. Excavation from Sidewalk project can be used for parking fill on all street projects.

**"EARTHWORK QUANTITIES"**

EXCAVATION			COMP. FILL			SGM		
CITY	CUBIC YARDS	PROP	CITY	CUBIC YARDS	PROP	CITY	CUBIC YARDS	PROP
5.6		179.2	0.0		3.7	5.6		151.3
.6	± 10 %	17.9	.0	± 10 %	.4	.6	± 10 %	15.1
6.4	TOTAL	197.1	0.0	TOTAL	4.1	6.2	TOTAL	166.4

NOTE TO FIELD ENGINEER & CONTRACTOR:  
 Grade parking and Clear R/W for proposed Sidewalk. Sidewalk to be Constructed by "OTHERS".

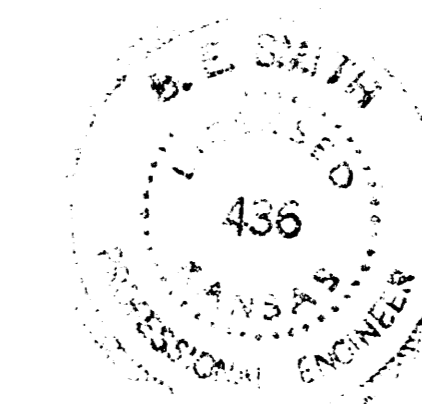

12<sup>th</sup> St. No.-EL. Spruce to WL. Grove  
 6" Concrete — 30' E to E w/Int. Curb  
 City of Wichita, Kansas.

B. E. Smith — City Engineer SHEET 1 of 2  
 Date: Project No. C10-12