

Survey  
 1/2" = 100'  
 (Horizontal)  
 B.E.

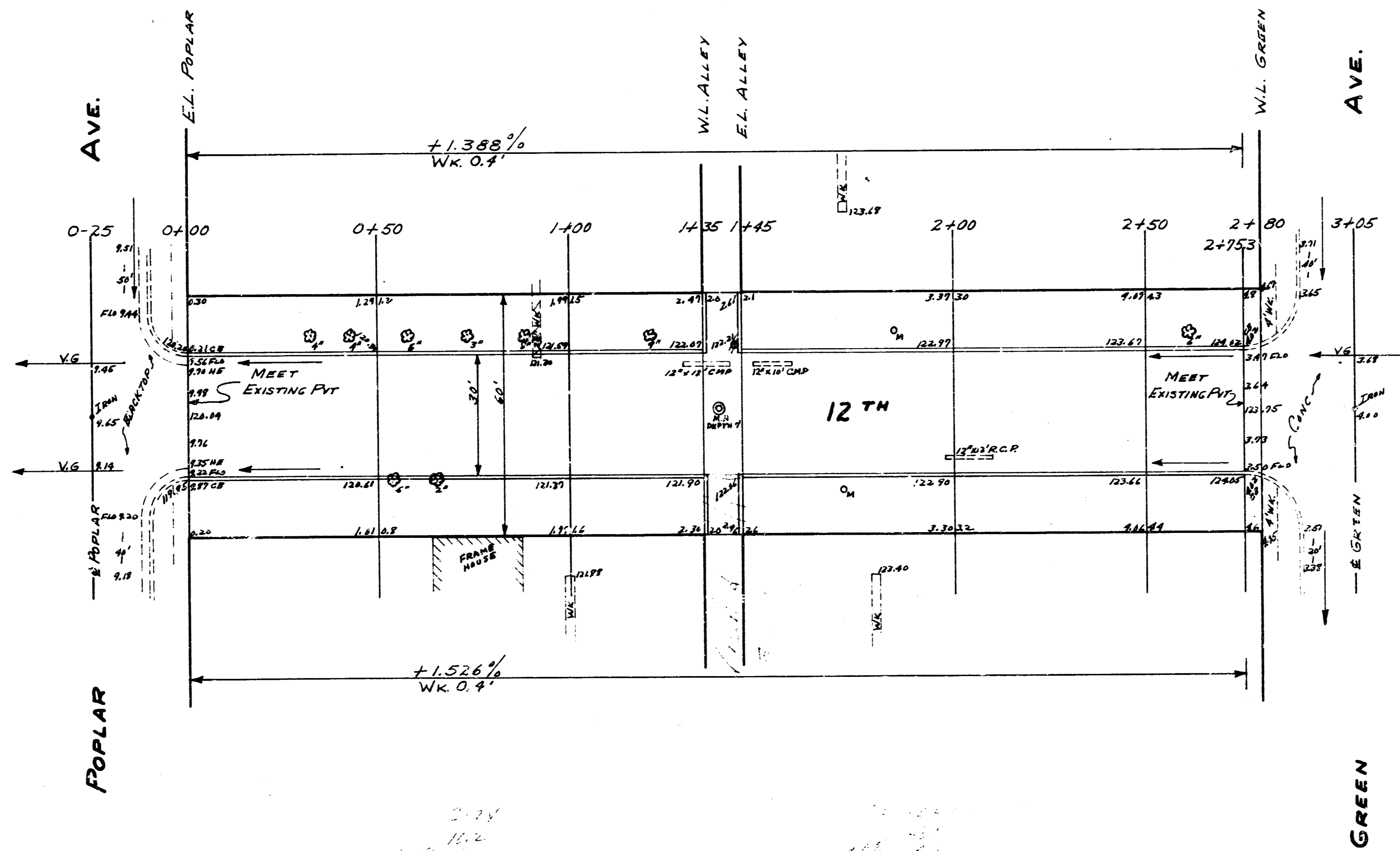

STATION & BASE LINE ON S  
 B.M. 120.28 "W" IN G.W. LEEVER WK. N. NW. COR. 12TH & POPLAR  
 B.M. 124.67 "K" IN KENSLER CENTER OF WK. N. NW. COR. 12TH & GREEN



12TH  
 EL. POPLAR TO W.L. GREEN  
 30' CONC. CURB  
 CITY OF WICHITA, KAN.  
 B.E. SMITH CITY ENGINEER  
 AUG. 1954 PROJ. NO. C14-124