

BM 11532 "X" on ca. 5' N of S. end of Rod. SE cor 13th & Mathewson  
BM 11499 "H" in Hurst on W.R.N. NE cor 13th & New York.

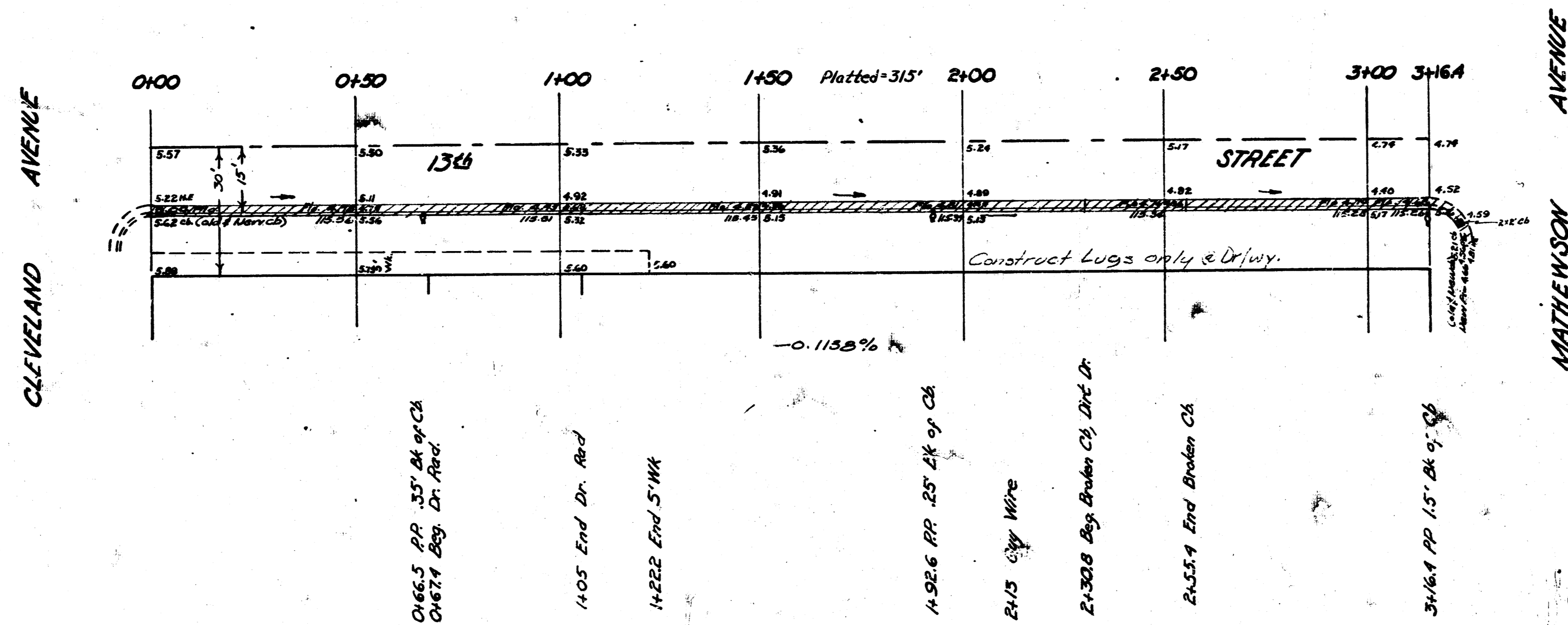

SOUTH SIDE 15th  
 EL CLEVELAND to W.L. MATHEWSON  
 Reconstruct C&Gut.  
 City of Wichita Kansas  
 LK White City Engineer  
 Feb, 1951 Proj. No. CIO-211

