

BM: - 116.8 Standard SW cor 13th & Washington
 BM: - 118.47 "G" in Globe Wnd Ref. NW cor 16th & Masley

BM: - 119.90 RB spl. in NW face Cottonwood Tree Sk. 3+49-50'S E 16th

BM: - 118.52 "G" in Globe E end Ret 16th cor 14th & Wabash

NOTE:
 Remove existing 2 x 2 Catch Basins and plug all leads out of said basins.

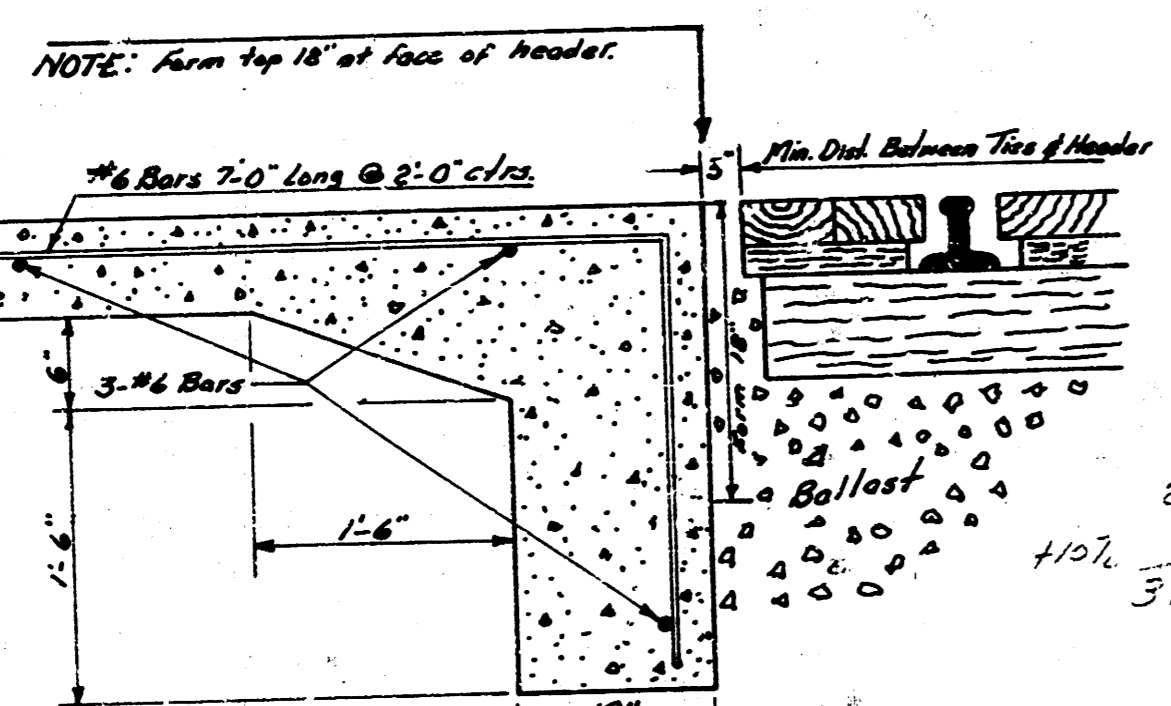
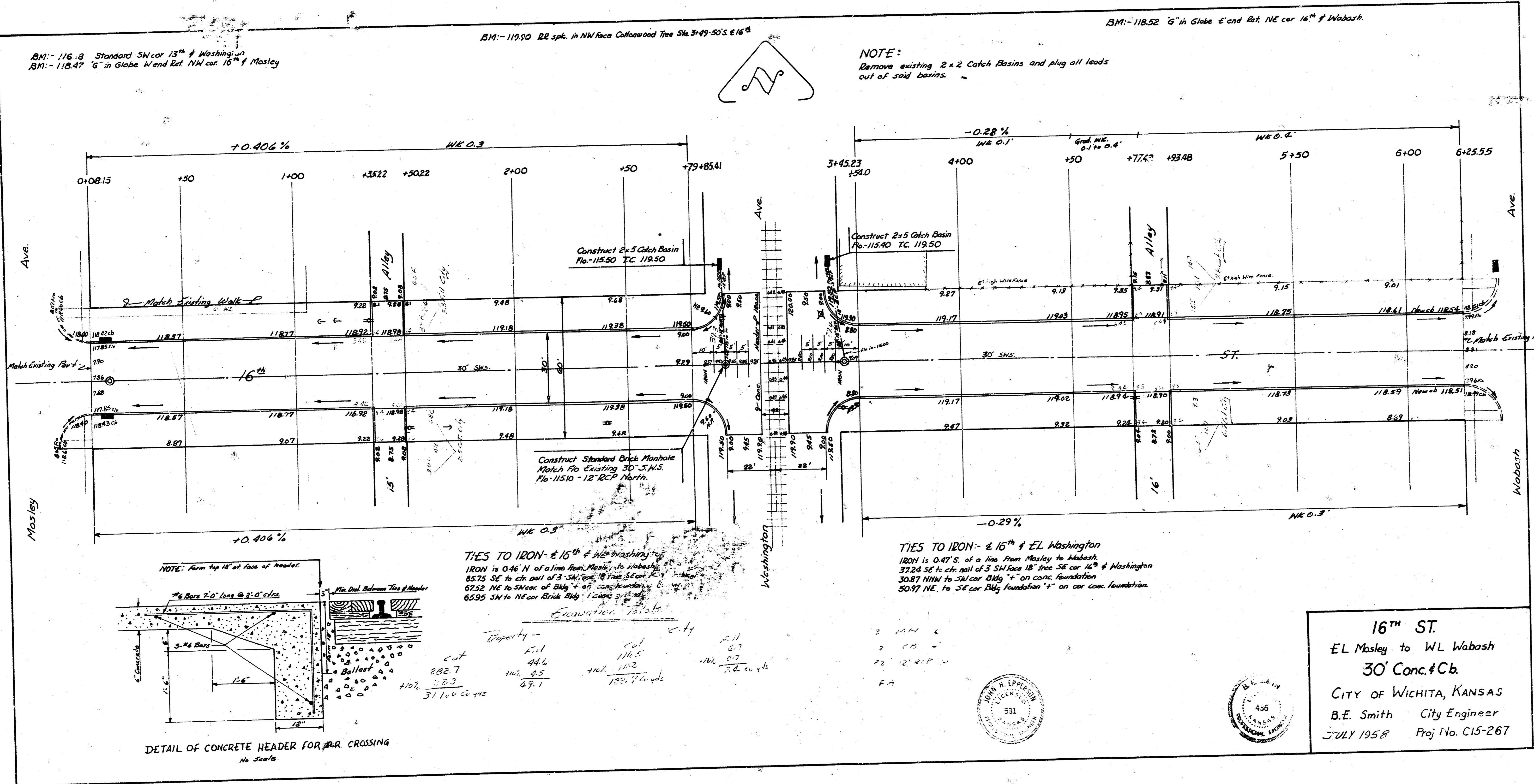

TIES TO IRON - E 16th & W Washington
 IRON is 0.46' N of a line from Masley to Wabash
 85.75 SE to ch. nail of 3" SW face 18" tree SE cor 16th & Washington
 67.52 NE to SW cor of Bldg #1 on conc. foundation
 65.95 SW to NW cor Bldg #1 on conc. foundation

TIES TO IRON - E 16th & EL Washington
 IRON is 0.47' S. of a line from Masley to Wabash
 32.24 SE to ch. nail of 3" SW face 18" tree SE cor 16th & Washington
 30.87 NWN to SW cor Bldg #1 on conc. foundation
 50.97 NE to SE cor Bldg #1 on conc. foundation

Excavation Table

| Property - | cut | col | ft |
|------------|---------|-------|------|
| | 282.7 | 116.5 | 6.7 |
| | 106.95 | 112 | 6.7 |
| | 49.1 | 125.7 | 20.4 |
| | 3110.66 | | |

16th ST.
 EL Masley to WL Wabash
 30' Conc. #Cb.
 CITY OF WICHITA, KANSAS
 B.E. Smith City Engineer
 JULY 1958 Proj No. C15-267

