

Note: Paving contractor to clear right of way, grade parkings and construct compacted fill for proposed sidewalk. Sidewalk to be constructed by others.

Note: Adjust walk on north side to match exist. ground if driveways are not constructed

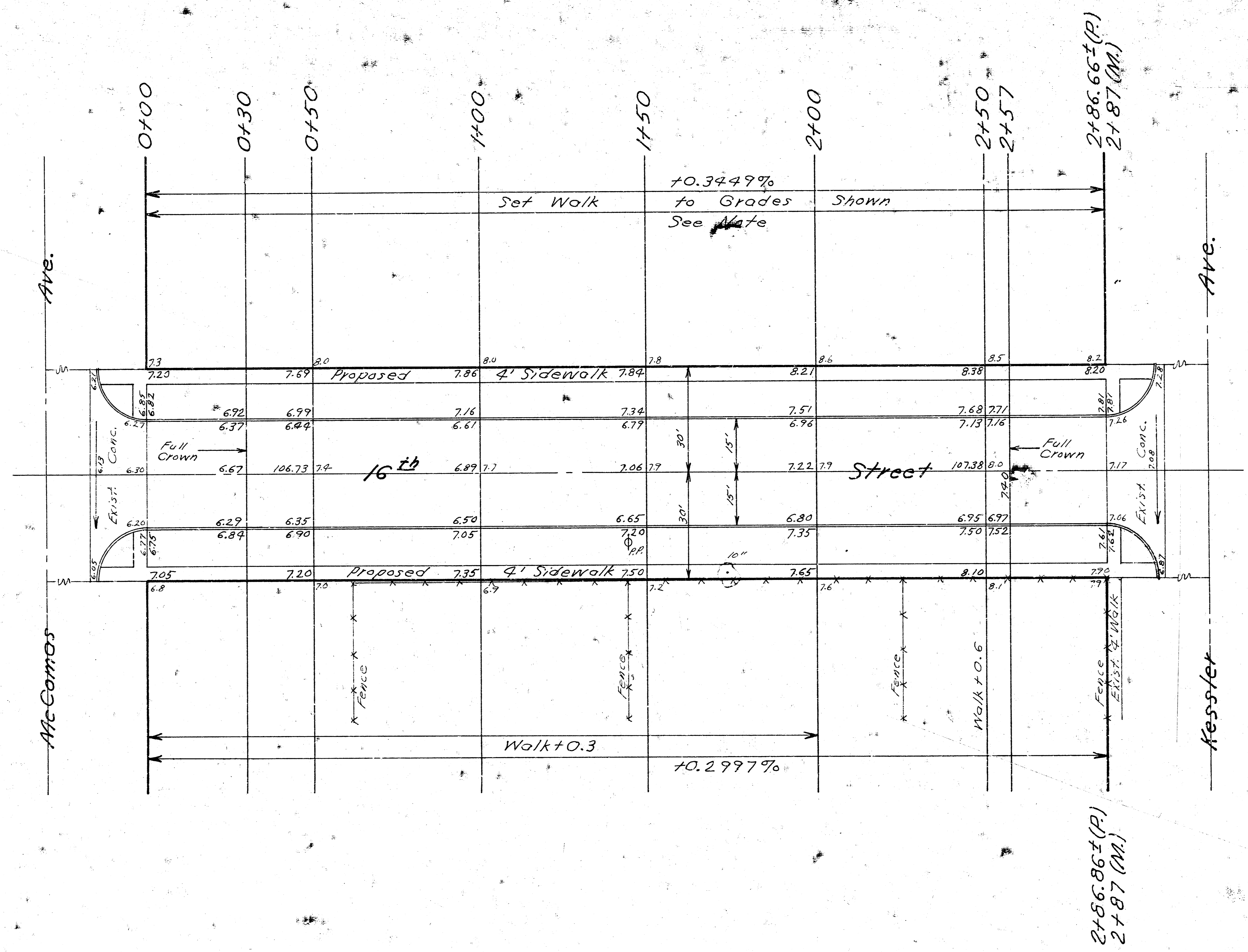
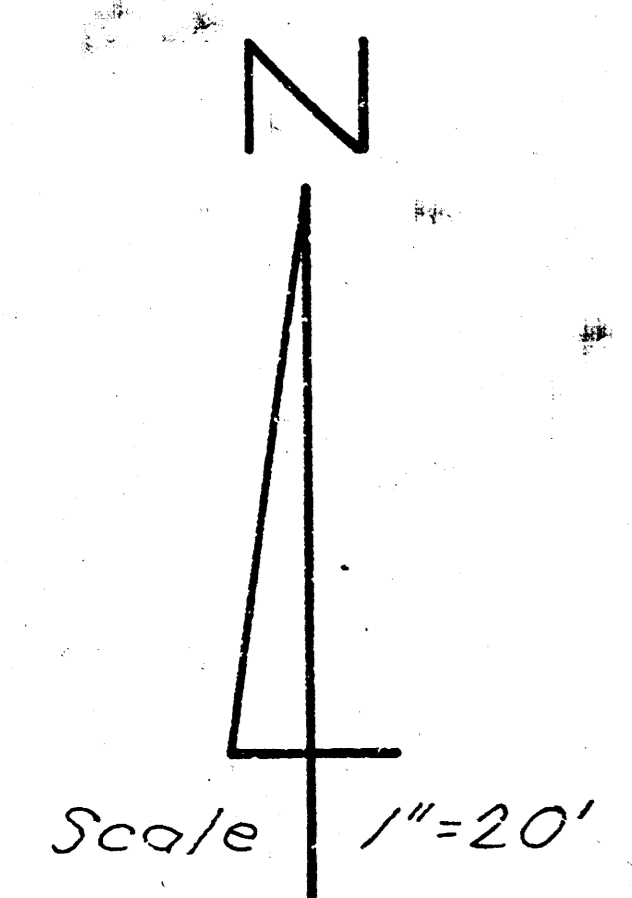

B.M. 127.74 N.E. corner conc. step house no. 1631 N. Kessler.

Earthwork Property  
 412.4 213.9 + 21.4 = 235.3 C.Y. Excavation  
 11.8 5.8 + 0.6 = 6.4 C.Y. Comp. Fill  
 175.3 175.4 C.Y. Comp. Fill S.G.M. for Pavement Subgrade

1/2

16th. STREET  
 E. L. McComas to  
 W. L. Kessler  
 30' CONCRETE  
 CITY OF WICHITA, KANSAS  
 B. E. SMITH, CITY ENGINEER  
 PROJ. NO. C 10-26  
 DATE: Sept. 1970