

B.M. 12189 CITY STANDARD S.W. corner 21st and AMIDON.
 B.M. 12593 " on ctr medial of 21st @ approx W.L. COOLIDGE N.

SURVEY BASELINE: 50' N. of 21st STR.

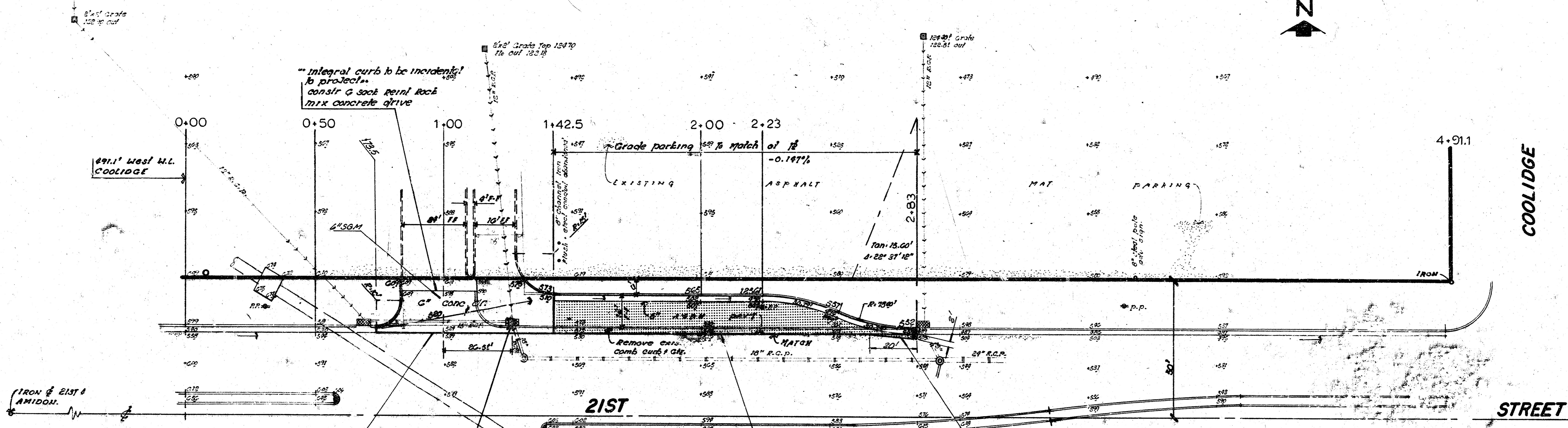

SURVEY: SHOW BE DLE 212
 PLAN - 21st
 C.E.C.
 1/27/77

Plans to re-
 patch in place
 in C.C. const.

Remove 2'-6" brick inlet and
 construct STD TYPE 2A MANHOLE
 in existg 18" R.C.P. S. 12189
 15" R.C.P. West 122.03
 12" R.C.P. North 122.92

EXIST. ASPH., BROKEN OR RICKLED DURING CURS AND
 GUTTER REMOVAL, SHALL BE REMOVED AND REPLACED,
 AND SHALL BE CONSIDERED INCIDENTAL TO COST OF
 PAVEMENT. DOWEL BARS IN EXIST. CONC. BASE SHALL
 BE CUT OFF WHERE NEW BLACK BASE IS CONSTRUCTED,
 BUT SHALL REMAIN AND EXTEND INTO NEW CONC.
 PAVEMENT AT DRIVE.

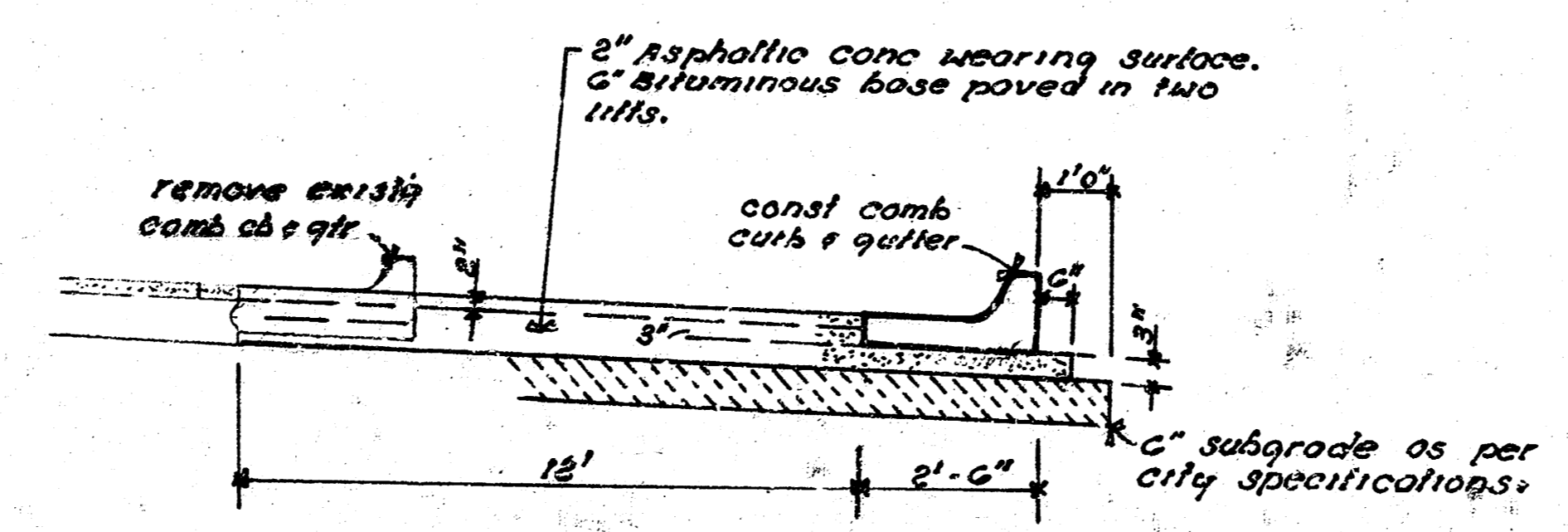

TYPICAL SECTION

SUB-GRADE
 TYPE OF SUB-GRADE TREATMENT SHALL BE DE-
 TERMINED BY THE FIELD ENGINEER. SUB-GRADE
 TREATMENT MAY CONSIST OF LIME TREATMENT,
 CEMENT TREATMENT, SUB-GRADE MODIFI-
 CATION, OR ANY COMBINATION OF THESE.

"EXCAVATION"
 87.7 CU YDS
 110% 8.8
 96.5 CU YDS

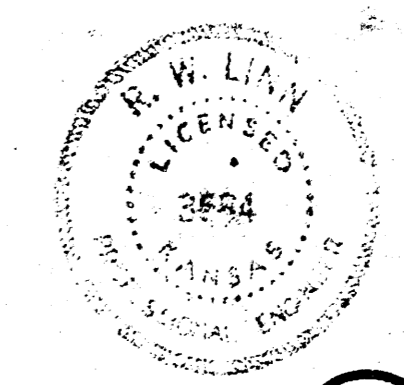

1/2

NORTH SIDE 21ST STR.
 From 391.1' West W.L. COOLIDGE To
 208.1' West W.L. COOLIDGE.
CITY OF WICHITA, KANSAS
 DECELERATION LANE 8" Asphalt
 Pavt y Comb Curb & Gutter.
 R.W. LINN CITY ENGINEER
 Date Jan 1977 Proj No DAKS576026

Revised Apr 28, 1977