

B.M. "G" in West Globe SW Cor. 15th & Green, S Co 15th 128.29
 B.M. "G" Globe W end Eol. N Cor. NW Cor. 15th & Green 122.22
 B.M. "E" in Kitchie E. NW on Park Block SW Cor. 15th & Poplar N. going E. 128.88
 B.M. "X" Top of Curb S.E. 15th E. Co Poplar 122.34

Stationing on E

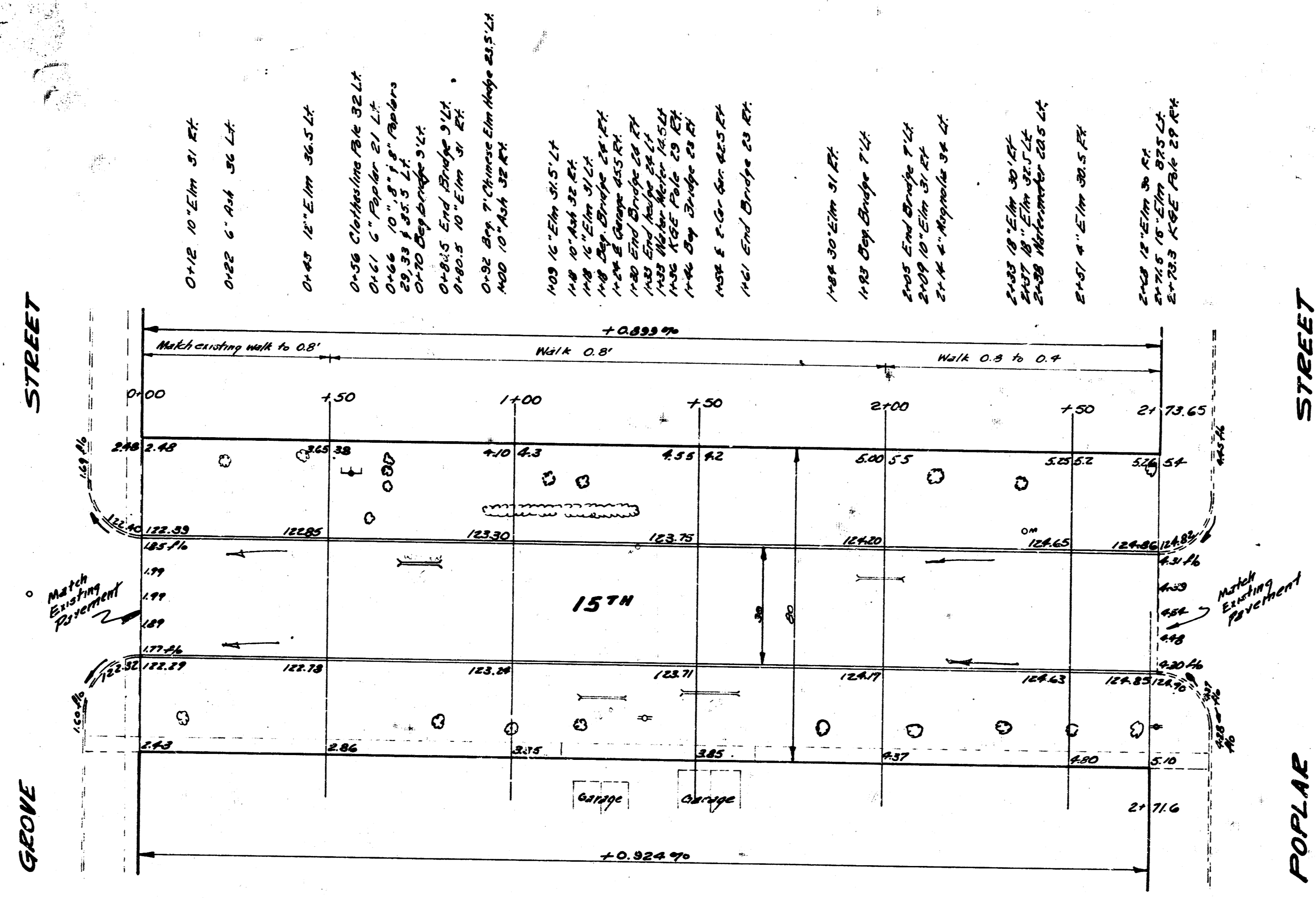

City of Wichita
 Public Works
 Engineering
 Division

15TH
 E.L. POPLAR TO W.L. GROVE
 30' CONC. & CURB
 CITY OF WICHITA
 BE SMITH CITY ENGINEER
 FEB 1954 PROJ. NO. C13-187



1/2