

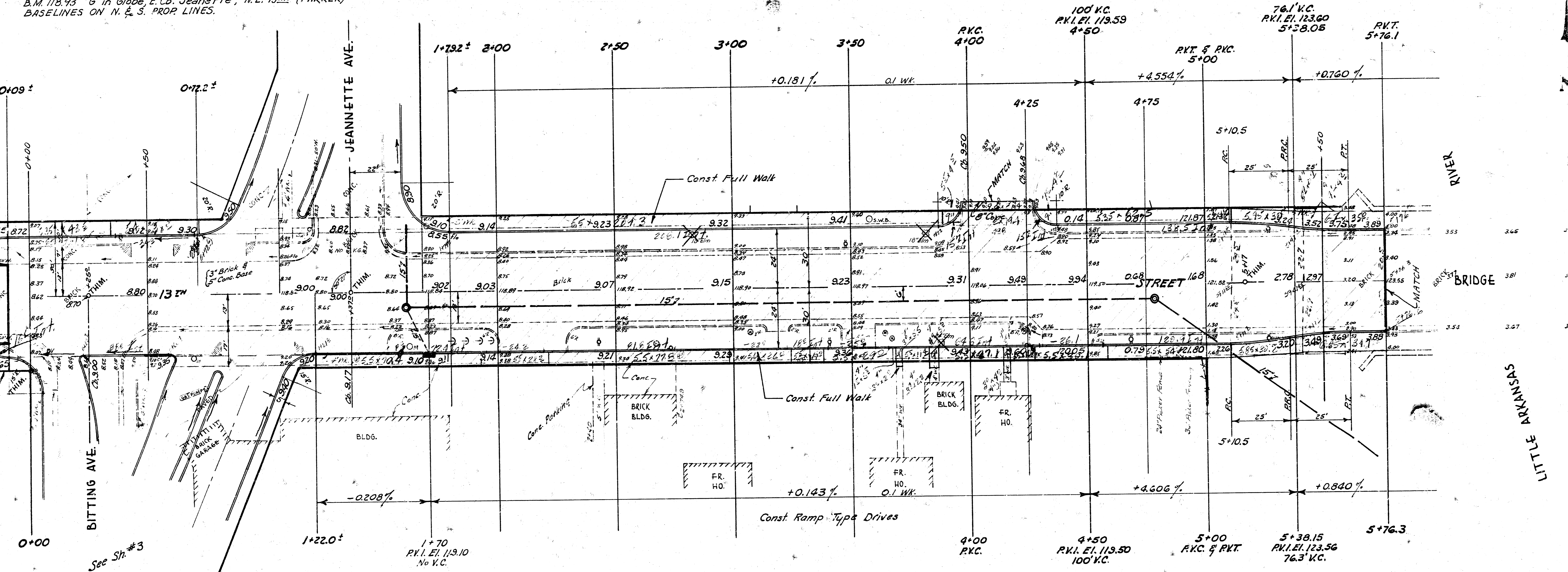

B.M. 124.01 W. Cor. N.W. Wing 13th St Bridge (Minisa)  
 B.M. 118.93 "G" in Globe, E. Cb. Jeannette, N.L. 13th. (PARKER)  
 BASELINES ON N. & S. PROP. LINES.



	EXC.	COMP. FILL
+10%	602 Cu.Yds.	260 Cu.Yds.
	60 "	26 "
Totals	662 Cu.Yds.	286 Cu.Yds.

Revised quantities  
 Final Status 662 Cu.Yds. 286 Cu.Yds.

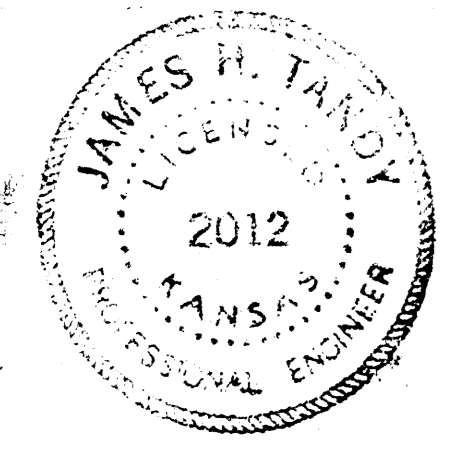

**13TH STREET**  
 FROM W.L. BITTING AVE. to (R.R.) BAR  
 LITTLE ARKANSAS RIVER  
 48' Conc. & Int. Curb  
 CITY OF WICHITA, KANSAS  
 B. E. SMITH CITY ENGINEER  
 JUNE 1966 PROJ. NO. C15-53

2/5

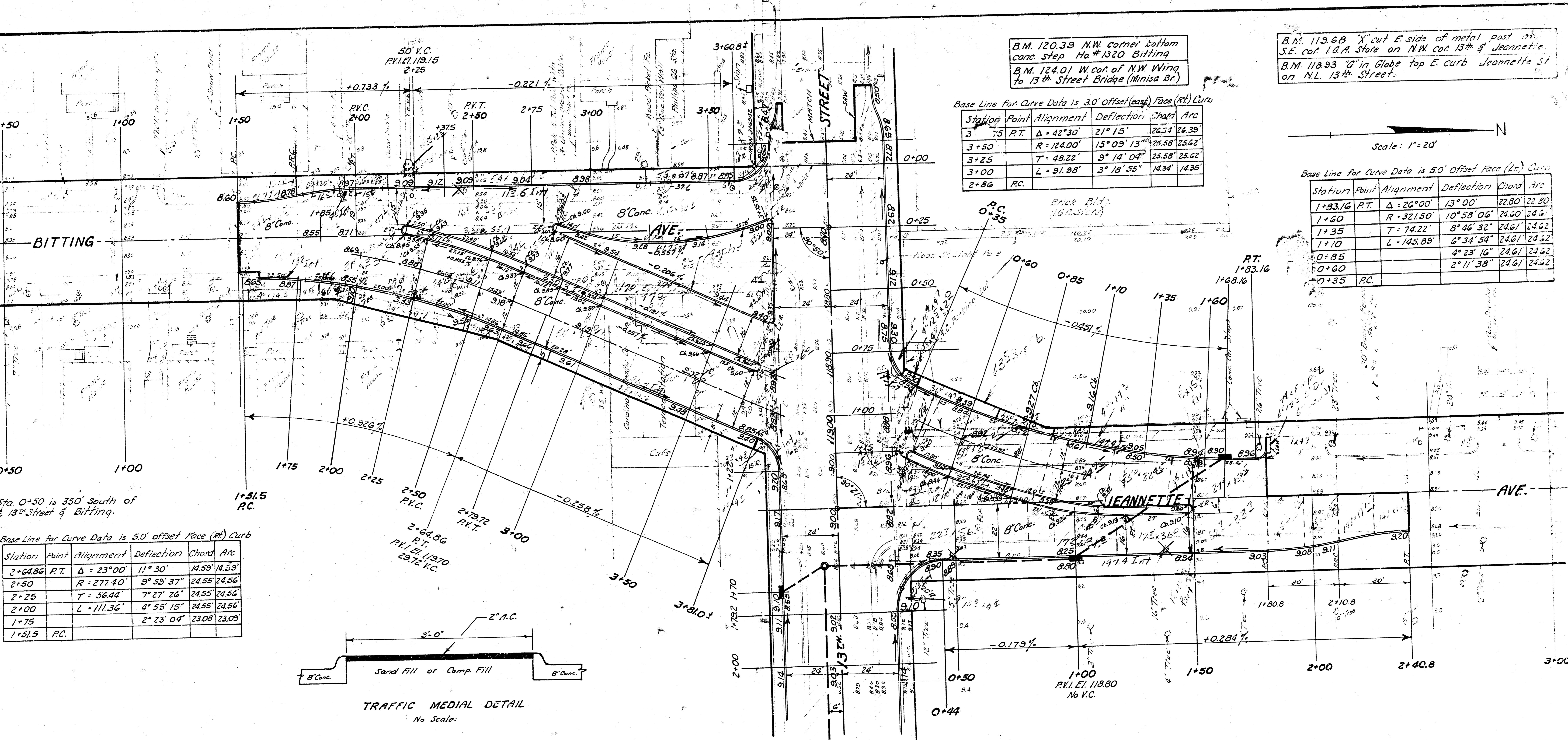

B.M. 120.39 N.W. corner bottom conc. step Ho #1320 Bitting  
 B.M. 124.01 W. cor. of N.W. Wing to 13th Street (Minisa Br.)

B.M. 113.68 "X" cut E. side of metal post at S.E. cor. I.G.A. Store on N.W. cor. 13th & Jeannette  
 B.M. 118.93 "G" in Globe top E. curb Jeannette's st on N.L. 13th Street.

Base Line for Curve Data is 3.0' Offset (east) Face (Rt) Curb

Station Point	Alignment	Deflection	Chord	Arc
3+75 P.T.	$\Delta = 42^{\circ}30'$	$21^{\circ}15'$	26.54	26.39
3+50	$R = 124.00'$	$15^{\circ}09'13''$	25.58	25.62
3+25	$T = 48.22'$	$9^{\circ}14'04''$	25.58	25.62
3+00	$L = 91.98'$	$3^{\circ}18'55''$	14.34	14.35
2+86	RC.			

Scale: 1" = 20'

Base Line for Curve Data is 5.0' Offset Face (Lr) Curb

Station Point	Alignment	Deflection	Chord	Arc
1+83.16 P.T.	$\Delta = 26^{\circ}00'$	$13^{\circ}00'$	22.80	22.80
1+60	$R = 321.50'$	$10^{\circ}58'06''$	24.60	24.61
1+35	$T = 74.22'$	$8^{\circ}46'32''$	24.61	24.62
1+10	$L = 145.89'$	$6^{\circ}34'54''$	24.61	24.62
0+85		$4^{\circ}23'16''$	24.61	24.62
0+60		$2^{\circ}11'38''$	24.61	24.62
0+35	RC.			

Sta. 0+50 is 350' South of 13th Street & Bitting.

Base Line for Curve Data is 5.0' offset Face (Rt) Curb

Station Point	Alignment	Deflection	Chord	Arc
2+64.86 P.T.	$\Delta = 23^{\circ}00'$	$11^{\circ}30'$	14.59	14.59
2+50	$R = 277.40'$	$9^{\circ}53'37''$	24.55	24.56
2+25	$T = 56.44'$	$7^{\circ}27'26''$	24.55	24.56
2+00	$L = 111.36'$	$4^{\circ}55'15''$	24.55	24.56
1+75		$2^{\circ}23'04''$	23.08	23.08
1+51.5	RC.			

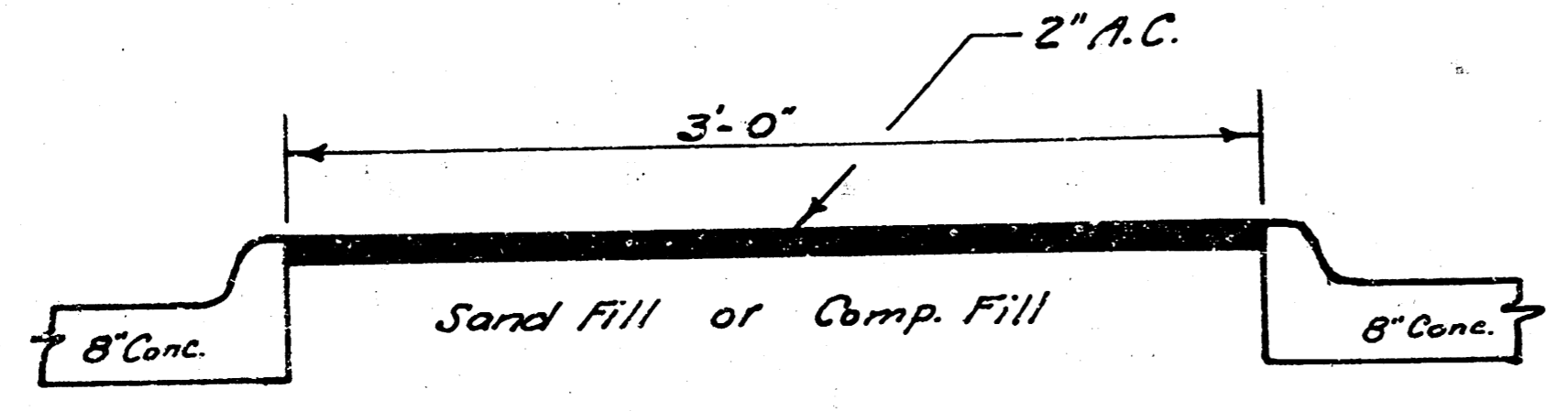

TRAFFIC MEDIAL DETAIL  
 No Scale:

13th STREET  
 FROM W.L. BITTING to (Rt) Bank of  
 LITTLE ARKANSAS RIVER

Project No. C15-53

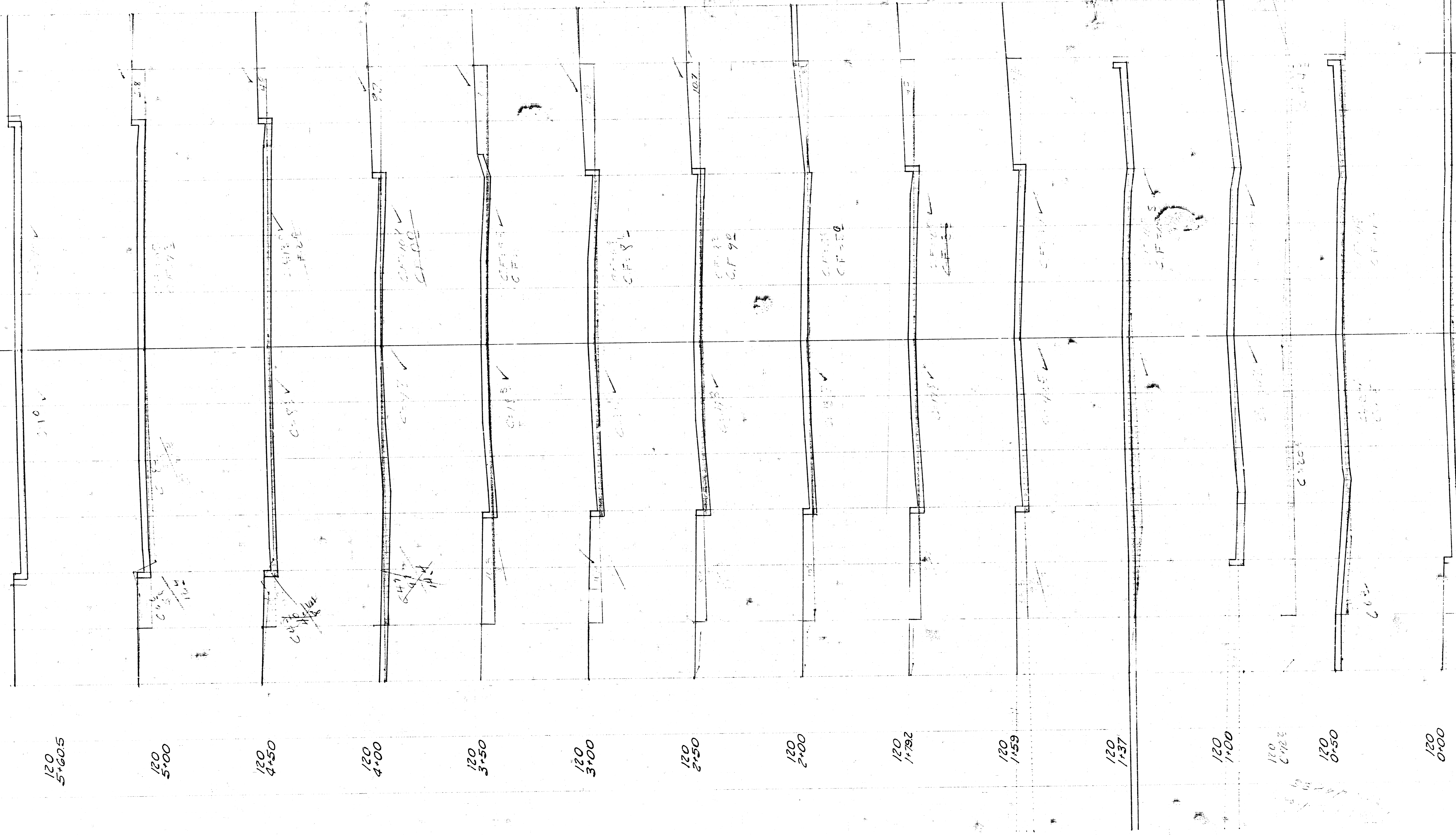

509+5  
021

500  
021

450  
021

400  
021

350  
021

300  
021

250  
021

200  
021

150  
021

100  
021

50  
021

000  
021

000  
021

000  
021

000  
021

13th Street from W.L. Bitting  
to (Rt) Bank Little Arkansas River  
C 15-53

43

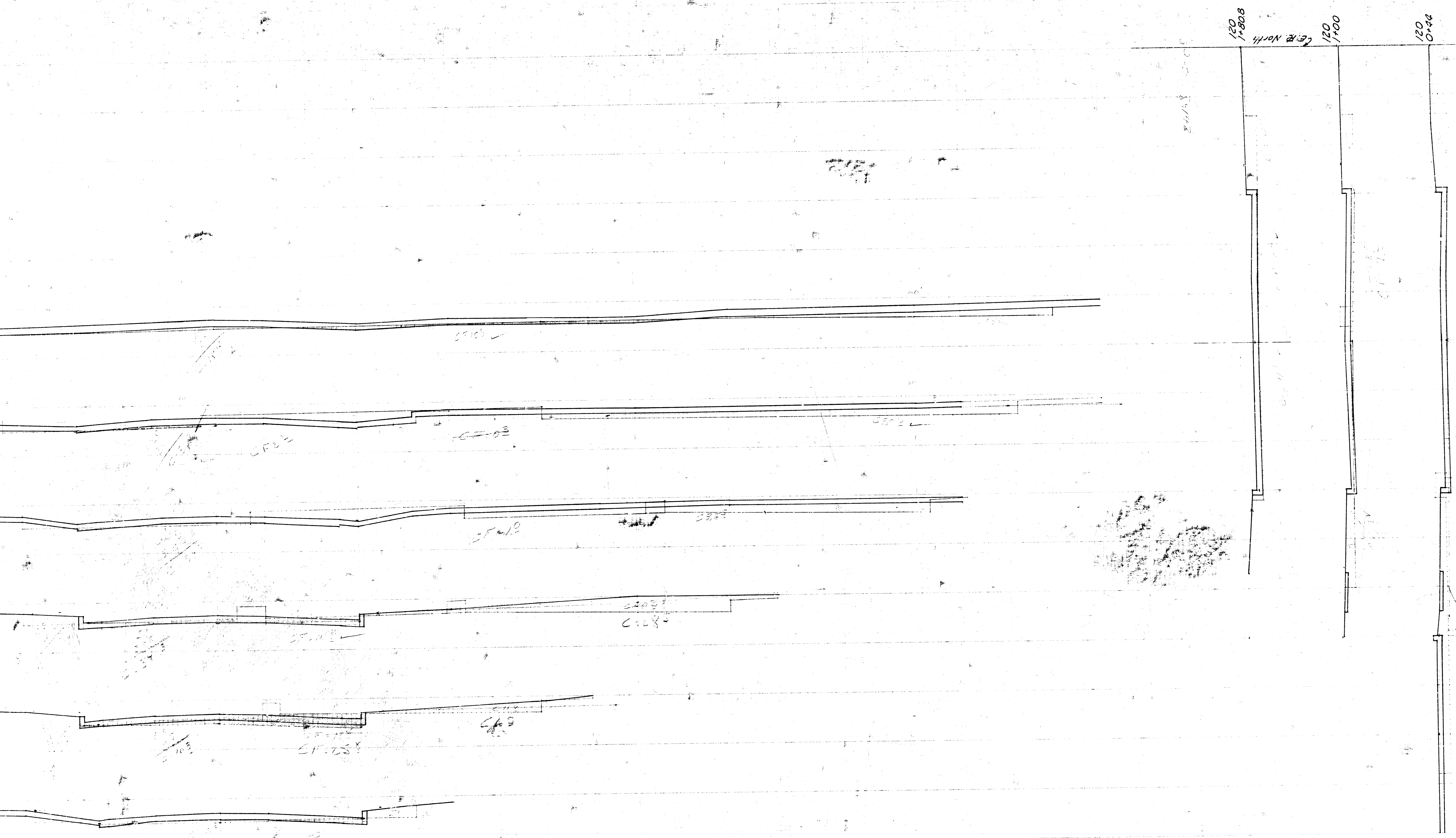

13<sup>th</sup> Street from W.L. Bitting  
to (RT) Bank Little Arkansas River  
C 15-53

55