

THIRTEENTH STREET

FROM E.L. HILLSIDE AVE. TO E.L. VESTA DRIVE
B.E. SMITH CITY ENGINEER CITY OF WICHITA, KANSAS

PROJECT NO. C16-1

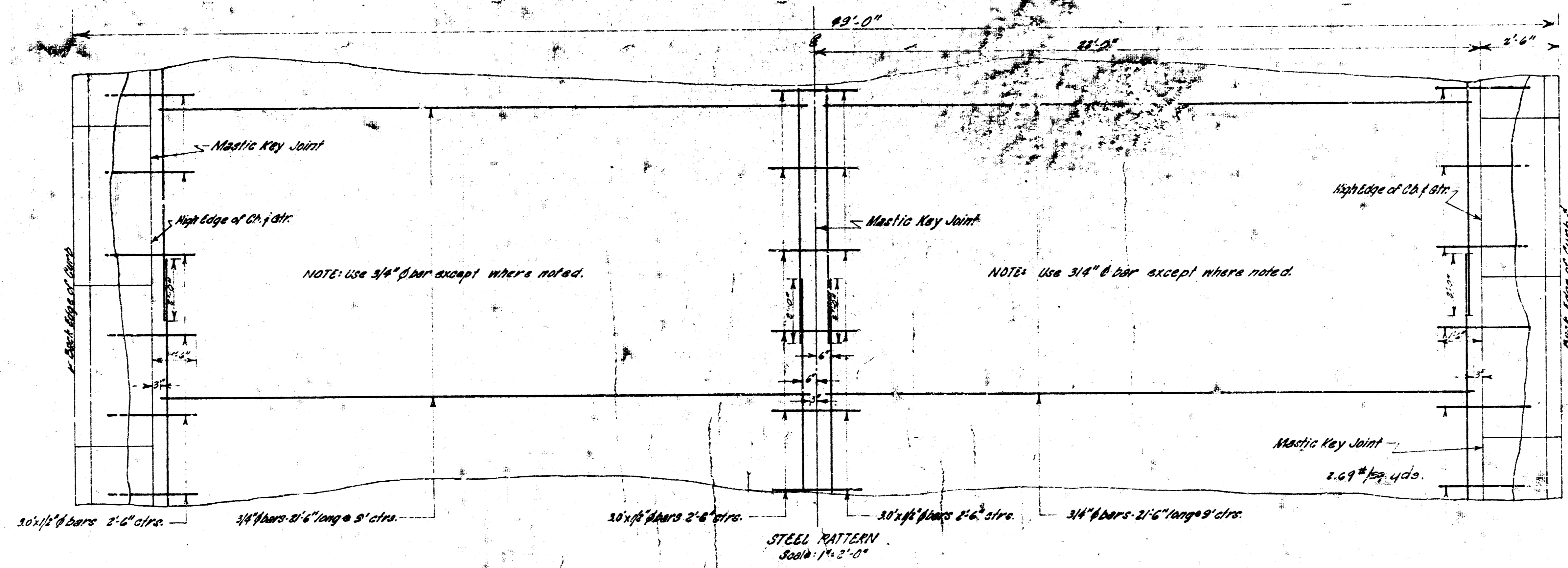

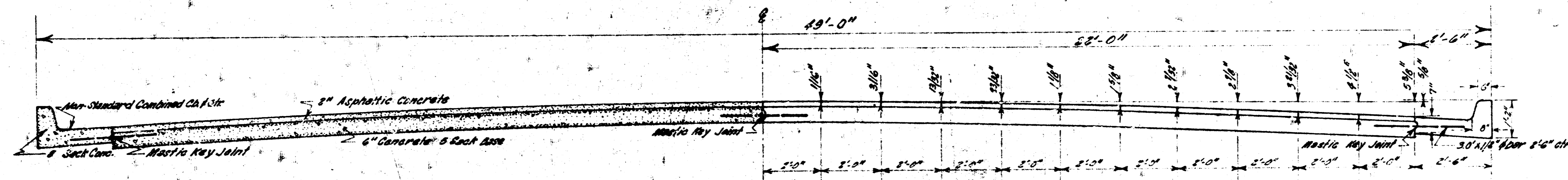
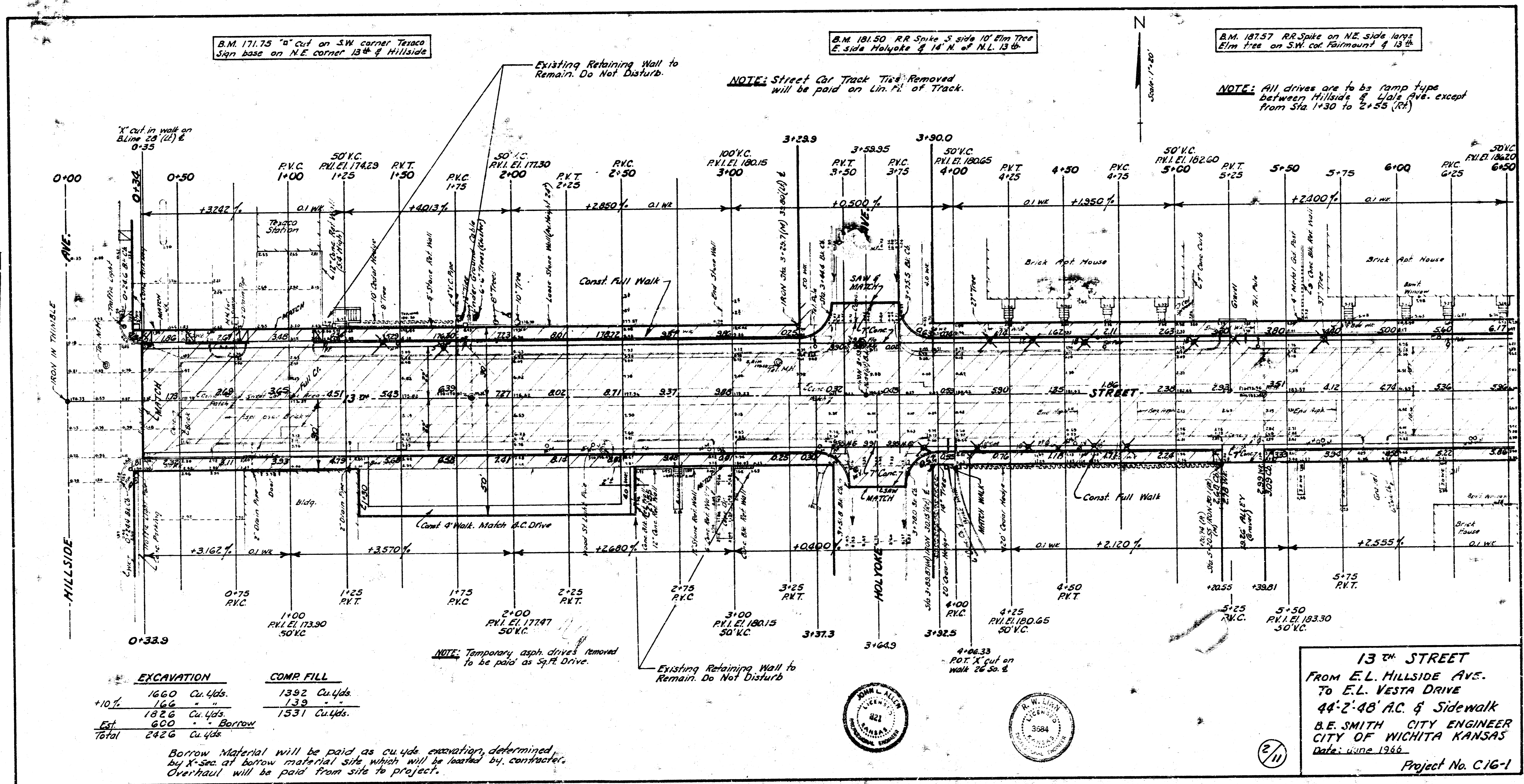

B.M. 171.75 "a" cut on SW corner Texaco sign base on NE corner 13th & Hillside

B.M. 181.50 RR Spike S side 10' Elm Tree E side Molyoke & 14' N of N.L. 13th

B.M. 187.57 RR Spike on NE side lamp Elm tree on SW cor Fairmount & 13th

NOTE: Street Car Track Ties Removed will be paid on Lin. P. of Track.

NOTE: All drives are to be ramp type between Hillside & Vesta Ave. except from Sta. 1+30 to 2+55 (Rt.)

Survey L.A.R. B.M. 171.75
 E.M. J.C.A. 4740
 Checked

	EXCAVATION	COMP. FILL
+10%	1660 Cu.Yds.	1392 Cu.Yds.
	166 "	139 "
Est.	1826 Cu.Yds.	1531 Cu.Yds.
Total	900 " Borrow	
	2426 Cu.Yds.	

Borrow Material will be paid as cu.yds. excavation, determined by X-sec. at borrow material site which will be located by contractor. Overhaul will be paid from site to project.

13th STREET
 FROM E.L. HILLSIDE AVE.
 TO E.L. VESTA DRIVE
 44'-2'-48" A.C. & Sidewalk
 B.E. SMITH CITY ENGINEER
 CITY OF WICHITA KANSAS
 Date: June 1936
 Project No. C.16-1



(2/11)

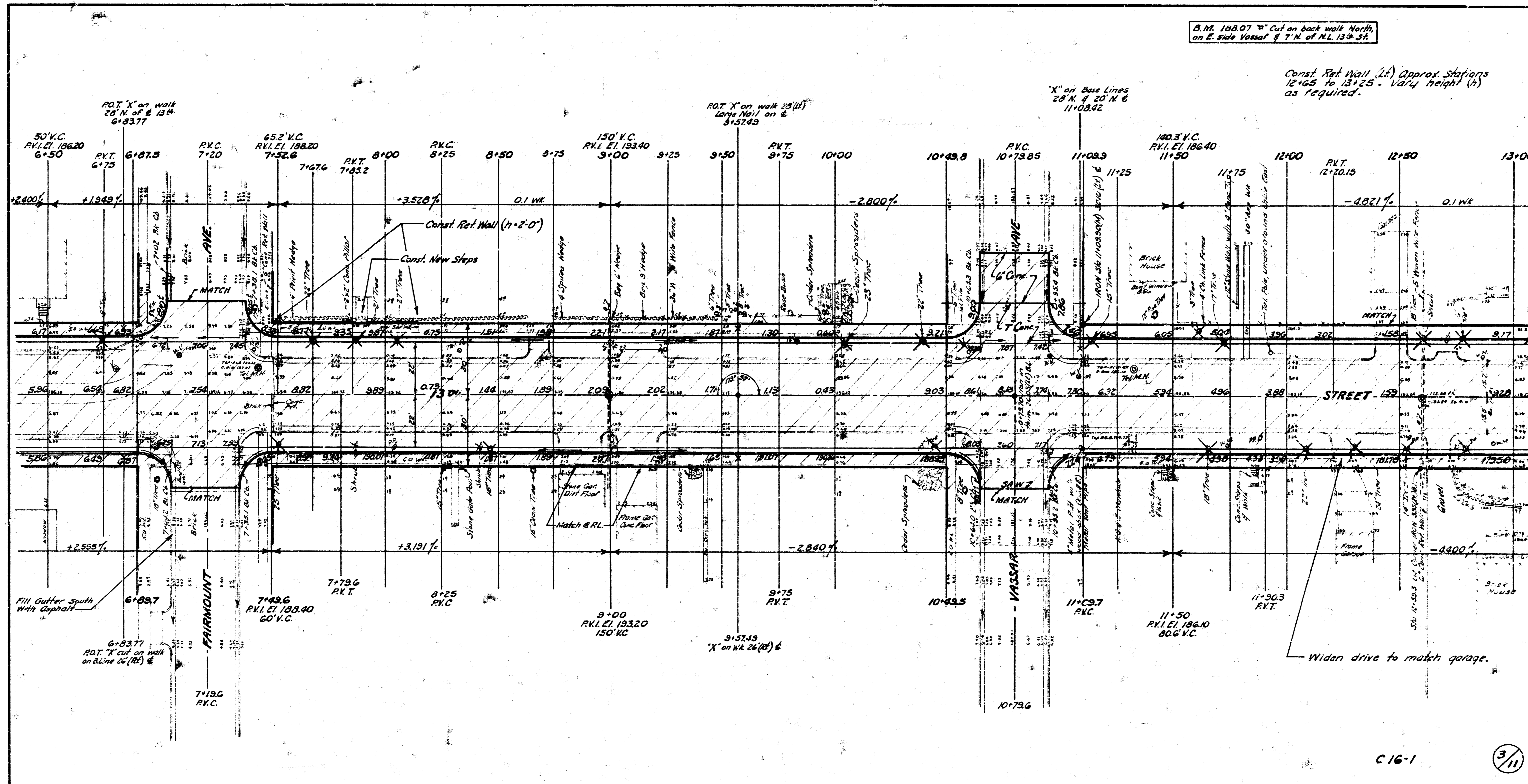

B.M. 175.87 R.R. Spike S. side Lane Elm Tree
N. side 13th approx 35' W. of W.L. Yale N.

B.M. 171.99 NW. cor. conc. porch
brick apartment #3623 E. 13th

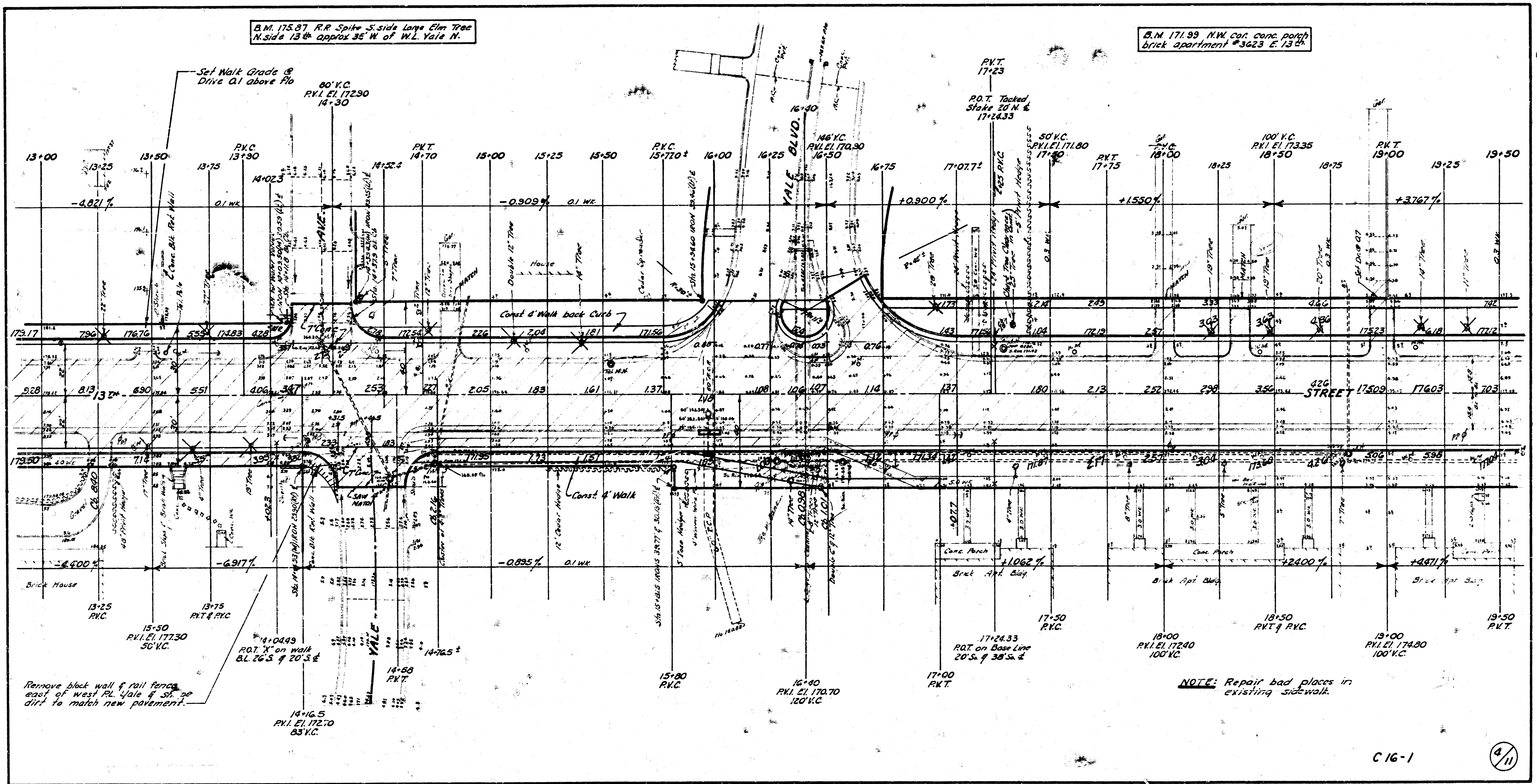

C 16-1

11

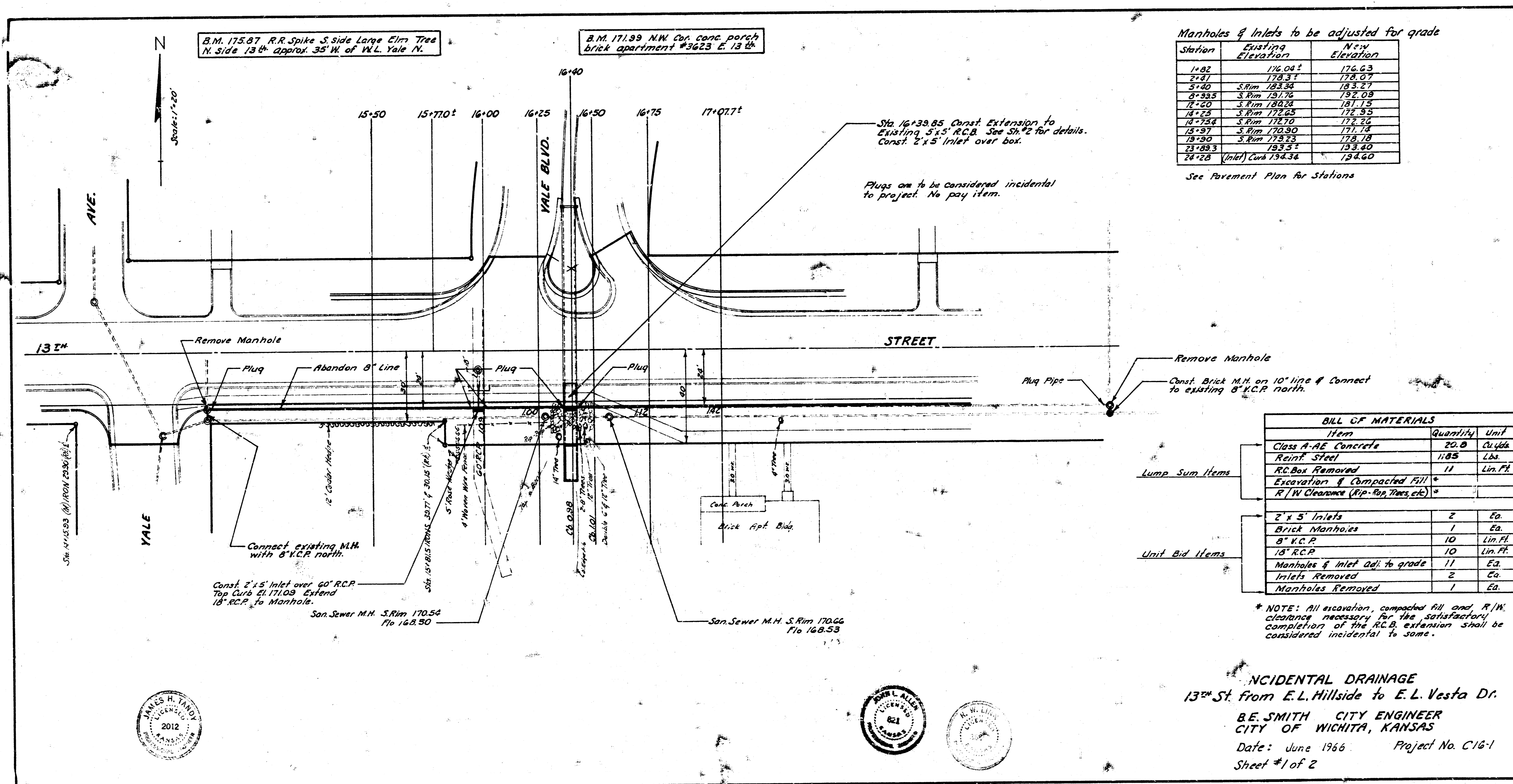

Manholes & Inlets to be adjusted for grade

Station	Existing Elevation	New Elevation
1+82	176.04±	176.63
2+47	178.3±	178.07
5+40	S.Rim 183.34	183.27
8+33.5	S.Rim 181.76	182.08
7+20	S.Rim 180.24	181.15
14+25	S.Rim 172.65	172.35
10+54	S.Rim 172.70	172.34
15+97	S.Rim 170.90	171.14
18+90	S.Rim 175.23	178.18
23+88.3	193.5±	193.40
24+28	(Inlet) Curb 194.34	194.60

See Pavement Plan for Stations

BILL OF MATERIALS

Item	Quantity	Unit
Class A-AE Concrete	20.8	Cu Yds
Reinf. Steel	1185	Lbs.
R.C. Box Removed	11	Lin. Ft.
Excavation & Compacted Fill*		
R/W Clearance (Rip-Up, Trees, etc)*		
2' x 5' Inlets	2	Ea.
Brick Manholes	1	Ea.
8\" R.C.P.	10	Lin. Ft.
18\" R.C.P.	10	Lin. Ft.
Manholes & Inlet Adj. to grade	11	Ea.
Inlets Removed	2	Ea.
Manholes Removed	1	Ea.

* NOTE: All excavation, compacted fill and R/W clearance necessary for the satisfactory completion of the R.C.B. extension shall be considered incidental to some.

INCIDENTAL DRAINAGE
 13th St. from E.L. Hillside to E.L. Vesta Dr.
 B.E. SMITH CITY ENGINEER
 CITY OF WICHITA, KANSAS
 Date: June 1966 Project No. C16-1
 Sheet #1 of 2



