

**14TH STREET NORTH**  
 E.L. LAWRENCE LANE to W.L. GOVERNEOUR ROAD  
 PROJ. NO. DAKS576028

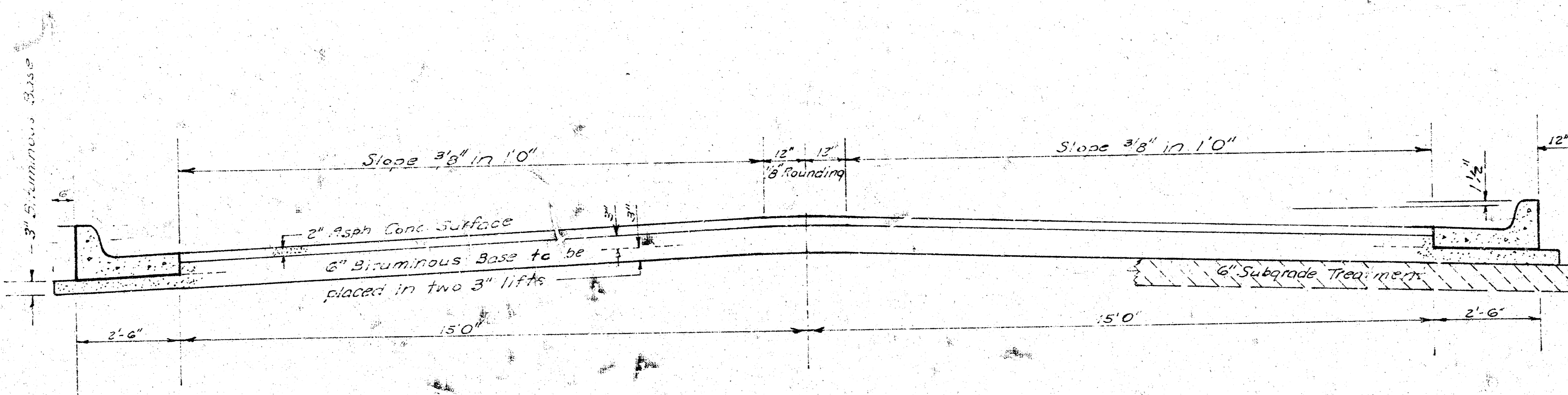

**TYPICAL SECTION**

**35' ASPHALTIC CONCRETE PAVEMENT WITH BITUMINOUS BASE**

A TACK COAT OF EMULSIFIED ASPHALT (SS-1P) SHALL BE APPLIED AT AN APPROXIMATE RATE 0.05 GALLONS PER SQ YD BETWEEN LIFTS OF ASPHALTIC MATERIALS WHEN ORDERED BY THE ENGINEER. TACK COAT WILL NOT BE PAID FOR DIRECTLY AND SHALL BE CONSIDERED AS SUBSIDIARY TO PRICE BID FOR ASPHALTIC PAVEMENT. BITUMINOUS BASE AND ASPHALTIC CONCRETE WEARING SURFACE SHALL BE PLACED WITH A LAYDOWN MACHINE HAVING AUTOMATIC ELECTRONIC CONTROLS FOR CROWN AND GRADE. CONSTRUCTION JOINTS IN EACH LIFT SHALL BE STAGGERED A MINIMUM DISTANCE OF 1' WITH JOINTS IN PRECEDING LIFTS AND PLACED SUCH THAT A JOINT WILL BE CONSTRUCTED ON THE CENTERLINE IN THE TOP LIFT.

*The A.C. Pavement between the comb curb & gutter shall be paid as Sq. Yds. 8" A.C. Pavement (6" Bituminous Base).  
 The Bituminous Base under the comb curb & gutter shall be paid as Sq. Yds. 3" Bituminous Base.*

**DETAIL OF TRANSVERSE CONSTRUCTION JOINTS**

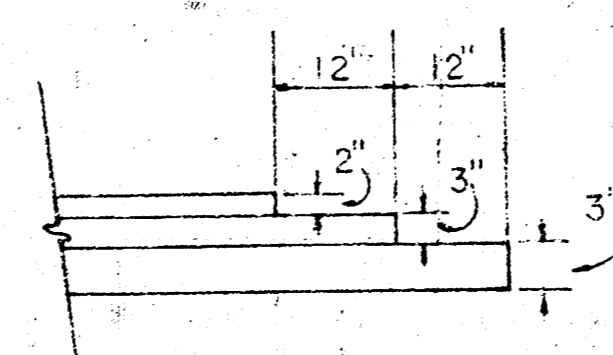

TRANSVERSE CONSTRUCTION JOINTS SHALL BE CONSTRUCTED IN FLEXIBLE BASE PAVEMENTS AT LOCATIONS WHERE PAVEMENT TEMPORARILY ENDS TO FACILITATE FUTURE PAVEMENT CONSTRUCTION AS SHOWN BY DETAIL. THE COST OF CONSTRUCTING THE TRANSVERSE CONSTRUCTION JOINTS SHALL NOT BE MEASURED OR PAID FOR DIRECTLY BUT SHALL BE INCLUDED IN THE BID PRICE FOR SQUARE YARDS OF ASPHALTIC CONCRETE PAVEMENT.

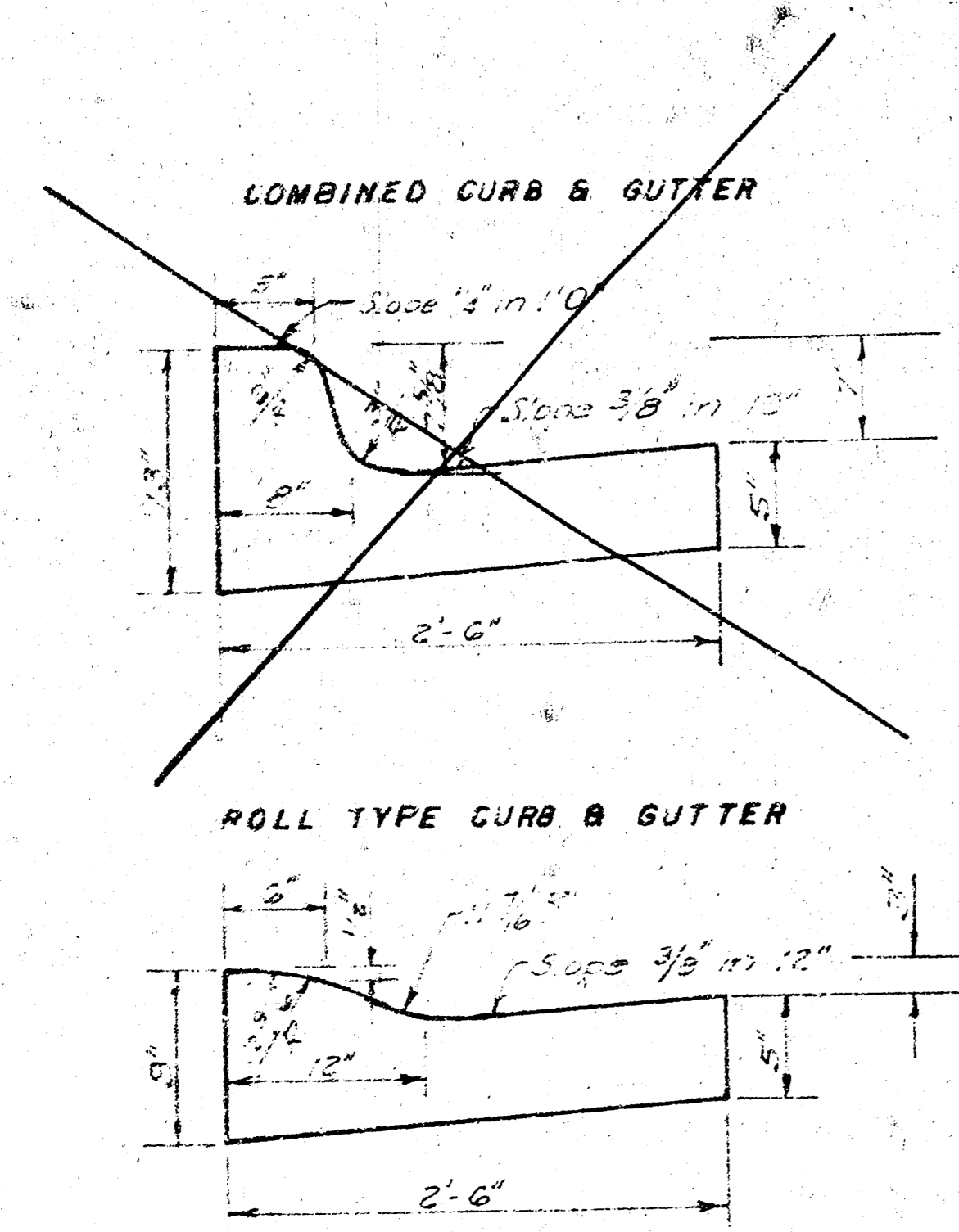

**CITY OF WICHITA KANSAS**

DEPARTMENT of PUBLIC WORKS - Engineering  
 Division

R. W. LINN CITY ENGINEER

DATE Sept 1976 Proj. No. DAKS576028

B.M. 19723 City St. N.E. Corner 15TH St. & Gouverneur Rd.  
 T.B.M. 25041 R.R. Spk. N.S.P.P. W.S. Gouverneur Rd. and S.S. 14TH St. No.  
 Base Line: Center Line 14TH St. No.

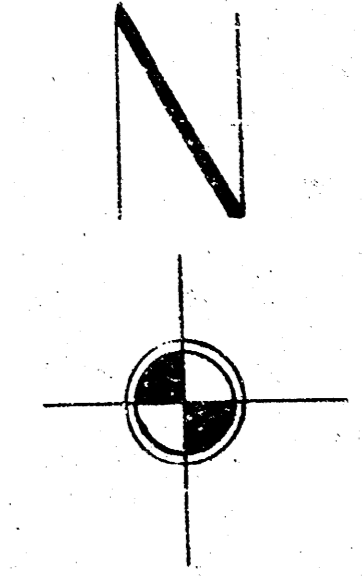

SCALE 1" = 20'

ROLL TYPE CURB & GUTTER to be used on this PROJECT

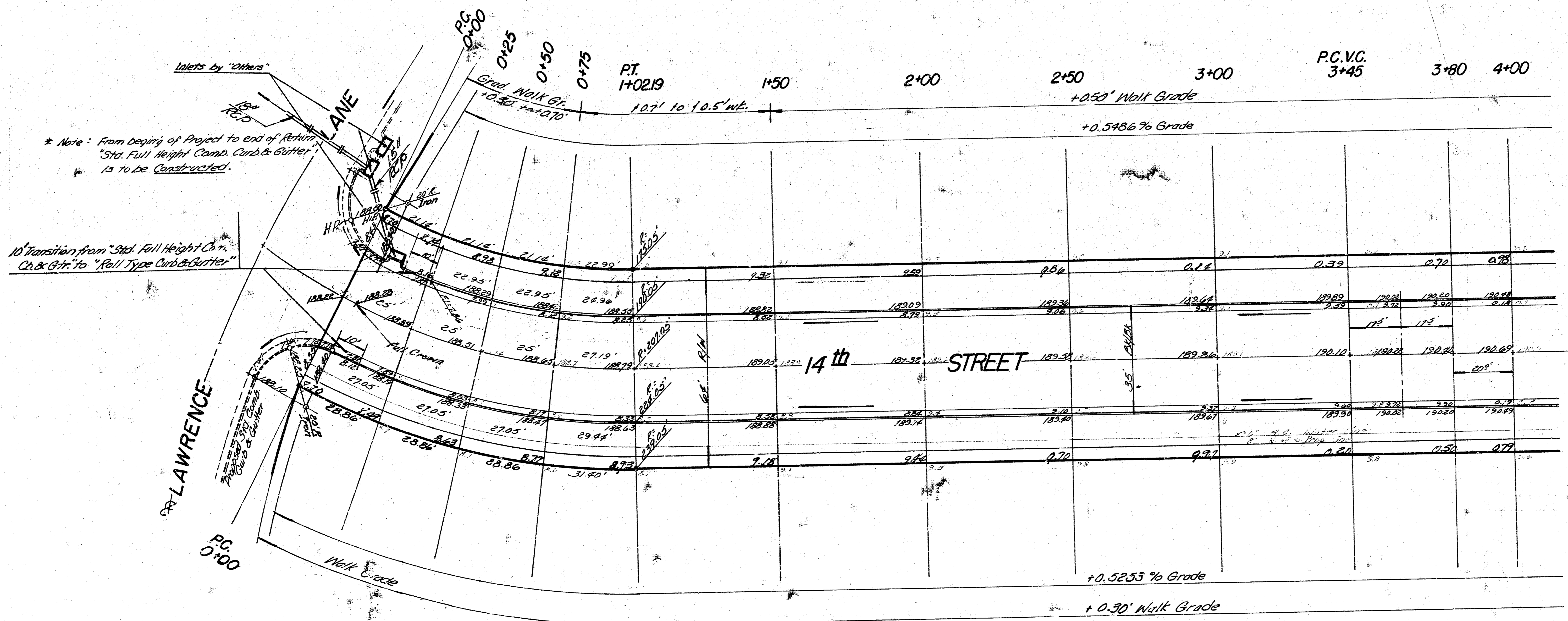

\* Note: From beginning of Project to end of Retaining Wall, Full Height Curb & Gutter is to be constructed.

10' Transition from 'Std. Full Height Curb & Gutter' to 'Roll Type Curb & Gutter'

**EARTHWORK**

	Property	City
Excavation	1,139.8 CY	33.9 CY
+10%	114.0	3.9
<b>Total</b>	<b>1,253.8 CY</b>	<b>37.8 CY</b>
Comp. Fill	41.7 CY	1.1 CY
+10%	4.3	0.1
<b>Total</b>	<b>45.9 CY</b>	<b>1.2 CY</b>

Δ = 251°46' N 207.25' = 52.16' L = 102.19' L.C. = 1.16'

CURVE DATA BASED ON 8' RAD. Δ = 208.64'

STA.	ARC.	CHORD LENGTH		DIST. TO CURV.	TOTAL DEFLECT. IN
		P.O.C.	P.O.B.		
0+00	—	—	—	—	0°00'00"
0+25	25°	21.87	28°	3°27'33"	3°27'33"
0+50	25°	"	"	3°27'36"	6°55'09"
0+75	25°	"	"	3°27'33"	10°22'42"
1+02.19	27°	23.88	30°	3°45'45"	14°08'27"

**14TH STREET NORTH**  
 E.L. LAWRENCE LANE to W.L. GOVERNEUR ROAD  
 35' B B AC Pavement With Roll Cb. & Gtr.  
 CITY OF WICHITA, KANSAS  
 R. W. LINN CITY ENGINEER  
 Proj. No. DAKS 576028 Date Sept. 76

Note to Field Engr. - If any circs have been considered in the paving this proj. match it between 10.3' & 10' above T.Cb.

B-M

FILMED FROM THE BEST AVAILABLE COPY.....

B.M. 197.82 City Standard, N.E. Corner of 13TH Street and Gouverneur Road.  
 T.B.M. 200.47 R.R. Spike, N.S. K.G.E., P.P., W.S. Gouverneur Rd and S.S. 14TH St. No.  
 Base Line: Center Line of 14TH Street No.

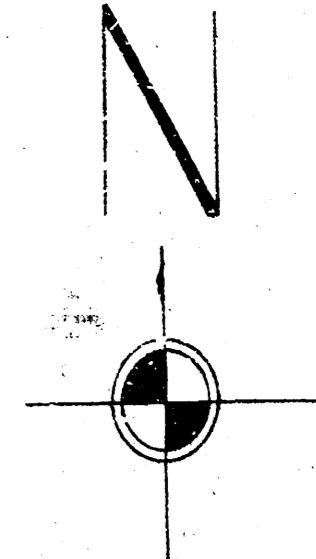

SCALE 1" = 20'

ROLL TYPE CURB & GUTTER to be used on this PROJECT

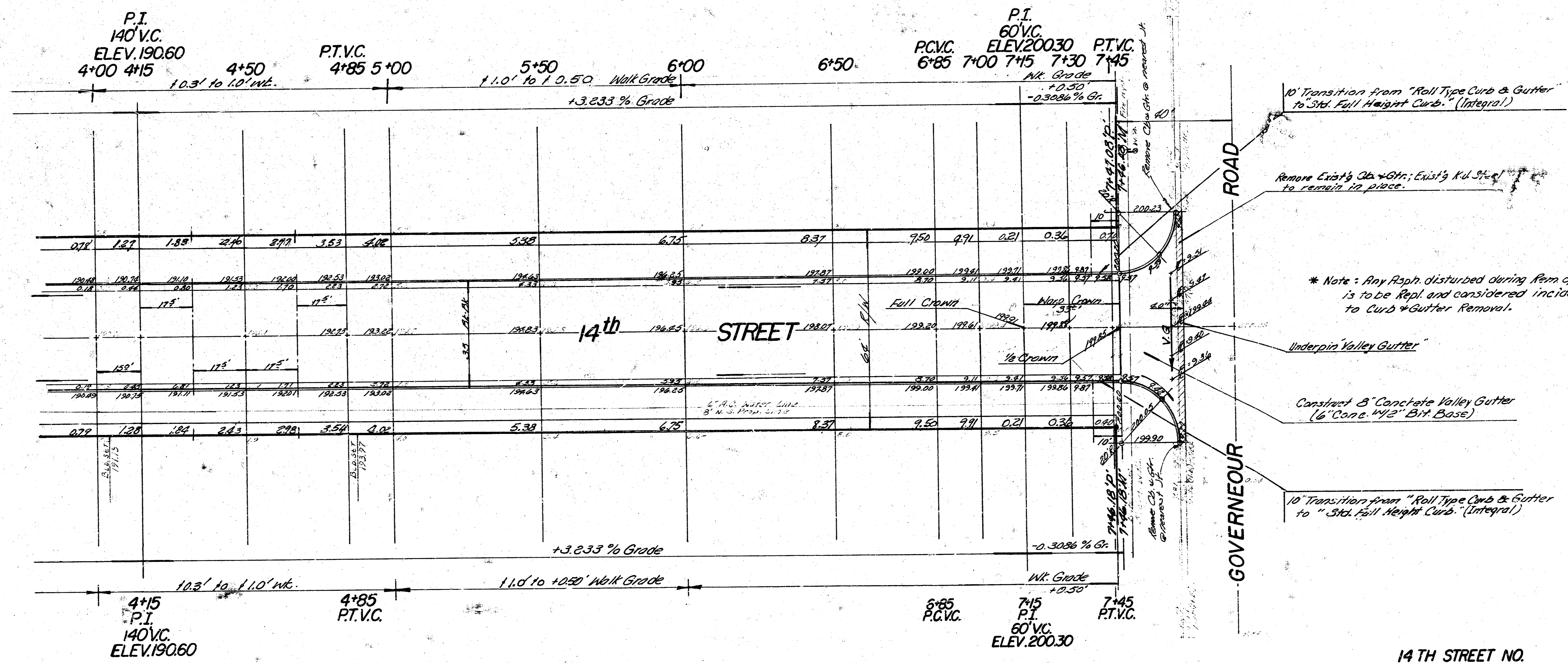

14 TH STREET NO.  
 LARWENCE LN - GOVERNEUR RD.  
 DAKS 576028

3/5

7/3