

17th STREET

E. L. WOOD-W.L. TYLER
DAKS574054

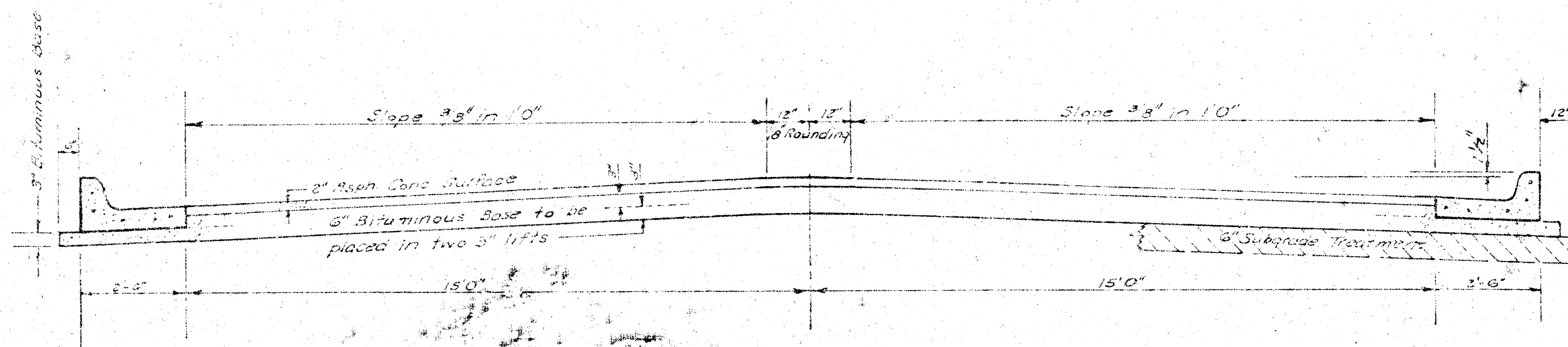

COMBINED CURB & GUTTER

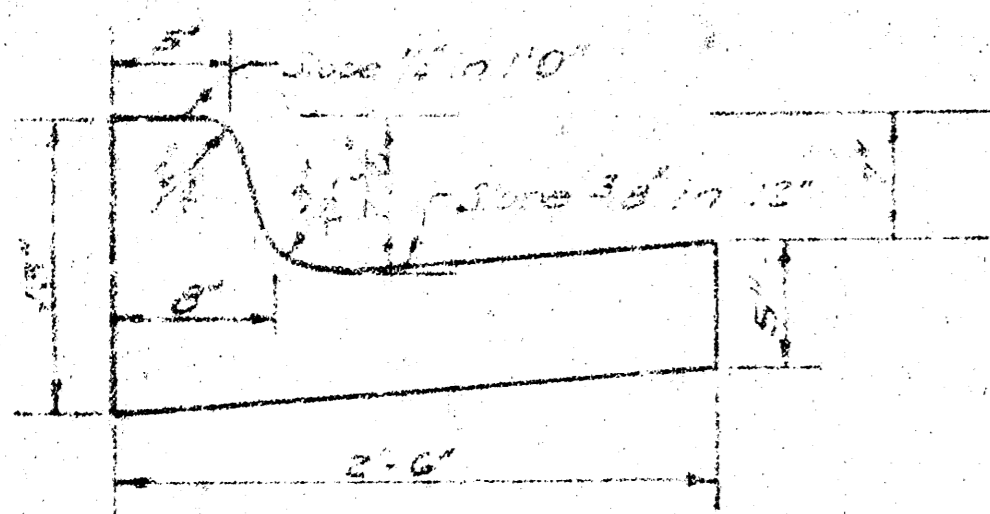

ROLL TYPE CURB & GUTTER

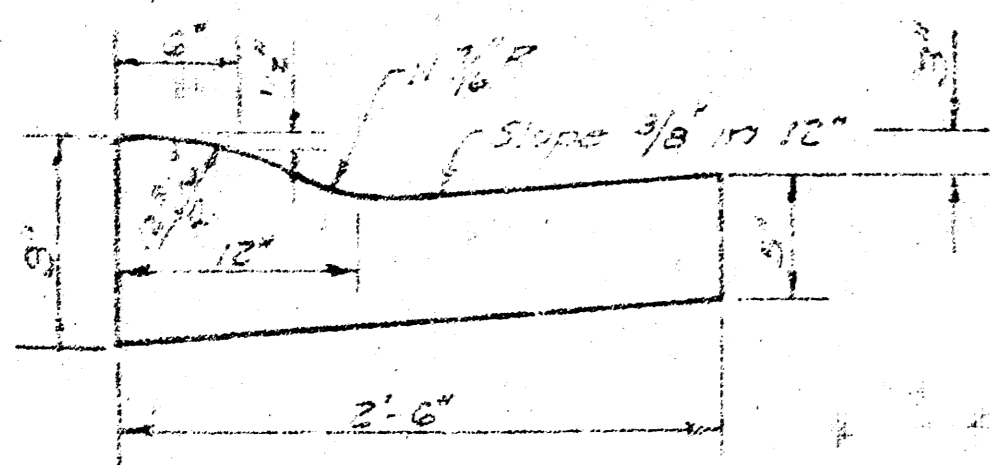

TRANSVERSE SECTION

35' ASPHALTIC CONCRETE PAVEMENT WITH BITUMINOUS BASE

A TACK COAT OF EMULSIFIED ASPHALT (SS-1H) SHALL BE APPLIED AT AN APPROXIMATE RATE 0.05 GALLONS PER SQ YD BETWEEN LIFTS OF ASPHALTIC MATERIALS WHEN ORDERED BY THE ENGINEER. TACK COAT WILL NOT BE PAID FOR DIRECTLY AND SHALL BE CONSIDERED AS SUBSIDIARY TO PRICE BID FOR ASPHALTIC PAVEMENT.

BITUMINOUS BASE AND ASPHALTIC CONCRETE WEARING SURFACE SHALL BE PLACED WITH A LAYDOWN MACHINE HAVING AUTOMATIC ELECTRONIC CONTROLS FOR CROWN AND GRADE. CONSTRUCTION JOINTS IN EACH LIFT SHALL BE STAGGERED A MINIMUM DISTANCE OF 1' WITH JOINTS IN PRECEDING LIFTS AND PLACED SUCH THAT A JOINT WILL BE CONSTRUCTED ON THE CENTERLINE IN THE TOP LIFT.

*The A.C. Pavement between the comb curb & gutter shall be paid as Sq. Yds. 8" A.C. Pavement (4" Bituminous Base).
The Bituminous Base under the comb curb & gutter shall be paid as Sq. Yds. 3" Bituminous Base.*

DETAIL OF TRANSVERSE CONSTRUCTION JOINTS

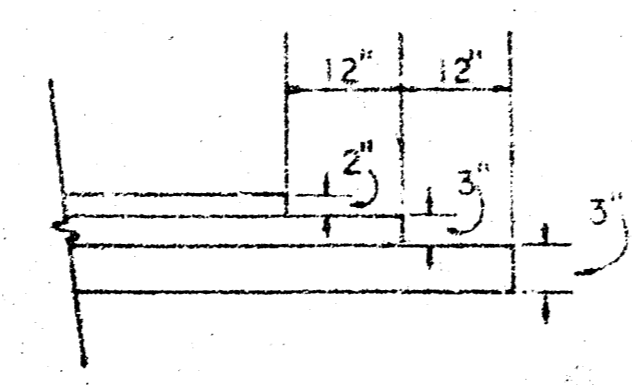

TRANSVERSE CONSTRUCTION JOINTS SHALL BE CONSTRUCTED IN FLEXIBLE BASE PAVEMENTS AT LOCATIONS WHERE PAVEMENT TEMPORARILY ENDS TO FACILITATE FUTURE PAVEMENT CONSTRUCTION AS SHOWN BY DETAIL. THE COST OF CONSTRUCTING THE TRANSVERSE CONSTRUCTION JOINTS SHALL NOT BE MEASURED OR PAID FOR DIRECTLY BUT SHALL BE INCLUDED IN THE BID PRICE FOR SQUARE YARDS OF ASPHALTIC CONCRETE PAVEMENT.

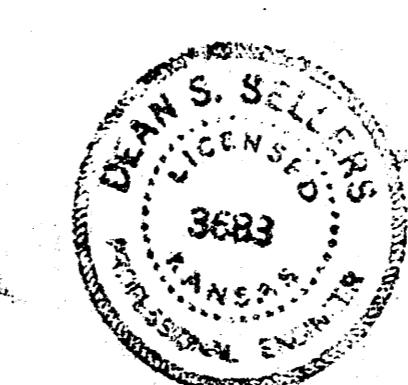

CITY OF WICHITA KANSAS
DEPARTMENT of PUBLIC WORKS - Engineering
Division.
R. W. LINN CITY ENGINEER
DATE *June 1976* Proj. No. DAKS574054

B-M

B.M. 172.48 City Std. 17th. & Tyler, 31' So. & 36' E. of 1/4 Sec. Cor.
 @ is @ 17th. St.

Δ = 202.62 R. = 230.57 T. = 78.69 L. = 153.46 LC. = 170.64

CURVE DATA BASED ON		E		RAD. Δ = 7.024	
STA	ARC	CHORD LENGTH	CHORD BEARS	DEFLECTION	TOTAL DEFLECTION
1+00	-	-	-	-	0°00'00"
1+25	25.00	27.70	22.28	3°06'22"	3°06'22"
1+50	-	-	-	3°06'22"	6°12'44"
1+75	-	-	-	3°06'22"	9°19'07"
2+00	-	-	-	3°06'22"	12°25'29"
2+25	-	-	-	3°06'22"	15°31'52"
2+50	25.00	27.70	22.28	3°06'22"	18°38'14"
2+75	3.46	3.84	3.08	0°35'46"	19°04'02"

Def'n. 7.83887 Min. 17

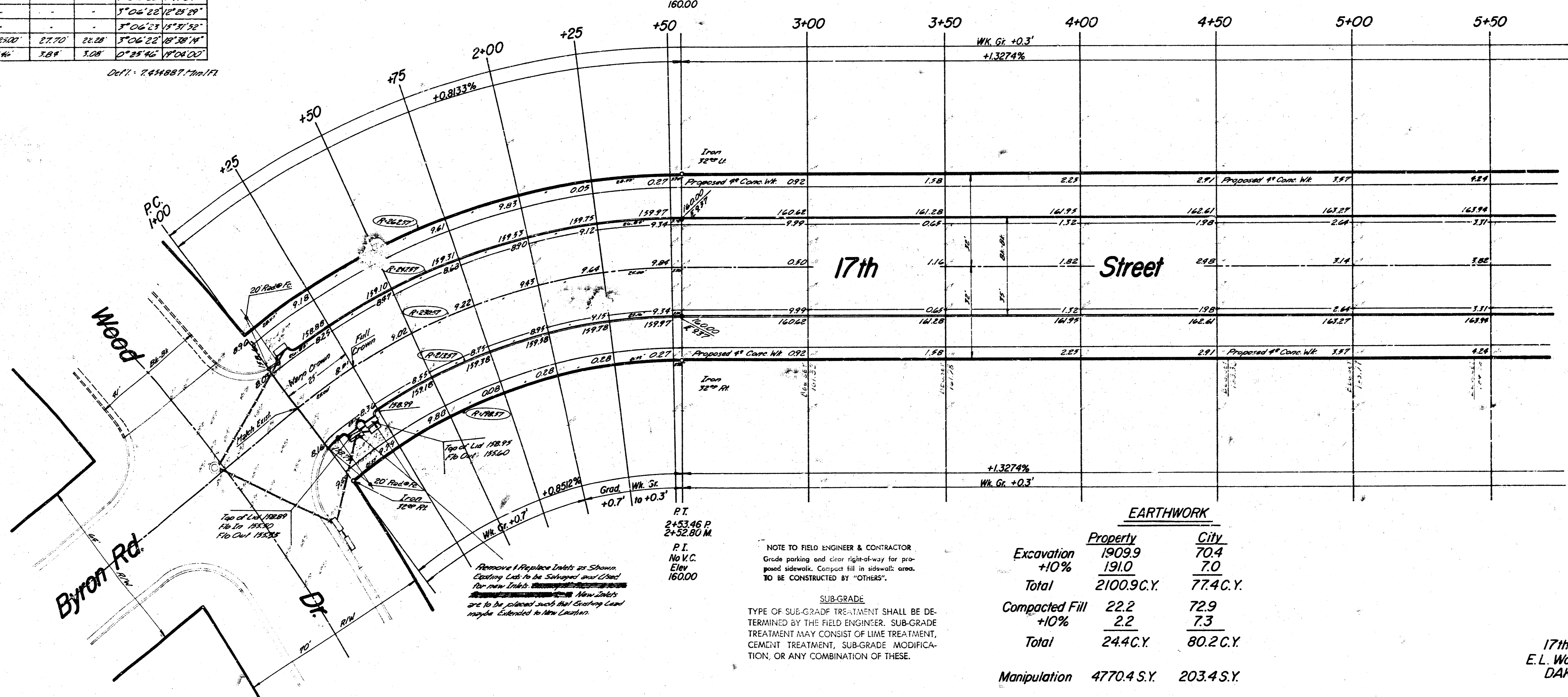
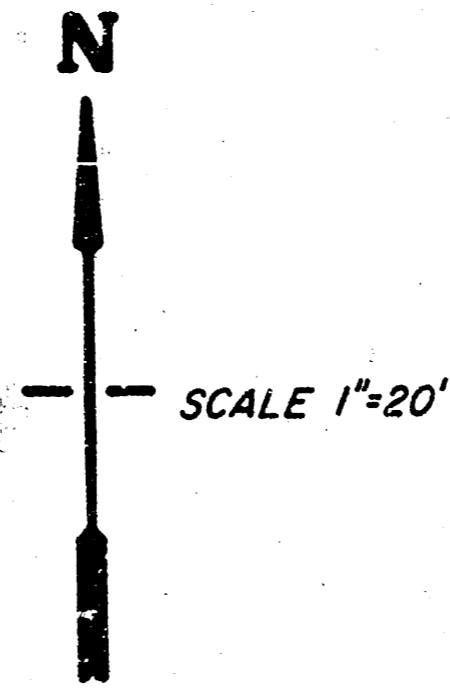

P.T.
 2+53.46 P
 2+52.80 M
 P.I.
 No V.C.
 Elev.
 160.00

P.T.
 2+53.46 P
 2+52.80 M
 P.I.
 No V.C.
 Elev.
 160.00

NOTE TO FIELD ENGINEER & CONTRACTOR
 Grade parking and clear right-of-way for proposed sidewalk. Compact fill in sidewalk areas. TO BE CONSTRUCTED BY "OTHERS".

SUB-GRADE
 TYPE OF SUB-GRADE TREATMENT SHALL BE DETERMINED BY THE FIELD ENGINEER. SUB-GRADE TREATMENT MAY CONSIST OF LIME TREATMENT, CEMENT TREATMENT, SUB-GRADE MODIFICATION, OR ANY COMBINATION OF THESE.

	EARTHWORK	
	Property	City
Excavation	1909.9	70.4
+10%	191.0	7.0
Total	2100.9 C.Y.	77.4 C.Y.
Compacted Fill	22.2	72.9
+10%	2.2	7.3
Total	24.4 C.Y.	80.2 C.Y.
Manipulation	4770.4 S.Y.	203.4 S.Y.

17th Street
 E.L. Wood-W.L. Tyler
 DAKS574054

Survey
 Plan
 Exc.
 Check

B.M. 172.48 City Std. 17th. & Tyler, 31' So. & 36' E. of 1/4 Sec. Cor.
 @ is @ 17th St

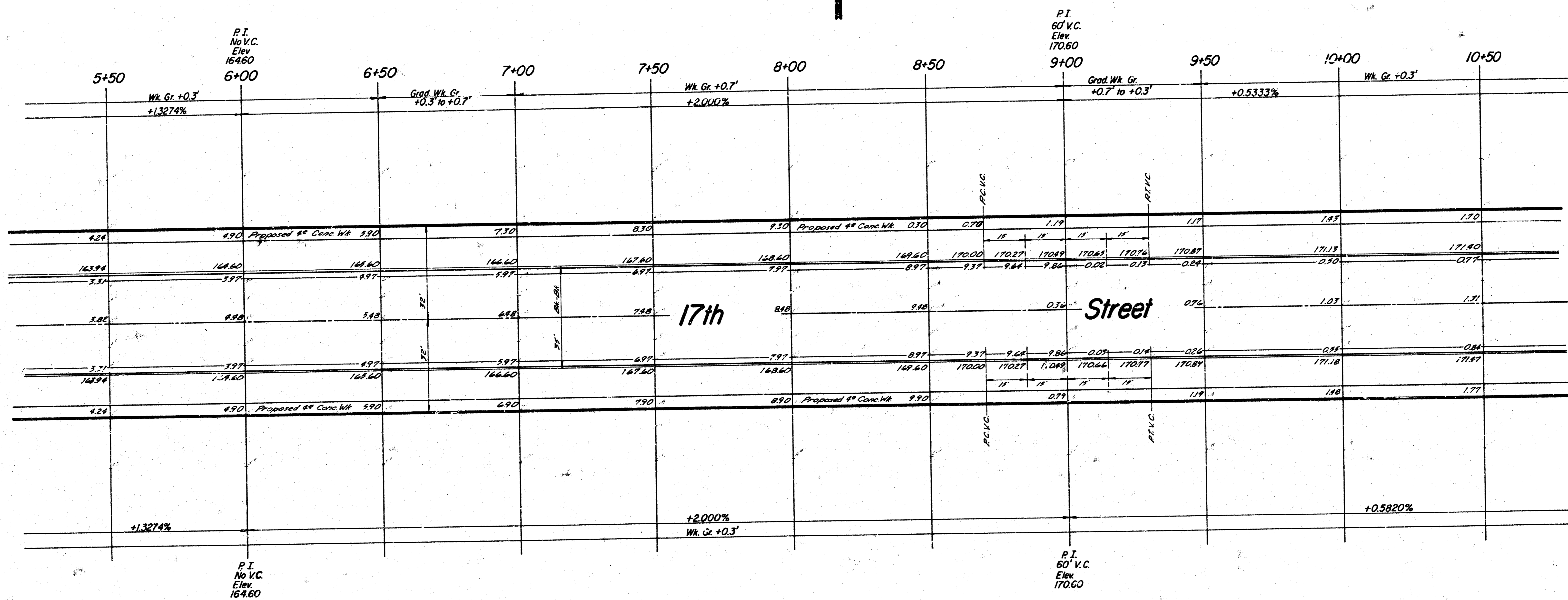
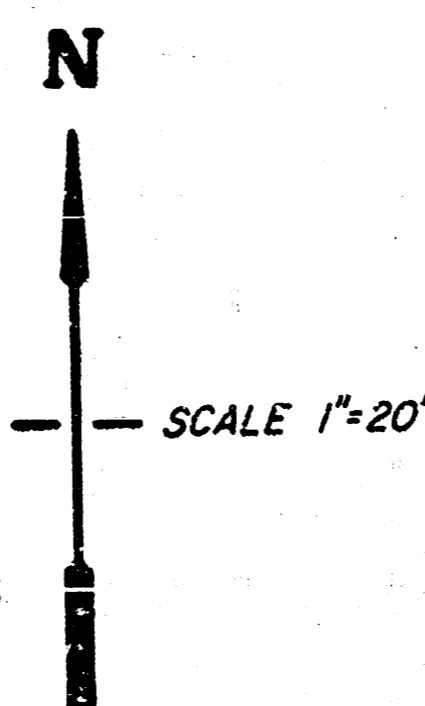

17th Street
 E.L. Wood-W.L. Tyler
 DAKS574054

B.M. 172.48 City Std. 17th & Tyler, 31' So. & 36' E. of 1/4 Sec. Cor.
 * B is @ 17th St.

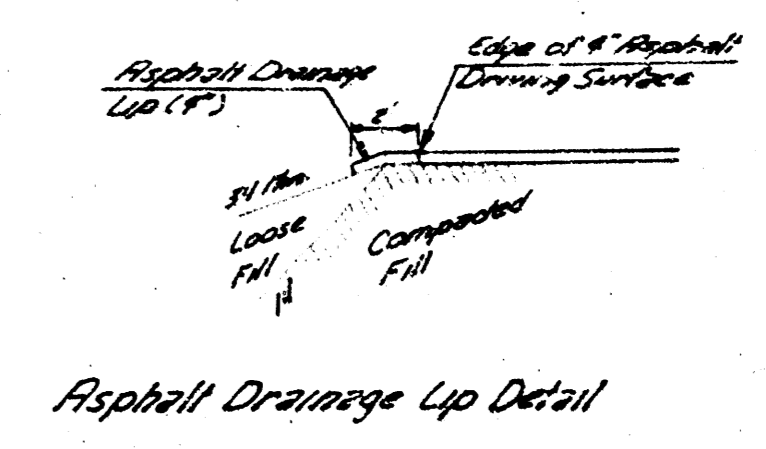
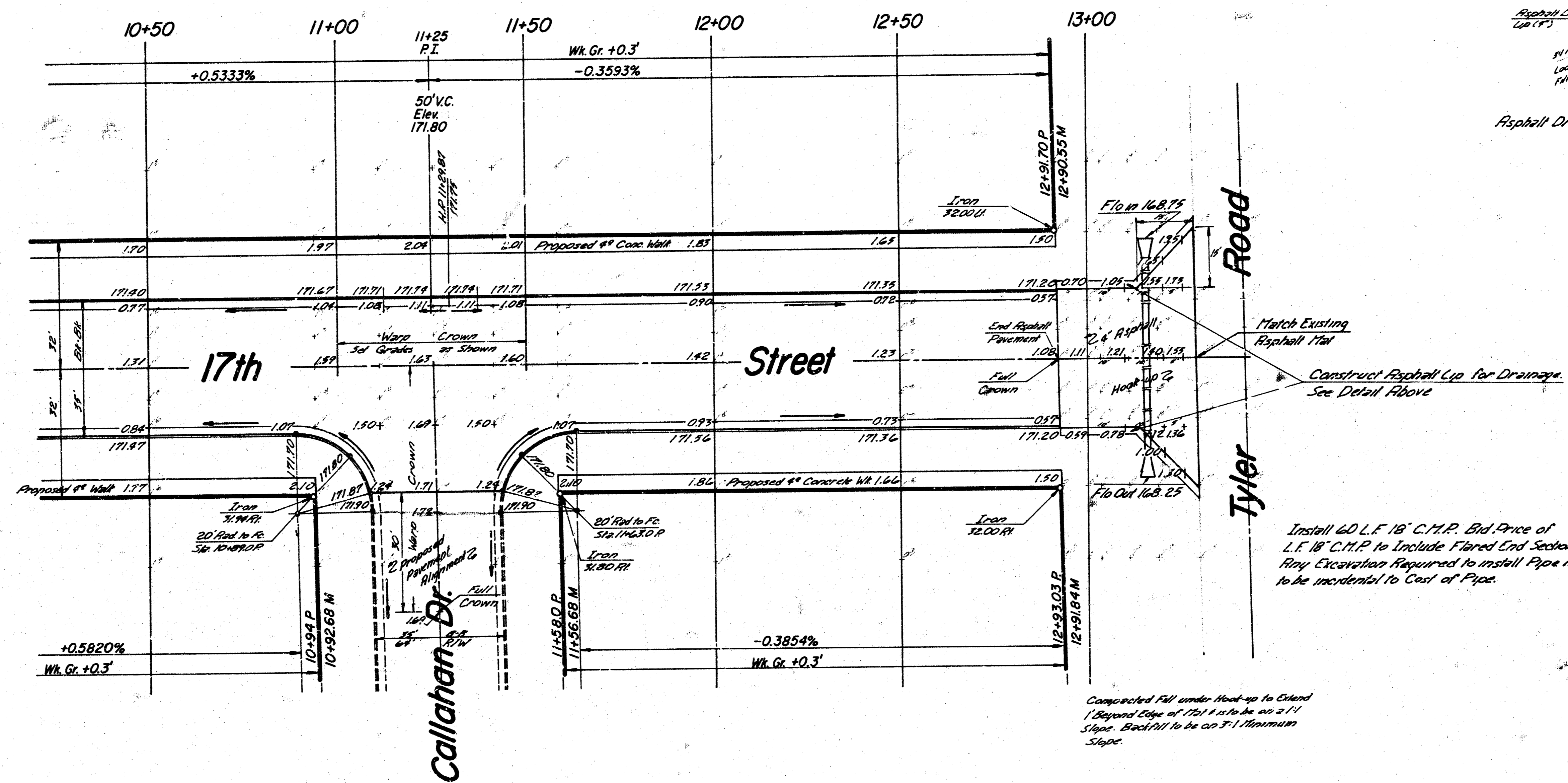
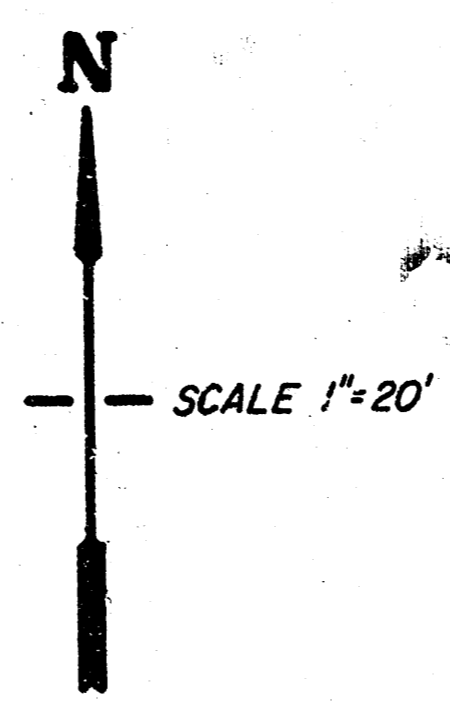

17th Street
 E. L. Wood - W. L. Tyler
 DAKS574054