

BT. 118.17 1/2" IN KEELAR 4 BK OF BK OF WY SW COR 15TH & WOODLAND
 ST. 120.50 1/2" IN 1926 BK OF WY SO. SW COR. 17TH & WOODLAND

N

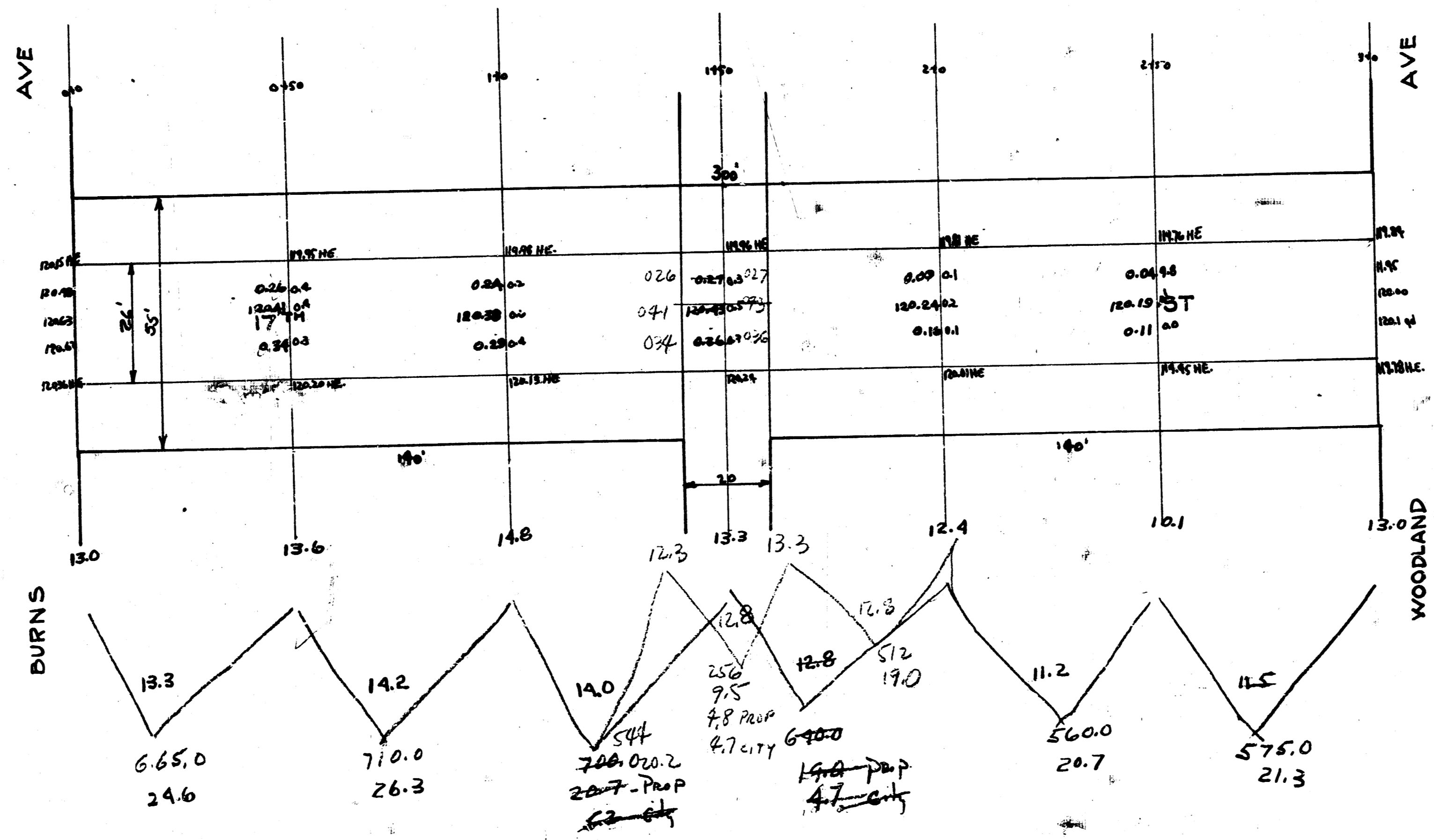

Prop
 24.6
 26.3
 19.0
 20.7
 21.3
 Total 132.6

City
 5.2
 2.7
 9.9
 Total 17.8

17TH ST
 EL. BURNS TO W. WOODLAND
 26' CONCRETE
 CITY OF WICHITA, KANSAS
 LK WHITE CITY ENGINEER
 APRIL 1947

