

James Young - 6587
 City Engineer
 City of Wichita, Kansas

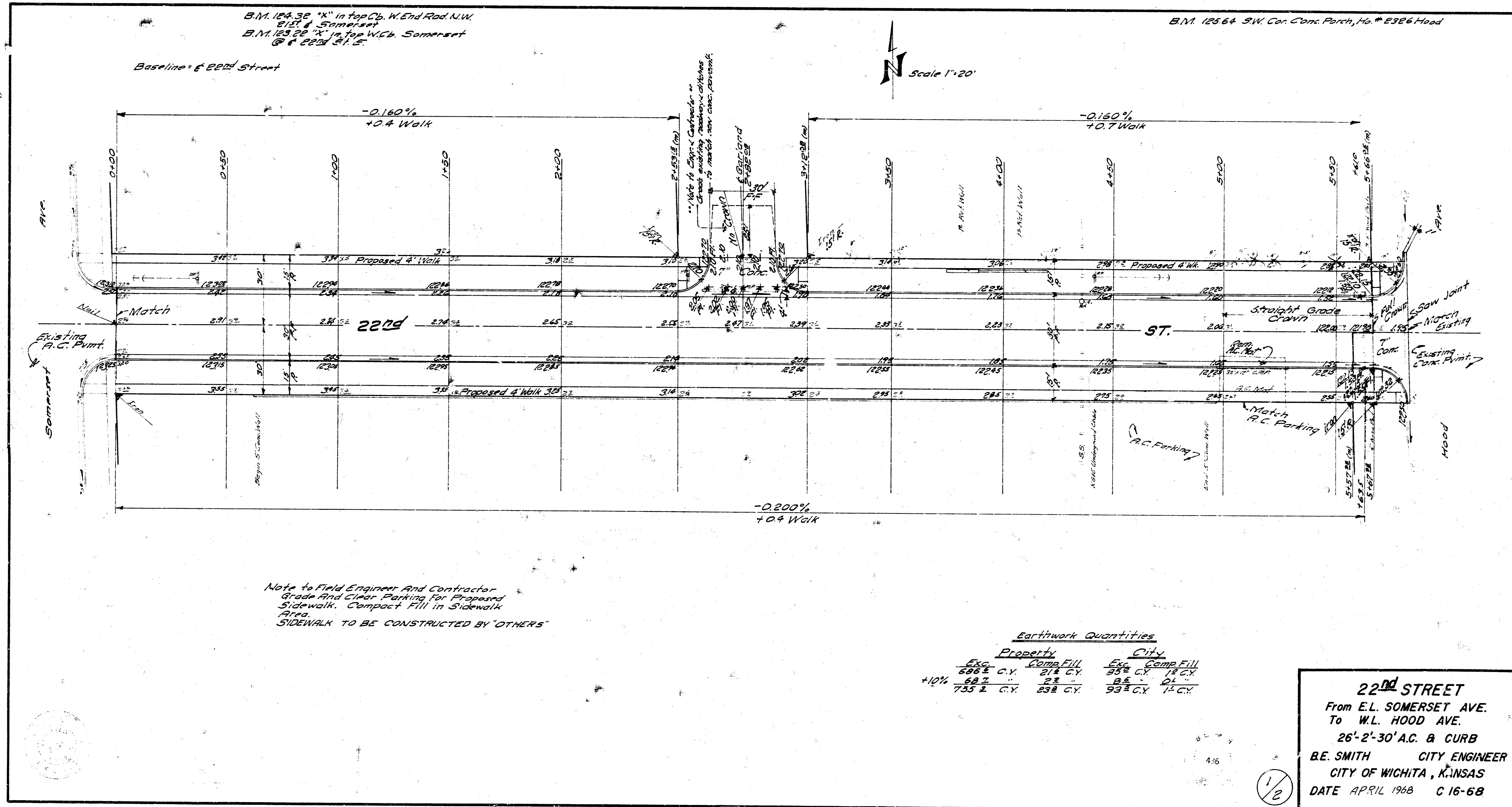

B.M. 164.30 "K" in Top Cb. W. End Rod. N.W. 1/4 of Somerset
 B.M. 163.28 "X" in Top W. Cb. Somerset @ E. 22nd St. E.
 Baseline: E. 22nd Street

B.M. 125.64 SW. Cor. Conc. Porch, Ho. # 2326 Hood

Scale 1"=20'

Note to Field Engineer And Contractor
 Grade And Clear Parking for Proposed
 Sidewalk. Compact Fill in Sidewalk
 Area.
 SIDEWALK TO BE CONSTRUCTED BY "OTHERS"

Earthwork Quantities

Property		City	
Exc.	Comp. Fill	Exc.	Comp. Fill
596 1/2 C.Y.	21 1/2 C.Y.	23 1/2 C.Y.	18 C.Y.
+10% 655 1/2 C.Y.	23 1/2 C.Y.	26 1/2 C.Y.	21 C.Y.
755 1 C.Y.	23 1/2 C.Y.	23 1/2 C.Y.	18 C.Y.

22nd STREET
 From E.L. SOMERSET AVE.
 To W.L. HOOD AVE.
 26'-2"-30' A.C. & CURB
 B.E. SMITH CITY ENGINEER
 CITY OF WICHITA, KANSAS
 DATE APRIL 1968 C 16-68

1/2