

B.M. 124.95 R.R. SPIKE E.S. COTTONWOOD 75' N. OF N.E. CORNER AMIDON & 23<sup>RD</sup>

CHAIN E. ON N. R.

Prop. 30' CONC. & CB.

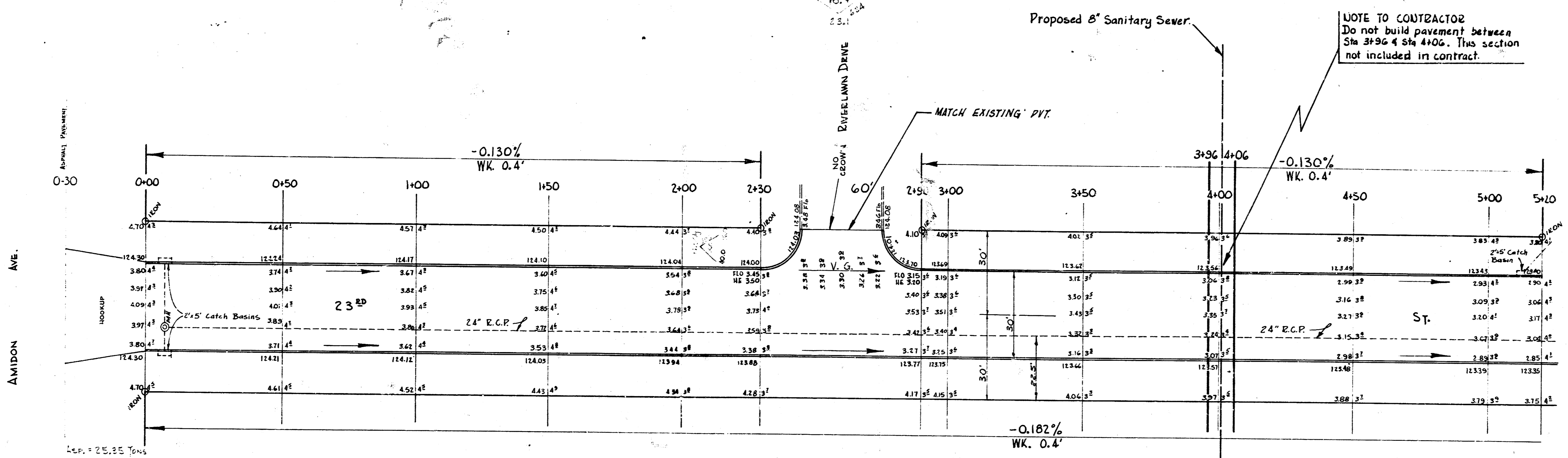

NOTE TO CONTRACTOR  
Do not build pavement between  
Sta 3+96 & Sta 4+06. This section  
not included in contract.



Survey Done by B. W. A. ...

$\frac{23 \times 40}{2} \times 30 \times 0.333 \times \frac{1.45}{1000} = 25.35 \text{ TONS}$   
 $\frac{26 \times 40}{2} \times 30 \times \frac{1.45}{1000} = 30.3 \text{ TONS}$

TOTAL EXCAV.

Prop.	CITY
+10%	+10%
15,777 CuYd	15,777 CuYd



23<sup>RD</sup> ST.  
E.L. AMIDON - W.L. COOLIDGE  
30' CONC. & CB.  
CITY OF WICHITA, KANS.  
B. E. SMITH CITY ENGINEER  
MARCH, 1955 PROJ. NO. C-13-173

1  
2

