

P.M. 12285-5140 Corch 2nd P. Poly M. of 23rd E.S. Hillside
 O.M. 14035-5141 Cor. Pavch No. 336 E. 23rd E. Hillside
 O.M. 14035-5142 in 1929 N. Co. 23rd Hillside of E.L. Chautauquis
 O.M. 14035-5143 in Globe 3. Co. 23rd E.L. Hillside

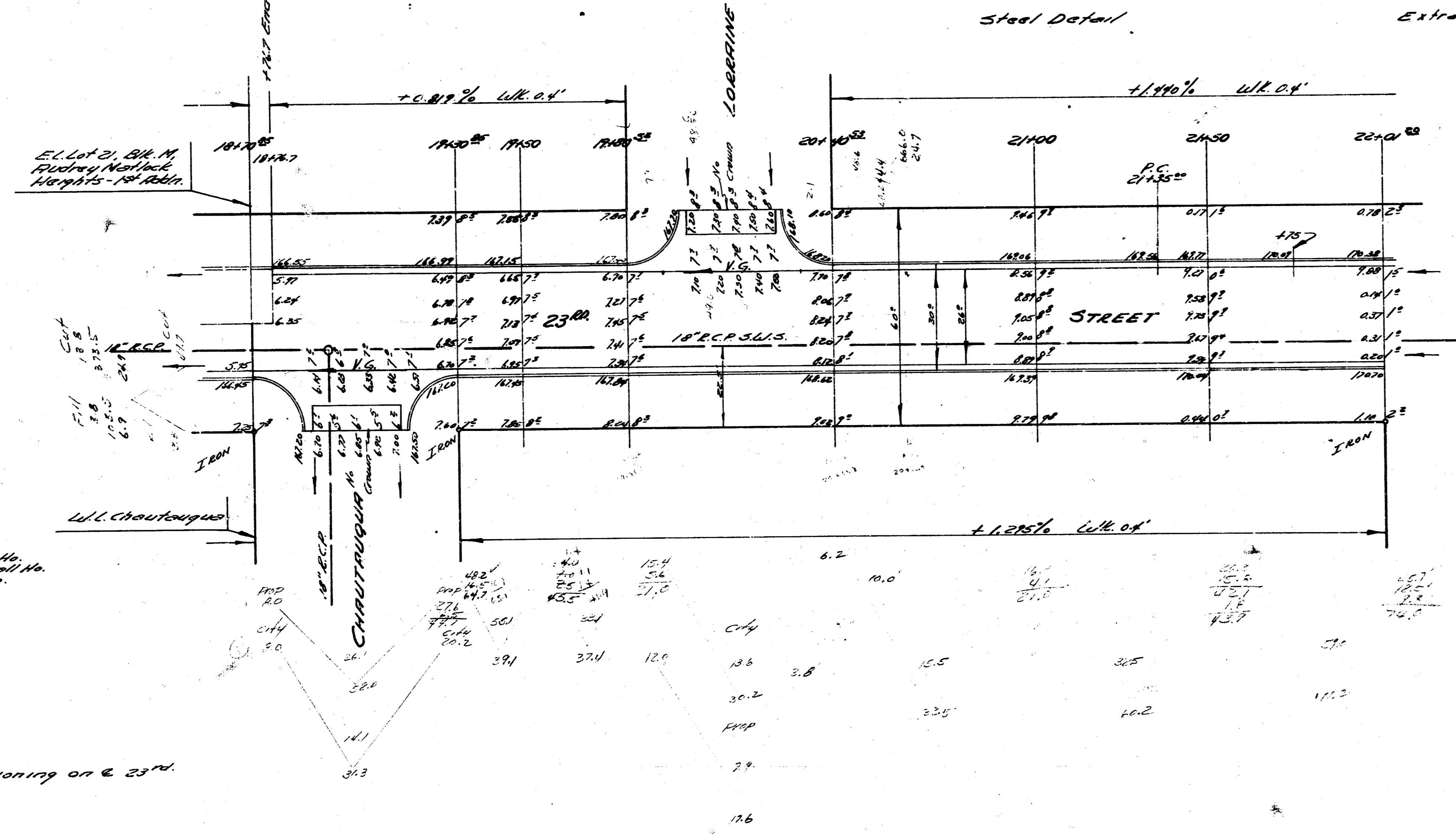
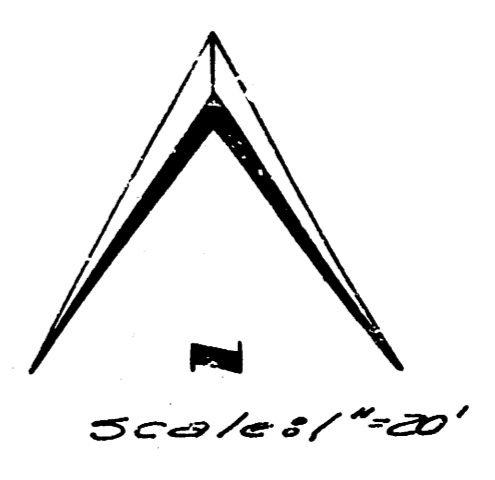
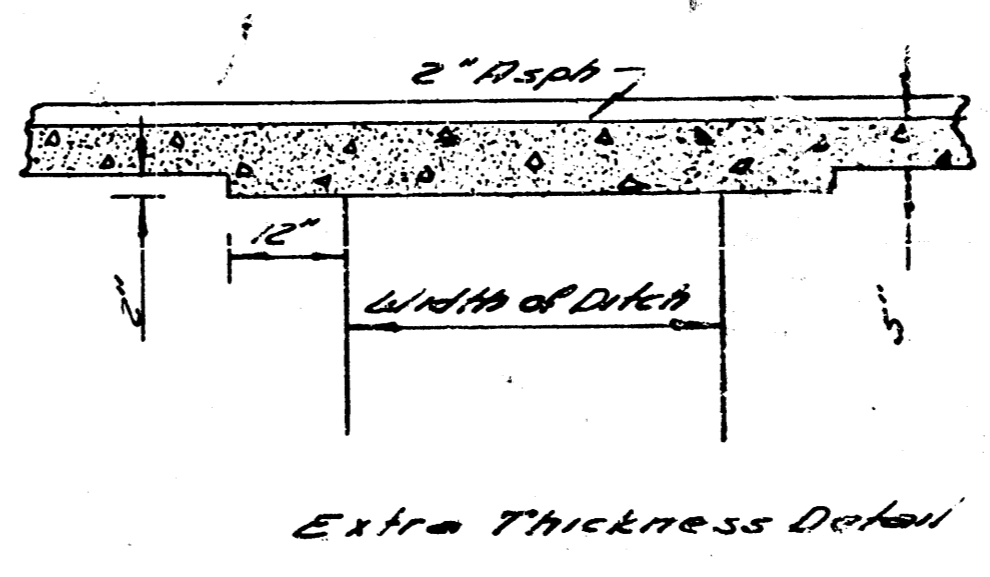
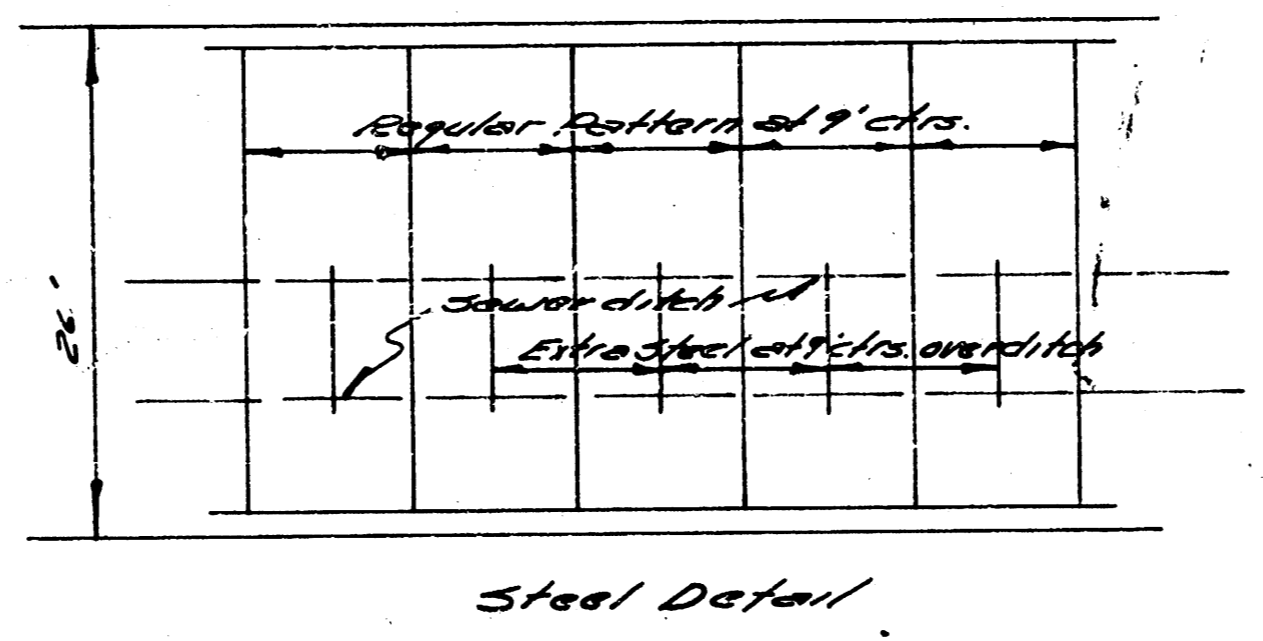

ESTIM. EXC. (cu. yds.)

CITY		PROP.	
Cut	Fill	Cut	Fill
172.7	3.8	422.4	14.4
17.4	0.4	4.2	1.4
190.1	4.2	426.6	15.8
		430.8	17.2

533.4

TIES TO IRONS
 W.L. Chautauquis
 45.32 N. to bk. of N. Co.
 54.37 N.W. to bk. of N. Co.
 E.S. Const. Joint.
 W.L. Hillside
 44.55 N.E. to N.W. Cor. No.
 61.27 W. to N.E. Cor. Small No.
 42.85 S.W. to S.E. Cor. No.

NOTE -
 Stationing on E. 23rd

23rd ST.
 E.L. Lot 21, Blk. M, Audrey
 Matlock Heights 1st Addn.
 to W.L. Hillside Ave.
 CITY OF LICHITA, KANS.
 26-2-30 P.C.
 B.E. Smith City Engineer
 July 1953 Proj. No. C15-78



1 of 2

Sunny Carr, Bk. No. 1
 Plan No. 100
 Checked J.T.

