

Survey: Hansen Book 14164
 Plan: Summit & Brewer 54
 C.E.:
 Checked: Family

Base Line - Right R. of 24th St.
 B.M. 180.55 "R" in Ritchie, So. Cb., 24th & W.L. Oliver.

Note:
 Contractor to clear right of way, grade parking & compact fill for proposed sidewalk. Sidewalk to be constructed by others.

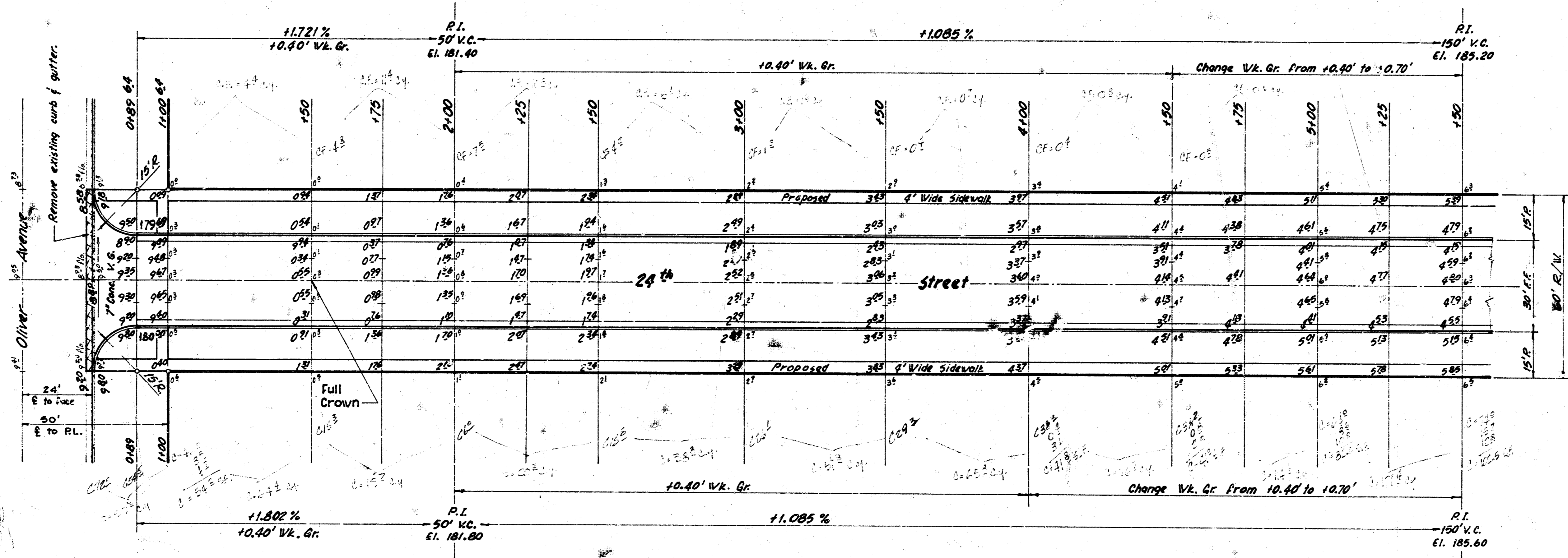

Earthwork

	Property		City	
	Excavation	Compacted Fill	Excavation	Compacted Fill
Plus 10%	1,454.0 C.Y.	55.3 C.Y.	144.8 C.Y.	-
Sub-Total	1,599.4 C.Y.	38.8 C.Y.	159.3 C.Y.	-
Add S.G.M.				
Totals	1,599.4 C.Y.	38.8 C.Y.	159.3 C.Y.	0.0 C.Y.

Note: Treat Sub-grade with "Lime"

24th Street E.L. of Oliver to
 E.L. of Bleckley.
 26'-2'-30" Asphaltic Concrete
 City of Wichita, Kansas.
 B. E. Smith City Engineer
 Date: July 1949 Project No. C19-103
 Sheet 1 of 2



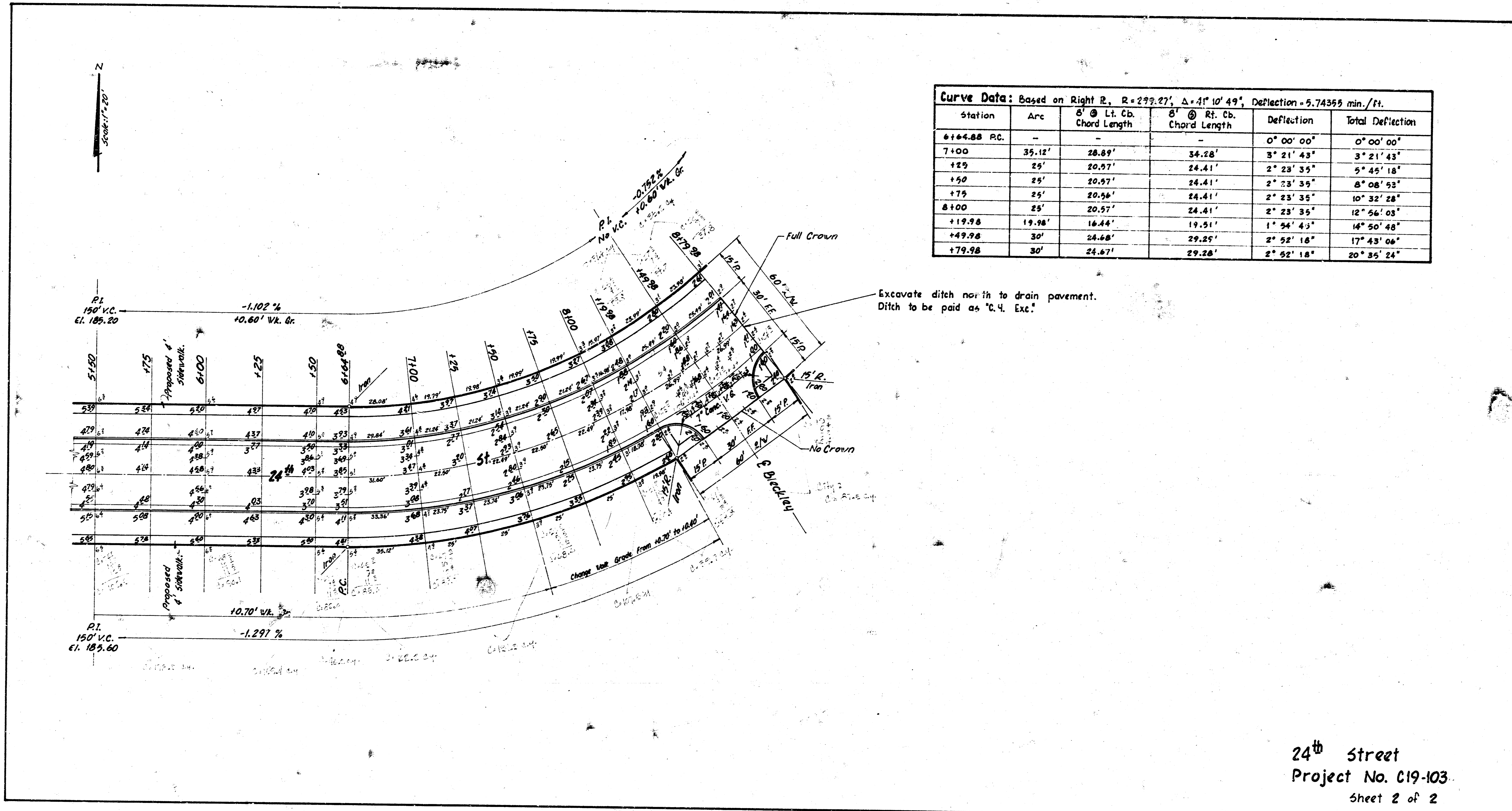

24th Street
 Project No. C19-103
 Sheet 2 of 2