

B.M. 128.99 NW COR CONC PORCH, HQ. ON N.E. COR. 25TH & HALSTEAD

NOTE TO FIELD ENGINEER:
 RE-X-SECTION PROJECT BEFORE BEGINNING CONSTRUCTION.
 AFTER CONSTRUCTION, RE-X-SECTION NORTH MEDIAL STRIP.

NOTE TO CONTRACTOR & FIELD ENGINEER

BOTTOM OF PAVT. IS 4" ABOVE TOP OF 48" WATER LINE. NO WORK IS TO BE PERFORMED ON PROJECT UNTIL INTERSECTION IS COMPLETED. ALL WORK ON INTERSECTION TO BE PERFORMED SO AS TO WORK AWAY FROM THE WATER LINE. NO EQUIPMENT TO CROSS WATER LINE FOR ANY REASON.

3/4" Ø BARS, 25' LONG, ON 4.5' CENTERS.

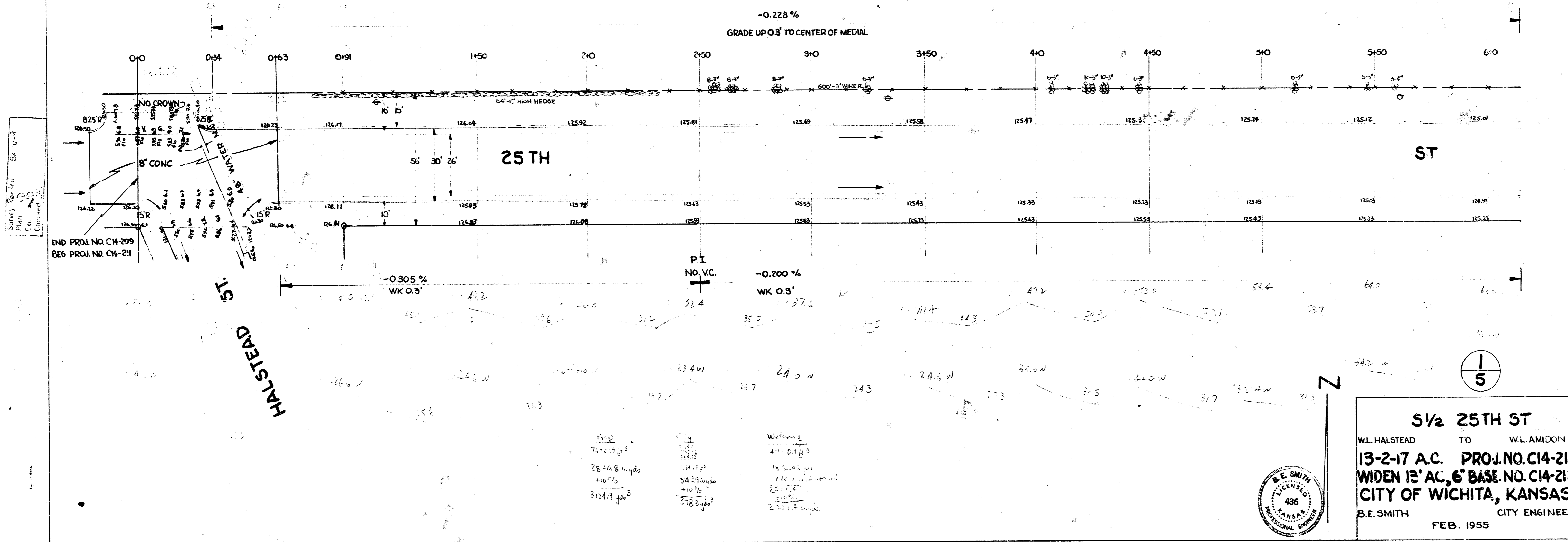

1/5

S 1/2 25TH ST
 W.L. HALSTEAD TO W.L. AMIDON
13-2-17 A.C. PROJ. NO. C14-211
WIDEN 13' AC, 6' BASE NO. C14-212
CITY OF WICHITA, KANSAS
 B.E. SMITH CITY ENGINEER
 FEB. 1955



NOTE:

INSTALL 2x5 INLETS AT CLARENCE AVE AS SHOWN. LEAD SIZES ARE SHOWN ON PLAN. INSTALL 15" STUBS ON NORTH CURB INLETS.

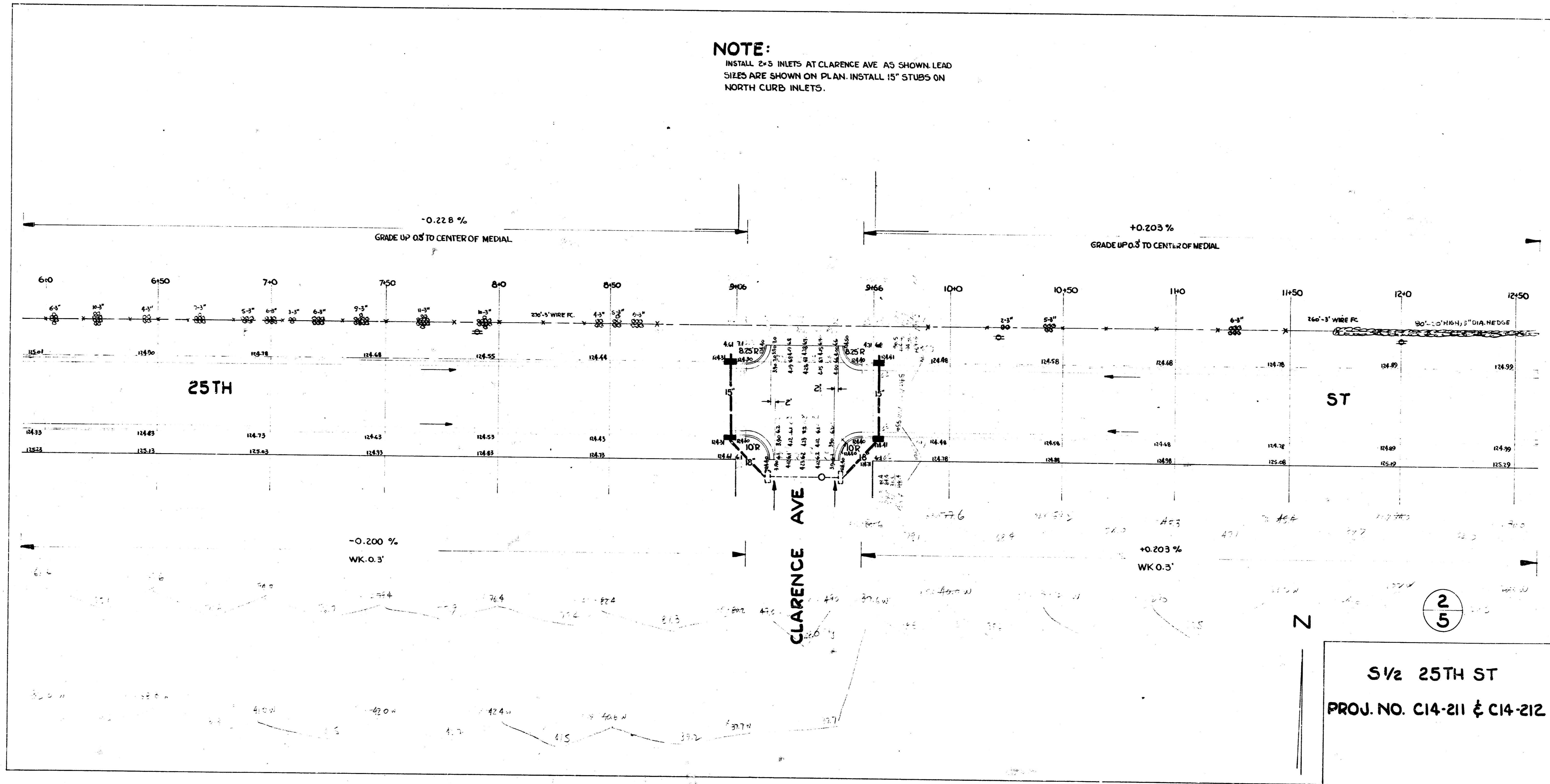

B.M. 12711 R.R. SPIKE E.S. 10' COTTONWOOD, S.E. COR 24TH & AMIDON
 T.P. 12576 'X' ON PVT. APPROX 70' N. MANHATTAN ON W.S. AMIDON

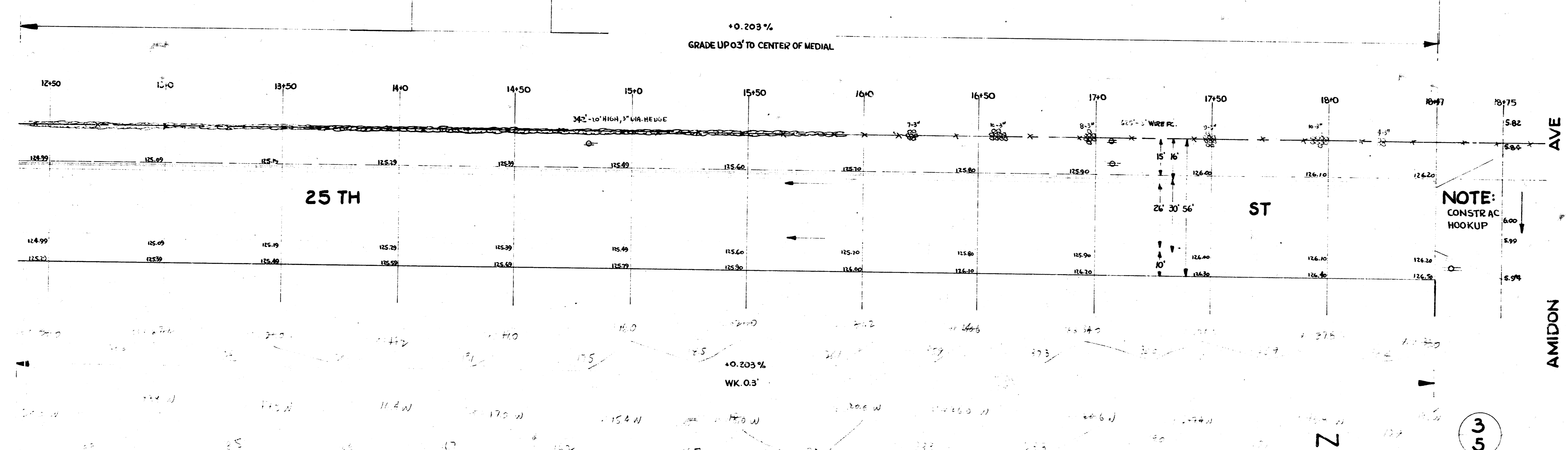

NOTE:
 CONSTR AC
 HOOKUP

3
 5

1/2 25TH ST
 PROJ. NO. C14-211 & C14-212