

27 TH. ST. NORTH

38'-0" ASPHALTIC CONCRETE

W. L. GROVE TO  $\phi$  VOLUTSIA

PROJ. C18-63

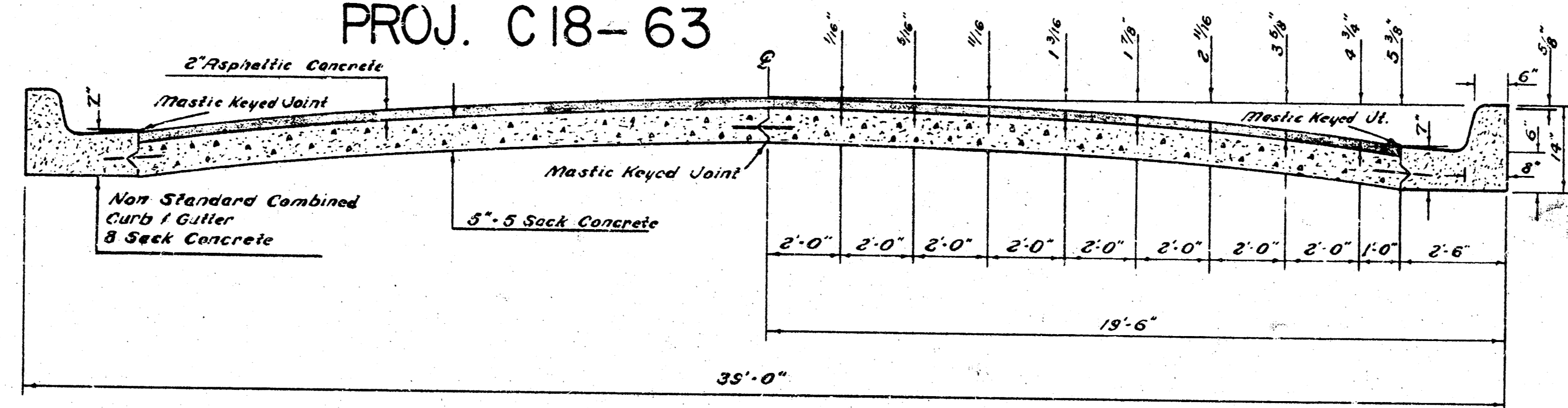

TYPICAL SECTION  
Not to Scale

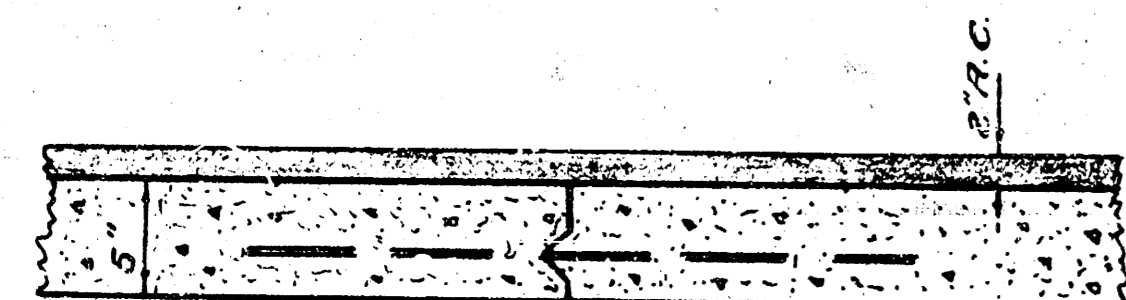

DETAIL of KEYED JOINT  
no scale

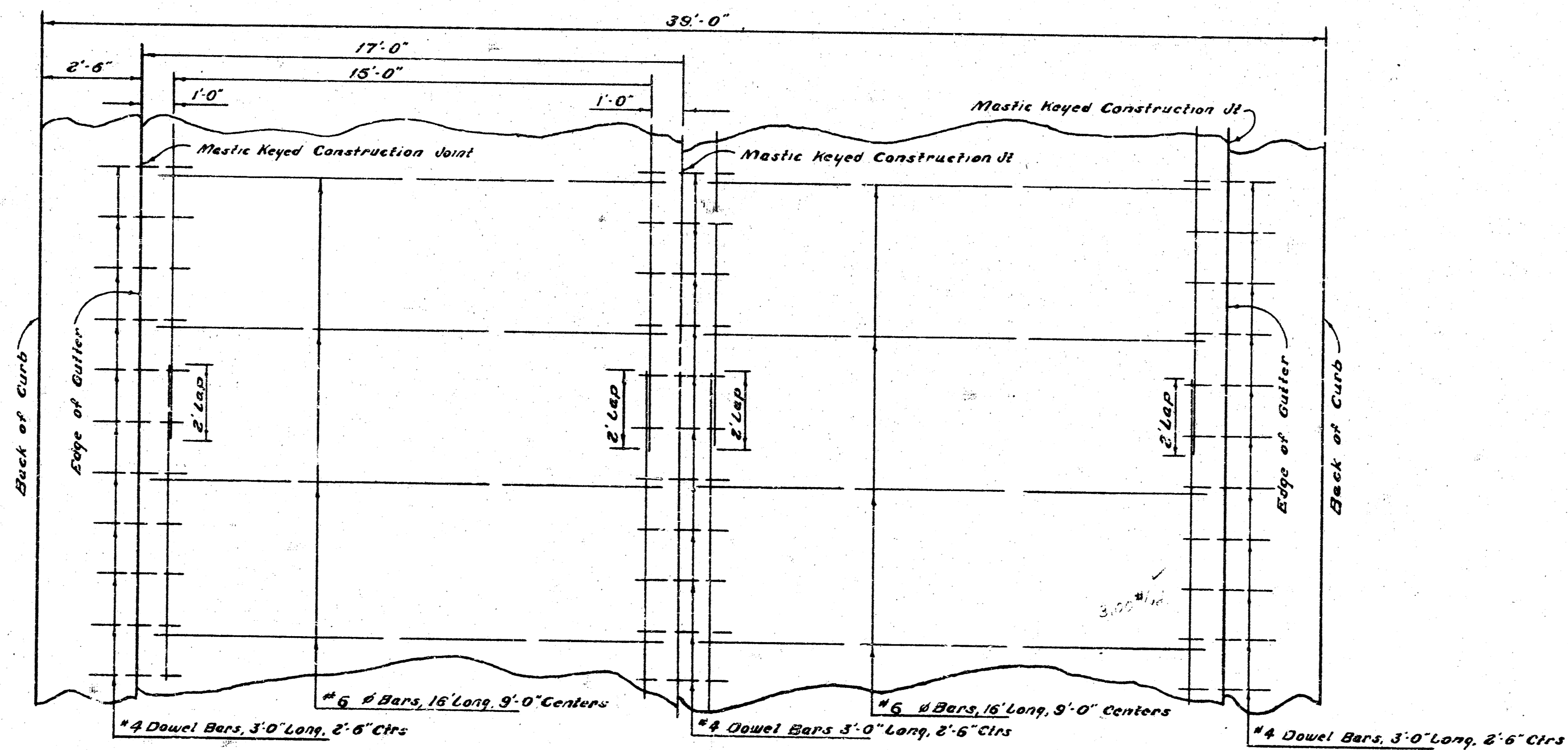

STEEL PATTERN

Not to Scale  
Use #6  $\phi$  Bars Except  
Where Noted

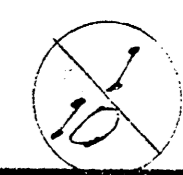
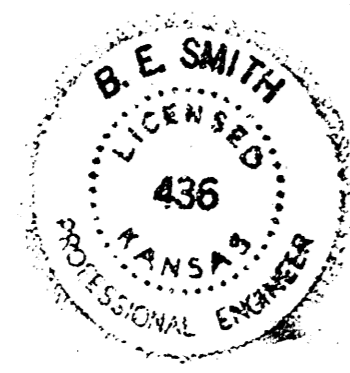
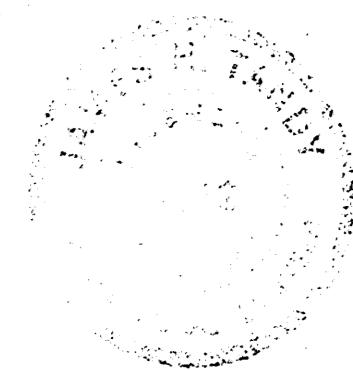

B.M. 141.65 City Std. on S.E. Cor. Grove @ 27th St. No.  
 B.M. 155.51 R.R. Spk. E Side Lg Elm Tree on SW Cor. 27th & Grove  
 B.M. 151.77 "a" Cut Top W. Cb. Poplar 3 S. of S.L. 27th St. No.

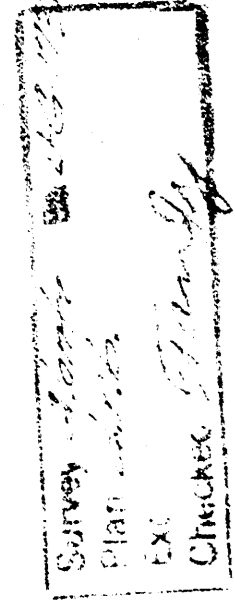

Scale 1" = 20'

- Ties To Iron @ 27th & Grove
- 77.89 S.W. to nail in bottle cap NW side 15' 6 1/2"
  - 56.77 S.E. to "a" cut in See N.E.S.P. 27th

drain to drain

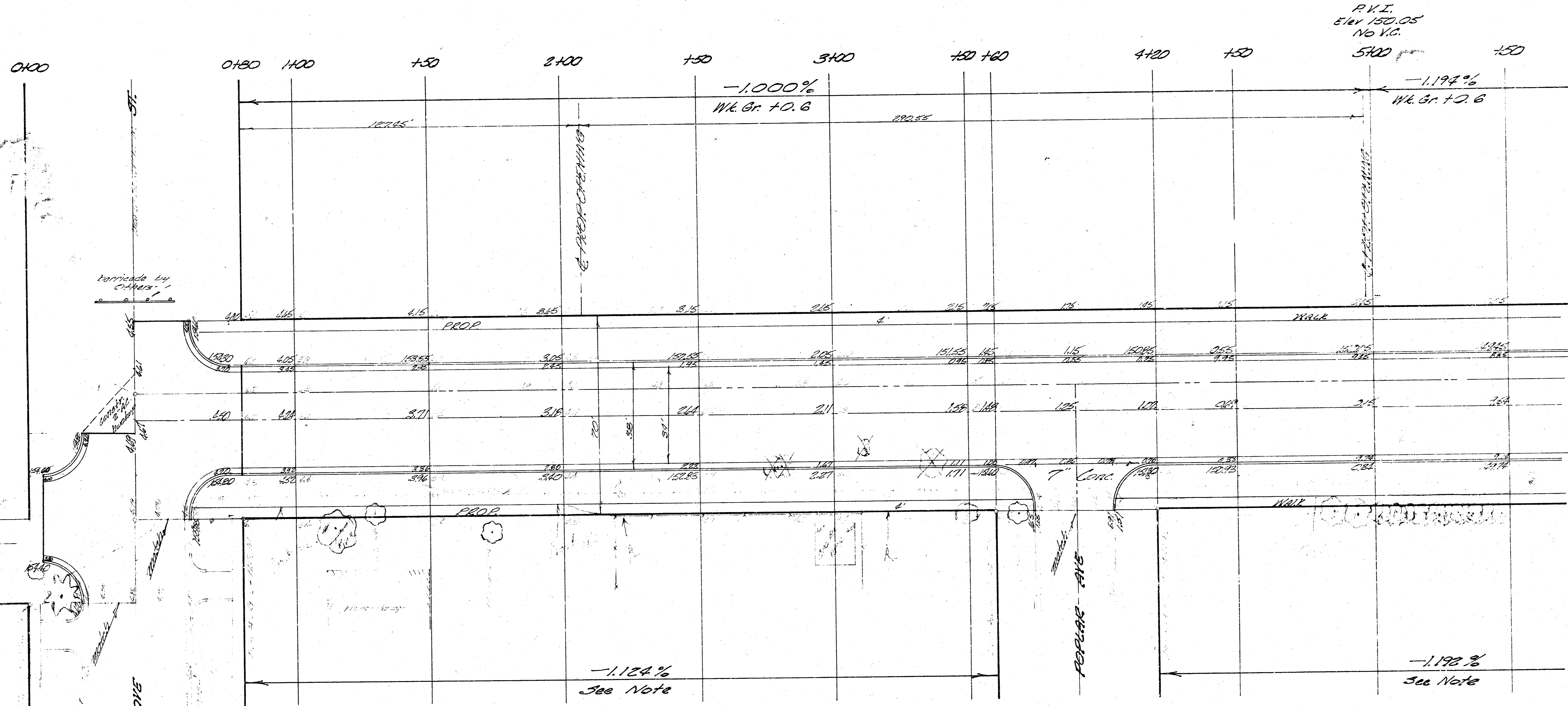

**NOTE TO FIELD ENGR:**

Field Engr to take walk profile and determine the grading limits for parking grading on S. side 27th St. No. IF Drives are requested set walk grade @ +0.7' above top of curb & grade parkings accordingly.  
 Field Engr to take final 'X' Sections on South Parking from drain to Volutsia

**NOTE TO CONTRACTOR:**

Grade parkings & clear R/W for proposed walk. Compact all backfill in sidewalk as shown on 'X' Sections. Walk to be constructed by Others

**EXCAVATION**

PROP. 388.9 C.Y.  
 388.9 +10%  
 4277.9 C.Y.

CITY 680.6 C.Y.  
 68.1 +10%  
 748.7 C.Y.

**CONR. FILL**

PROP. 161.5 C.Y.  
 16.2 +10%  
 177.7 C.Y.

CITY 7.9 C.Y.  
 0.8 +10%  
 8.6 C.Y.

**27TH ST NORTH  
 W.L. GROVE TO & VOLUTSIA  
 34' - 2' - 38' A.C.**

**CITY OF WICHITA, KANSAS  
 B. E. SMITH CITY ENGINEER  
 DATE AUG. 1968 PROJ. C13-63**

B.M. 148.53 R.R. Spk N. Side Wood St. Light Pole SW. Cor Green & 27th St. No.  
 B.M. 146.00 "D" Cut Bk 4' W. E. Side Estelle @ S.L. 27th St. No.

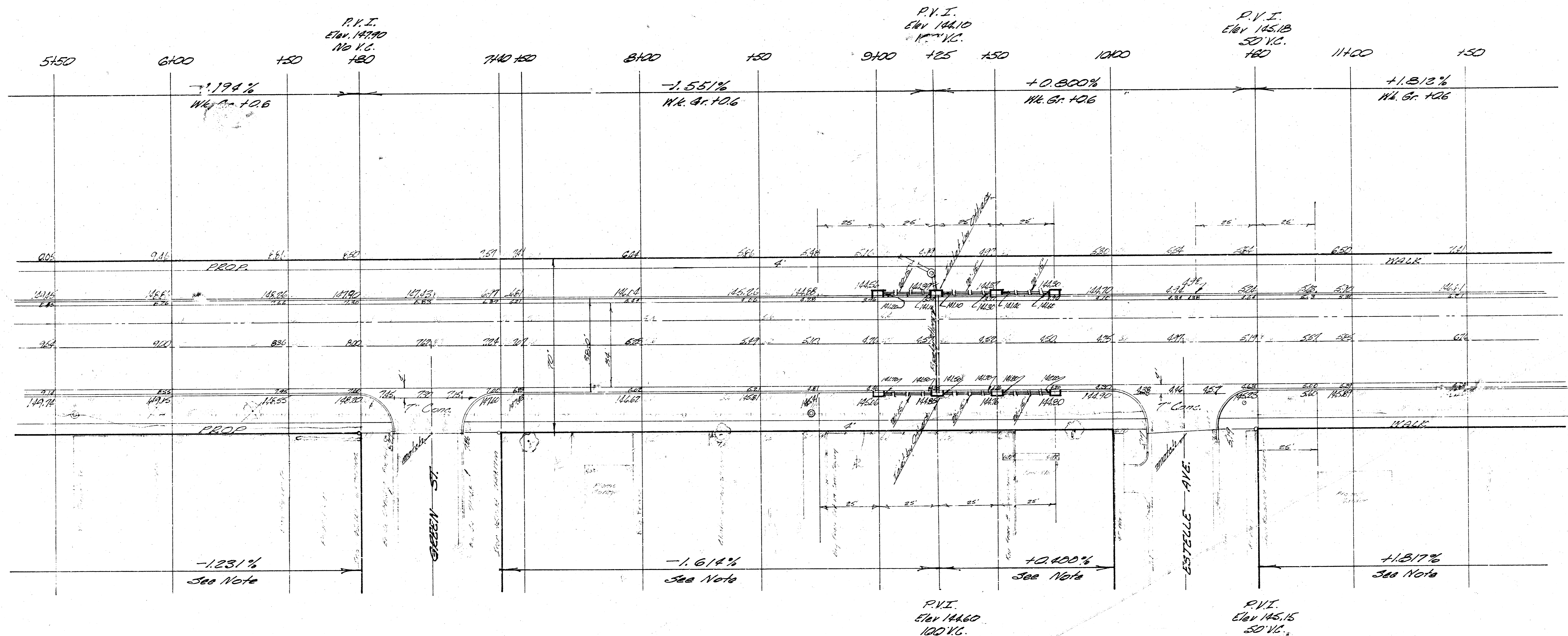

**NOTE TO CONTRACTOR**  
 Install 120' - 15" R.C.P. &  
 Construct 6" - 2x5' Inlets

B.M. 151.14 R.R. Spk. 3. side Wood St Light Pole SW Cor 27th & Volusia

- View to Iron @ 27th & Volusia
1. 4217 SW 75' rail in bottle cap at SW Cor. of Light Pole
  2. 4218 SW 75' rail in bottle cap at SW Cor. of Light Pole
  3. 510' E To Nail in bottle cap. Nails @ 8" to 12"

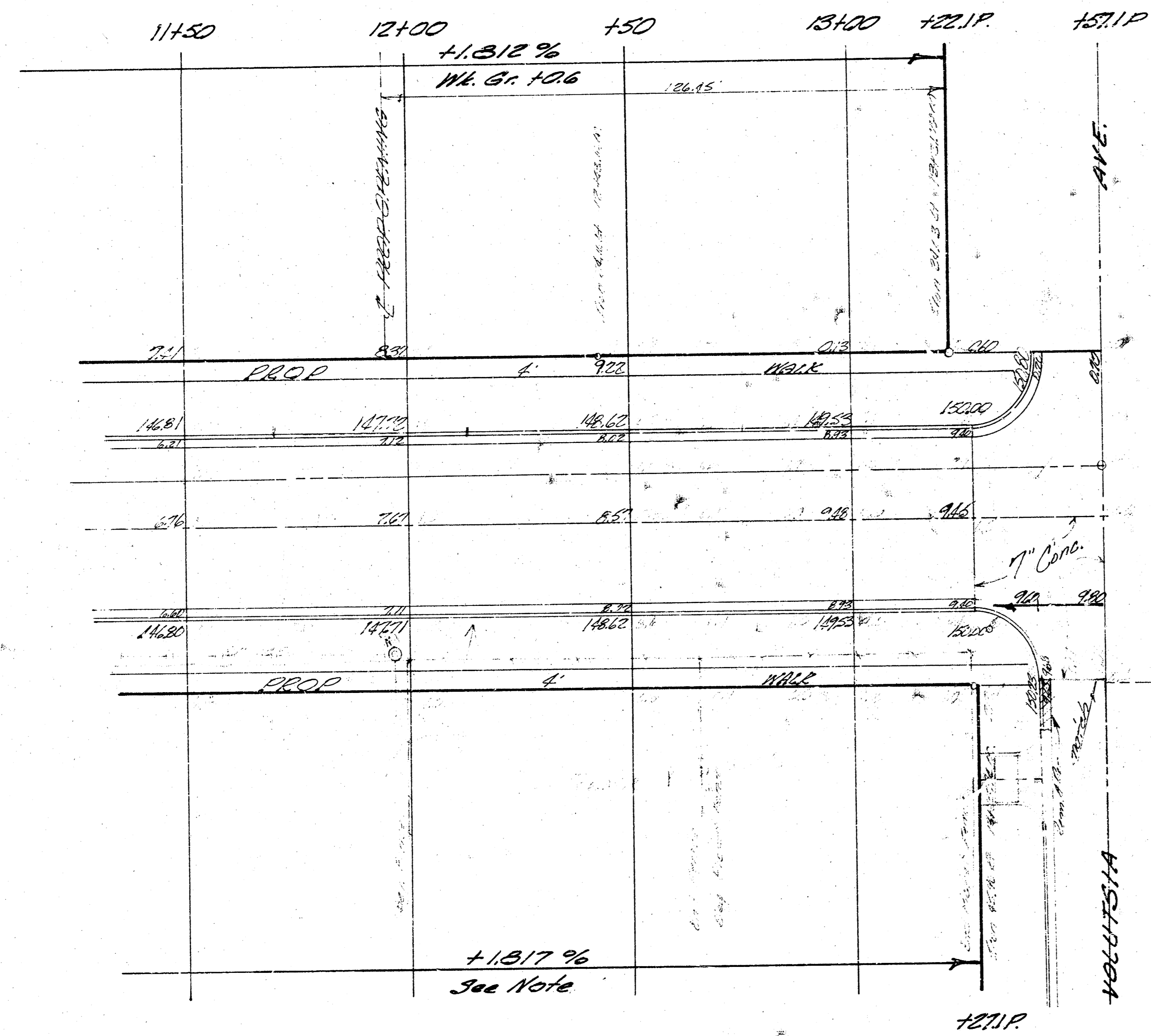

165

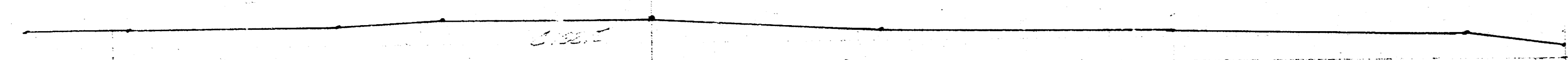

0160.1 East Co. Grove South

175

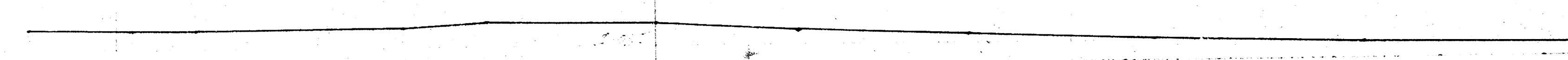

0147

155

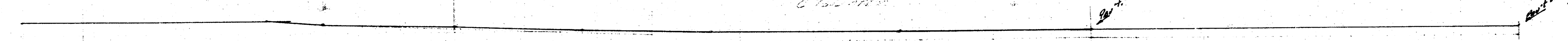

114. 0131.15 & Grove

155



0129

155

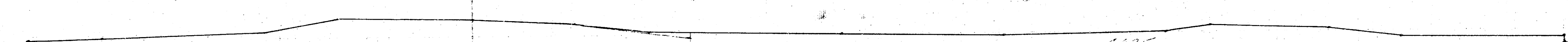

0113.5 Mcb. Grove South

155

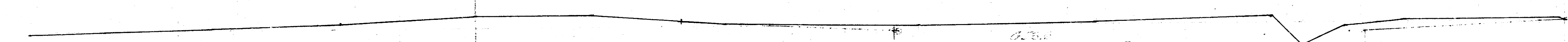

-0100.85

10 20 30 40 50 60 70 80

01<sup>st</sup> Baseline 44.26' N of S R East

NOV 19 1955

105

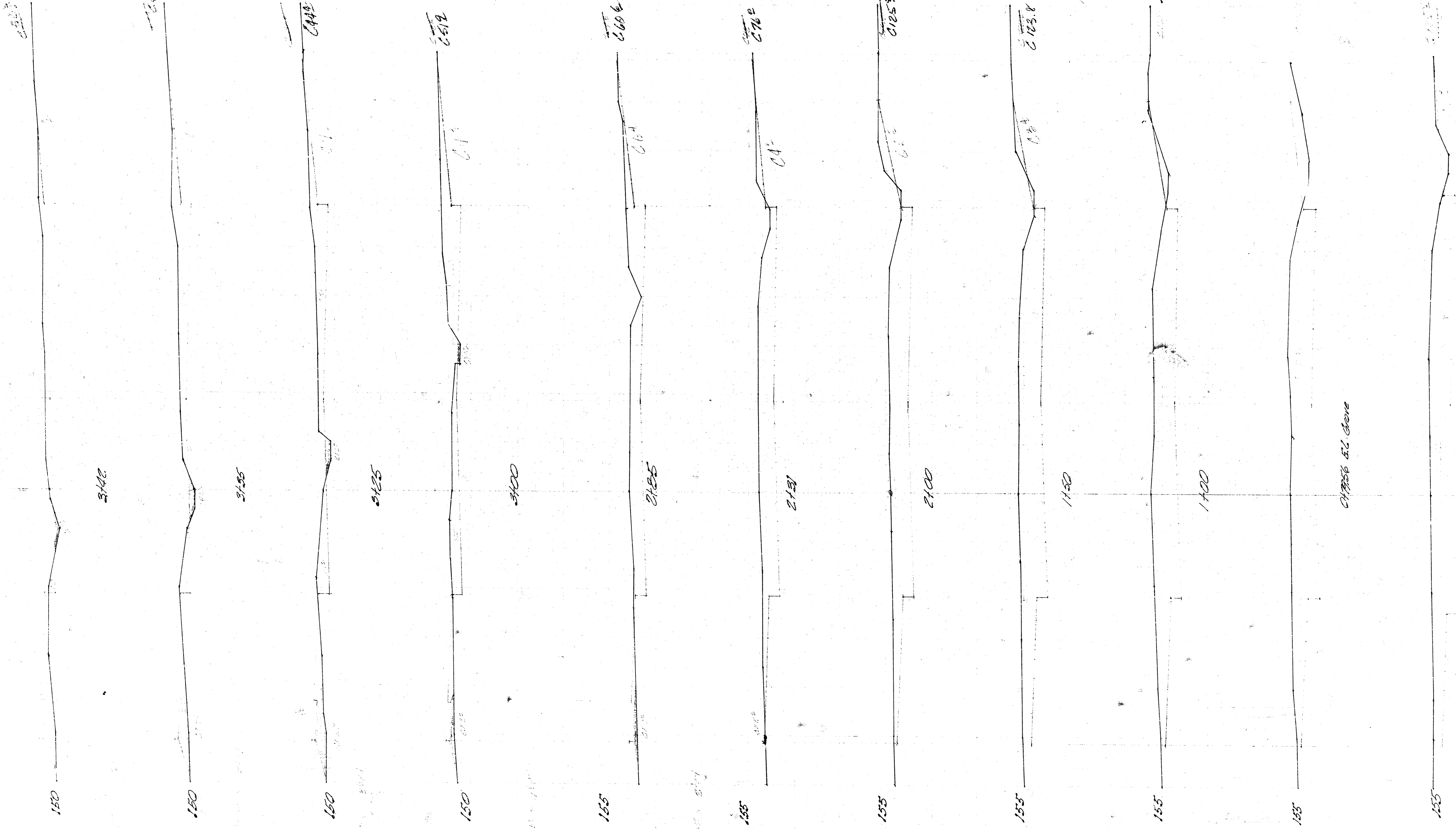

20 30 40 50 60 70 80 90 100

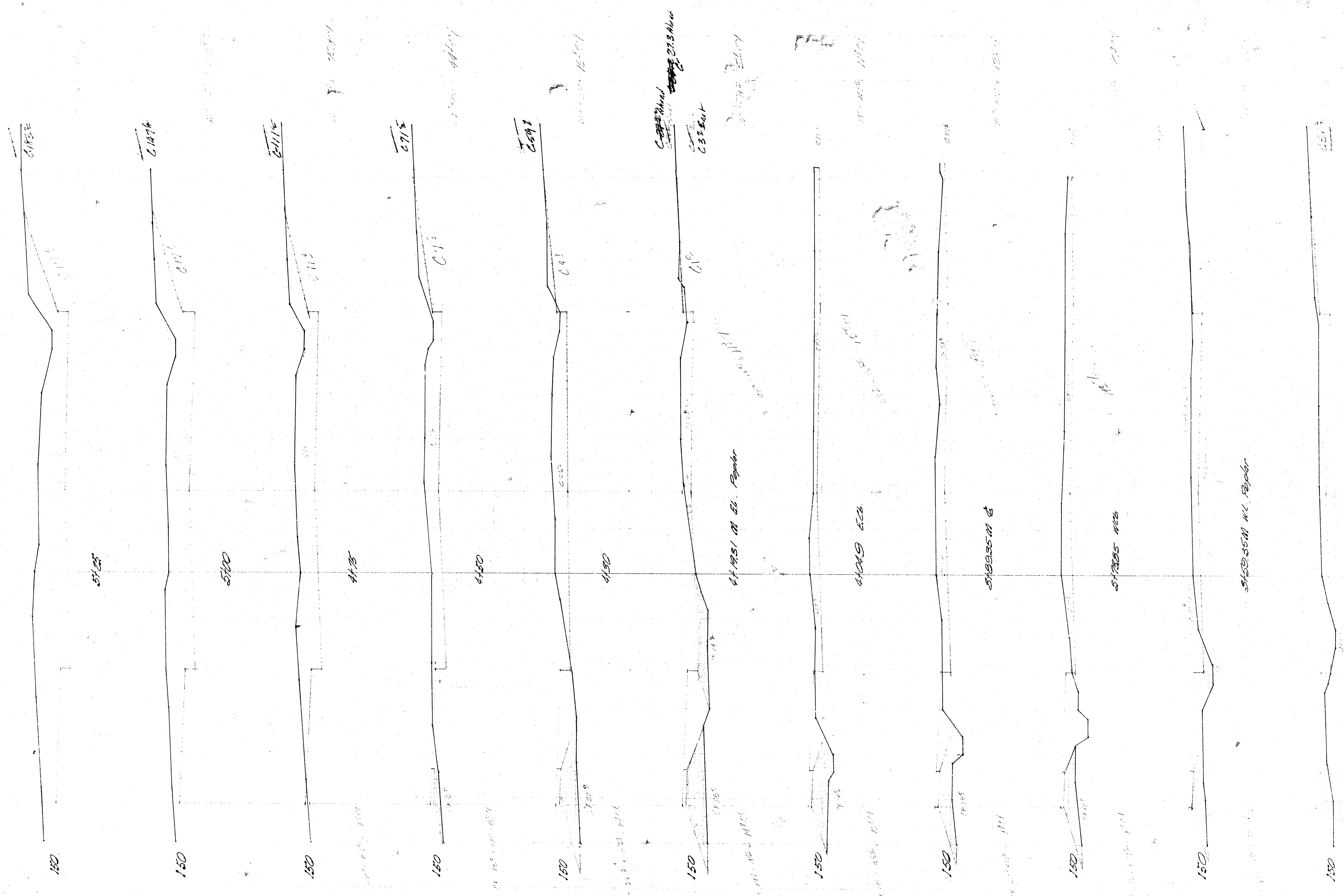

30 20 10 0 10 20 30 40 50

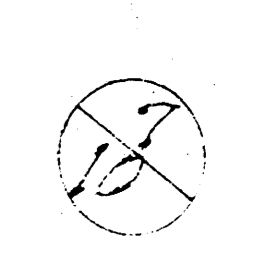

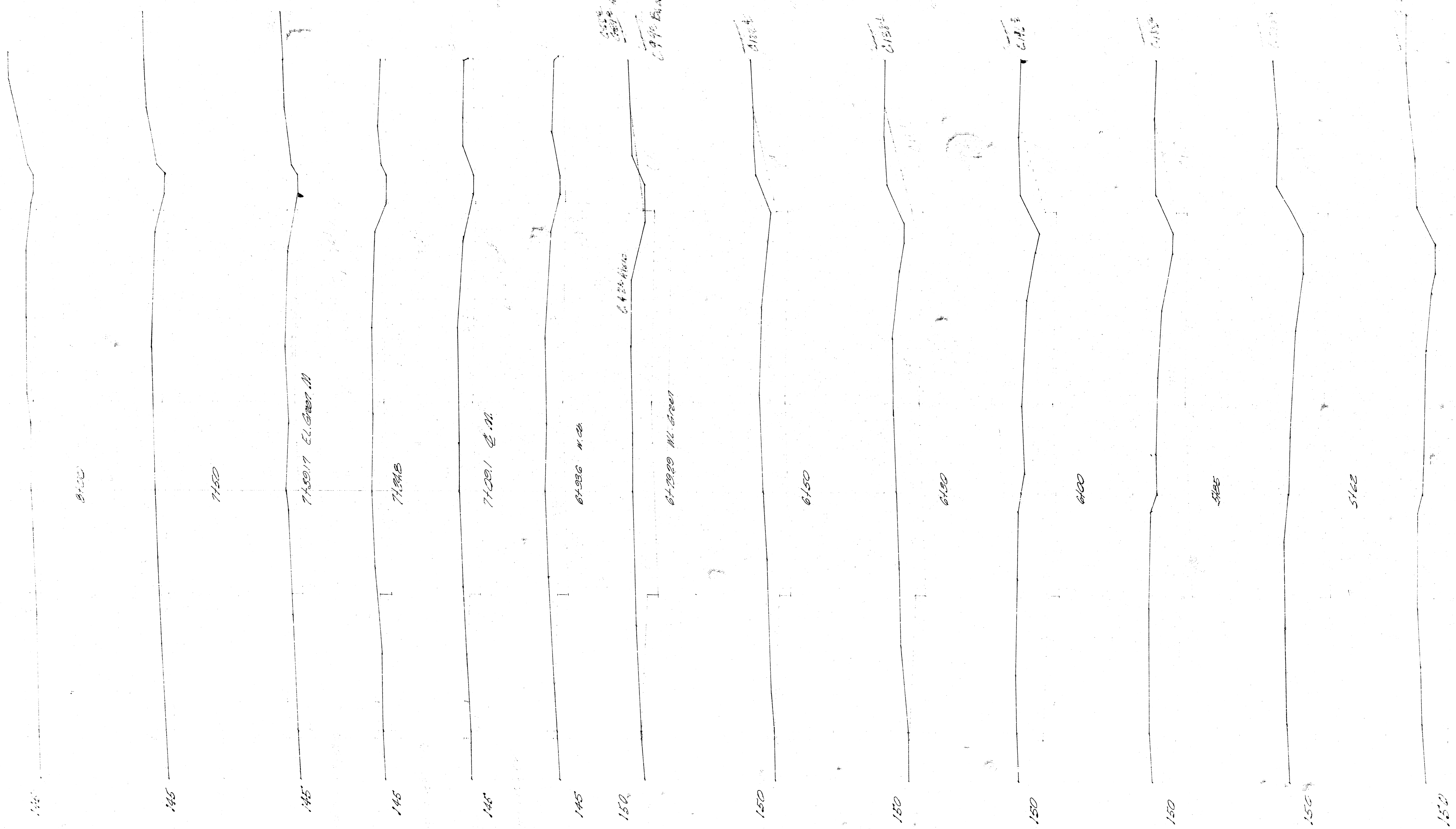

100  
 80  
 60  
 40  
 20  
 0  
 10  
 20  
 30  
 40  
 50  
 60  
 70  
 80  
 90  
 100



