

B. M. 131.00 S.E. COR. 1st CONC. STEP HO. N.E. COR. 27th & RICHMOND.

CONTRACTOR TO GRADE PARKING AND CLEAR RIGHT-OF-WAY FOR PROPOSED SIDEWALK.
COMPACT BACKFILL IN SIDEWALK AREA. SIDEWALK BY "OTHERS".

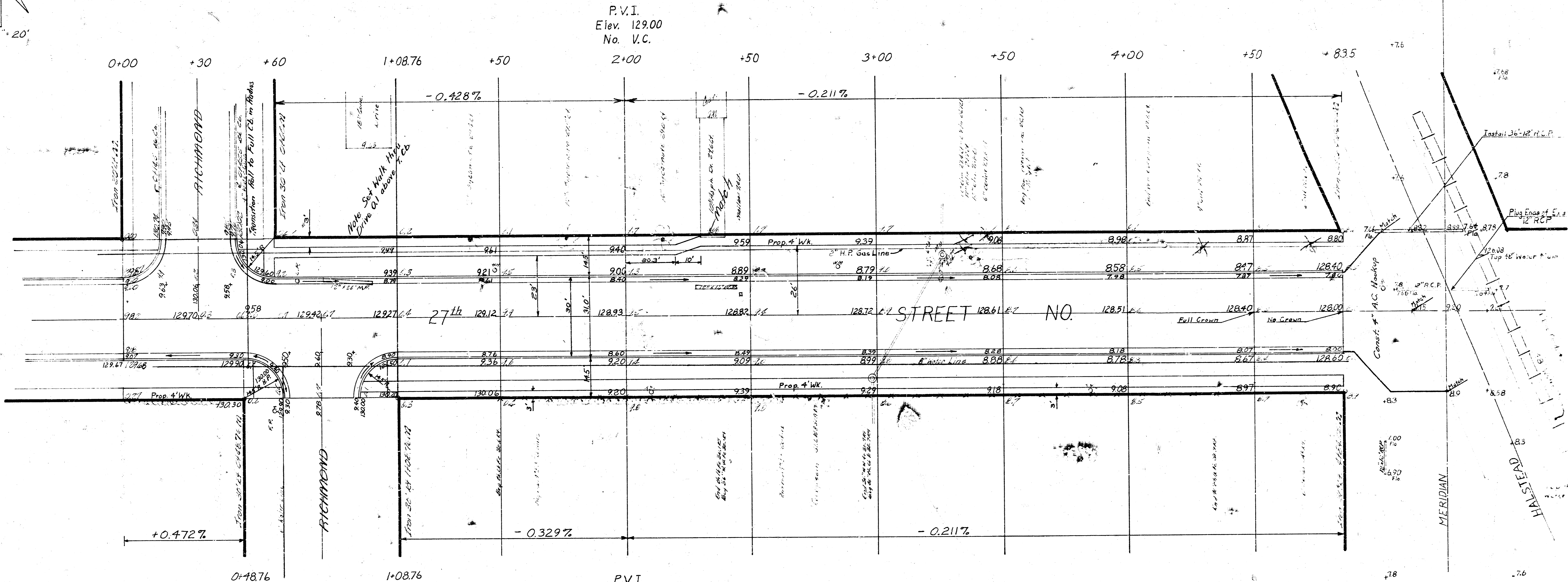
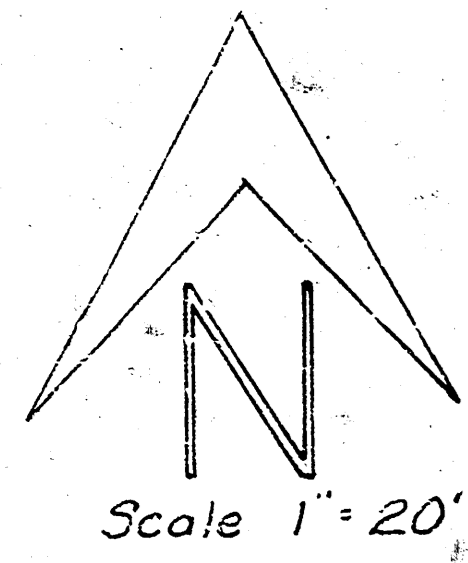

P.V.I.
Elev. 129.20
No. V.C.

CITY		PROPERTY	
EXCAVATION	COMP. FILL	EXCAVATION	COMP. FILL
EXC. 148.0 cy	C.F. 00 cy	EXC. 587.9 cy	C.F. 112 cy
	S.G.M. 54.4 cy		S.G.M. 259.4 cy
SUB-TOTAL 148.0 cy	55.2 cy	587.9 cy	270.6 cy
+ 10% 14.8 cy	5.5 cy	58.0 cy	27.1 cy
TOTAL 162.8 cy	60.7 cy	646.7 cy	297.7 cy

27th Street North, W.L. Richmond
Avenue North to W.L. Halstead

31'-Curb & Gutter-A.C.

City of Wichita, Kansas

B.E. Smith City Engineer

Date June 1, 1970 Proj. No. C19-81