

D. M. 128.62 R. R. Spk. E. Side H.L.P. NW cor. 27th & Market.
 B. M. 128.98 NE cor. conc. wk @ NE cor. building #2819 N. Broadway.
 Base line = \pm 28th St.

NOTE: Sta. 0+00 is E.L. Park Place & 28th St.

INTERSECTION INCLUDED
 IN PROJECT C12-5

Cu. Yds. Excavation 206
 +10% 21
 Total 227 Cu. Yds.

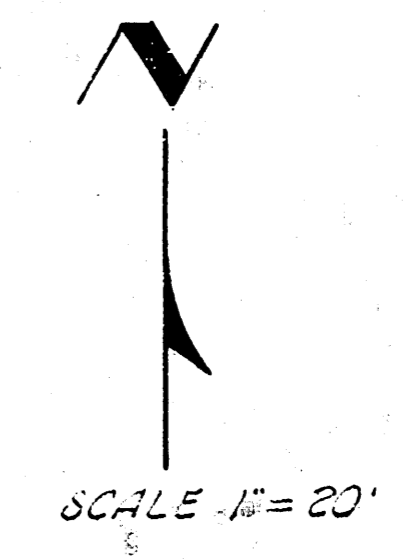
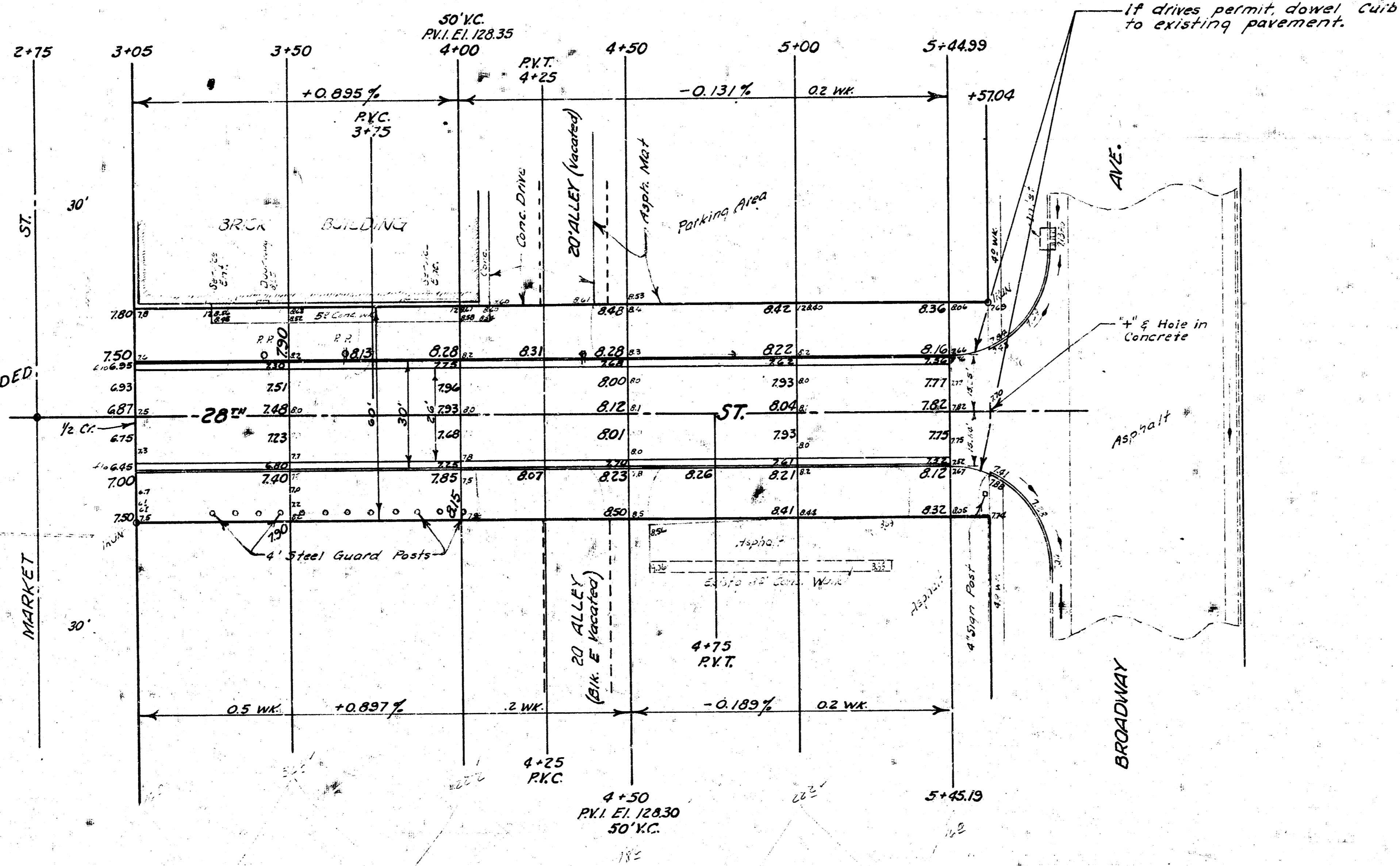

A. T. & S. F.
 R. R.

28th STREET N.
 WL. MARKET to WL. BROADWAY
 26-2-30 Asph. Conc.
 CITY OF WICHITA, KANSAS
 B. E. SMITH CITY ENGINEER
 May 1962 Project No. C11-18

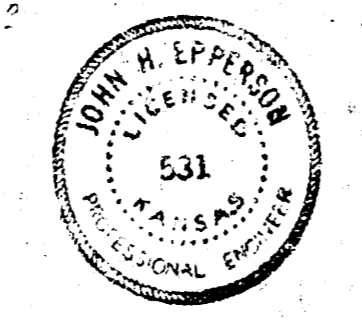
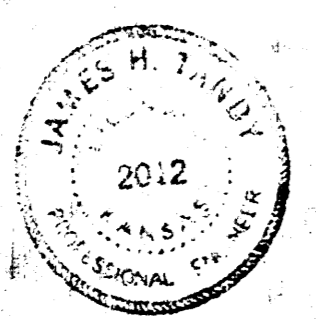

C. H. G. 12 & 2091
 J. L. J. 12 & 2091
 J. L. J. 12 & 2091