

CITY OF WICHITA, KANSAS

STREET IMPROVEMENTS

GENERAL NOTES:

- Utility service lines, poles, valve boxes, meters, etc. are to be adjusted as necessary by others prior to construction unless the plans specifically call for their adjustment by the Contractor or unless the plans specifically identify a utility to be adjusted by its owner during construction. Existing utilities and their location, as shown on the plans, represent the best information obtainable for design. The Contractor will be required to work around existing utilities within the right-of-way which do not conflict with proposed construction.
- Contractor is solely responsible to notify and to make any necessary arrangements with utility companies for any needed adjustments of utility facilities prior to start of work.
- Contractor will be required to provide as minimum advance notice of forty-eight (48) hours to utility companies prior to starting any excavation as follows:

Kansas One Call	687-2470
Southwestern Bell Telephone Company	1-316-571-2611
Cablevision	262-4270 or 263-2061
KPL Gas Service	263-7511
Kansas Gas and Electric	264-1141
City of Wichita Water Department	268-4908
City of Wichita Sewer Department	268-4071
Peoples Natural Gas	942-8811
- The Contractor shall be responsible for preserving property irons. The Contractor will be required to re-establish any property irons which are damaged or destroyed by his construction operations. Such irons shall be re-established by a licensed land surveyor or a licensed professional engineer in accordance with state laws.
- Limits of earthwork shall match existing ground elevations at the right-of-way line unless otherwise noted on the plans. Where the new finished grade elevations do not match the existing ground elevations, the earthwork shall extend one foot beyond the right-of-way line and then sloped up or down using permissible slopes to match the existing ground surface.
- Contractor will be required to obtain properly executed driveway request forms signed by property owners or their authorized representatives verifying driveway widths and locations. Such forms shall be submitted to the Engineer for his review and approval.
- The Contractor shall give all property owners and/or tenants of developed property abutting the project limits a minimum of ten (10) days advance notice prior to start of construction.
- The Contractor must examine the construction site prior to bidding and be satisfied as to the work shown for completion. After bids have been received, the Contractor shall not assert that there was a misunderstanding of the quantities of work or of the nature of the work to be completed.
- All construction and materials, unless otherwise noted, to comply with City of Wichita specifications and standards.
- Contractor shall give property owners abutting this project, whose yards will be lower than the new finished grade elevations at the right-of-way line, an opportunity to utilize excess excavated material from the project to regrade their yards to drain to the new pavement. Contractor will be required to dump and spread the excess material as required by the specifications when requested by the property owner. The Contractor shall ascertain that a dirt order form has been properly executed by the property owner before any such excess material is delivered to such properties.
- Any fence removed for construction shall be repaired in a condition equal to, or better than original, at no additional cost to the owner. This cost shall be considered as subsidiary to other bid items.
- Rubble Removal - Rubble from the removal of miscellaneous structures and excess excavation which is to be wasted shall be disposed of on sites to be provided by the Contractor. These sites shall be approved by the Engineer as to suitability, appearance and site location. Locations that, in the opinion of the Engineer will leave an unsightly appearance will not be approved. All disposal sites must be approved by the Kansas Department of Health and Environment. Material either stockpiled or disposed of in a flood plain will require a Kansas State Board of Agriculture permit. Any material dumped in waters of the United States or wetlands is subject to US Corps of Engineers permitting regulations. Any material buried or stockpiled beyond approved construction limits would require additional archaeological investigations unless buried in a previously approved borrow location. The cost of disposing of rubble from the removal of miscellaneous structures and excess excavation, including loading and hauling shall be subsidiary to the other bid items.
- Mailboxes within the limits of the project shall be removed and replaced by the Contractor as approved by the Engineer. Contractor will be required to make satisfactory provisions for mail delivery to properties affected by this project during its construction. This cost is subsidiary to other bid items.
- Trees and shrubs in public right-of-way which are in direct conflict with proposed new construction shall be removed by the Contractor with the Engineer's approval. Trees and shrubs which are not in direct conflict with proposed new construction shall be saved and protected from damage. This cost is subsidiary to other bid items.
- All entrance and cross road pipe within the project limits shall be removed by the Contractor unless otherwise noted on the plans. Removal of such pipes shall conform to the applicable section of the standard specifications. This cost is subsidiary to other bid items.
- A saw cut of at least one-half the depth of existing surface courses or one-fourth the depth of the existing total pavement thickness shall be provided where proposed abuts on existing surface course or pavement removal. Sowed joint to facilitate removal within three (3) feet of existing joints will not be permitted and for such instances the limits of removal shall extend to the existing joint. Such saw cuts will not be paid for directly and this cost shall be considered as subsidiary to the other bid items.

26TH ST. N., FROM VASSAR TO WELLESLEY
PROJECT NO. 472-82997
INDEX CODE : 765255

- The Contractor shall adjust water valve boxes and fire hydrants as directed by the Engineer. This cost is subsidiary to other bid items. The Water Department shall field locate water valves one time during construction when requested by the Contractor. It shall be the Contractor's responsibility to preserve such field locations during the construction process. Water valves, water valve boxes or fire hydrants damaged during construction shall be repaired by the Contractor at his own expense.
- The project limits may have underground sprinkler systems which conflict with new construction. Contractor will be required to remove such improvements should they not be removed by their owner prior to the time of construction of the project. The Contractor will be required to scavenge all sprinkler heads and/or valves and give such material to their owner. Portions of underground sprinkler systems not in conflict with new construction shall be protected from damage and shall remain in place. All work in connection with underground sprinkler systems shall be considered as subsidiary to the contract pay items of work.
- Street to be closed during construction except for temporary access coordinated with the adjacent properties. The Contractor shall use construction methods which shall minimize inconvenience to residents in the project area. Contractor will be required to make special access provisions for any handicapped residents within the project area whose normal access would otherwise be impaired.
- Earthwork computation for both alternates are based on alternate 1 which is to the bottom of the 5" reinforced crushed rock base.
- Railroad ties and yard decorations within the limits of this project are to be stockpiled for their owner. This cost is subsidiary to the site preparation and restoration bid item.
- The street R/W shall be seeded with temporary Rye grass at a rate of 200 lbs/acre. Unless it's in a developed area which is to conform to City's policy AR-78.



SCALE : 1" = 100'

	35	36	
	33	34	
	31	32	
	29	30	
	27	28	
	25	26	
	23	24	
	21	22	
	19	20	
	17	18	
	15	16	
	13	14	
	11	12	
	9	10	
	7	8	
	5	6	
	3	4	
	1	2	
	47	48	
	45	46	
	43	44	
	41	42	
	39	40	
	37	38	
	35	36	
	33	34	
	31	32	
	29	30	
	27	28	
	25	26	
	23	24	
	21	22	
	19	20	
	17	18	
	15	16	
	13	14	
	11	12	
	9	10	
	7	8	
	5	6	
	3	4	
	1	2	

LOCATION MAP

INDEX:

SHEET 1	TITLE SHEET
SHEET 2	TYPICAL PAVEMENT SECTION
SHEET 3	VALLEY GUTTER DETAIL SHEET
SHEET 4	PLAN SHEET
SHEET 5	X-SECTIONS

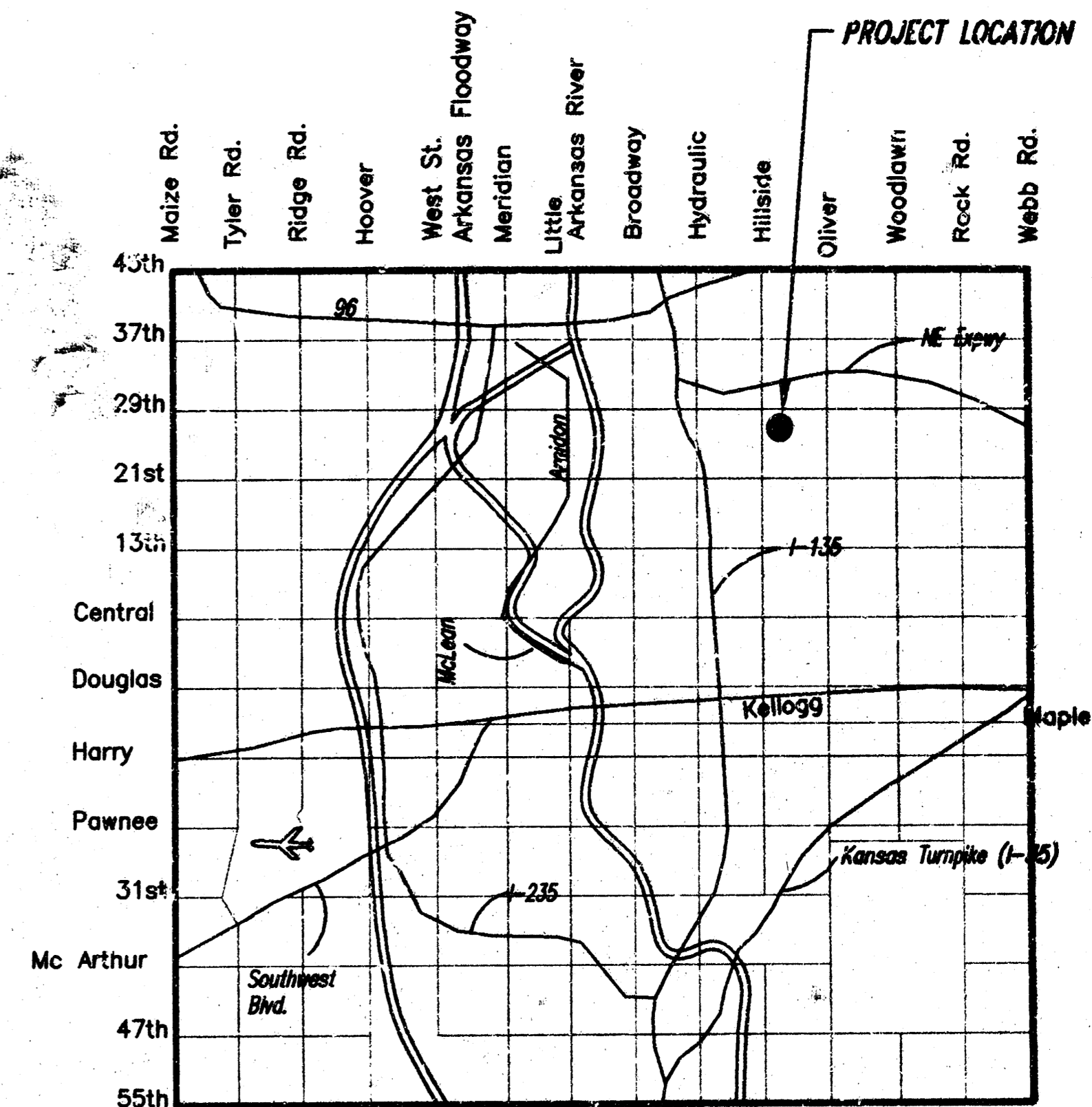

KEYMAP

BENCH MARK:

BM # 1.
 N end of the NE return Vassar & 26th Street North.
 Elev. = 173.45
 BM # 2.
 City Disc, 26.7' E & 28.0' S. of SE Cor. NW 1/4, Sec 2-27S-1E
 Elev. = 179.30

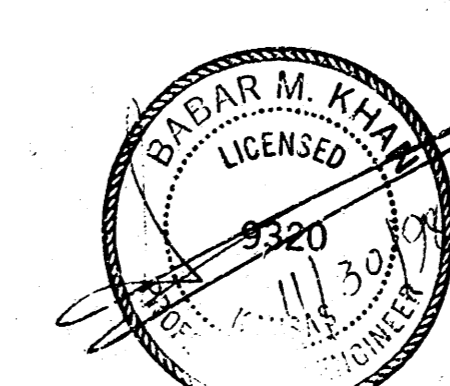

TITLE SHEET		
SCALE:	APPROVED:	DRAWN BY: S.A.
DATE:	CHECKED: B.K.	
PROJECT NO.	SHEET NO.	
98-103 (MUNICIPAL)	1 OF 5	
MIE MUNICIPAL ENGINEERS		
264 LAURA, SUITE 201 WICHITA, KANSAS 67211 316-262-3842		

TYPICAL 31' PAVEMENT DETAILS

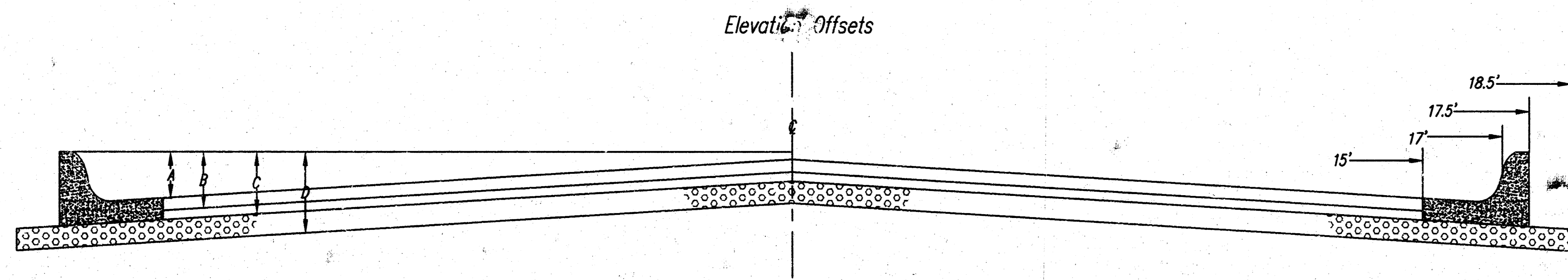
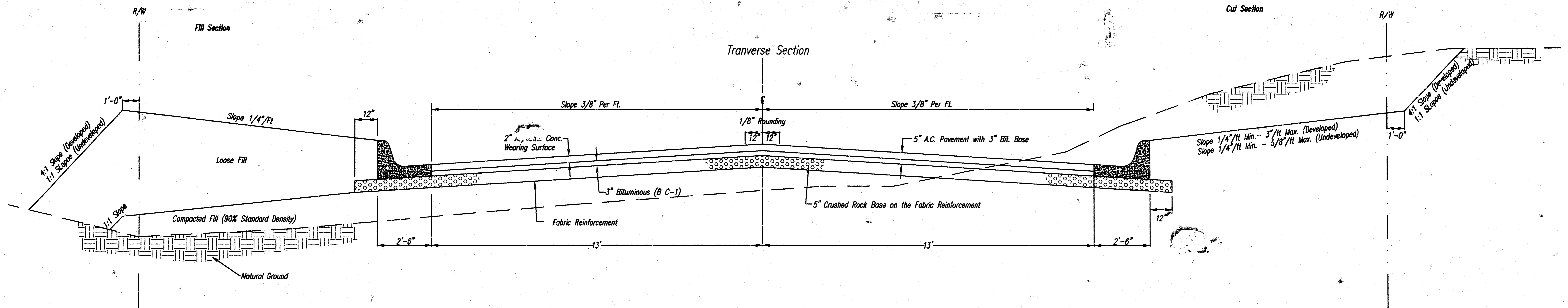

Fabric base reinforcement shall be 8 x 1100 by Tensor corporation or approved equal. Fabric base reinforcement shall be installed in accordance with manufacturers recommendations. Crushed rock shall be uniformly graded from 1-1/2" max. six to not more than 10% passing a no. 200 sieve. Rock quality shall be the same as specified for coarse aggregate for concrete mixes.

TRANSVERSE CONSTRUCTION JOINTS

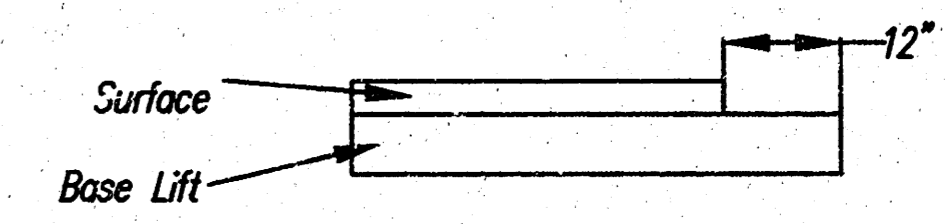

Transverse construction joints shall be constructed in flexible base pavement at locations where pavement joints existing flexible base pavement as shown of the transverse joint shall be included in the bid price for square yards 5" asphaltic concrete pavement (3" bituminous base.)

GENERAL NOTES

Rock base is to be compacted and smoothed with a steel faced roller prior to placement of asphalt. Tack coat will not be applied to rock base.

A tack coat of emulsified asphalt (SC-1H or CSS-1H) shall be applied at an approximate rate of 0.05 gallons per square yard between each lift of asphaltic material.

Bituminous base and asphaltic concrete wearing surface shall be placed with a laydown machine having automatic controls for line and grade.

Construction joint in each lift shall be staggered a minimum distance of one (1) foot from joints in preceding lifts and placed so that a joint will be constructed on the centerline of the top lift.

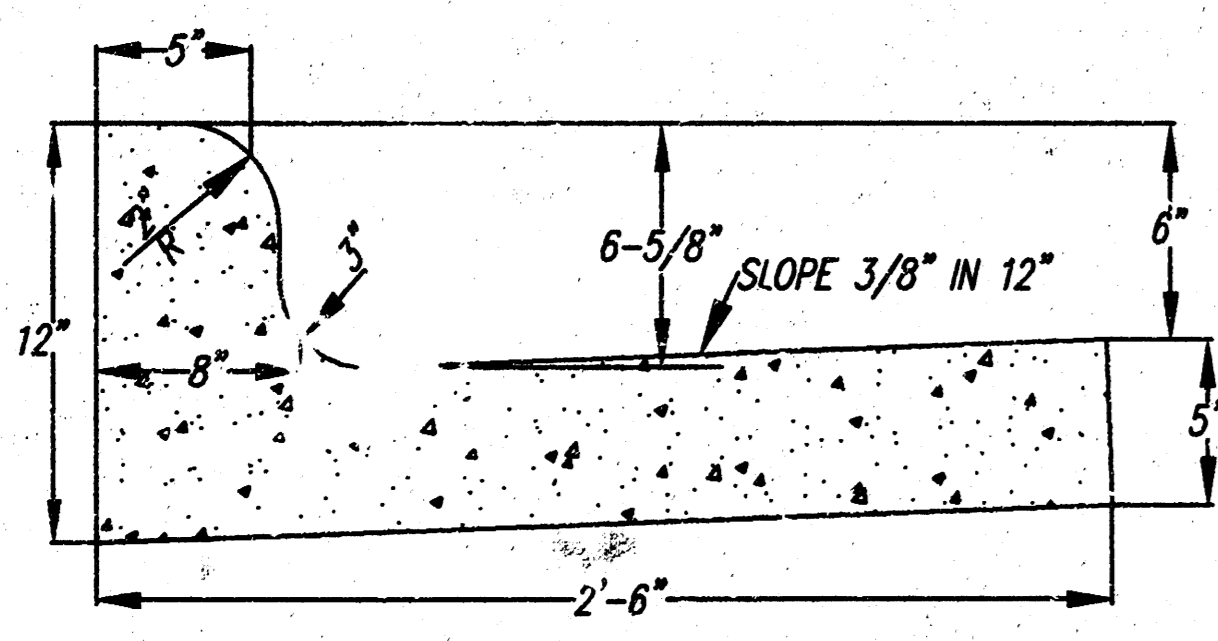

COMBINED CURB & GUTTER

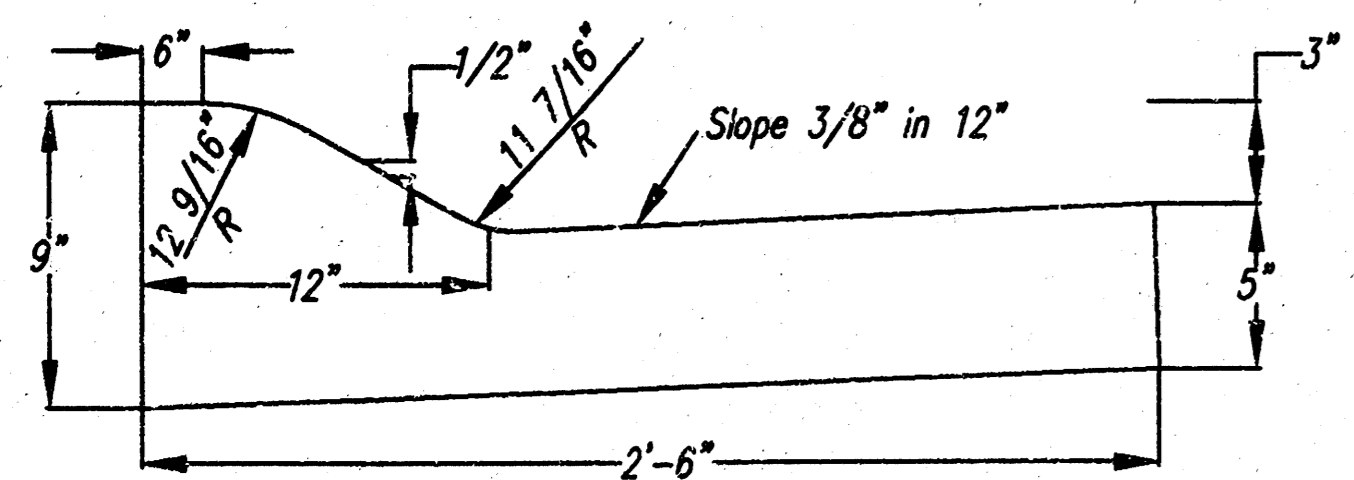

ROLL TYPE COMBINED CURB & GUTTER

	Distance from centerline (Lt. or Rt.)									
	0'	2'	4'	6'	8.5'	10'	12'	14'	15'	15.5'
A. Top of curbs to top of surface Lift	0.09	0.15	0.21	0.27	0.35	0.40	0.46	0.52	0.55	-
B. Top of curbs to top of base lift	0.26	0.32	0.38	0.44	0.52	0.57	0.63	0.69	0.72	-
C. Top of curbs to top of rock base	0.51	0.57	0.63	0.69	0.77	0.82	0.88	0.94	0.97	0.99
D. Top of curbs to top of subgrade										

5" Residential Asphaltic Concrete Pavement with Crushed Rock Base on Fabric Reinforcement

SCALE:	APPROVED:	DRAWN BY:
DATE:	CHECKED:	
PROJECT NO:		SHEET NO. 5

MUNICIPAL ENGINEERS
254-LAURA, SUITE 201
WICHITA, KANSAS 67211
316-262-3842

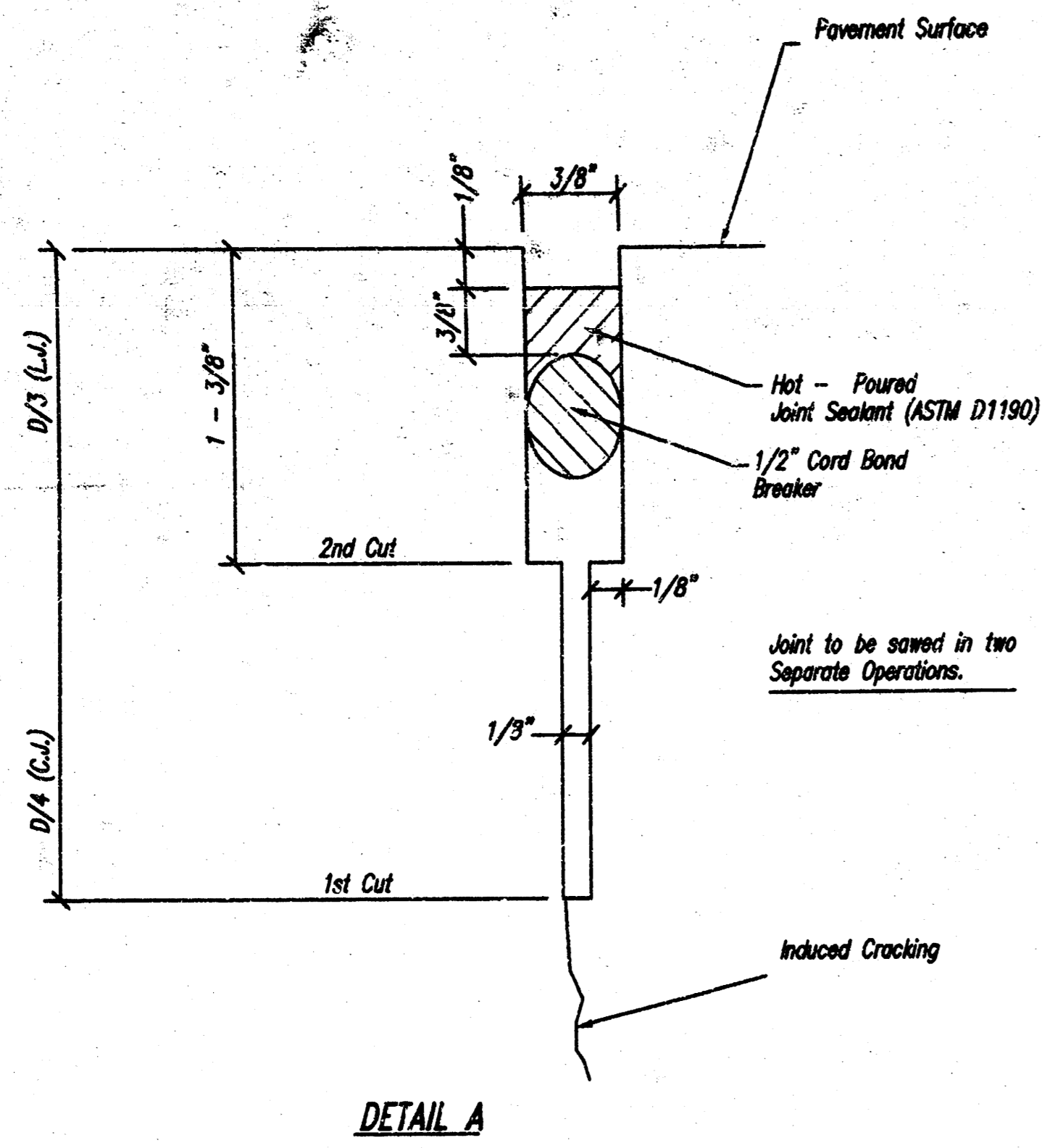

NOTE:
All concrete valley gutter reinforcement shall be adequately supported by bar chairs in the required position unless approved otherwise by the Engineer.

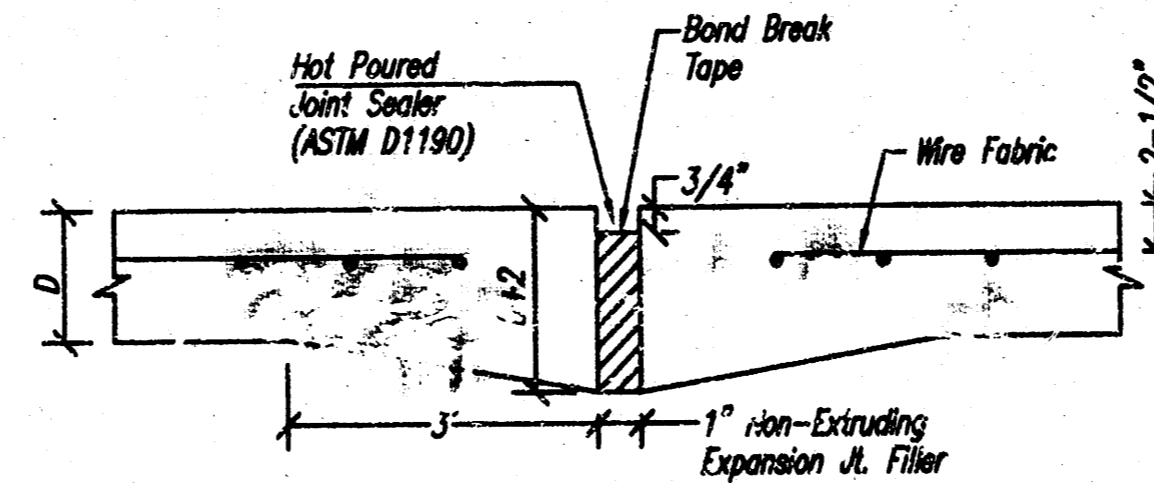

EXPANSION JOINT

Note:
Extra Thickness to be subsidiary to Price of Sq. Yds. Pavement.

6" x 12" W4-W4 WIRE FABRIC REINFORCING SHALL BE PLACED SUCH THAT THE WIRES WITH THE 6" SPACING WILL RUN PARALLEL WITH THE LONGITUDINAL JOINT.

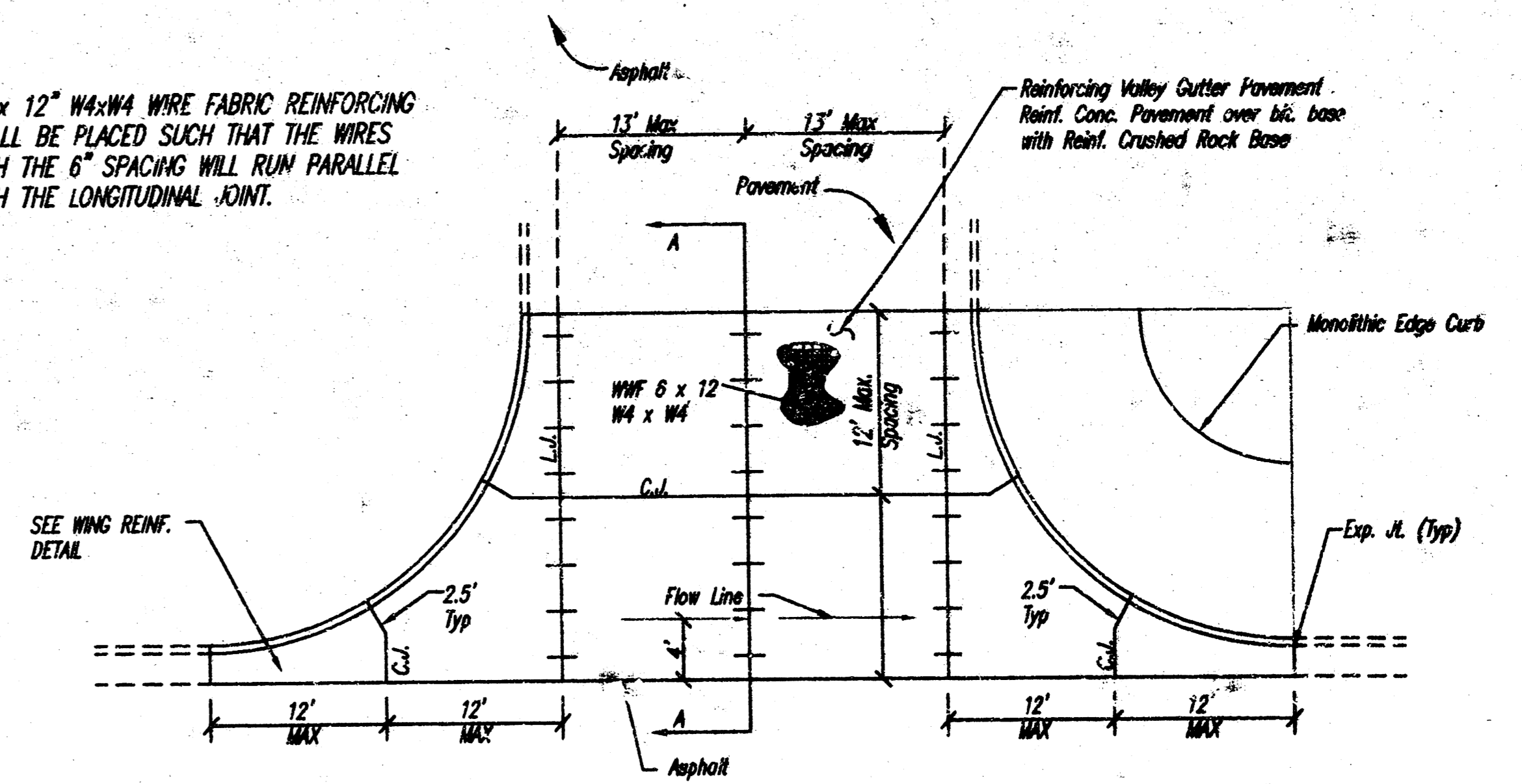

PLAN REINFORCED VALLEY GUTTER

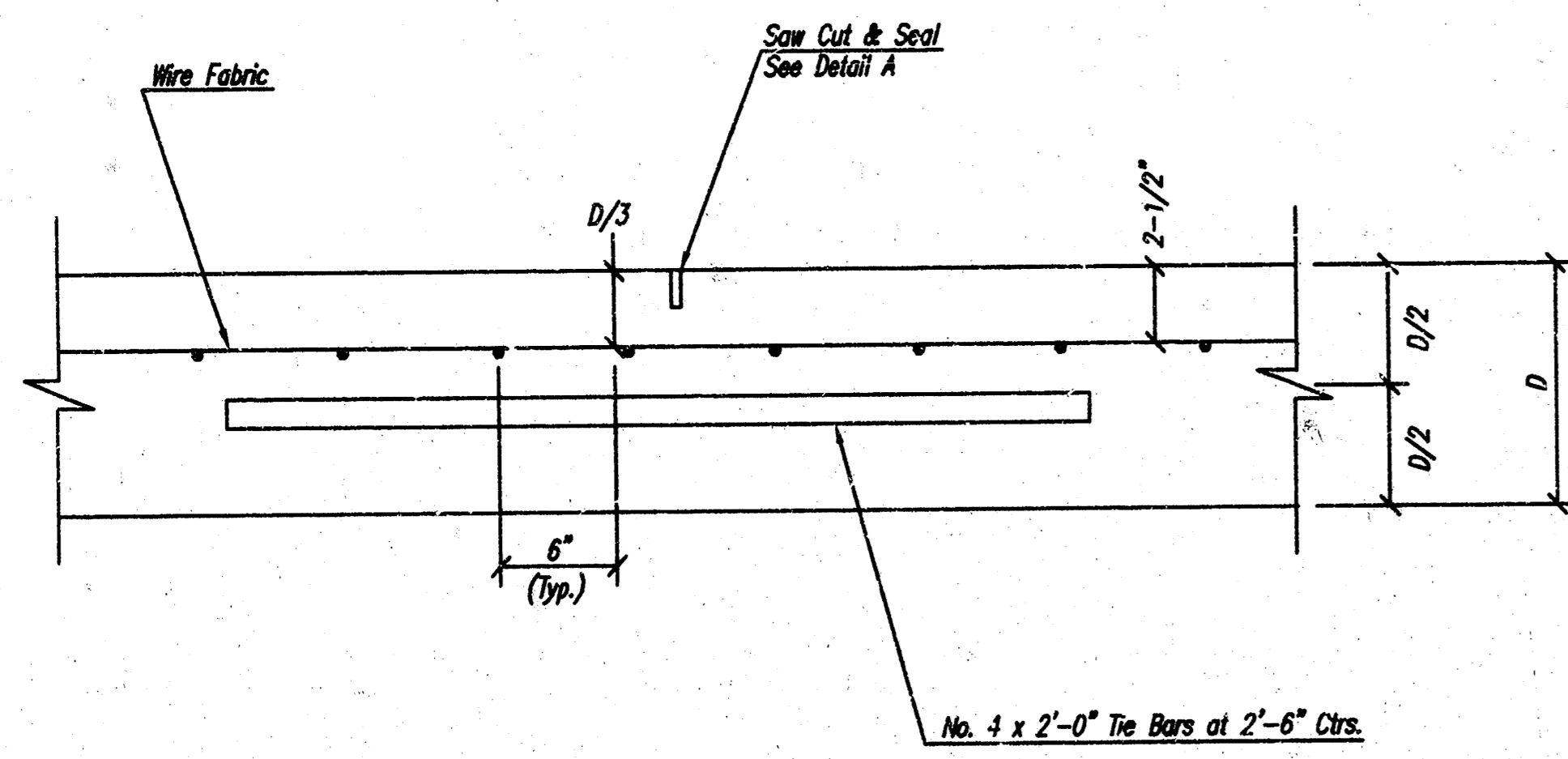

LONGITUDINAL JOINT DETAIL (L.J.)

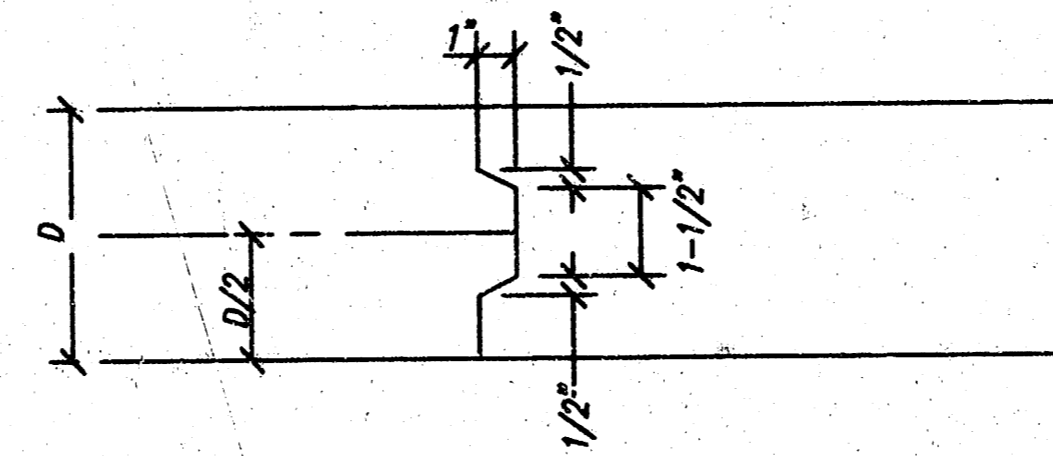

KEYWAY DETAIL

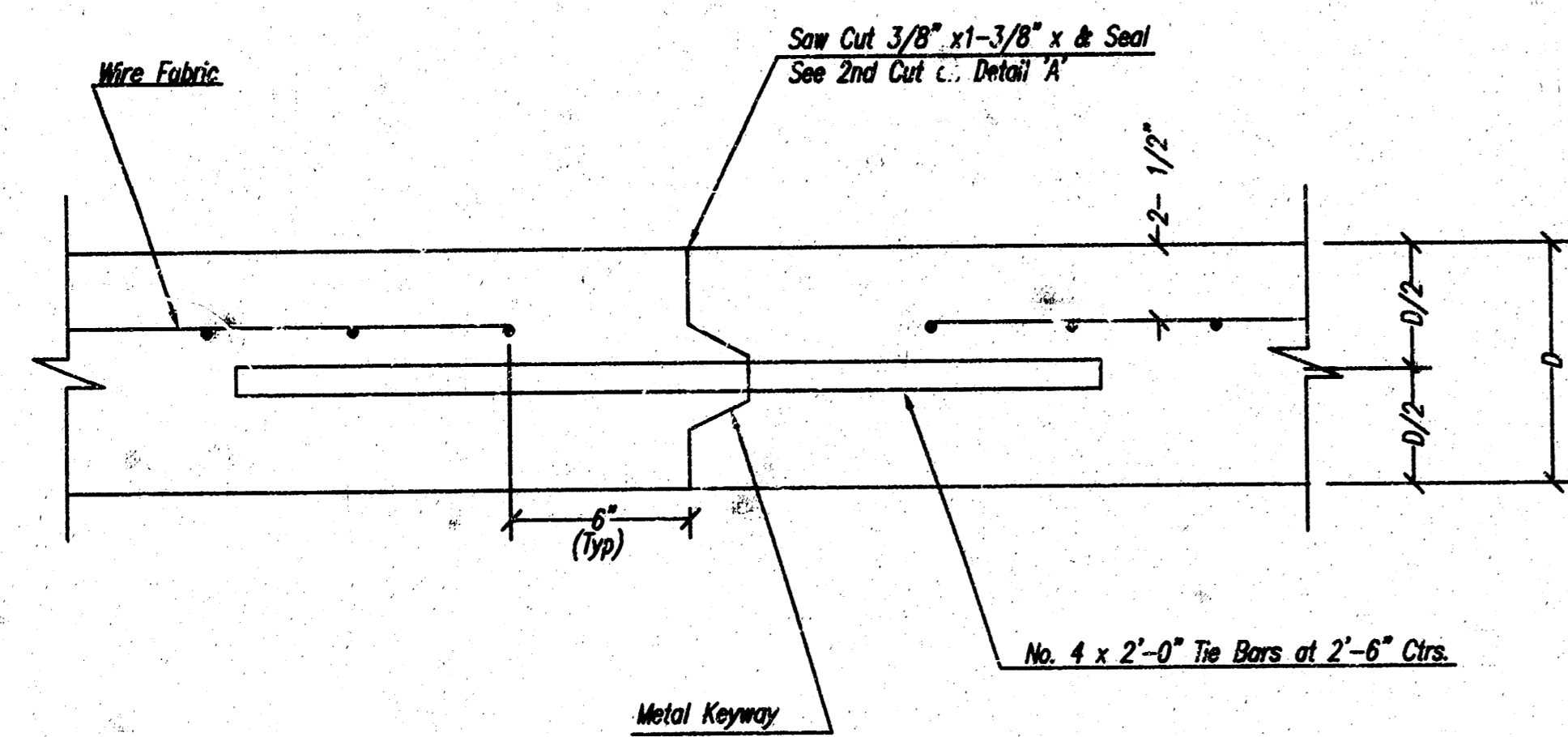

OPTIONAL LONGITUDINAL CONSTRUCTION JOINT (L.J.) (Alternate L.J.)

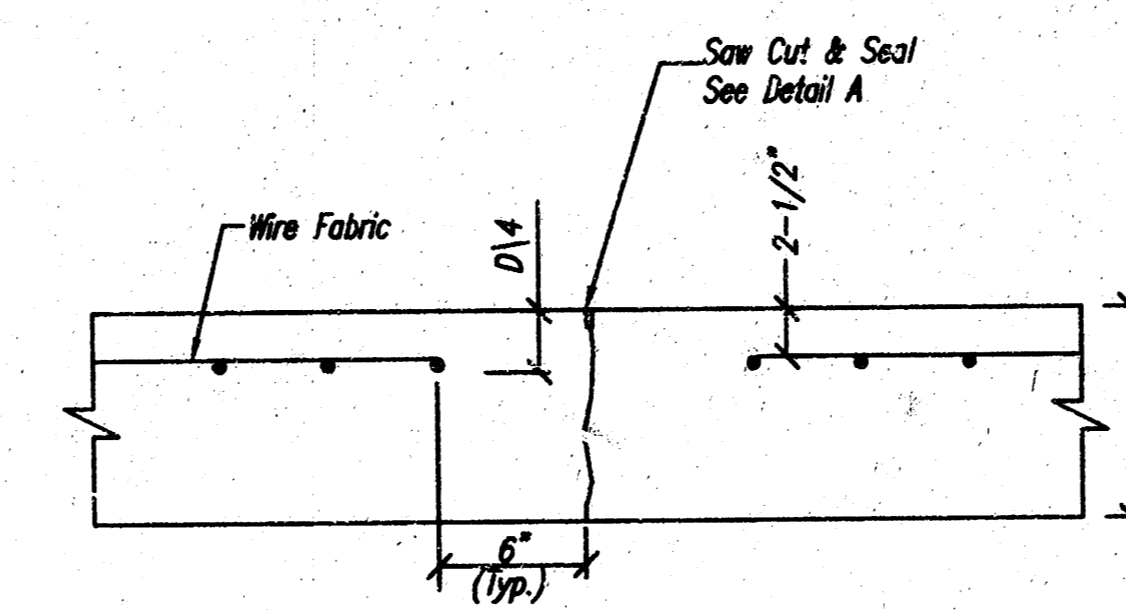

CONTRACTION JOINT DETAIL (C.J.)

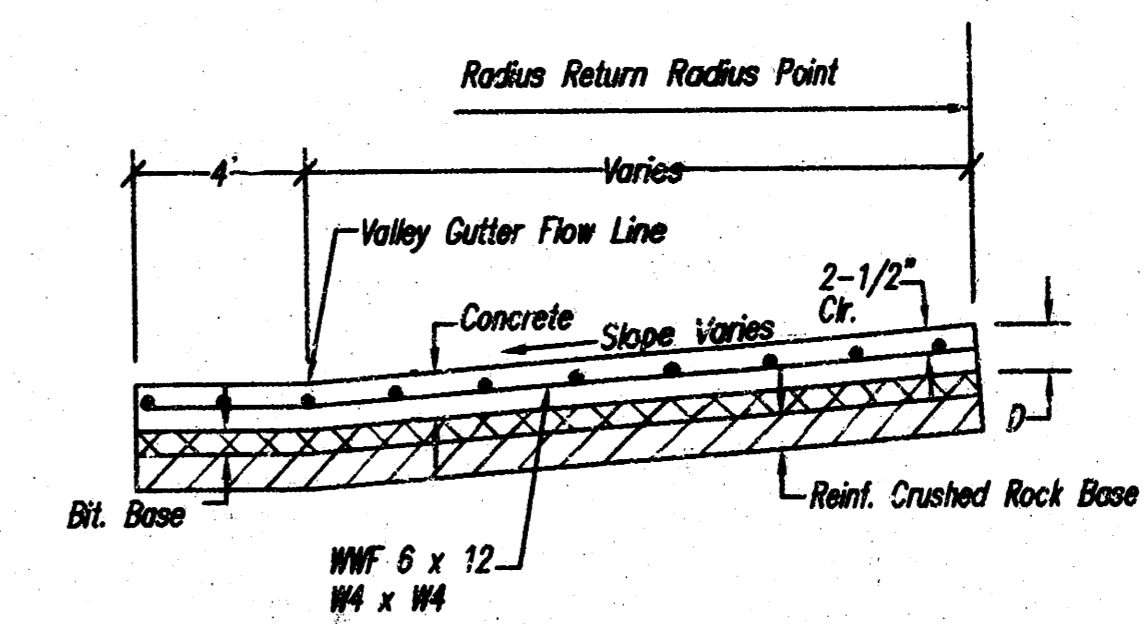

SECTION A-A

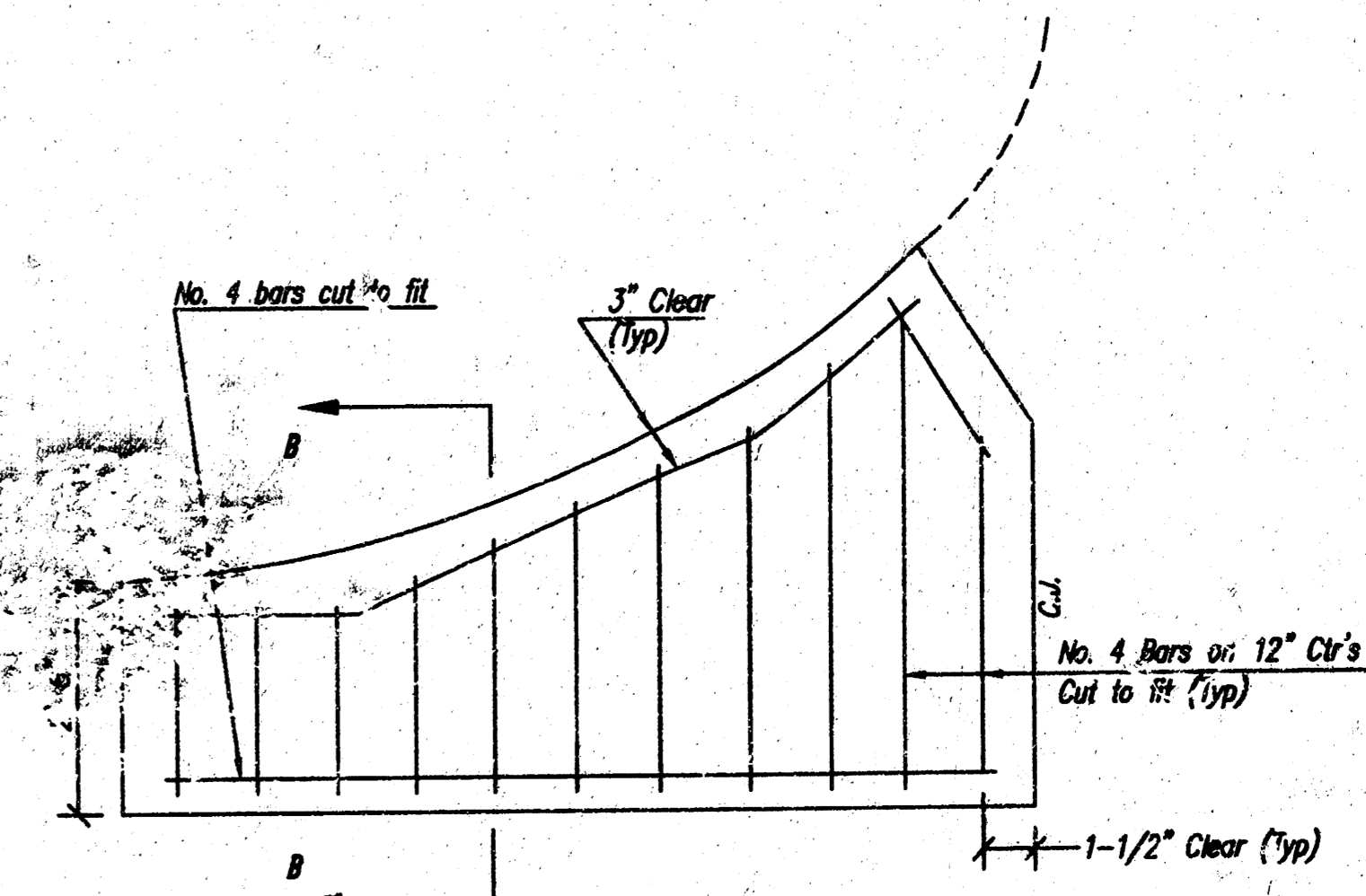

WING REINFORCING DETAIL

Note: Omit Wire fabric reinforcing in this section.

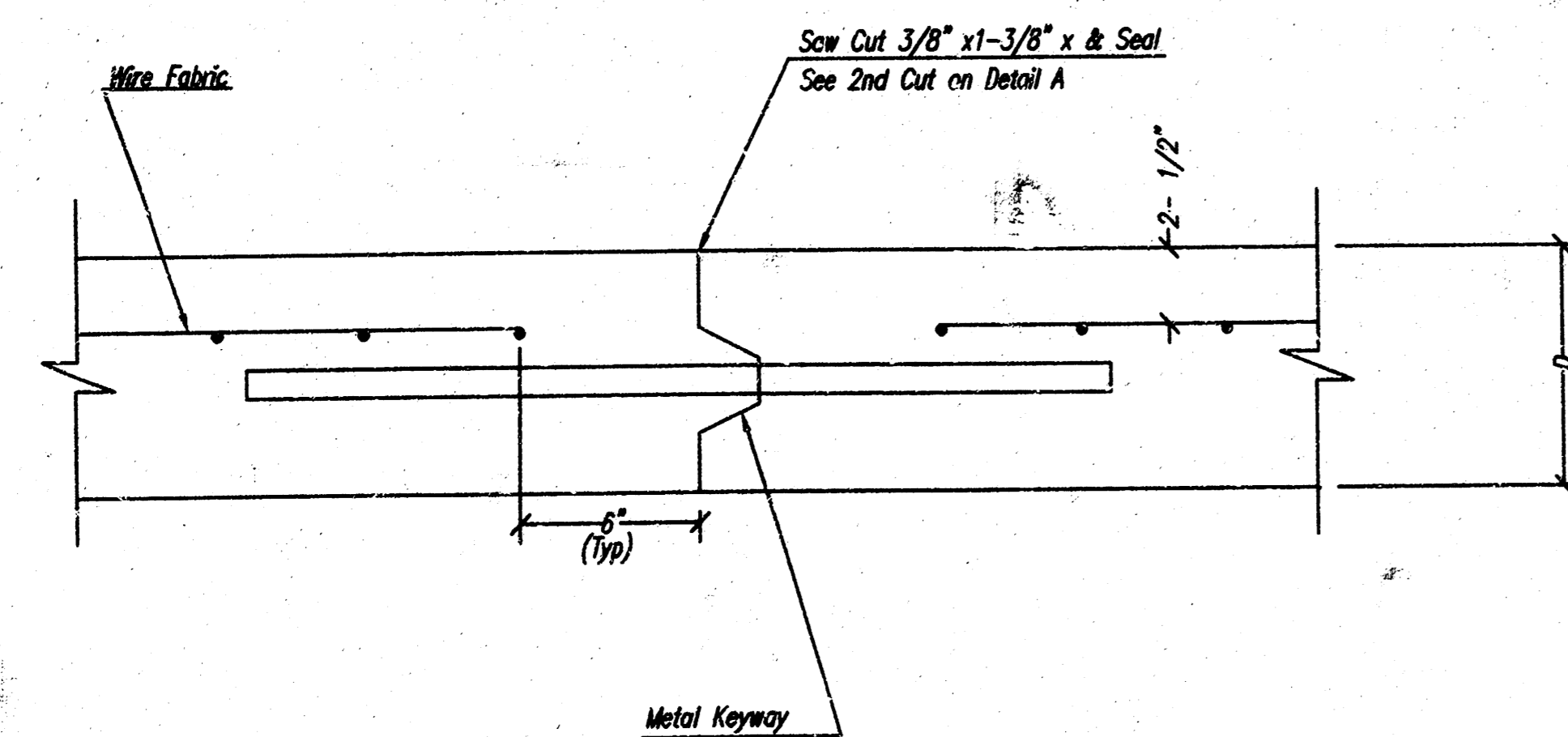

OPTIONAL CONTRACTION CONSTRUCTION JOINT (C.J.) (Alternate C.J.)

LEGEND

C.J. Identifies Contraction Joint
L.J. Identifies Longitudinal Joint

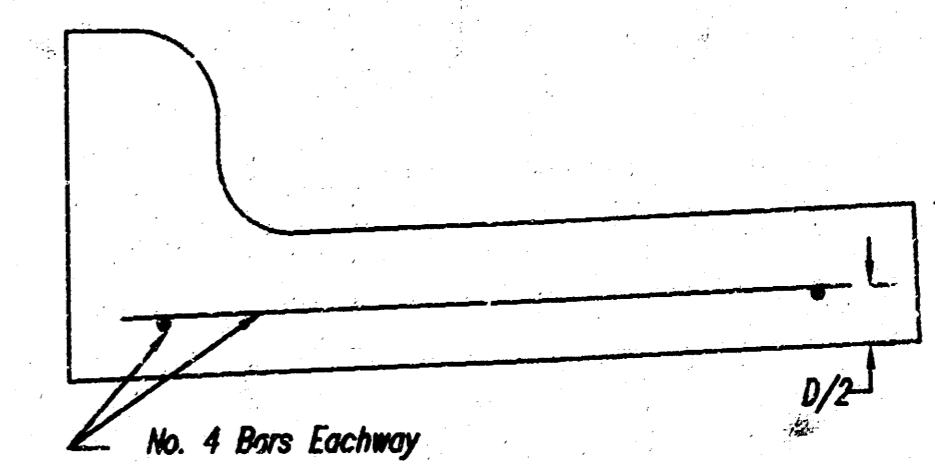

SECTION B-B

VALLEY GUTTER DETAILS

LEGEND

- Iron Pin or Rebar
- Light Pole
- Power Pole
- Manhole
- Fire Hydrant
- Sign
- Bushes
- Tree
- ▨ Remove & Replace Existing Pavement & Conc. Driveway
- Fence
- Gas Line
- Telephone Line
- Water Line

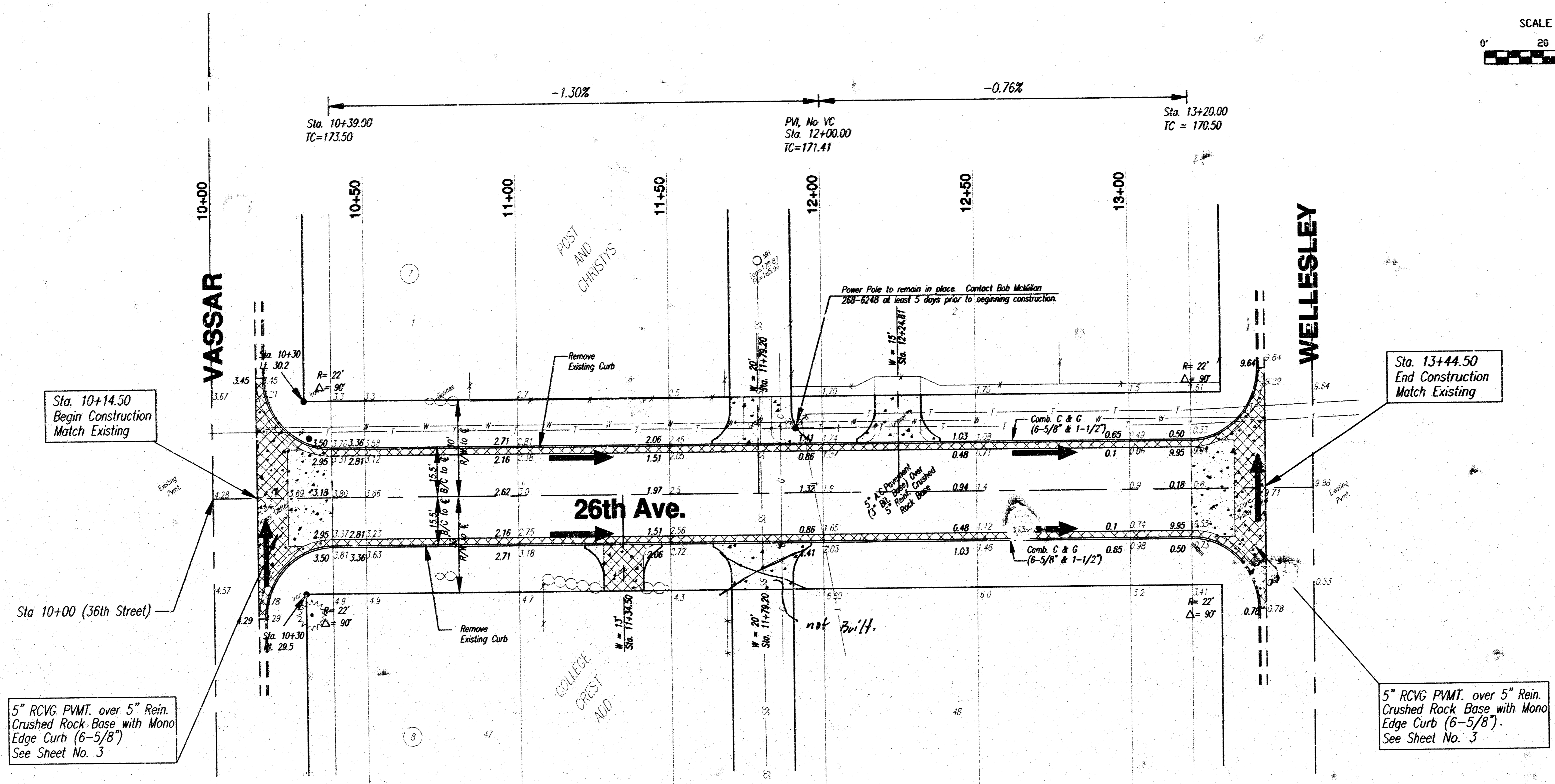
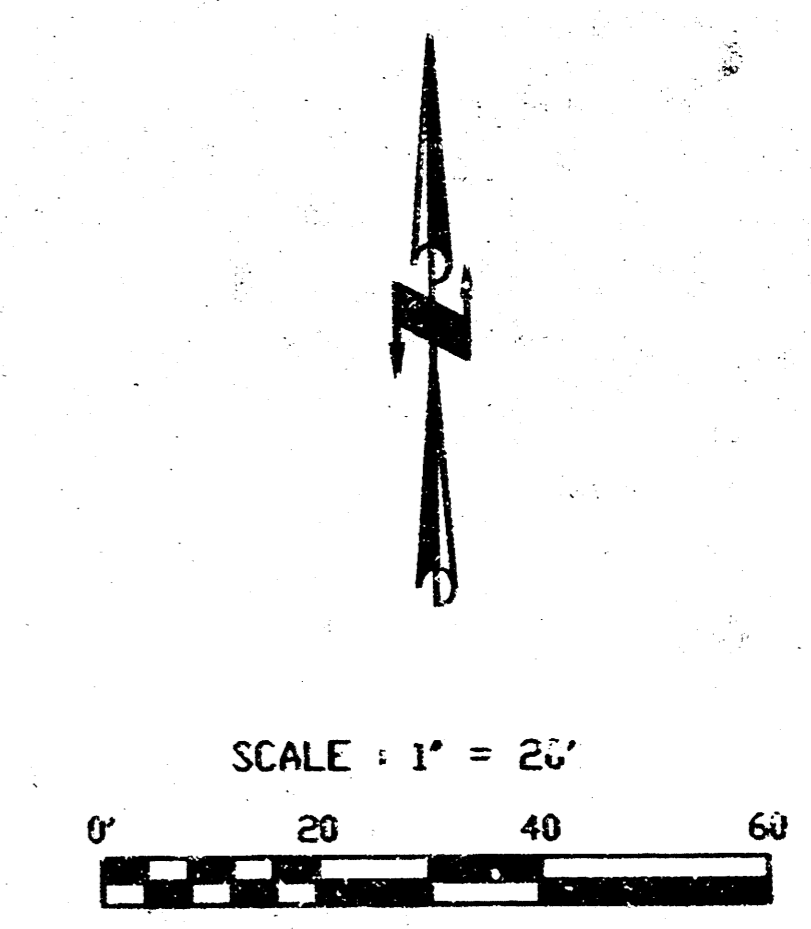

- Note:
1. Warp Crown from 1/2 crown @ Sta. 10+39.00 to full crown @ Sta. 11+00.00
 2. Warp Crown from full crown @ Sta. 12+50.00 to half crown @ Sta. 13+20.00

**Plan Sheet
26th Ave.**

SCALE:	APPROVED:	DRAWN BY:	CHECKED:
DATE:			
PROJECT NO. 98-103		SHEET NO. 4 OF 5	

MUNICIPAL ENGINEERS
254-LAURA, SUITE 201
WICHITA, KANSAS 67211
316-262-3842

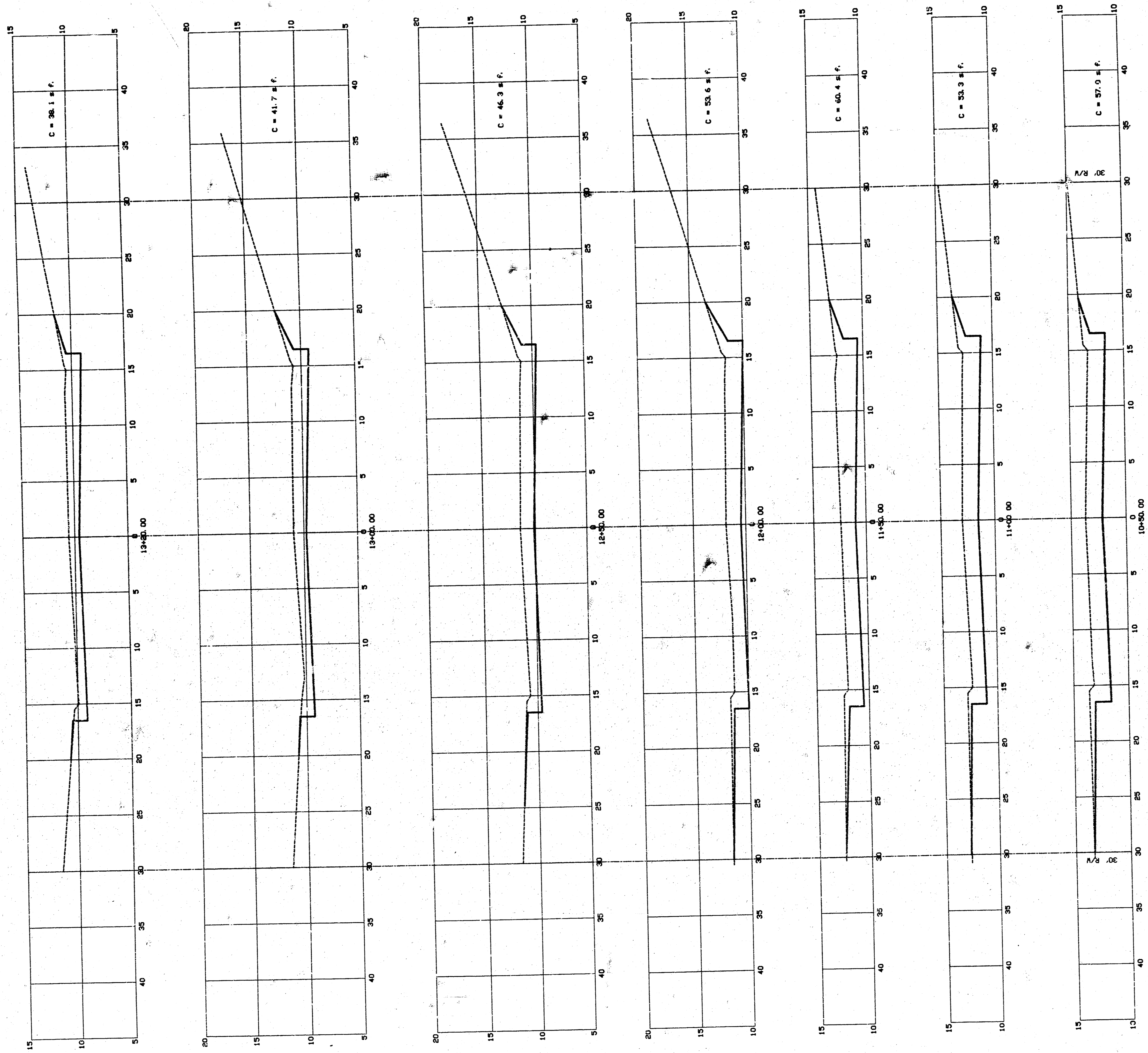

Cross Sections
26th Street

SCALE:	APPROVED:	DRAWN BY:
DATE:		CHECKED:
PROJECT NO:	98-103	SHEET NO.:
		5 OF 5

ME MUNICIPAL ENGINEERS
 254-LAURA, SUITE 201
 WICHITA, KANSAS 67211
 316-262-3842