

B.M. 98725 S.W. Cor. 1st Conc. Strip No. #2152 So. Oak.

Sta. on E

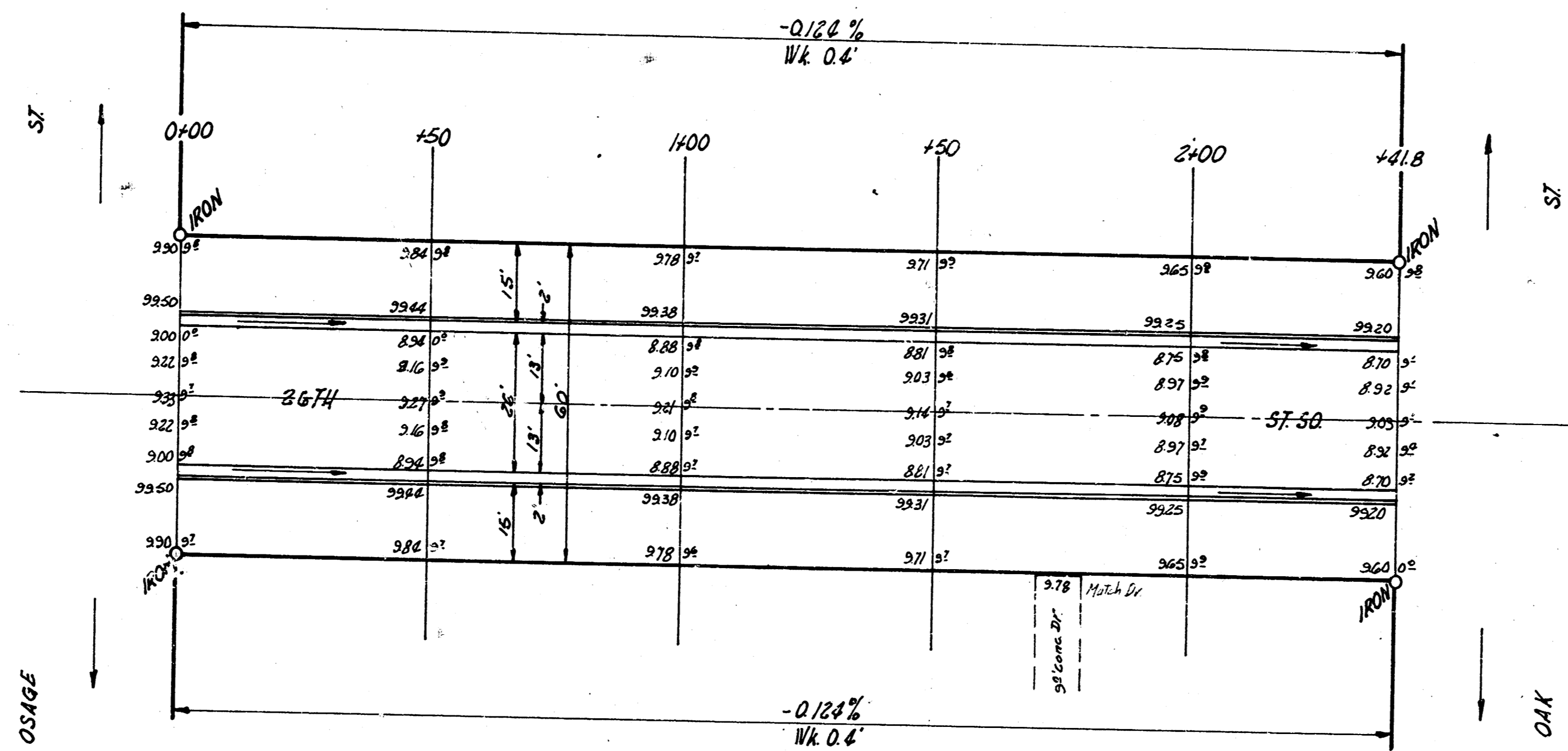

44' 0.37'

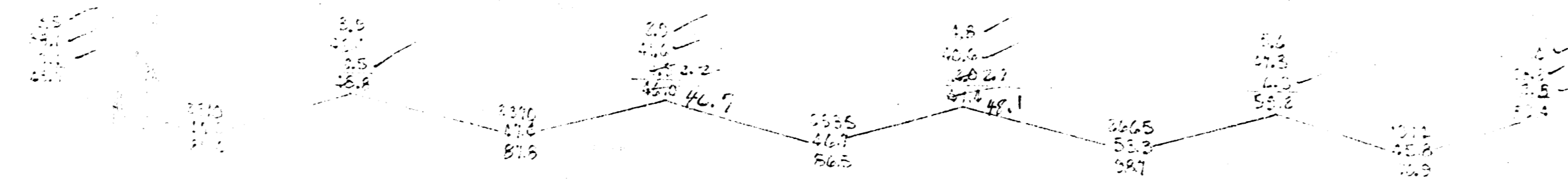

26TH ST SO
 E.L. OSAGE - W.L. OAK
 26'-2'-30" A.C.
 CITY OF WICHITA, KANS.
 B.E. SMITH CITY ENGINEER
 Feb. 1956 PROJ. NO. C15-78

Young
 & Sons
 CIVIL ENGINEERS
 112 S. 10th St.
 WICHITA, KANS.