

B.M. TOP IRON IN CONC. MARKER SQ. HI BANK LITTLE ARK. RIVER, APPROX. 10' E. OF WL HOOD SO. ELEV. 126.64

NOTE:
STA ON N.P.L.

NOTE TO CONTRACTOR & FIELD ENGINEER
ALL DR'S. ON N.S. 26TH ST. HAVE WOODEN CULVERTS (12" x 12" x LONG) 14' 50" OF N.P.L. THESE CULVERTS WILL BE DISPOSED OF IN ACCORDANCE WITH INSTRUCTIONS OF DIRT CHECKER.

NOTE TO CONTRACTOR & INSPECTOR
DO NOT MATCH EXIST. DRIVES ON N.S. 26TH ST. DRIVES WERE NOT BUILT TO GRADE. USE 0.8' WK. GRADE AS SHOWN.

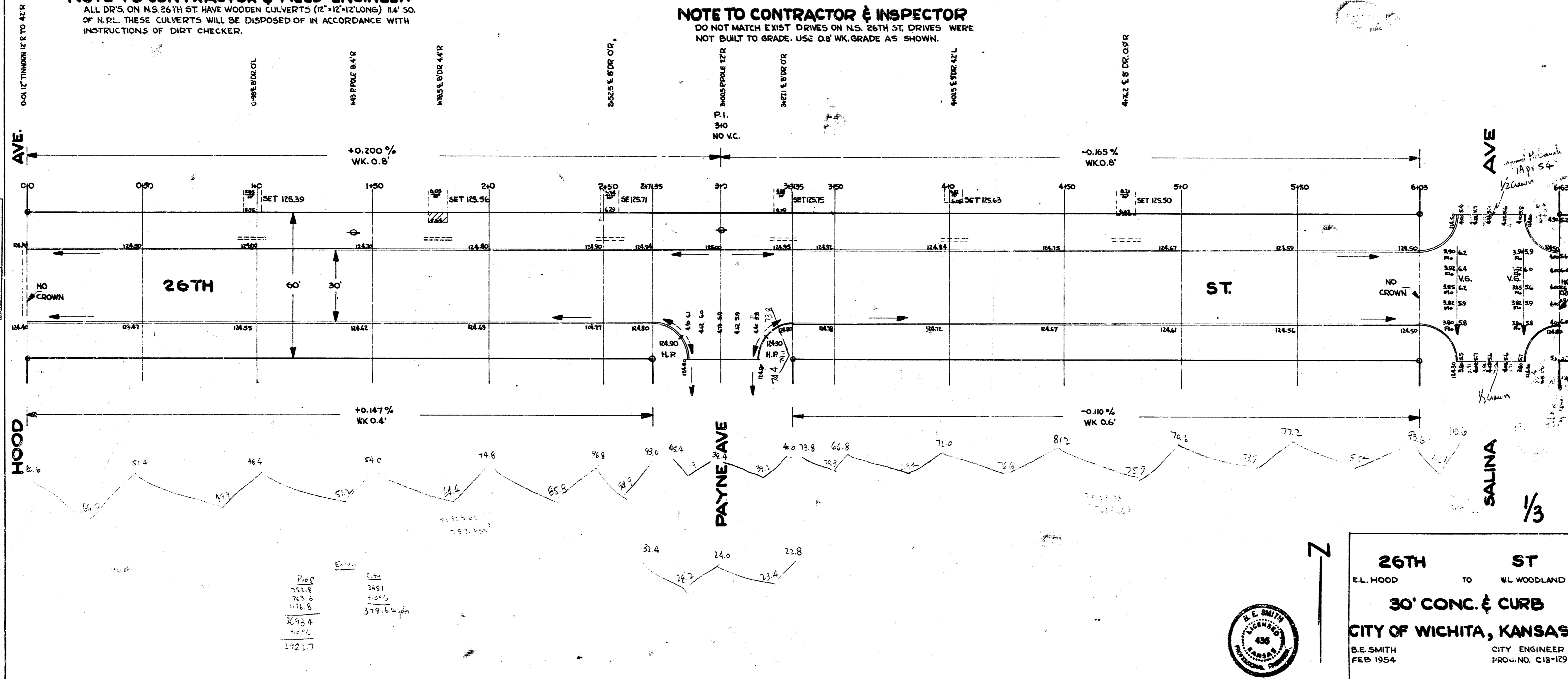

26TH ST
EL. HOOD TO WL WOODLAND
30' CONC. & CURB
CITY OF WICHITA, KANSAS
B.E. SMITH CITY ENGINEER
FEB. 1954
PROJ. NO. C13-129



AVE
AVE
SALINA
1/3

