

D.M. 131.66 N.W. Cor. Lower Step of W. Group Steps Facing North.
 210' West 31st STREET No.

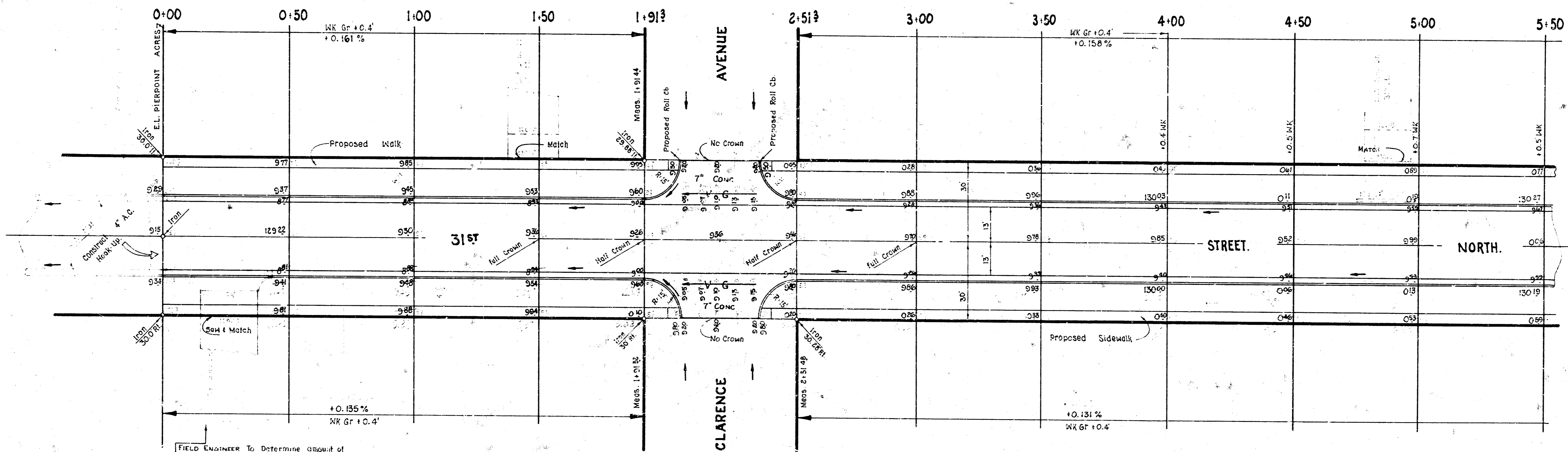
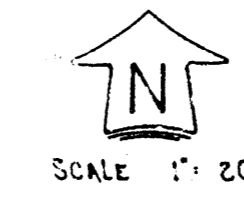

FIELD ENGINEER To Determine amount of
 Curb & gutter to be removed and limits
 of Drive removal.

EARTHWORK

PROPERTY		CITY	
Excavation	Comp. Fill	Excavation	Comp. Fill
1314.3 Cu yds	13.1 Cu yds	224.5 Cu yds	0.9 Cu yds
140.4 Cu yds	110.1 Cu yds	124.7 Cu yds	1.0 Cu yds
1445.7 Cu yds	123.2 Cu yds	249.2 Cu yds	1.9 Cu yds

SIDEWALK
 Grade Parking and clear Right of Way
 for Proposed Sidewalk Compact back fill
 in Sidewalk Area. SIDEWALK TO BE CONSTRUCTED
 BY OTHERS.

31st STREET NORTH.
 E.L. PIERPOINT ACRES TO W. AMMON AVENUE.
26'-2'-30" ASPHALTIC-CONC.

CITY of Wichita, Kansas
 S.E. SMITH City Engineer
 DATE: 12/10/1953 Proj. No. C-17-38



1/2

B.M. 130 65 60' Spike N.W.S. P.P. S.E. 31' CHARLES.

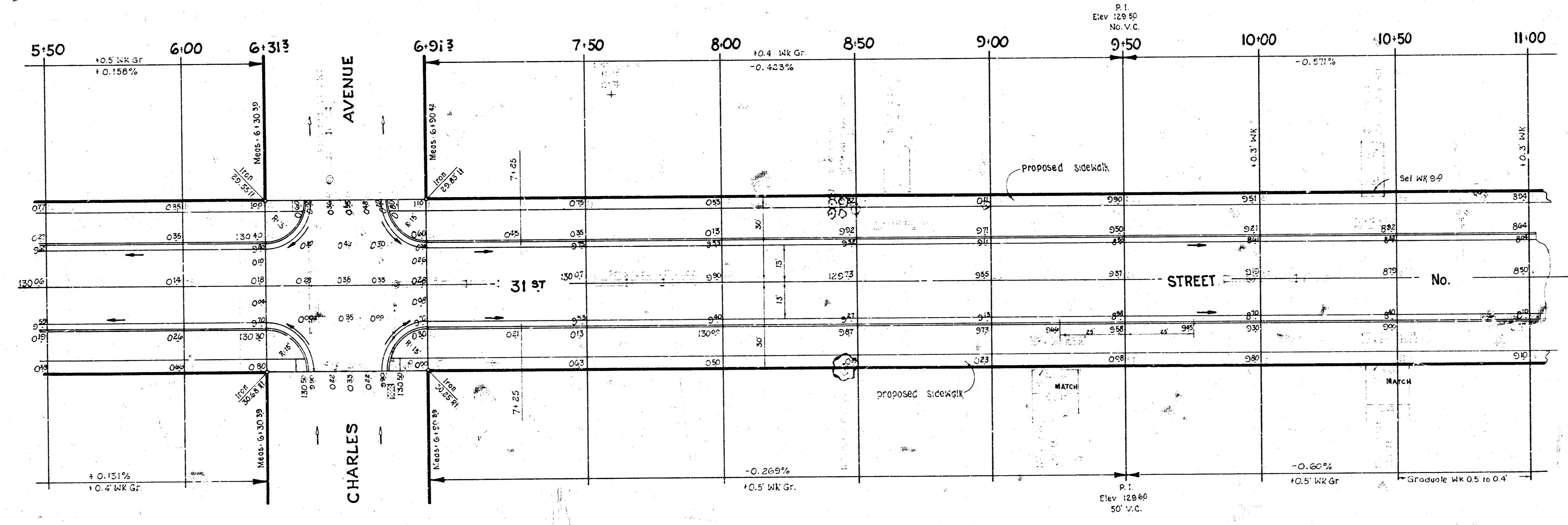

1/2" = 1' HORIZONTAL SCALE

S.M. 12576 S.E. Cor Conc Step @ N.E. Cor Hc# 3155 N. AMIDON.
House at S.W. Cor. 31ST & AMIDON.

