

31ST ST. SO  
PROJ. 121'S. C14-389 & C14-390  
3/14





Loc. & 2nd Midland Valley R.R. :  
 13.75' N to Nail in Bottle Cap W.G. & E. P.C. :  
 34.27' S.E. to Nail in Bottle Cap in Guy Pole.  
 50.02' S. to Iron.

254  
 254  
 254

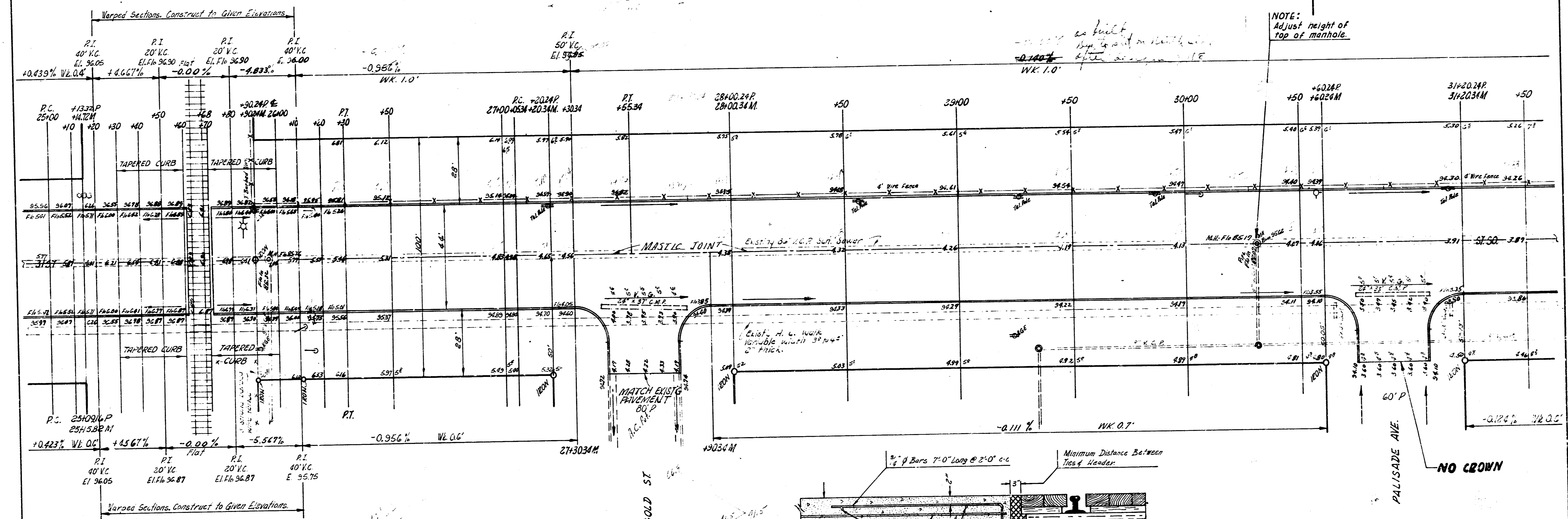
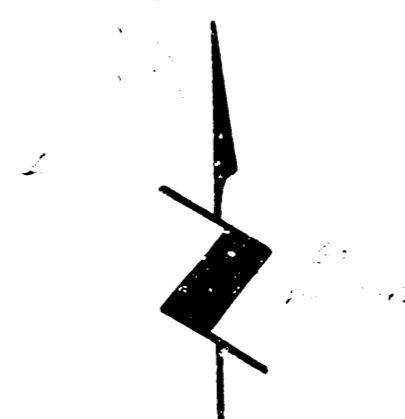

NOTE:  
 Adjust height of  
 top of manhole.

as built  
 sup. is set on bench mark  
 after construction of SE

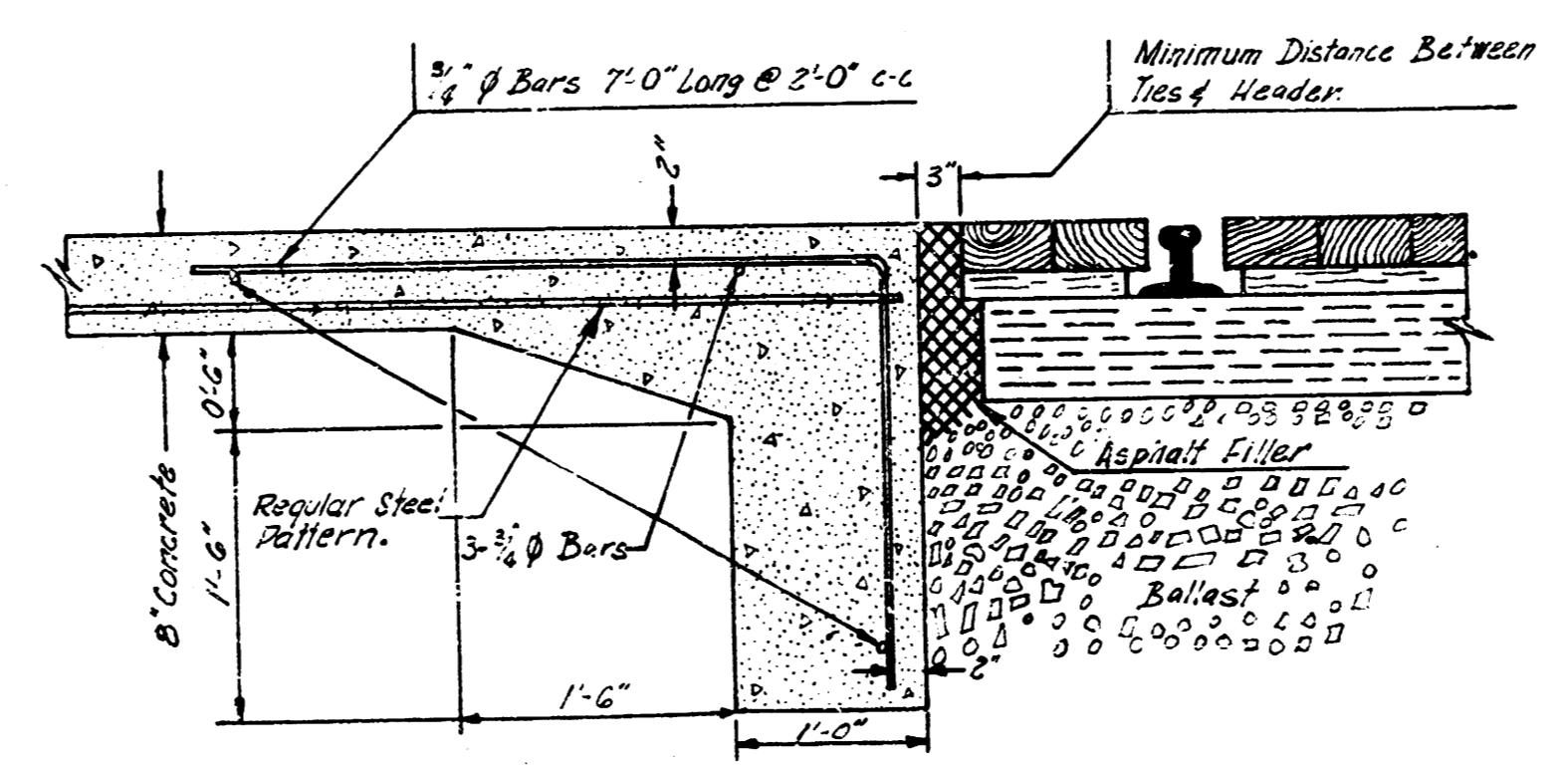

DETAIL OF CONCRETE HEADER FOR R.R. CROSSING  
 Not to Scale

31 ST. ST. SQ.  
 PROJ. NO'S. C14-389 & C14-390  
 14

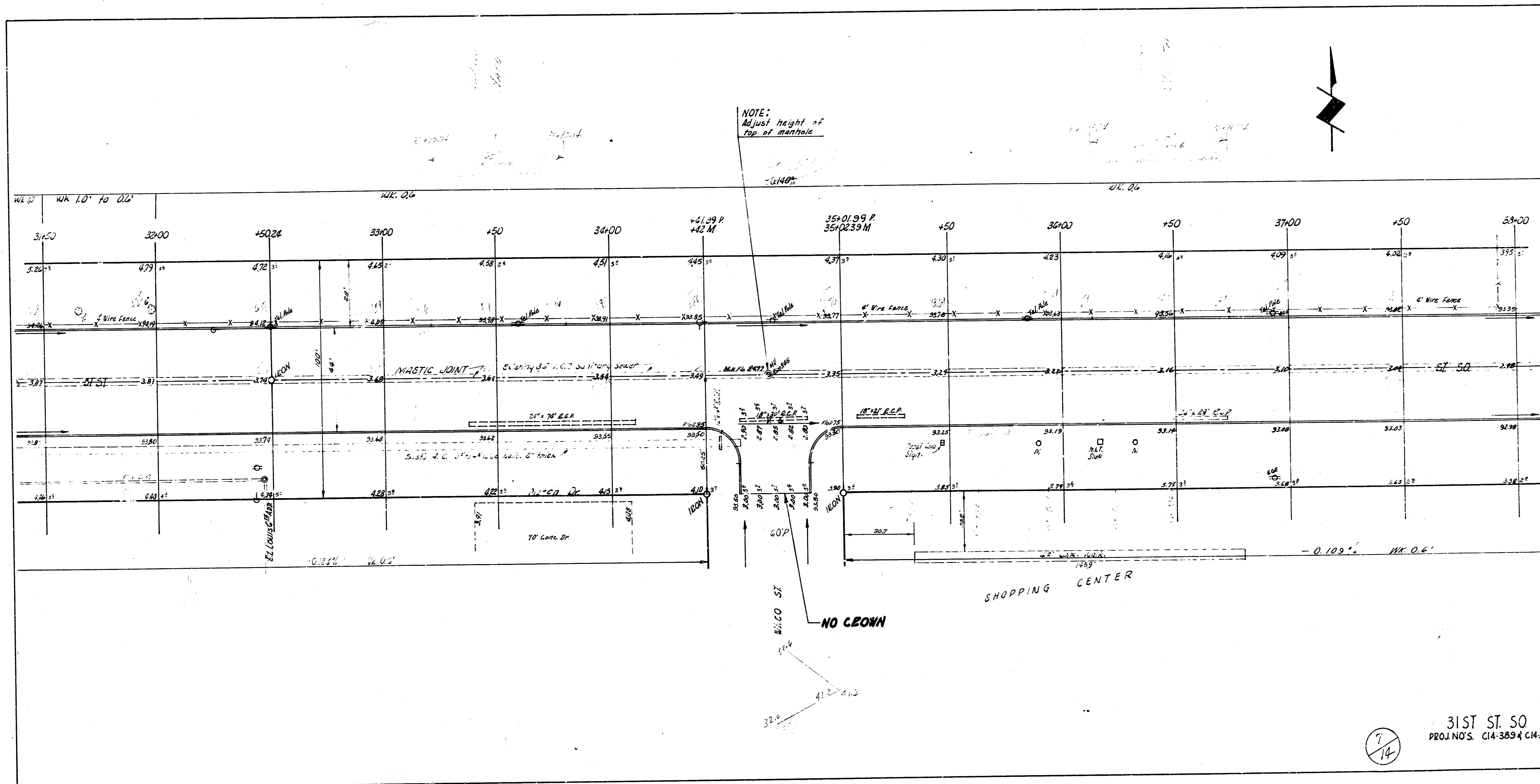

7/14

31ST ST. SO  
 PROJ. NO'S. C14-3894 C14350

