

31ST. ST. SO.
E.L. MERIDIAN TO E.L. GLENN

PROJ'S. **CI5-218**
CI5-219

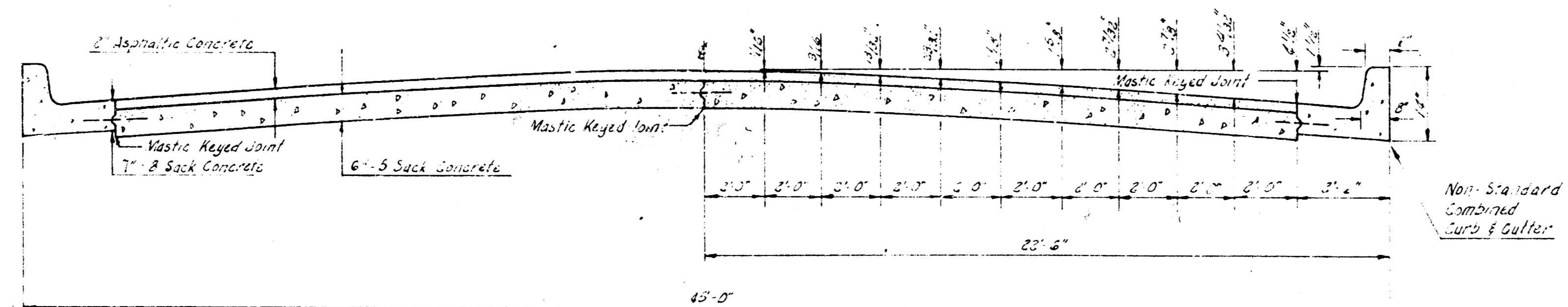

TYPICAL SECTION
 NOT TO SCALE

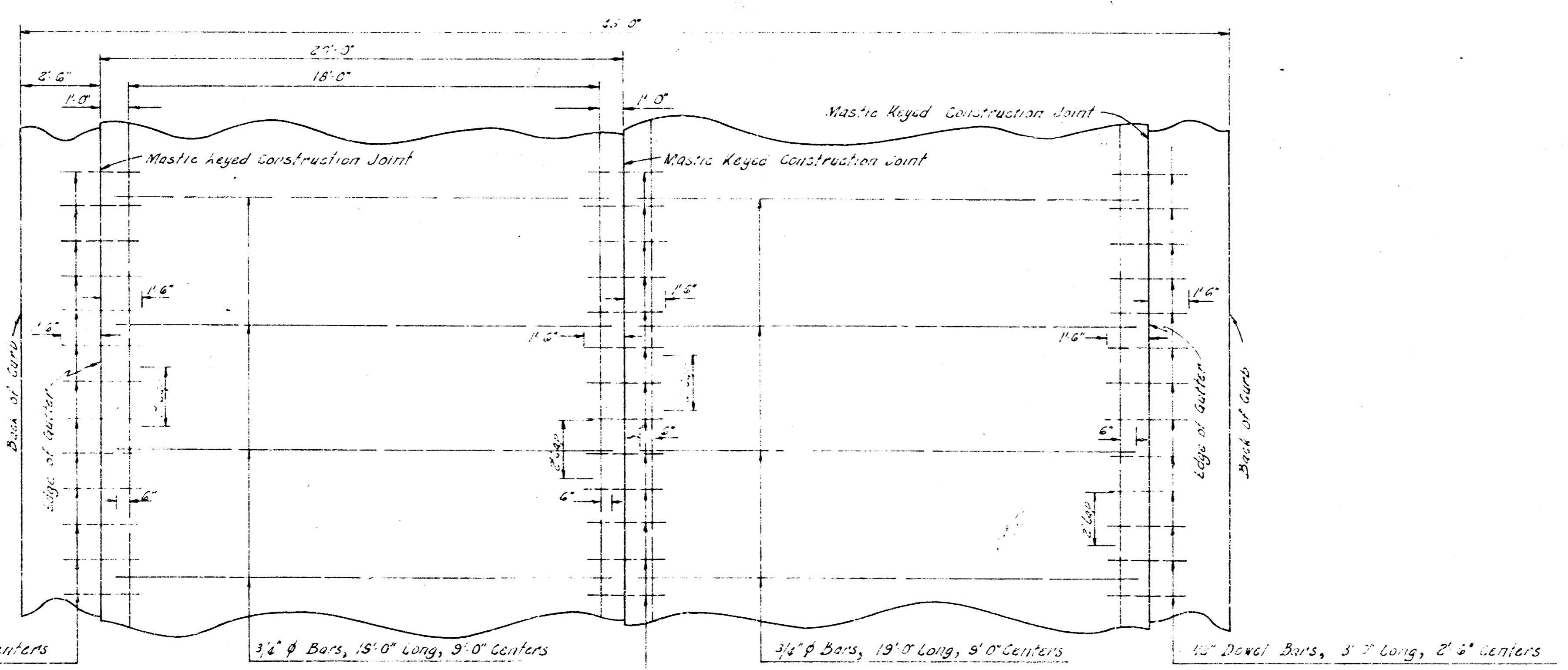

STEEL PATTERN
 NOT TO SCALE

USE 3/4" O BARS EXCEPT WHERE NOTED

201-59
 11/15
 1/16



B.M. 37.605 U.S.G.S. Standard B.M. S.W. Meridian & 31st St. So.
 B.M. 34.90 "R" in Ritchie Web Hiram, N.L. 31st St. So.
 B.M. 34.64 "Y" on E. and N. Handrail conc. bridge Glenn & 31st St. So.

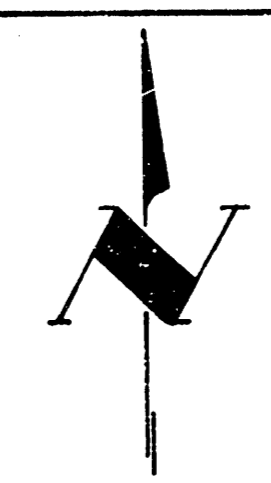

Base Line = 20' s. of Section Line.

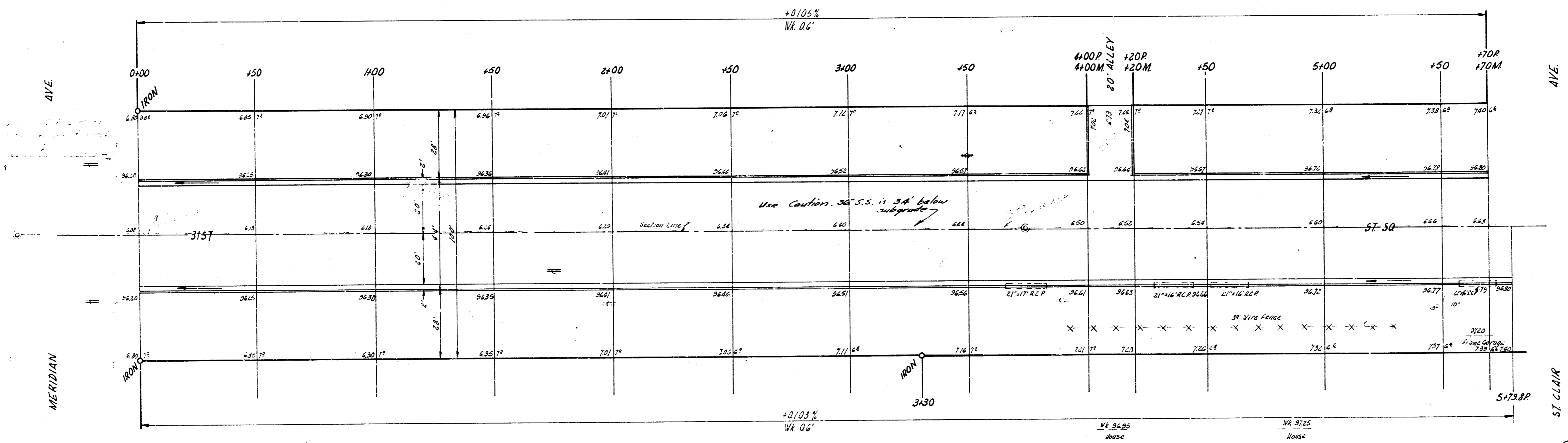

MILLS
JUL 24 1956

NOTE TO FIELD ENGINEER & CONTRACTOR
 All entrance pipes are to be disposed of in accordance with instructions of city dirt checker.
 Use caution working over 36" San. Sewer

Station	Manhole	Depth	Notes
0+00	M.H. 1	4.85	Iron
1+50	M.H. 2	6.20	
4+00	M.H. 3	6.36	
4+50	M.H. 4	7.01	
5+00	M.H. 5	7.06	
6+00	M.H. 6	7.12	
7+00	M.H. 7	7.17	
3+30	M.H. 8	7.16	Iron



31ST ST. SO
 E.L. MERIDIAN - E.L. GLENN
 26'-2"-30" A.C.
 WIDEN TO 44'-6" BASE
 CITY OF WICHITA, KANS.
 B.E. SMITH CITY ENGINEER
 AUG 1956 PROJS. C.S-218 & 219

2/11

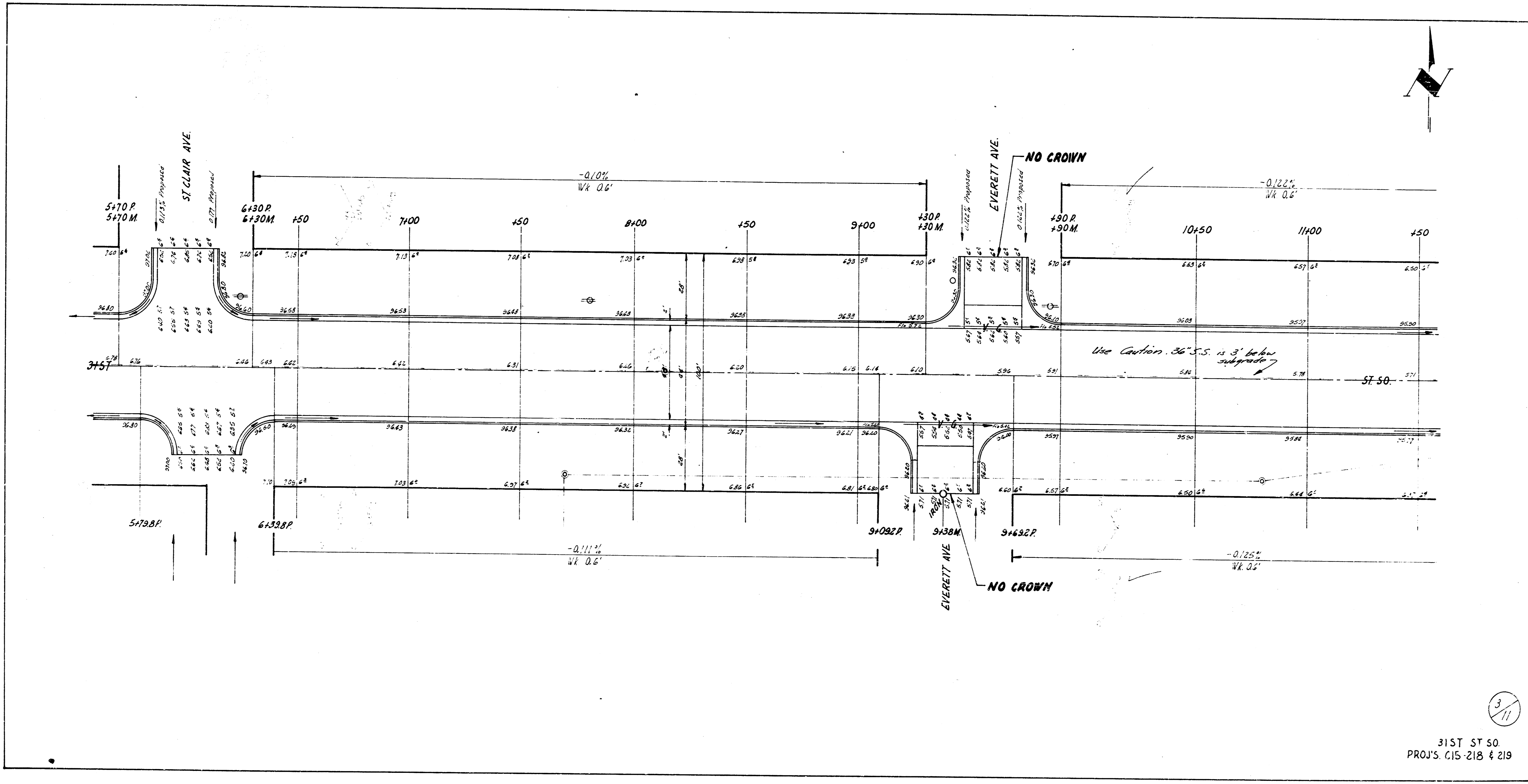

3/11

31ST ST SO.
 PROJ'S. CIS-218 & 219

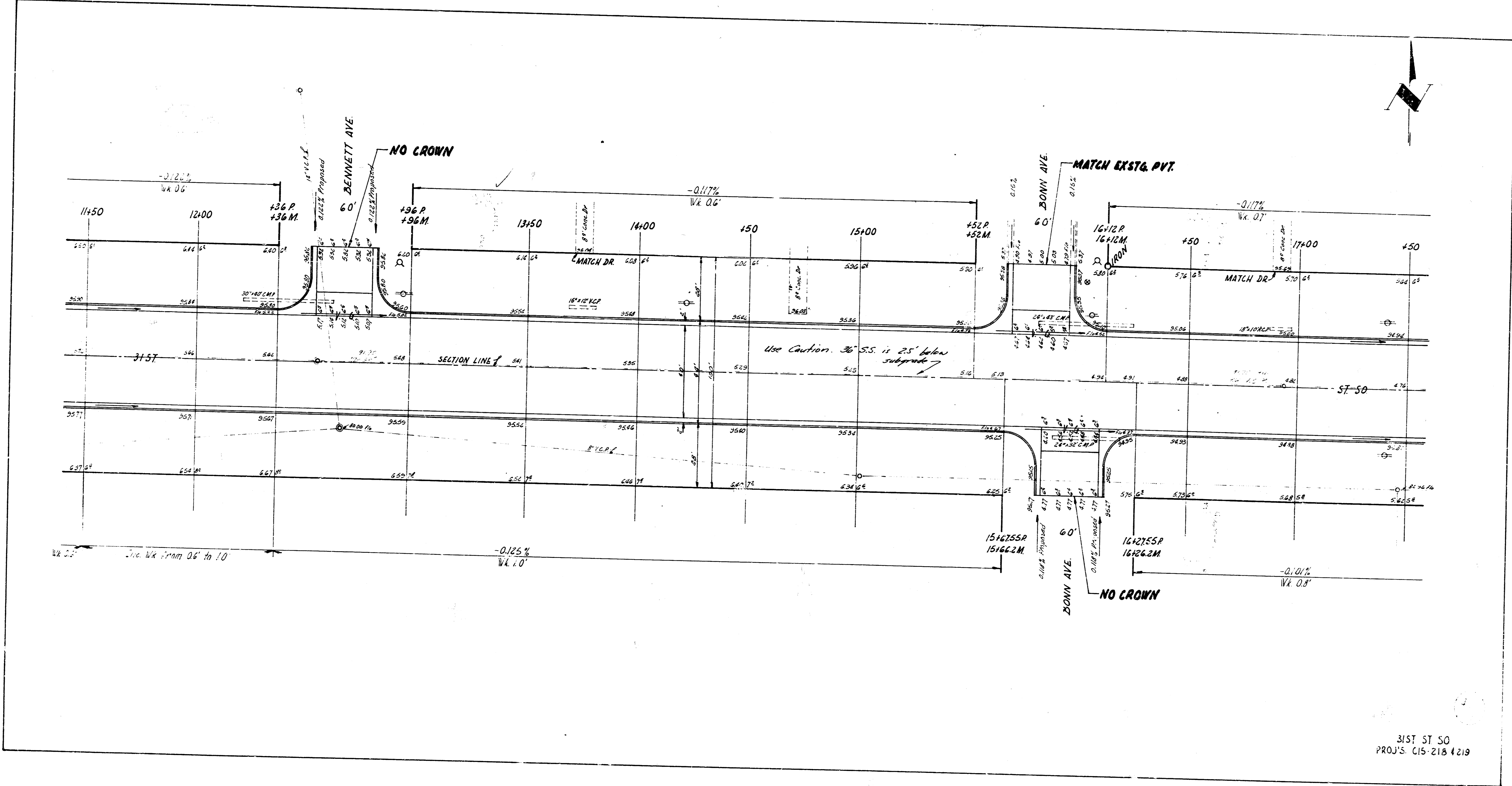

31ST ST 50
 PROJ'S. C15-218 & 219

NOTE TO CONTRACTOR & FIELD ENGINEER:
 No work is to be done from W.L. Euclid to E.L. Glenn until the pavement west of Euclid is completed & open to traffic.

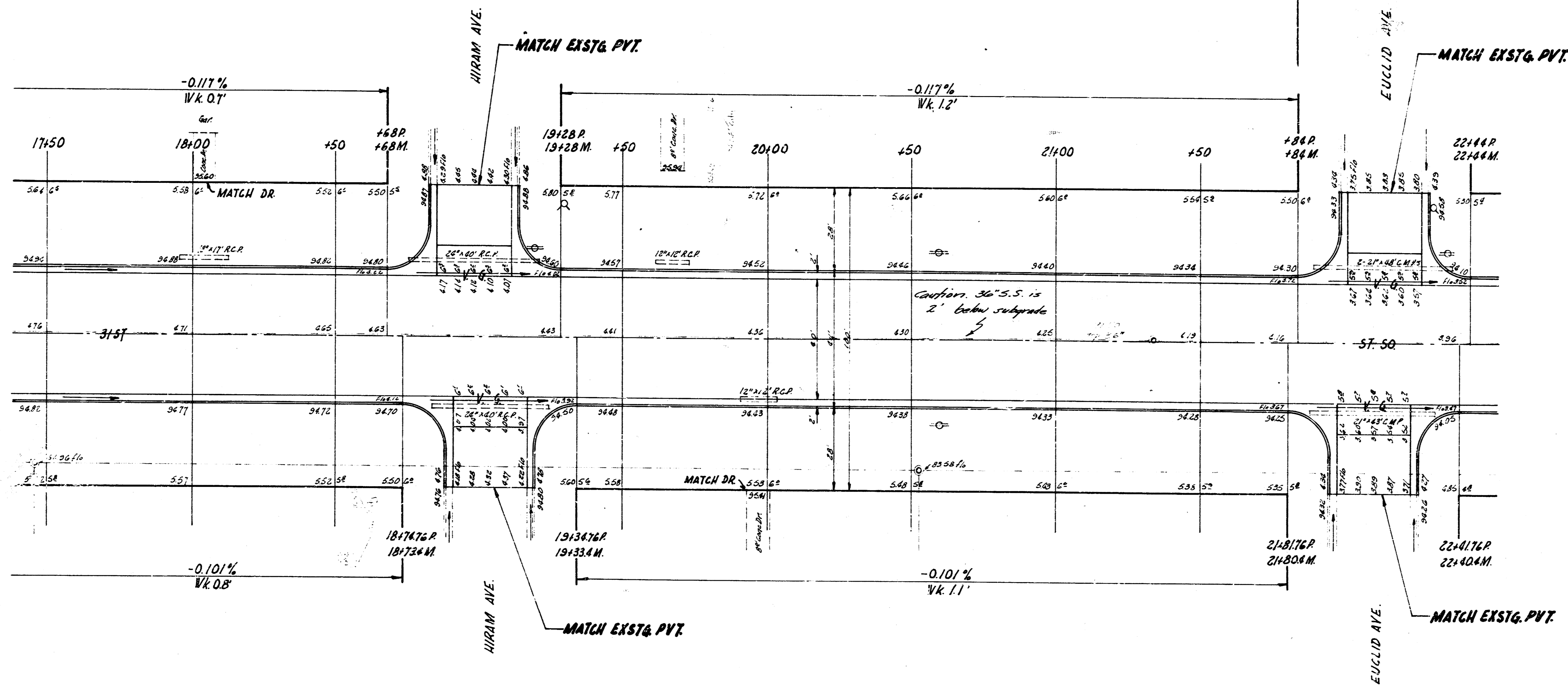
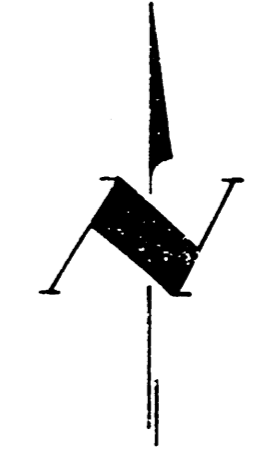

5/11

31ST ST. SO.
 PROJ'S. C15-218 & 219

NOTE TO CONTRACTOR & FIELD ENGR.:
 No work is to be done from W.L. Euclid
 to E.L. Glenn until the pavement west of
 Euclid is completed & open to traffic.

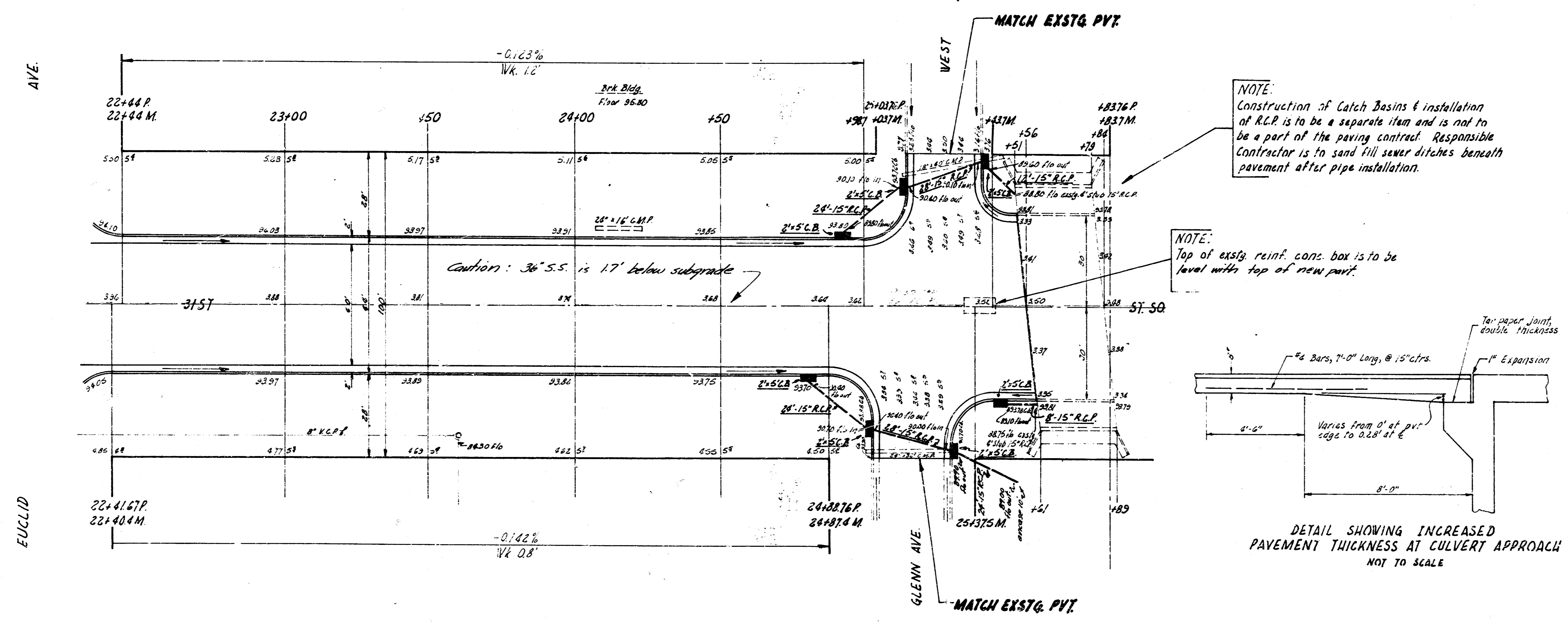
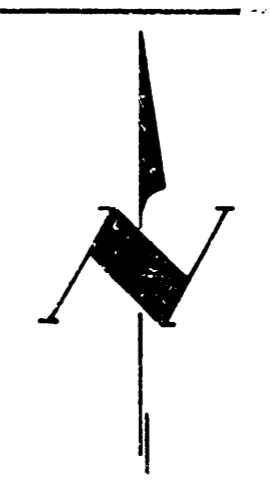

NOTE:
 Construction of Catch Basins & installation
 of R.C.P. is to be a separate item and is not to
 be a part of the paving contract. Responsible
 Contractor is to sand fill sewer ditches beneath
 pavement after pipe installation.

NOTE:
 Top of exstg. reinf. conc. box is to be
 level with top of new part.

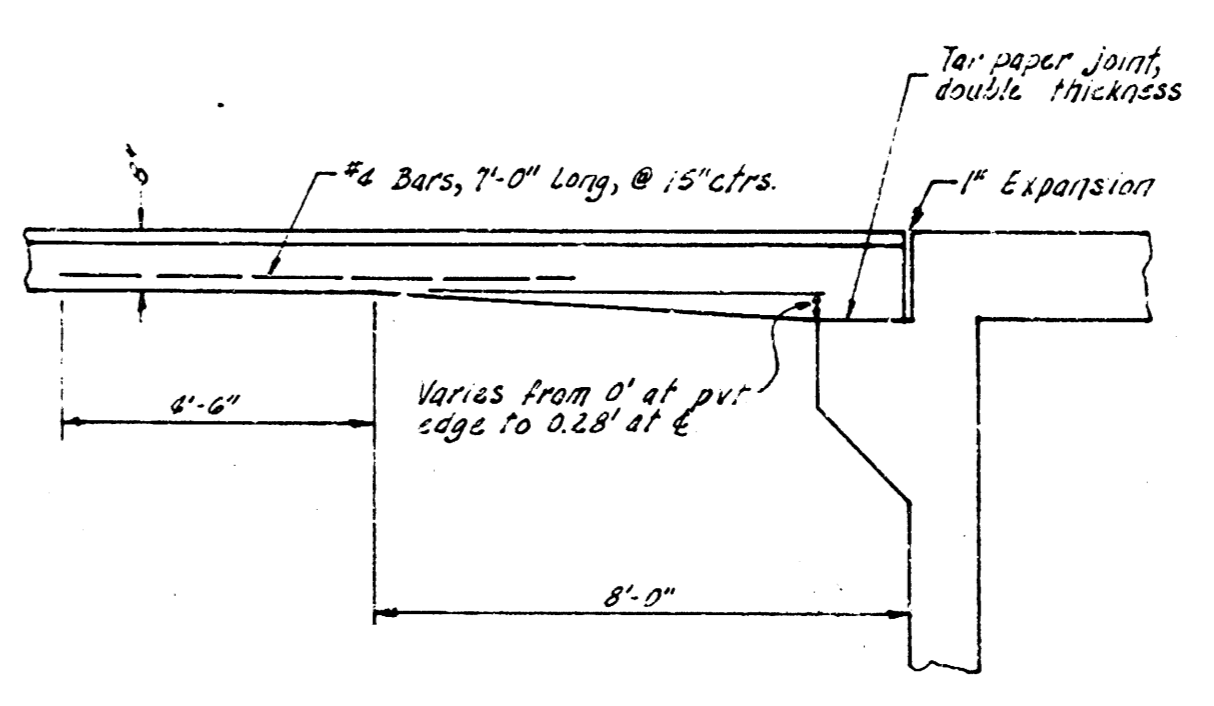

**DETAIL SHOWING INCREASED
 PAVEMENT THICKNESS AT CULVERT APPROACH
 NOT TO SCALE**

6/11

31ST ST. 50.
 PROJ'S. C15-218 & 219