

B.M. 98.10 "R" in Ritchie W. end return NW cor. Mt. Carmel of 32nd St. So.
 B.M. 99.82 R.R. Spike S. S. HLP NS 31st St. So. 100' W. of Gordon.
 B.M. 100.66 "M" in Muller Fire Plug NW cor. Chase of 32nd St. So.
 Chaining from West to East on South Fl.

EXCAVATION
 CITY 3.0
 PROJ 1137.5
 1137.5
 1217.7 20.196

SCALE 1"=20'

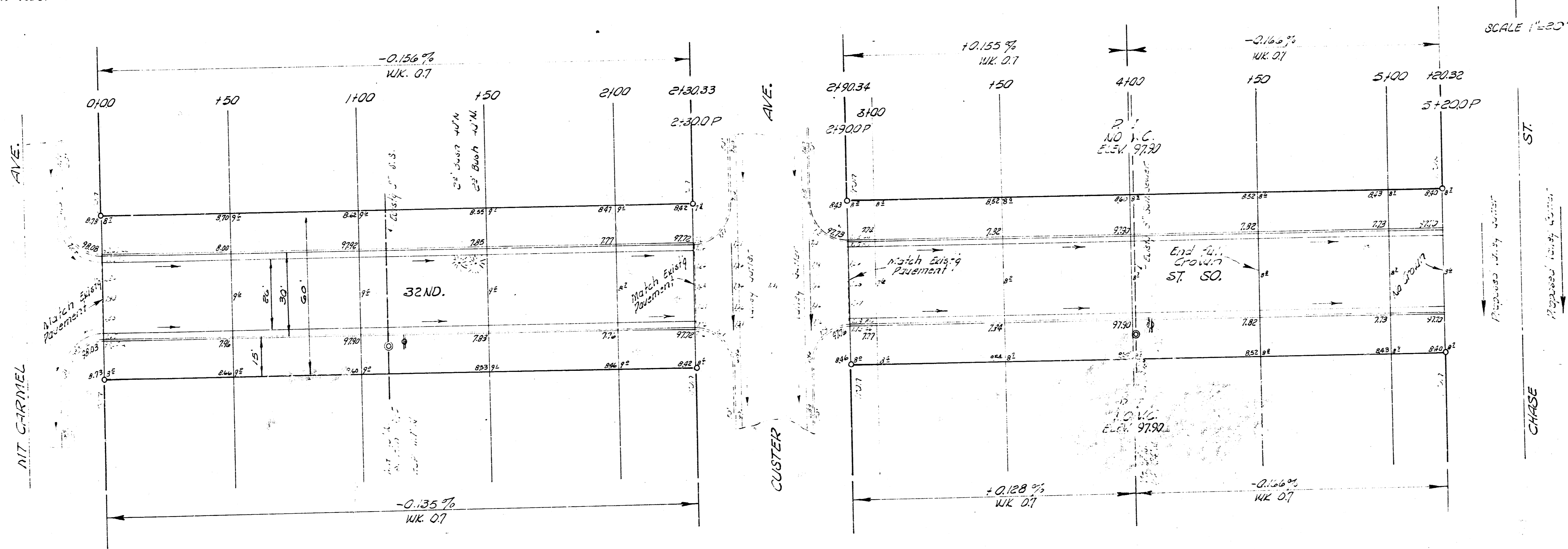

U. Long in J.A.M. 6/10/20 by S.H.S. C.W.

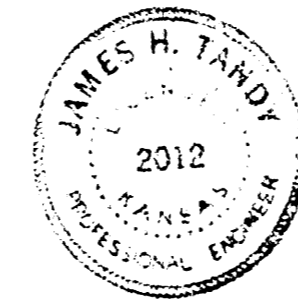

1/2

32ND ST. SO.
 EL. MT. CARMEL TO W. CHASE
 26-2-30 A.C.
 CITY OF WICHITA, KANSAS
 B. E. SMITH CITY ENGINEER
 SEPT 1958, PROJ. NO. C-5-136