

B.M. 9741 U.S.G.S. 31st & Meridian.
 B.M. 9242 "R" in Ritchie N.L. 32nd, E curb Richmond.

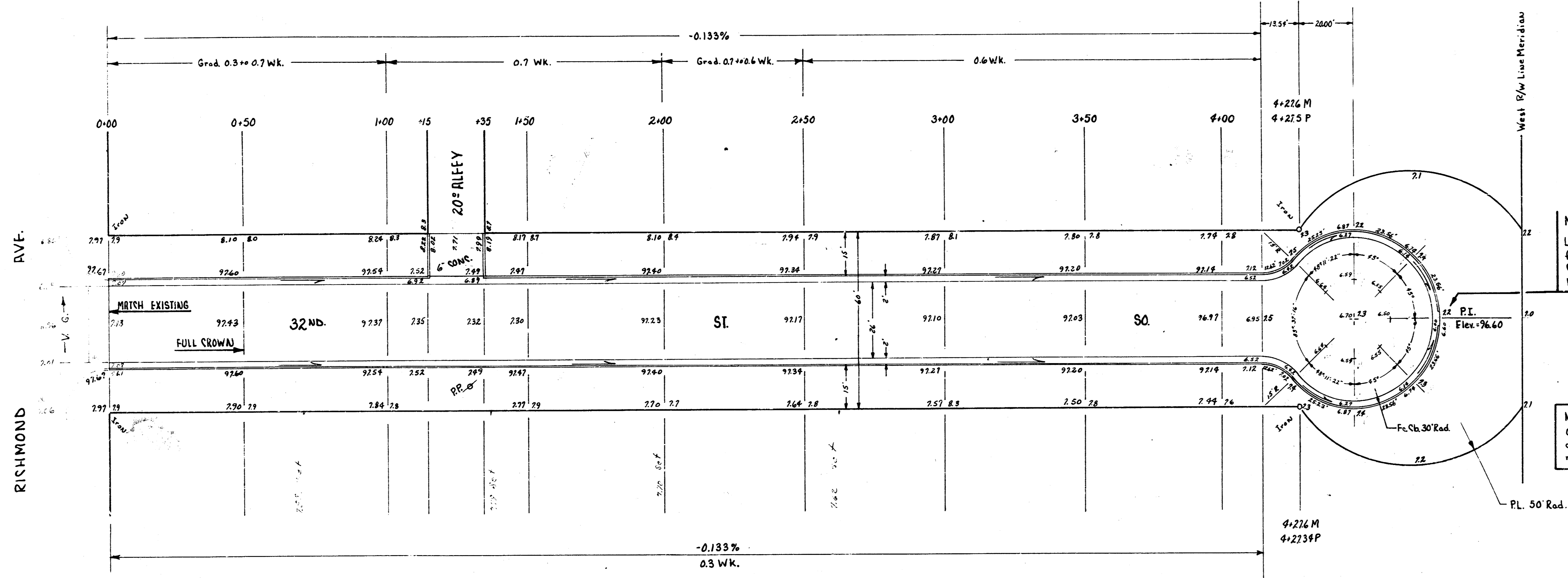
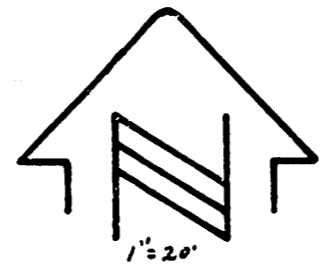

NOTE:
 Leave 5 foot opening in curb
 for drainage east to ditch.
 Concrete rip-rap & ditching to
 be incidental to project.

NOTE:
 Grade parking @
 curb de sac to
 match property line.

EARTHWORK TOTALS

CITY: _____ PROP: _____

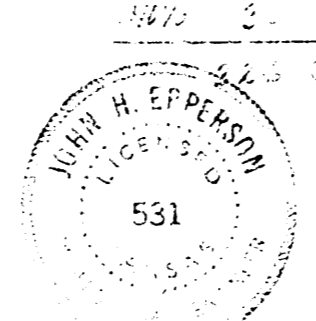

1/2

32ND ST. SO.
 E.L. RICHMOND to W.L. MERIDIAN
 26-2-30 A.C.
CITY OF WICHITA, KANSAS
 B.E. SMITH CITY ENGINEER
 DATE: APRIL 1959, PROJ. NO. C15-103