

# 33<sup>rd</sup> STREET SOUTH

W. L. SHERIDAN AVE.  
TO E. L. MT. CARMEL

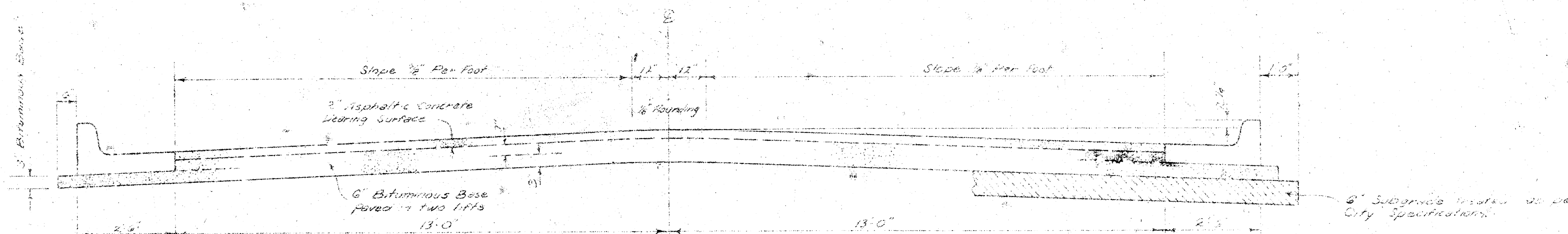

## TYPICAL SECTION

### 3" ASPHALTIC CONCRETE PAVEMENT WITH BITUMINOUS BASE

A TACK COAT OF EMULSIFIED ASPHALT (SS-1H) SHALL BE APPLIED AT AN APPROXIMATE RATE OF 0.05 GALLONS PER SQ. YD. BETWEEN LIFTS OF ASPHALTIC MATERIALS WHEN ORDERED BY THE ENGINEER. TACK COAT WILL NOT BE PAID FOR DIRECTLY AND SHALL BE CONSIDERED AS SUBSIDIARY TO PRICE BID FOR ASPHALTIC PAVEMENT. BITUMINOUS BASE AND ASPHALTIC CONCRETE WEARING SURFACE SHALL BE PLACED WITH A LAYDOWN MACHINE HAVING AUTOMATIC ELECTRONIC CONTROLS FOR CROWN AND GRADE. CONSTRUCTION JOINTS IN EACH LIFT SHALL BE STAGGERED A MINIMUM DISTANCE OF 1' WITH JOINTS IN PRECEDING LIFTS AND SUCH THAT A JOINT WILL BE CONSTRUCTED ON THE PAVEMENT CENTERLINE IN THE TOP LIFT.

### DETAIL OF TRANSVERSE CONSTRUCTION JOINTS

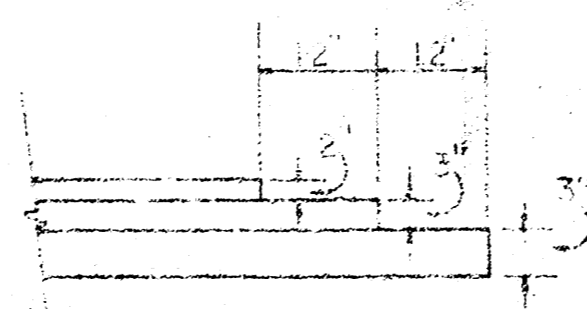

TRANSVERSE CONSTRUCTION JOINTS SHALL BE CONSTRUCTED IN FLEXIBLE BASE PAVEMENTS AT LOCATIONS WHERE PAVEMENT TEMPORARILY ENDS TO FACILITATE FUTURE PAVEMENT CONSTRUCTION AS SHOWN BY DETAIL. THE COST OF CONSTRUCTING THE TRANSVERSE CONSTRUCTION JOINTS SHALL NOT BE MEASURED OR PAID FOR DIRECTLY BUT SHALL BE INCLUDED IN THE BID PRICE FOR SQUARE YARDS OF ASPHALTIC CONCRETE PAVEMENT.

*The A.C. pavement between the concrete curb & gutter shall be paid as 3" A.C. pavement & bituminous base. The Bituminous Base under the curb & gutter shall be paid as 2" Bit. Base.*

COMBINED CURB & GUTTER

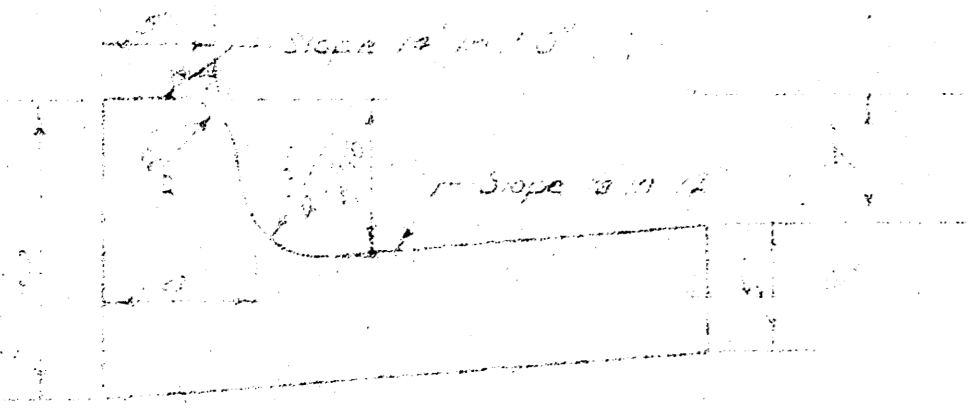

ROLL TYPE CURB & GUTTER

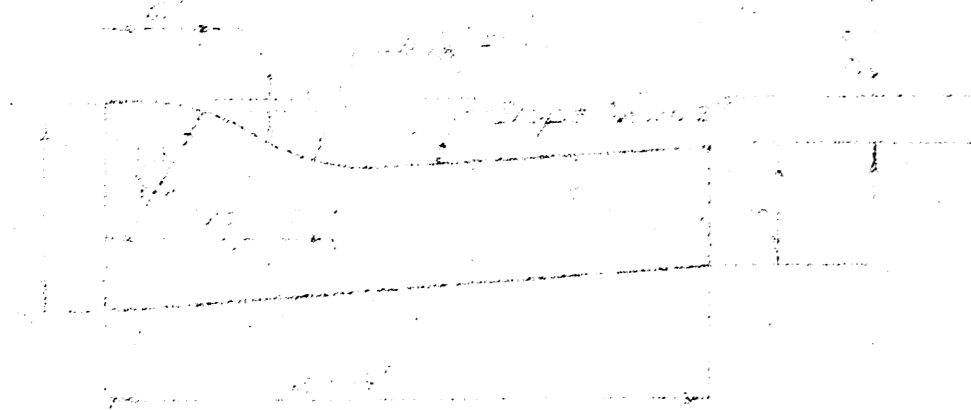

CITY OF WICHITA, KANSAS

DEPARTMENT OF PUBLIC WORKS & ENGINEERING

R. W. LEVIN CITY ENGINEER

DATE \_\_\_\_\_ PROJ. NO. DA\*3575051

1/4

B.M. = 98.44 □ Cut N. End Conc. M.H. on S.W. Cor. Sheridan & 33<sup>rd</sup> St. South

Base Line = North Property Line 33<sup>rd</sup> Street South

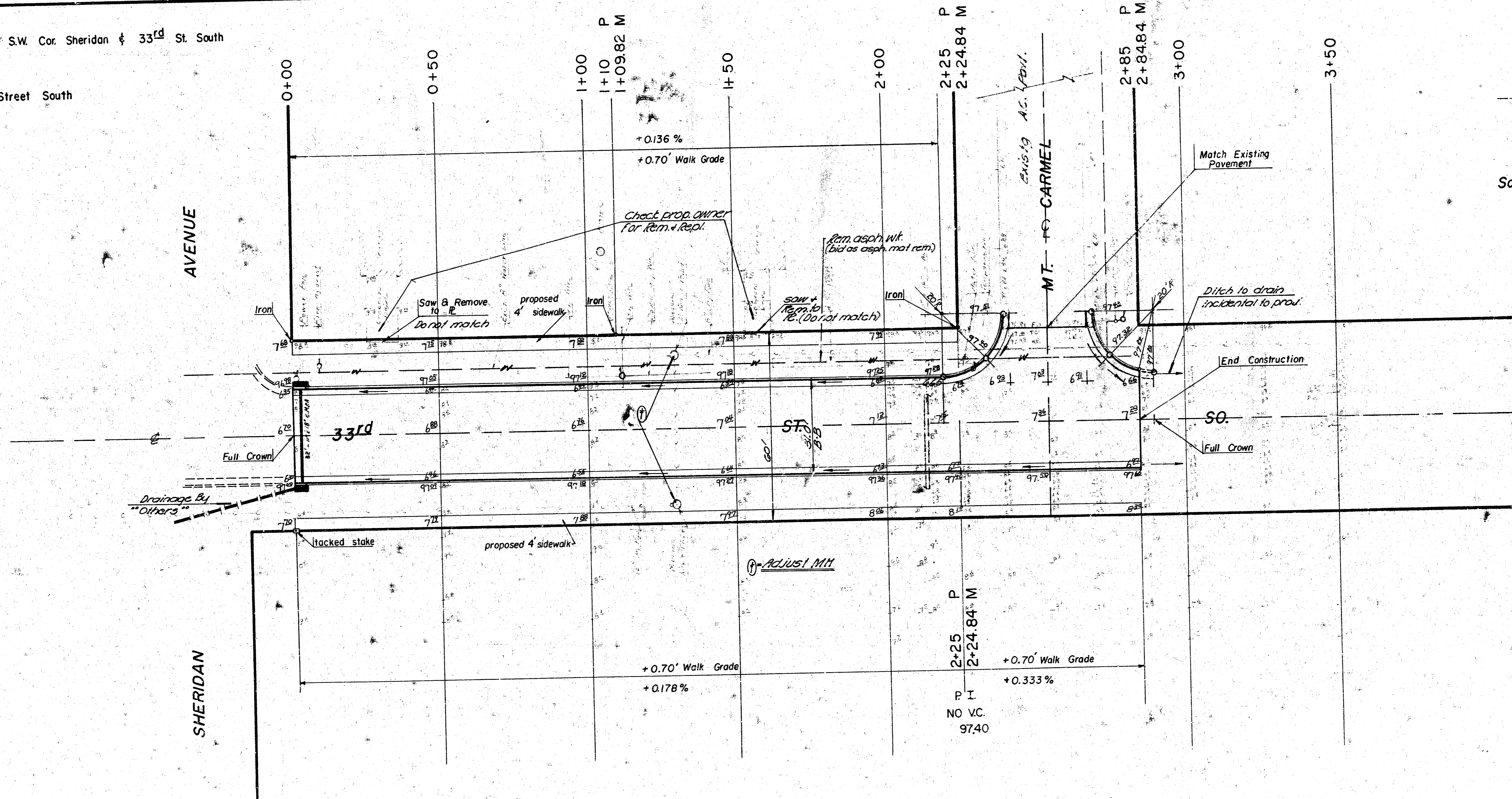

PLAN - Pinner  
SURVEY - Gault  
E.C. - Palmer  
CHECKED - J.P.

**SUB-GRADE**  
TYPE OF SUB-GRADE TREATMENT SHALL BE DETERMINED BY THE FIELD ENGINEER. SUB-GRADE TREATMENT MAY CONSIST OF LIME TREATMENT, CEMENT TREATMENT, SUB-GRADE MODIFICATION OR ANY COMBINATION OF THESE.

NOTE TO FIELD ENGINEER & CONTRACTOR  
Grade parking and clear right-of-way for proposed sidewalk. Compact fill in sidewalk area. TO BE CONSTRUCTED BY "OTHERS".

**CITY**  
Excavation = 74.2 cy  
+10% = 7.8 cy  
Total = 81.6 cy  
  
Comp. Fill = 0.0 cy  
+10% = 0.0 cy  
Total = 0.0 cy  
755 SY Manrip.

**EARTHWORK**

**PROPERTY**  
Excavation = 905.7 cy  
+10% = 90.5 cy  
Total = 996.3 cy  
  
Comp. Fill 0.0 cy  
+10% 0.0 cy  
Total 0.0 cy  
1658X Manrip.

**33<sup>rd</sup> STREET SOUTH**  
M.L. Sheridan Avenue  
To EL. Mt. Carmel  
31' B-B A.C. Pav't W/ Comb. Cb. & Gtr.  
CITY OF WICHITA, KANSAS  
R. W. LINN - CITY ENGINEER  
Project No. DAKS 575051

2/4