

B.M. #1 95.36 N.W. Cor. Concrete Po. House on S.E. Corner Gold of 33rd St.
 B.M. #2 96.20 N.W. Corner Conc. Po. Ho. 407 W. 33rd St.
 B.M. #3 96.74 N.W. Corner Concrete Po. Ho. 301 33rd St.

EXCAV
 Prop. 1003.2 Cu.Yb. CITY
 323.0 Cu.Yb.

Chaining from W. to E. on S. P.L.

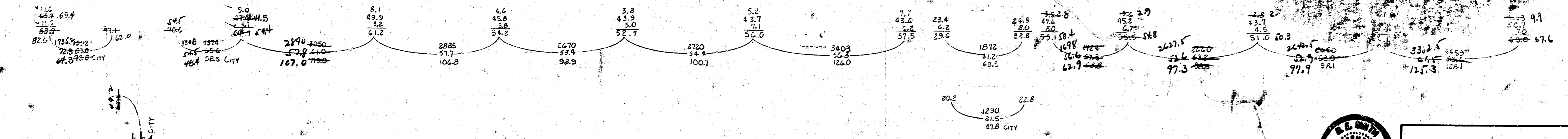
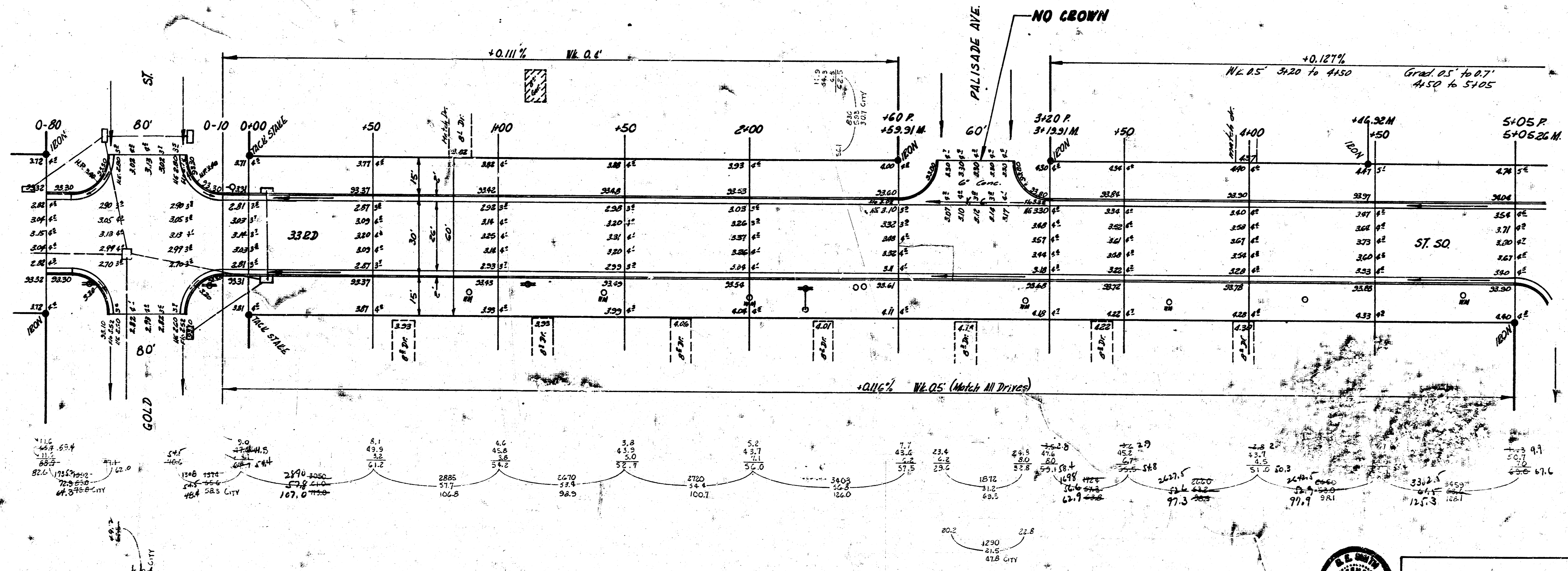

Note to Contractor & Field Engr:
 Intersection @ Gold to be completed
 & open to traffic before starting
 work east of E.L. Gold.



33RD ST. SO.
 W.L. GOLD - W.L. WICHITA
 26-2-30 AC.
 CITY OF WICHITA, KANS.
 B.E. SMITH CITY ENGINEER
 OCT, 1956 PROJ. NO. C14-75

TOTAL EXCAV
 7802 CITY
 2314.4 538.5
 +10% 231.4 +10% 53.8
 2545.8 Cu.Yb. 592.3 Cu.Yb.



EXCAV
 Prop. City
 1511.2 Cu Yd. 2035 Cu Yd.

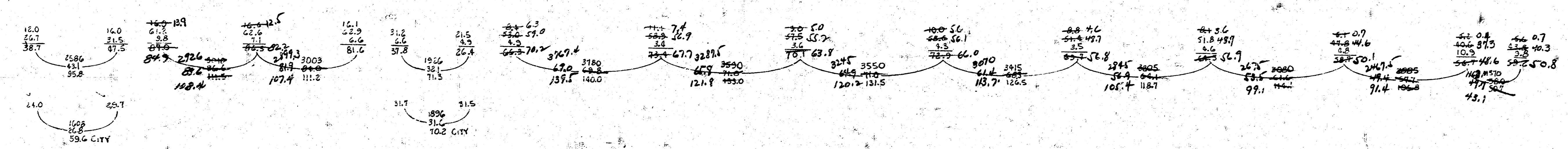
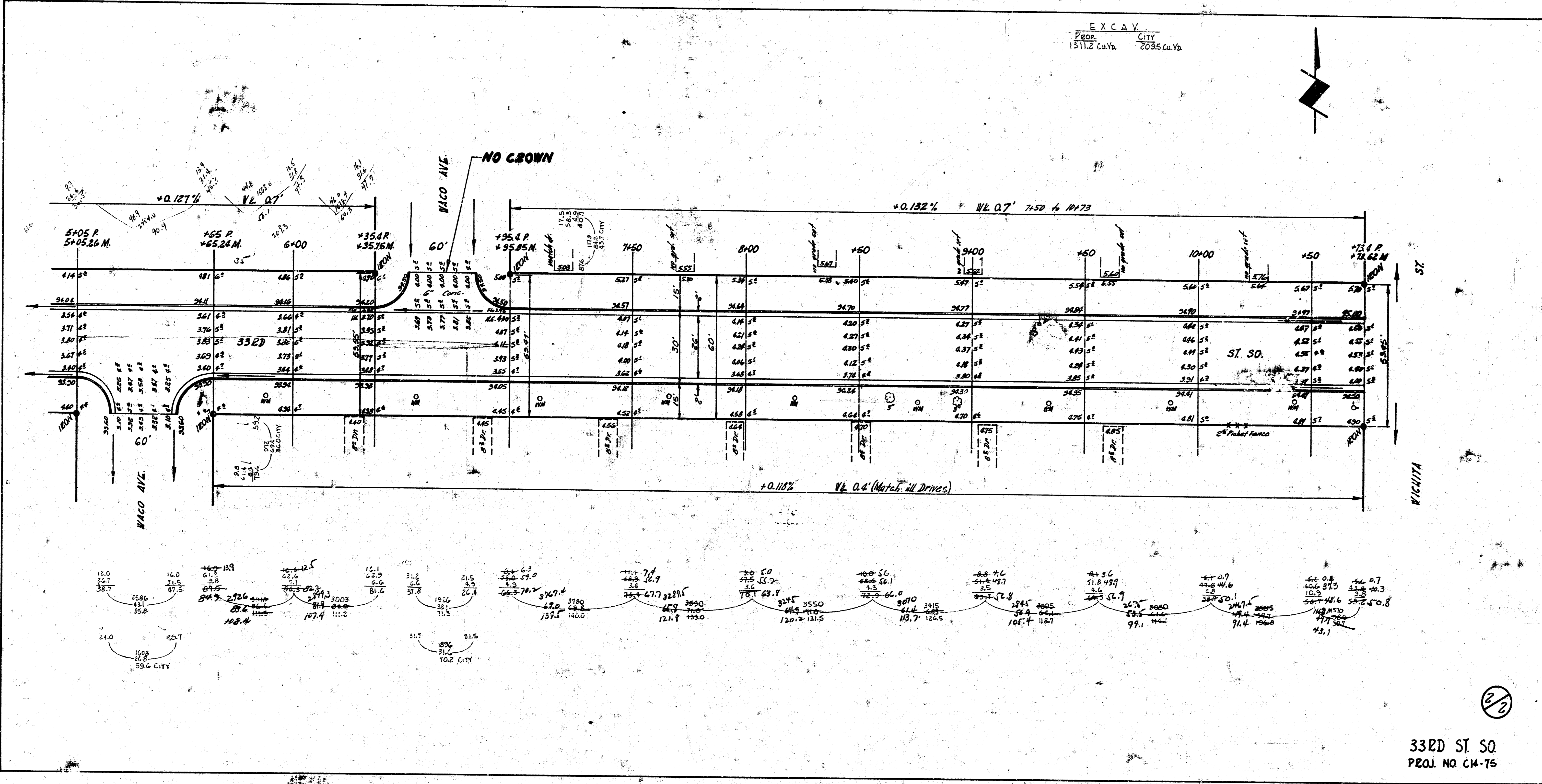
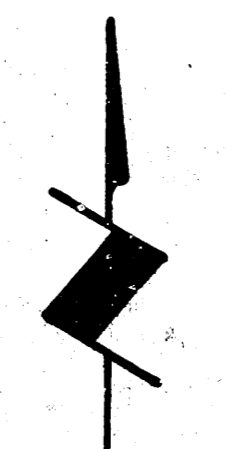

33RD ST. SO
 PROJ. NO. CM-75