

B.M. 9439 S.W. corner concrete front house walk house S.E. corner Gold & 34th St.  
 B.M. 3525 1/2" spike in N. face of P.Pole 10' W. of E.L. Waco 4' 13" S. of S.L. 34th St.  
 B.M. 3512 1/2" spike in N. face Power Pole 135' S. of S. P.I. at about Sta 10+25

Chaining from W. to E. on N. RL

EXCAV  
 Prop. 594.1 Cu.Yd. City 152.8 Cu.Yd.

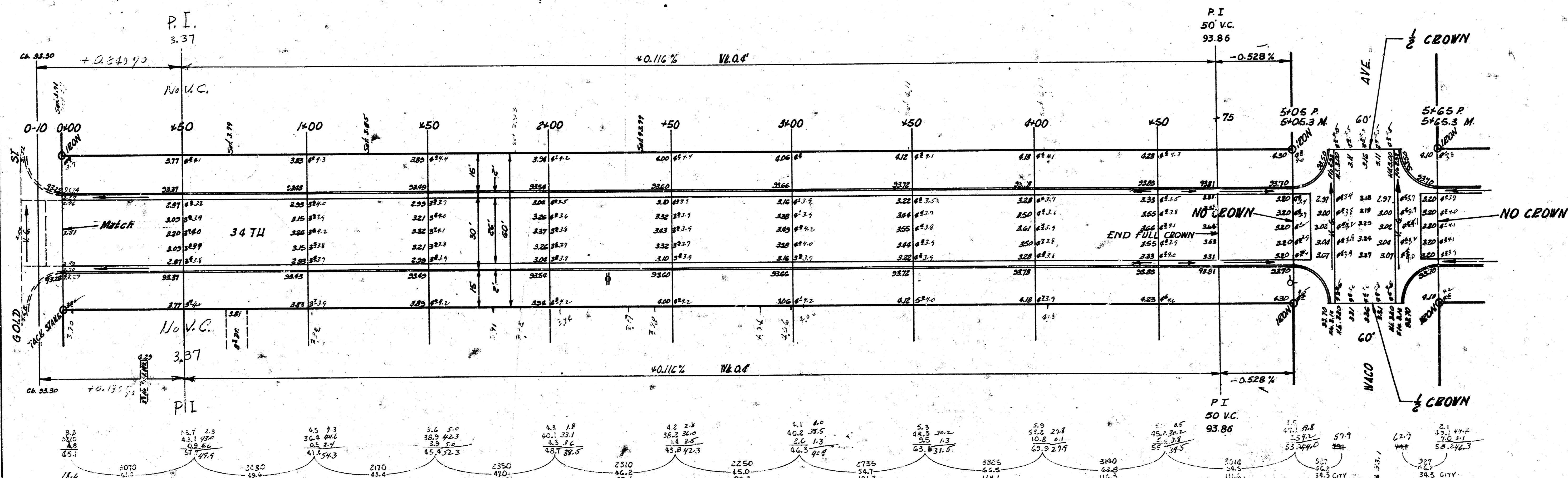

Surveyed by  
 Plan 422  
 Exc. J.E.Z.  
 Checked by

34TH ST. SQ.  
 E.L. GOLD - W.L. WICHITA  
 26-2-30 A.C.  
 CITY OF WICHITA, KANS.  
 B.E. SMITH CITY ENGINEER  
 PROJ. NO. C14-76

TOTAL EXCAV  
 Prop. 594.1 City 152.8  
 10% 163.4 10% 19.1  
 1798.1 Cu.Yd. 216.5 Cu.Yd.



EXCAV.  
 Prop. 6405 CuYd. CITY 0 CuYd.

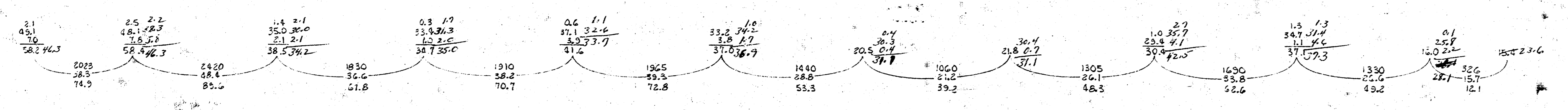
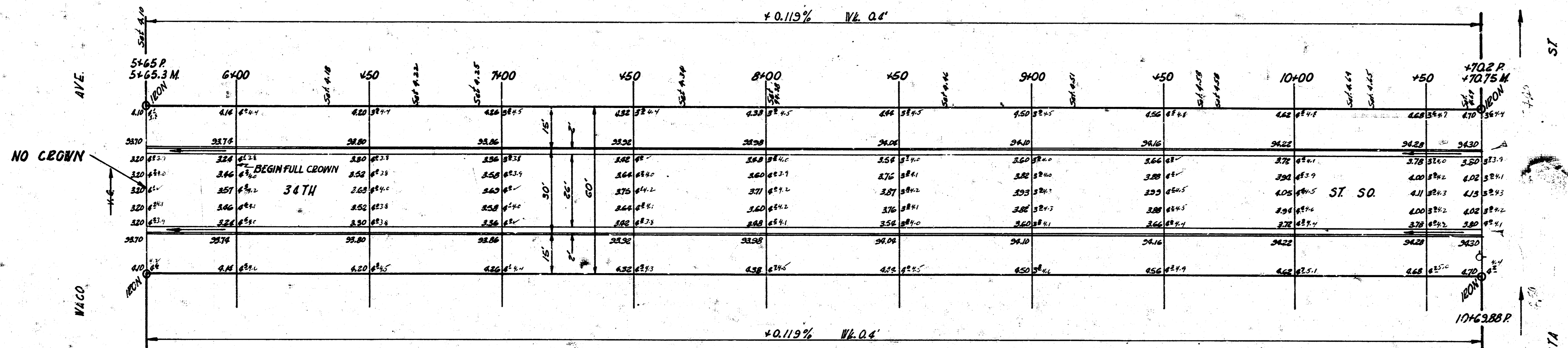

34TH ST. SO  
 PROJ. NO. C14-76