

CERTIFIED ENGINEERING DESIGN

438 North Ohio
Wichita, KS 67214
(316)262-8808 Office
(316)262-0080 Fax

July 21, 1997

Ms. Vicki Huang, P.E.
Engineering Division
City of Wichita
7th Floor, City Hall
455 North Main
Wichita, KS 67202

Re: Drainage Plan
Davis' Mt. Vernon Estates

Dear Ms. Huang:

Attached please find a drainage plan prepared for the final plat of the above referenced addition. Please review this information at your earliest convenience and notify me of your comments. If you have questions, please call me at 262-8808.

Sincerely,

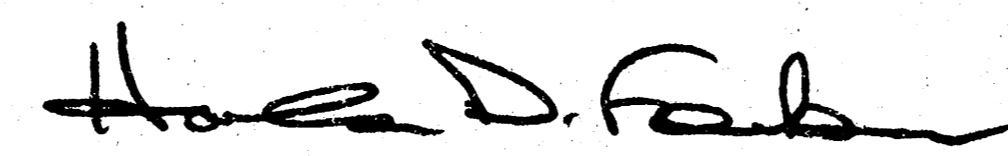

Harlan D. Foraker, P.E.
Kansas P.E. No. 10891

CERTIFIED ENGINEERING DESIGN

cc: Terra Tech Land Surveying, Inc.

DRAINAGE PLAN
SKETCH TO ACCOMPANY FINAL PLAT OF
"DAVIS' MT. VERNON ESTATES"
WICHITA, KANSAS

IN THE NW 1/4 OF SEC. 35, T27S, R1E OF THE 6TH P.M.

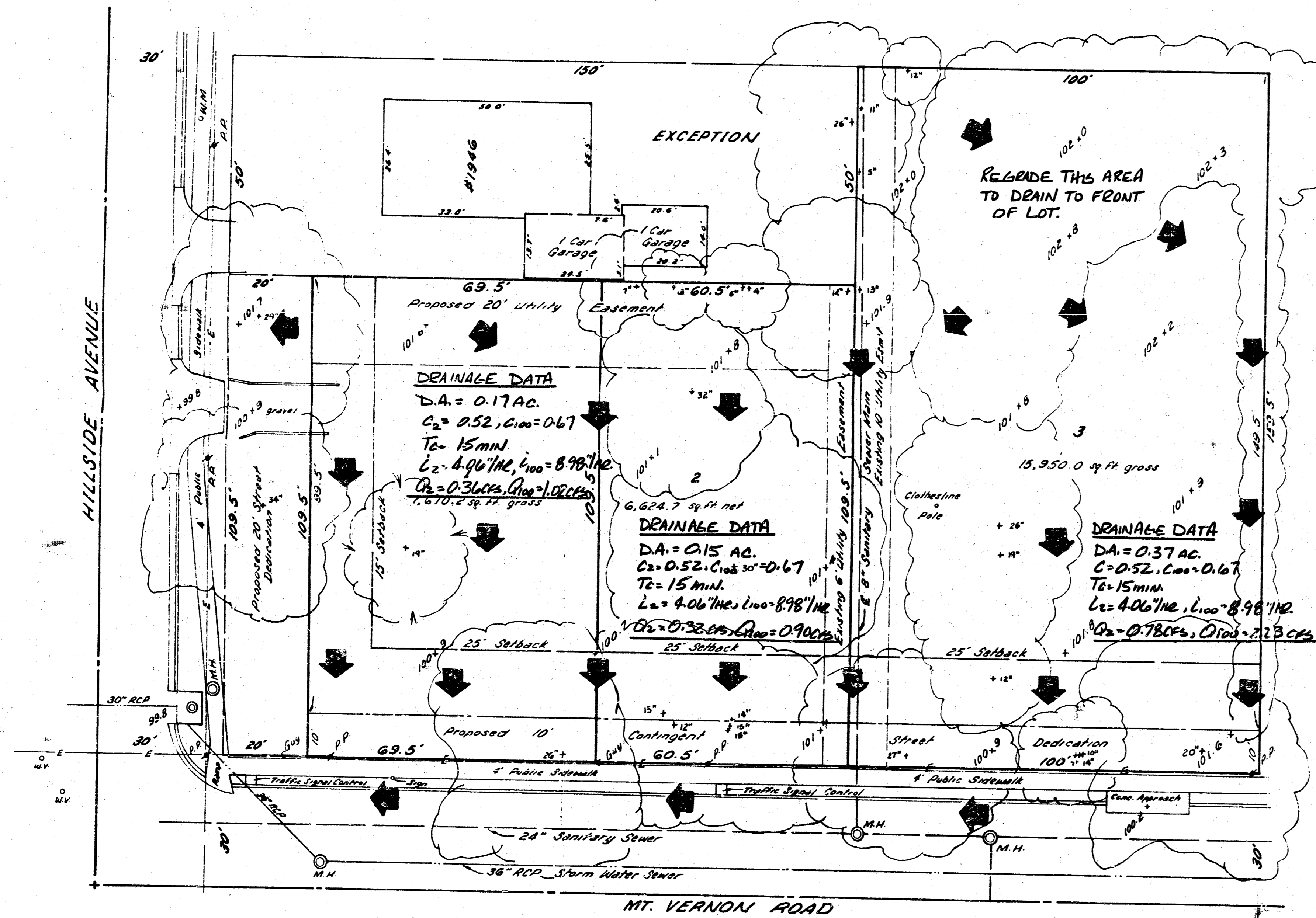

LEGAL DESCRIPTION

A tract BEGINNING 30 feet East and 30 feet North of the Southwest corner of the Northwest Quarter of Section 35, Township 27 South, Range 1 East of the Sixth Principal Meridian, Sedgwick County, Kansas; thence East 350 feet; thence North 159.5 feet; thence West 350 feet; thence South 159.5 feet to the POINT OF BEGINNING, EXCEPT the North 50 feet of the West 150 feet and EXCEPT the East 100 feet thereof.

FLOOD ZONE

According to Federal Emergency Management Agency Flood Insurance Rate Map 200328 0025 B, City of Wichita, Kansas, dated May 15, 1988, subject property is in Zone B.

BENCHMARK

City Standard Disc. at the Southeast corner of the intersection of Hillside Avenue and Mt. Vernon Road, in the Northeast corner of concrete traffic signal light.

Elevation 100.97 City Datum

Base Flood Elevation = 1284 MSL (96.6 City Datum)

Lowest Opening Elevation shall be no lower than 1285 MSL (97.6 City Datum)

ACCESS CONTROLS SHALL BE AS FOLLOWS:

- 1) Complete Access Control to Hillside Avenue
- 2) Access Control to Mount Vernon Road Except One Opening Per Lot

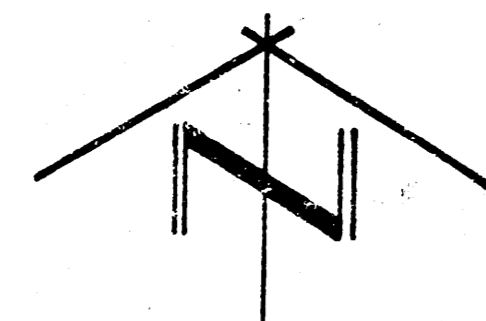

SCALE: 1" = 20'
 FILE #970222
 17 JUNE, 1997
 3 JULY, 1997
 18 JULY, 1997

OWNER/DEVELOPER

KDA, Inc.
 c/o Mr. Grant Davis
 Davis-Moore
 8215 E. Kellogg
 Wichita, Kansas 67218
 (316) 685-0211

ARCHITECT

Sam L. Mobley
 420 S. Ridge Road
 Wichita, Kansas 67209
 (316) 943-5480

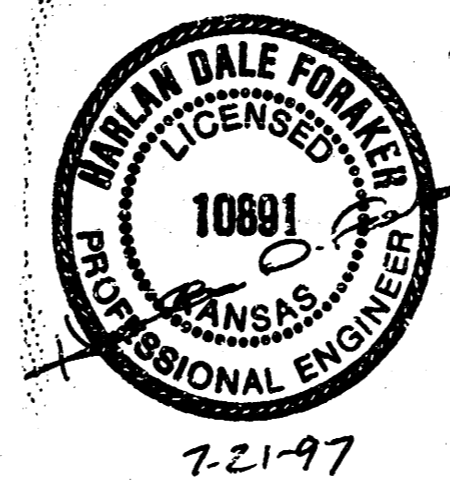

TERRA TECH | **LAND SURVEYING INC.**

239 North Ohio
 Wichita, Kansas 67214-3933
 (316) 267-0744 / 267-2348
 Fax (316) 267-2736

DRAINAGE PLAN
SKETCH TO ACCOMPANY FINAL PLAT OF
"DAVIS' MT. VERNON ESTATES"
WICHITA, KANSAS

IN THE NW 1/4 OF SEC. 35, T27S, R1E OF THE 6TH P.M.

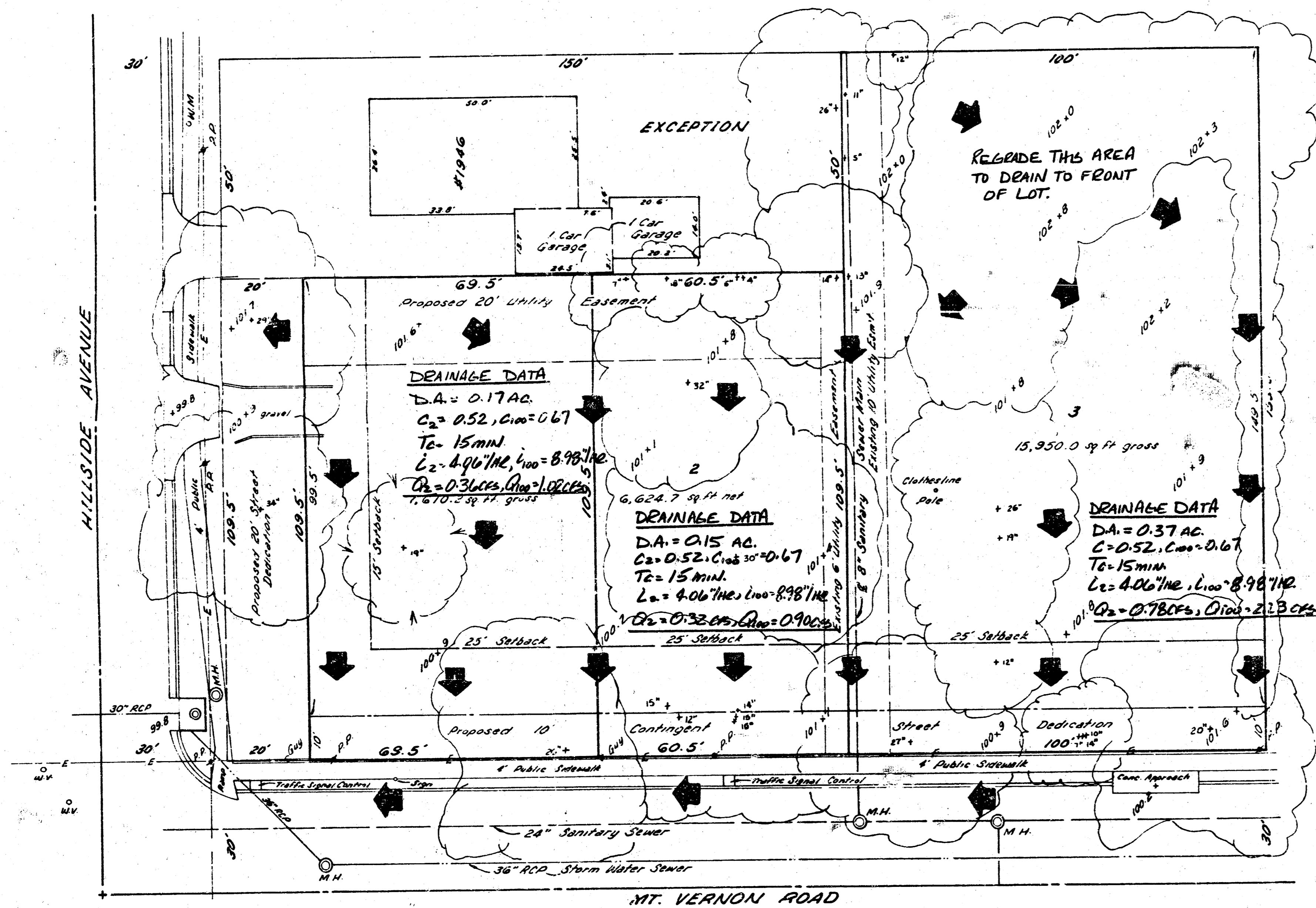

LEGAL DESCRIPTION

A tract BEGINNING 30 feet East and 30 feet North of the Southwest corner of the Northwest Quarter of Section 35, Township 27 South, Range 1 East of the Sixth Principal Meridian, Sedgewick County, Kansas; thence East 350 feet; thence North 159.5 feet; thence West 350 feet; thence South 159.5 feet to the POINT OF BEGINNING, EXCEPT the North 50 feet of the West 150 feet and EXCEPT the East 100 feet thereof.

FLOOD ZONE

According to Federal Emergency Management Agency Flood Insurance Rate Map 200328 0025 B, City of Wichita, Kansas, dated May 15, 1986, subject property is in Zone B.

BENCH MARK

City Standard Disc. at the Southeast corner of the intersection of Hillside Avenue and Mt. Vernon Road, in the Northeast corner of concrete traffic signal light.
 Elevation 100.97 City Datum

Base Flood Elevation = 1284 MSL (96.6 City Datum)

Lowest Opening Elevation shall be no lower than 1285 MSL (97.6 City Datum)

ACCESS CONTROLS SHALL BE AS FOLLOWS:

- 1) Complete Access Control to Hillside Avenue
- 2) Access Control to Mount Vernon Road Except One Opening Per Lot

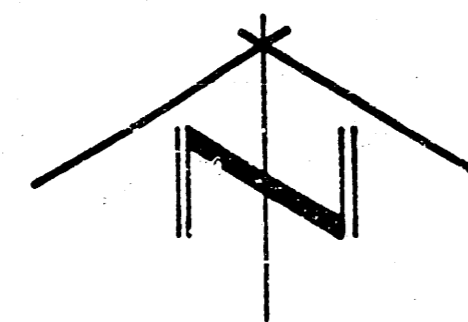

SCALE: 1"=20'
 FILE #970222
 17 JUNE, 1997
 3 JULY, 1997
 14 JULY, 1997

OWNER/DEVELOPER

KDA, Inc.
 c/o Mr. Grant Davis
 Davis Moore
 6215 E. Vollogg
 Wichita, Kansas 67218
 (316) 685-0211

ARCHITECT

Sam L. Mobley
 420 S. Ridge Road
 Wichita, Kansas 67209
 (316) 943-5480

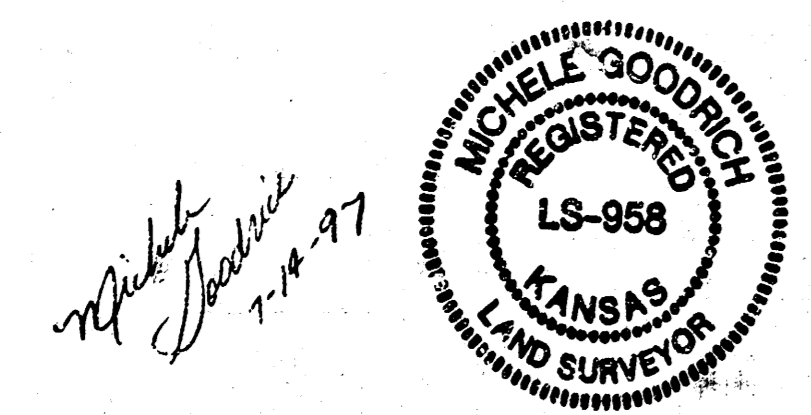
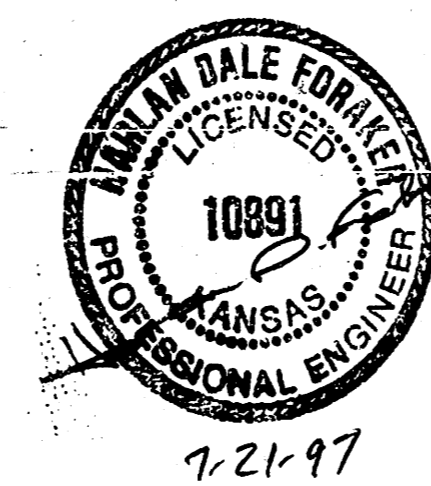

TERRA TECH | **LAND SURVEYING INC.**

239 North Ohio
 Wichita, Kansas 67214-3933
 (316) 267-0244 / 267-2348
 Fax (316) 267-2736