

# PRELIMINARY PLAT DILLON 10TH ADDITION

LOTS 1, 2 AND 3 WITH HENNING ADDITION TO WICHITA, SEDGWICK COUNTY, KANSAS TOGETHER WITH ALL OF THE ALLEY LYING SOUTH OF AND ADJACENT TO SAID LOTS 1, 2 AND 3, LOTS 4 AND 5 OF LOMA-LINDA GARDENS AN ADDITION TO WICHITA, SEDGWICK COUNTY, KANSAS AND LOT 1, LOMA-LINDA GARDENS SECOND ADDITION, WICHITA, SEDGWICK COUNTY, KANSAS.

DILLON REAL ESTATE CO., INC.

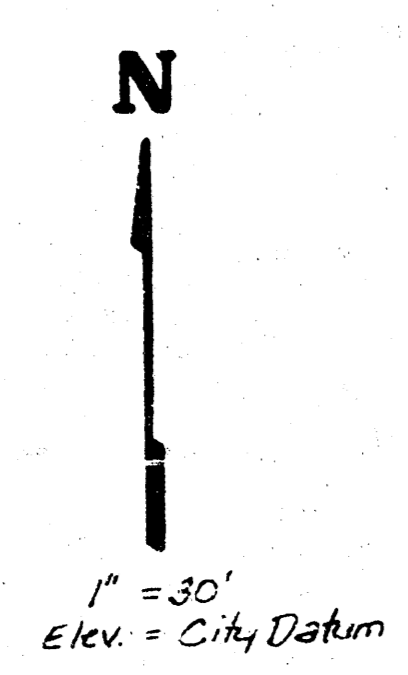

BENCH MARK:  
City Standard Disc 6" N & 2" W of  
SW Cor. of Seneca & 35th St. So.  
Elev. = 32.691 City Datum

drainage plan

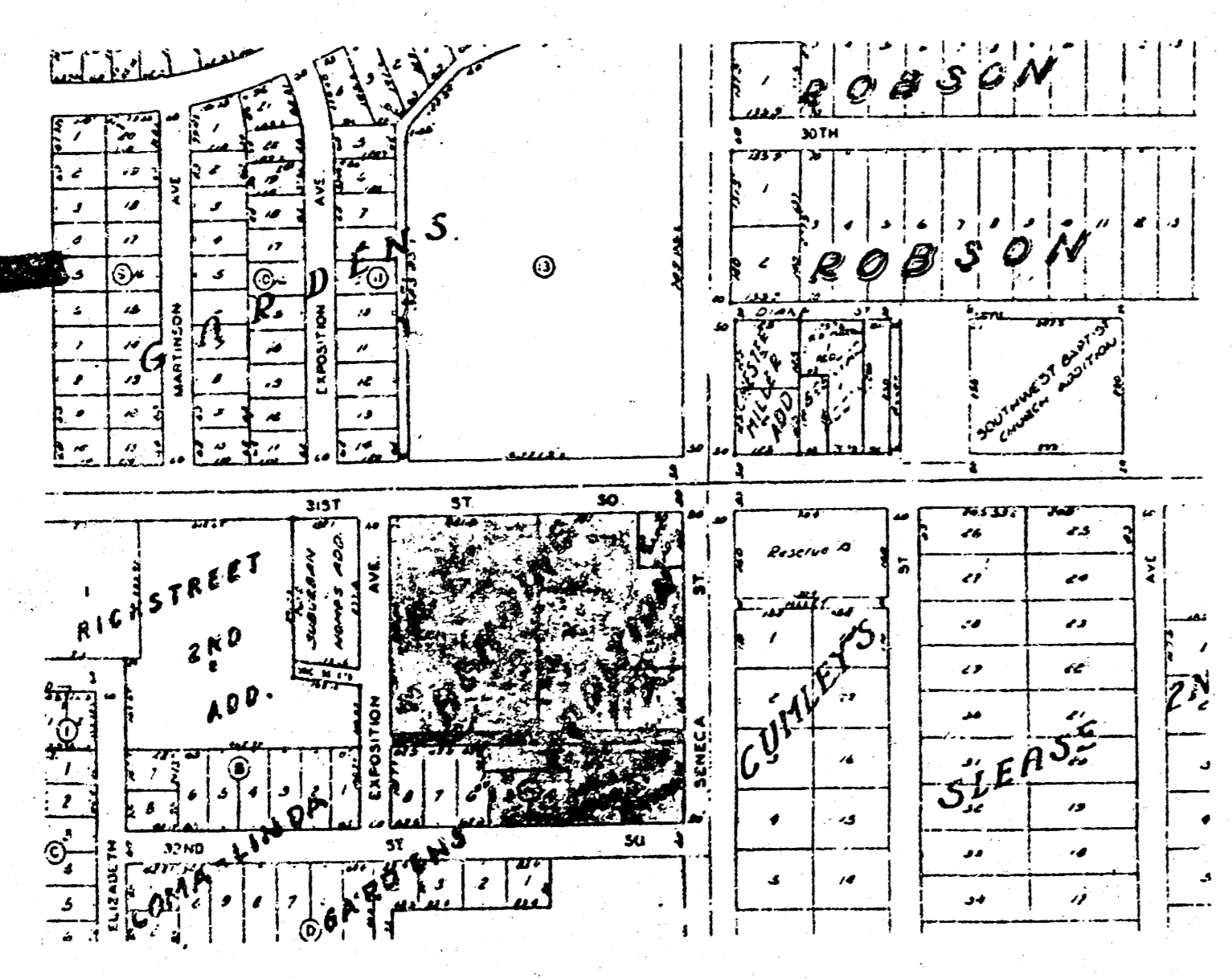

VICINITY PLAT

