

1.30'  
Elevation City Datum

BENCH MARK: City Standard Dwg.  
in sidewalk at N.E. Cor. of Bridge  
over Arkansas River at Lewis St.  
Elevation: 1300.08 M.S.L.  
Elevation: 122.08 City Datum

### PRELIMINARY PLAT EASTBANK FIRST ADDITION

PART OF THE SE 1/4 OF SEC 20, TWP 27-S, R-1-E AND PART  
OF G. A. HATFIELDS ADDITION AND PART OF JACKSON-WALKER  
ADDITION AND PART OF SWOPES ADDITION AND DEWEY STREET,  
LYING WEST OF THE WEST LINE OF WICHITA STREET.

CITY OF WICHITA - REAL ESTATE DEPARTMENT



#### DRAINAGE NOTES

The two commercial zoned lots when redeveloped will be regraded to drain east to the paved street. Wichita St. presently drains south as indicated to inlets. A small undersized storm sewer exists adjacent to these lots in Wichita St. Another larger storm sewer exists to the south of these lots and drains into the Arkansas River.

At the time of redevelopment of these lots appropriate storm sewer may be extended from the storm sewer to the south if necessary. Adequate provisions and means of drainage methods for this site will be determined as necessary and installed at the time development plans are designed and approved by the City.

#### UTILITY NOTES

8" public sanitary sewers are in the Wichita Street right-of-way adjacent to the site as well as 8" extensions into each lot. 10" public water main is also in the Wichita Street right-of-way and adjacent to the lots.

ARKANSAS RIVER

ARKANSAS

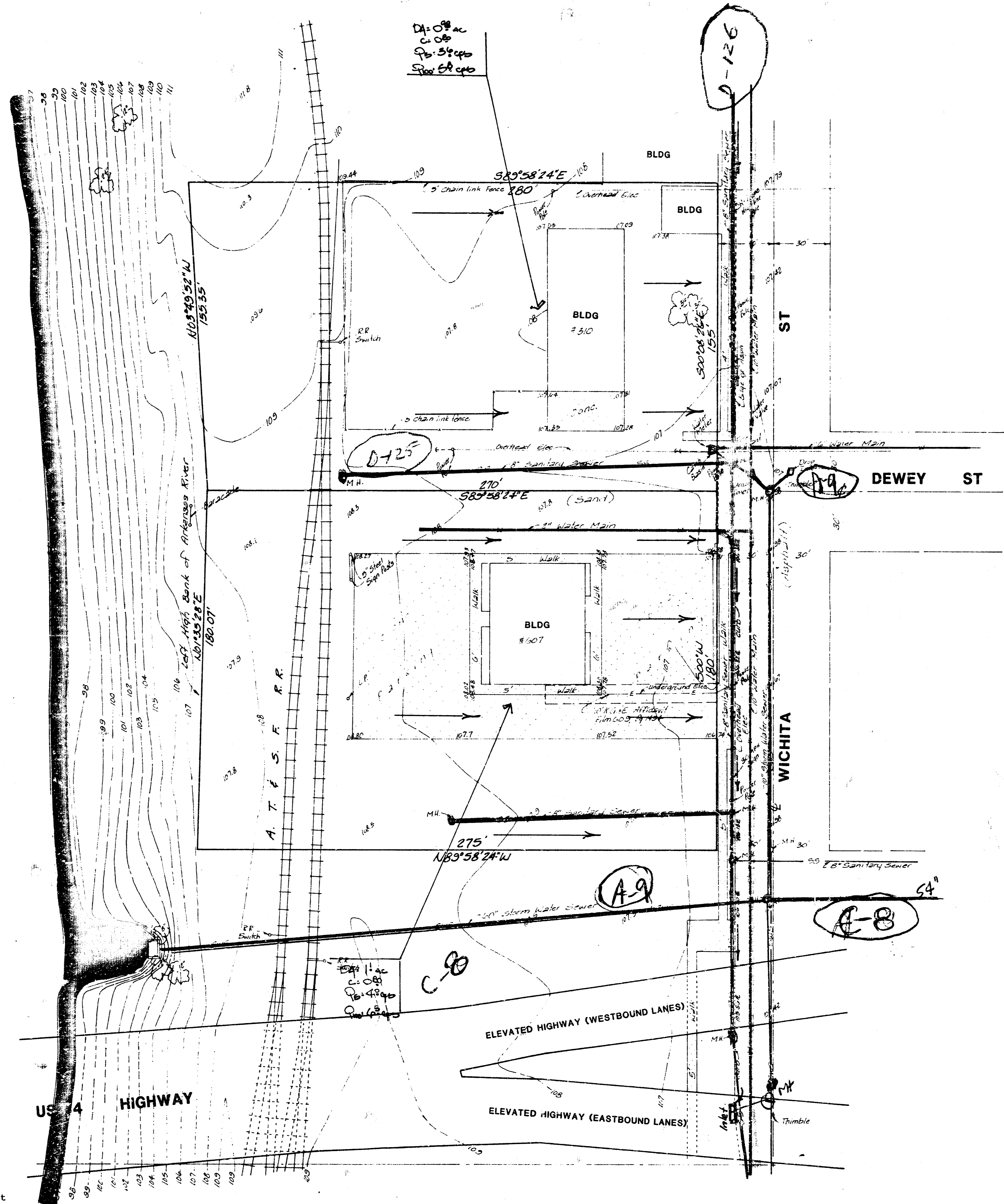

### DRAINAGE & UTILITY PLAN

BAUGHMAN COMPANY, P.A.  
SURVEYING & ENGINEERING  
315/282-7211 • 315 ELLIS • WICHITA, KANSAS 67211  
10 Mar 1988

