

NOTES

- ZONING: Existing Single Family "SF-20"
Proposed Single Family "SF-5"
- RESERVES platted for:
 - "A," "B," "D," "E," "F," "K," "L" - monuments, landscaping, irrigation, and open space.
 - "M" - drainage in designated locations
 - "C," "I," "G," "H" - lakes, floodway, and drainage in designated locations, also house, pool, playground, sidewalks, landscaping, irrigation, berming, monuments, and open space.
 - "J" - drainage, sidewalks, landscaping, irrigation, berming, monuments, and open space.
 - Reserve "N" & "O" - private streets, drainage, utilities, monuments and open space.

3. Lot minimum pad elevations as indicated on the DRAINAGE PLAN, provided at the time of FINAL PLATTING

BENCHMARK

- BM#1 60" IN SOUTH LEG OF "H" POLE HIGH LINE STRUCTURE, 75' NORTH & 80' EAST OF C 127TH STREET & CENTERLINE BURLINGTON NORTHERN RAILROAD ELEV. = 1365.37
- BM#2 Top of iron at SW Cor., SW 1/4, Sec. 2, T27S, R2E, (127th St. E. & 21st St. N.) ELEV. = 198.01 (CITY DATUM) 1385.41 NGVD

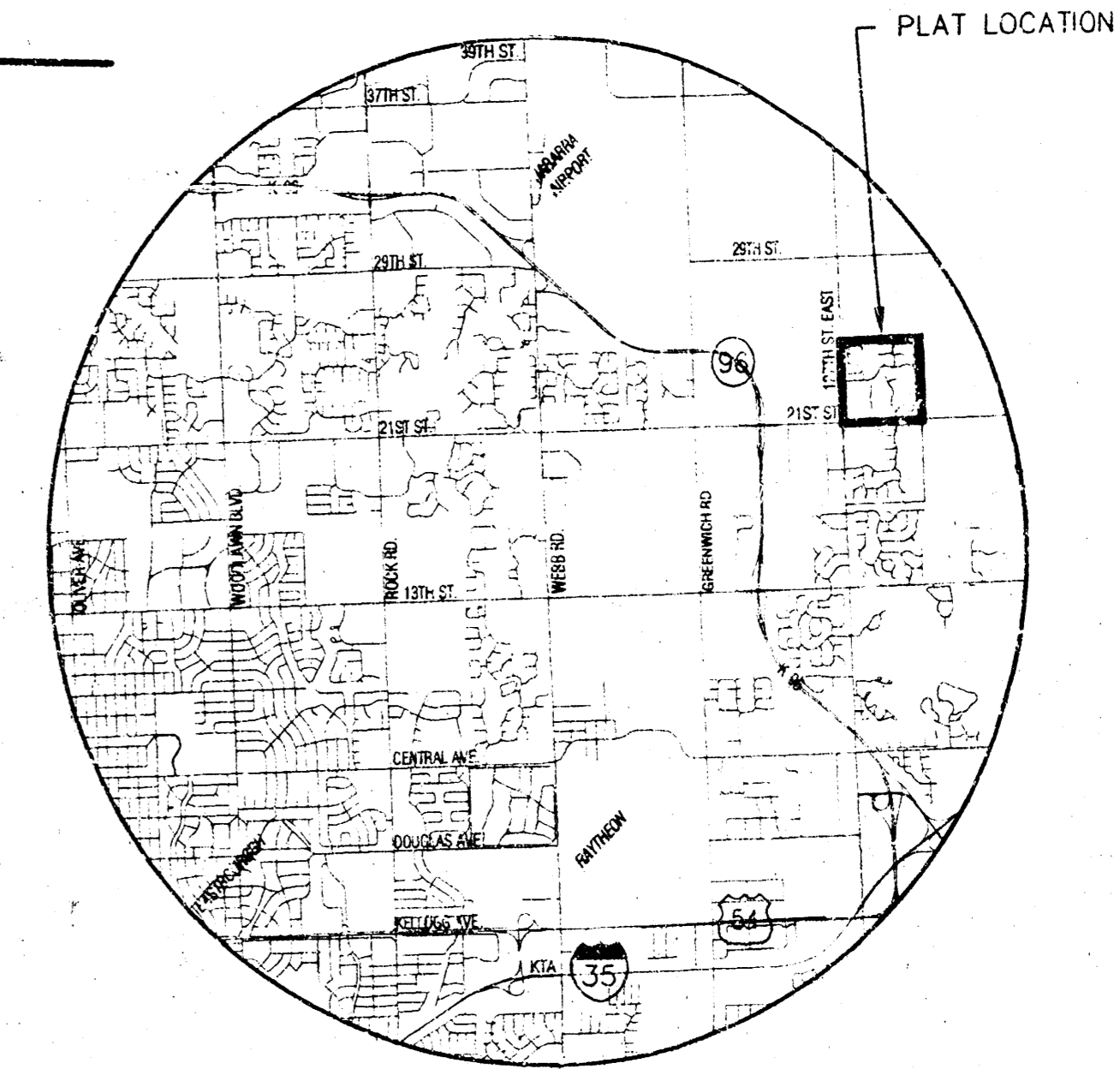

VICINITY MAP

MINIMUM PAD ELEVATIONS (LOWEST OPENINGS)				MINIMUM PAD ELEVATIONS (LOWEST OPENINGS)			
LOT	BLOCK	ELEVATION (CITY DATUM)	ELEVATION (USCS)	LOT	BLOCK	ELEVATION (CITY DATUM)	ELEVATION (USCS)
6	2	175.85	1363.25	14	6	170.30	1357.70
9	2	175.60	1363.00	15	6	170.50	1358.30
10	2	174.70	1362.10	16	6	170.90	1358.30
11	2	174.35	1361.75	17	6	170.30	1357.70
12	2	174.10	1361.50	18	6	170.30	1357.70
21	2	173.60	1361.00	19	6	170.30	1357.70
22	2	173.60	1361.00	20	6	170.30	1357.70
23	2	173.50	1361.00	21	6	170.30	1357.70
24	2	173.60	1361.00	22	6	170.30	1357.70
25	2	173.60	1361.00	23	6	170.30	1357.70
26	2	173.50	1361.00	24	6	169.70	1357.10
27	2	173.60	1361.00	25	6	169.70	1357.10
28	2	173.60	1361.00	26	6	169.70	1357.10
29	2	173.60	1361.00	27	6	169.70	1357.10
30	2	173.60	1361.00	28	6	169.70	1357.10
31	2	173.60	1361.00	29	6	169.70	1357.10
32	2	173.60	1361.00	30	6	174.10	1361.50
33	2	174.60	1362.00	31	6	174.10	1361.50
34	2	175.85	1363.25	32	6	174.10	1361.50
35	2	166.60	1354.00	33	6	177.80	1368.00
36	2	167.10	1354.50	34	6	176.60	1364.00
37	2	168.10	1355.50	35	6	176.60	1364.00
38	2	167.85	1355.25	36	6	176.10	1363.50
39	2	170.30	1357.70	37	6	175.10	1362.50
40	2	170.30	1357.70	38	6	174.10	1361.50
41	2	170.30	1357.70	39	6	174.10	1361.50
42	2	170.30	1357.70	40	6	174.10	1361.50
43	2	170.30	1357.70	41	6	174.10	1361.50
44	2	170.30	1357.70	42	6	169.70	1357.10
45	2	170.30	1357.70	43	6	169.70	1357.10
46	2	170.30	1357.70	44	6	169.70	1357.10
47	2	170.30	1357.70	45	6	169.70	1357.10
48	2	170.30	1357.70	46	6	169.70	1357.10
49	2	170.30	1357.70	47	6	169.70	1357.10
50	2	170.30	1357.70	48	6	169.70	1357.10
51	2	170.30	1357.70	49	6	169.70	1357.10
52	2	170.30	1357.70	50	6	169.70	1357.10
53	2	170.30	1357.70	51	6	169.70	1357.10
54	2	170.30	1357.70	52	6	169.70	1357.10
55	2	170.30	1357.70	53	6	169.70	1357.10
56	2	170.30	1357.70	54	6	169.70	1357.10
57	2	170.30	1357.70	55	6	169.70	1357.10
58	2	170.30	1357.70	56	6	169.70	1357.10
59	2	170.30	1357.70	57	6	169.70	1357.10
60	2	170.30	1357.70	58	6	169.70	1357.10
61	2	170.30	1357.70	59	6	169.70	1357.10
62	2	170.30	1357.70	60	6	169.70	1357.10

LEGEND

- CONTOUR LINE - CONTOUR LINE
- DECIDUOUS TREE & DAMPER
- BUSH
- EDGE OF TREES
- FENCE
- SANITARY SEWER MANHOLE
- GAS METER
- HOLE
- GATE
- LIGHT POLE
- PIPE HYDRANT
- WATER VALVE
- WATER METER
- POWER POLE AND GUY ANCHOR
- TELEPHONE RISER
- INLET
- STORM SEWER PIPE
- WATER LINE
- SANITARY SEWER LINE
- GAS LINE
- UNDERGROUND ELECTRIC LINE
- OVERHEAD TELEPHONE
- OVERHEAD ELECTRIC
- UNDERGROUND FIBER OPTIC CABLE
- HIGH PRESSURE GAS PIPELINE
- SECTION CORNER
- PROPERTY CORNER FOUND
- BENCHMARK

**HEC-RAS CROSS SECTIONS
HAWTHORNE ADDITION**

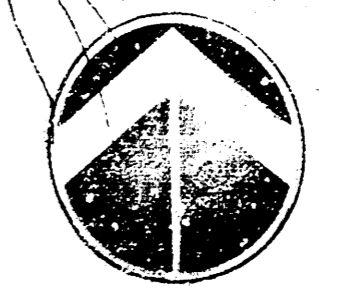
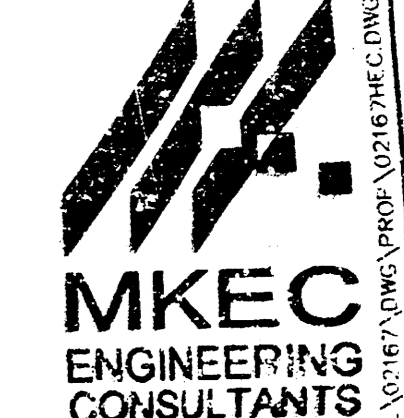

SCALE: 1" = 100'