

HIDDEN CREEK ADDITION

Date: January 5, 2000

POE & ASSOCIATES OF KANSAS, INC.
LAND SURVEYING ENGINEERS
2840 E. Central, Suite 200 • Meriden, KS 67204 • 316/685-4114

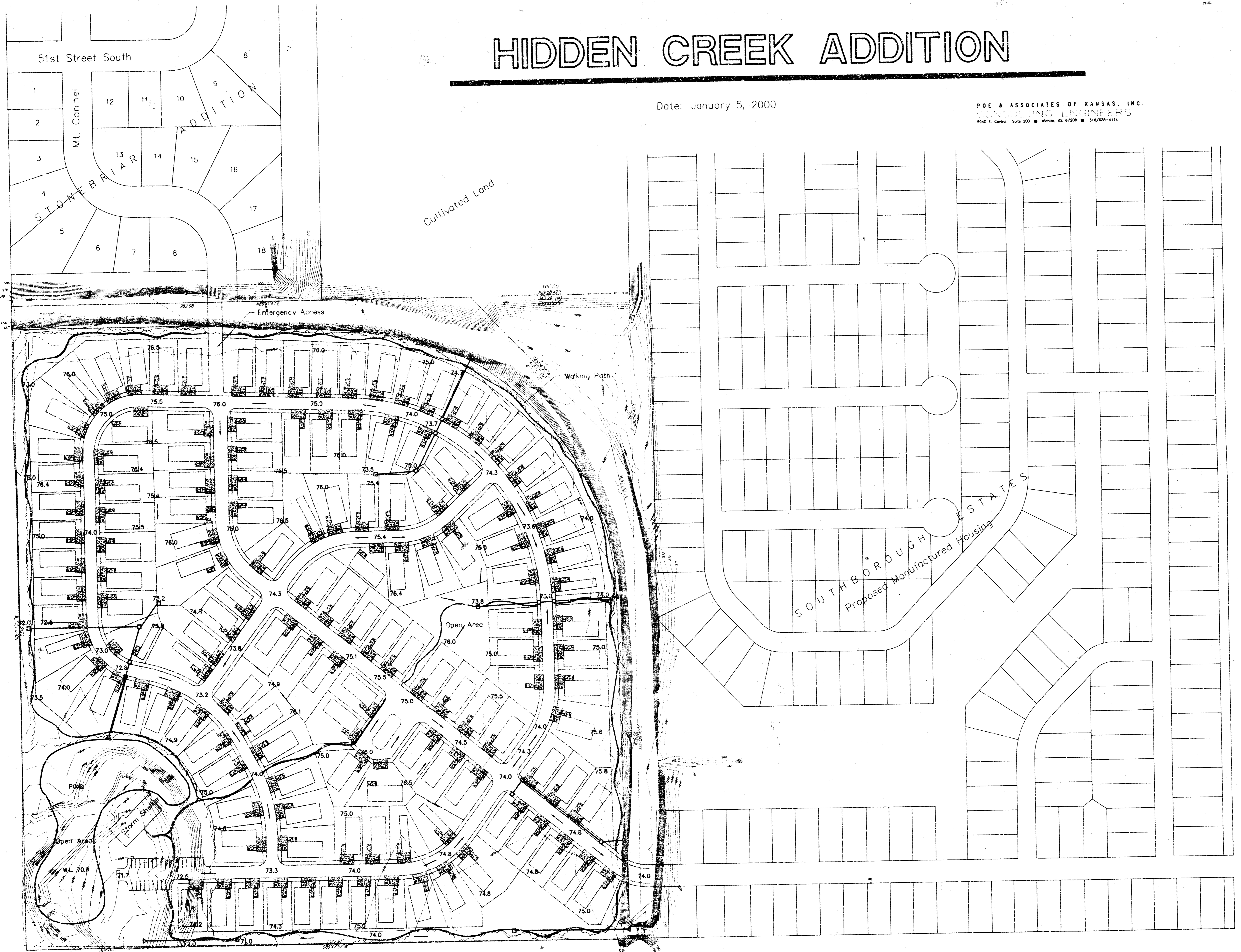

Meridian Avenue

G:\APPS\DCAP\1999\1199.dwg Tue Jan 18 15:50:56 2000 Kenny E. Hill, P.E. - Poe & Associates of Kansas