

DAN MORGEN ADDITION
(Drainage)

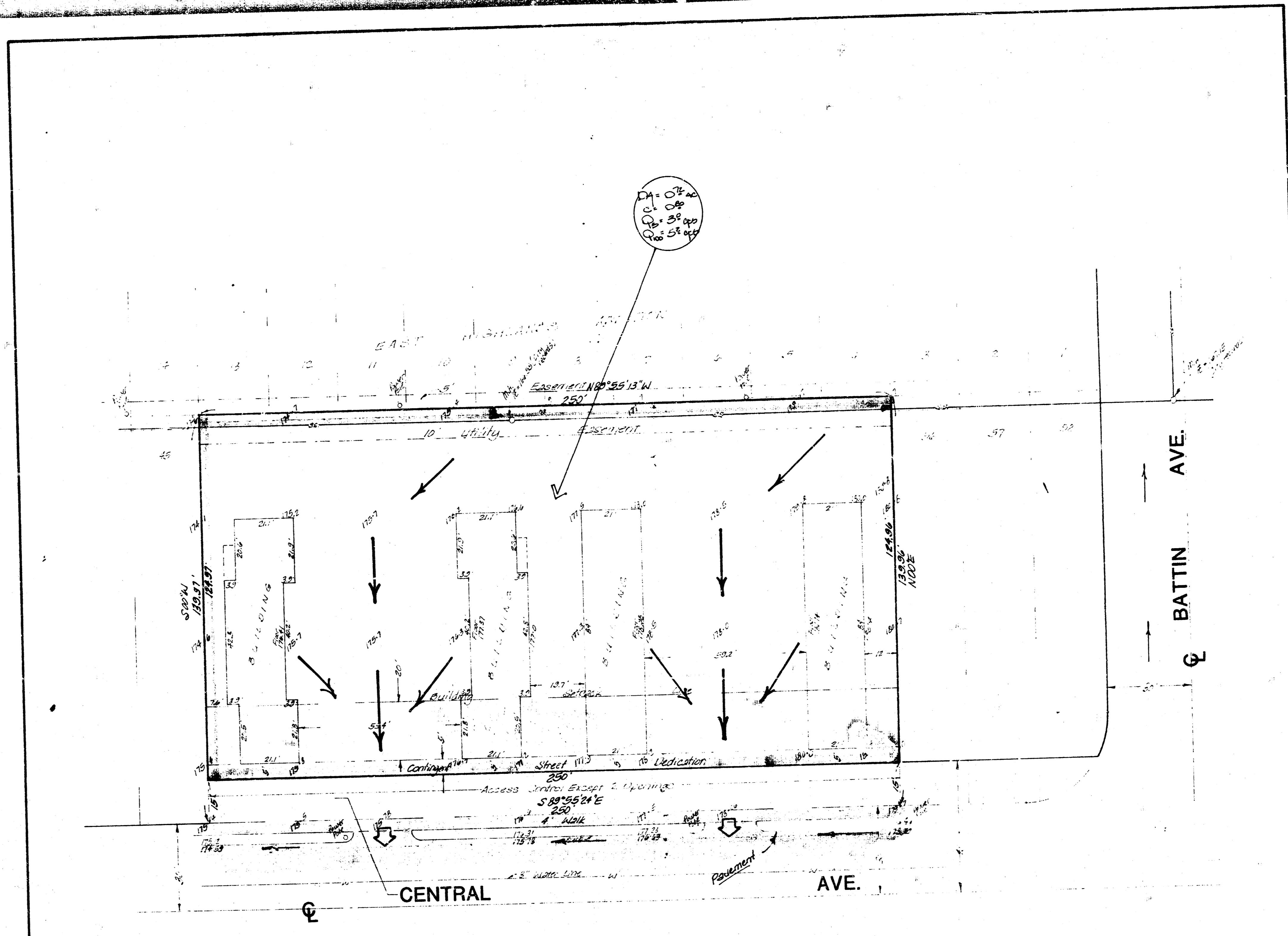

DRAINAGE PLAN
SKETCH PLAT
DAN MORGEN ADDITION
LOTS 46-47-48-49-50-51-52-53-54-55, BLOCK 14,
EAST HIGHLANDS ADDITION, WICHITA, KANSAS
OWNER: DANIEL D. MORGEN

DRAINAGE NOTES
The Lot 1 (0.72 acres) is to be redeveloped for commercial use, but no more new buildings or parking lots will be added. The lot will basically drain to Central as it does presently with the discharge thru the driveways to the street.
Central drains west approximately 130' to a concrete channel which drains south across Central just east of Oliver.

BAUGHMAN COMPANY, P.A.
SURVEYING & ENGINEERING
316-24-2271 • 3301 ALMA • WICHITA, KANSAS 67211